

Oklahoma Corporation Commission  
Oil & Gas Conservation Division  
Post Office Box 52000  
Oklahoma City, Oklahoma 73152-2000  
Rule 165: 10-3-25

Form 1002A

API No.: 35049252940001

**Completion Report**

Spud Date: July 08, 2019

OTC Prod. Unit No.: 049-226070-0-0000

Drilling Finished Date: July 22, 2019

1st Prod Date: November 24, 2019

Completion Date: January 10, 2020

**Drill Type: DIRECTIONAL HOLE**

Well Name: BARRON 1

Purchaser/Measurer:

Location: GARVIN 3 4N 3W  
SE SE SW NE  
260 FSL 1613 FEL of 1/4 SEC  
Derrick Elevation: 1009 Ground Elevation: 992

First Sales Date:

Operator: GLB EXPLORATION INC 18634

7716 MELROSE LN  
OKLAHOMA CITY, OK 73127-6002

Completion Type	
X	Single Zone
	Multiple Zone
	Commingled

Location Exception
Order No
707485

Increased Density
Order No
There are no Increased Density records to display.

Casing and Cement							
Type	Size	Weight	Grade	Feet	PSI	SAX	Top of CMT
CONDUCTOR	16	42		85		5	SURFACE
SURFACE	8 5/8	24	J-55	523	500	275	SURFACE
PRODUCTION	5 1/2	17 & 20	L-80	8505	1800	375	6300

Liner								
Type	Size	Weight	Grade	Length	PSI	SAX	Top Depth	Bottom Depth
There are no Liner records to display.								

**Total Depth: 9915**

Packer	
Depth	Brand & Type
There are no Packer records to display.	

Plug	
Depth	Plug Type
8050	CIBP
8160	CIBP

Initial Test Data
-------------------

Test Date	Formation	Oil BBL/Day	Oil-Gravity (API)	Gas MCF/Day	Gas-Oil Ratio Cu FT/BBL	Water BBL/Day	Pumpin or Flowing	Initial Shut-In Pressure	Choke Size	Flow Tubing Pressure
Oct 23, 2019	1ST BROMIDE					50	SWAB	1400		
Oct 29, 2019	1ST BROMIDE					10	SWAB	200		
Jan 10, 2020	VIOLA	61	38	204	3344	22	FLOWING	1900	20/64	295

**Completion and Test Data by Producing Formation**

Formation Name: 1ST BROMIDE

Code: 202BRMD1

Class: DRY

**Spacing Orders**

Order No	Unit Size
229481	160

**Perforated Intervals**

From	To
8170	8180

**Acid Volumes**

1,000 GALLONS 7 1/2% NEFE HCL
-------------------------------

**Fracture Treatments**

NONE
------

Formation Name: 1ST BROMIDE

Code: 202BRMD1

Class: DRY

**Spacing Orders**

Order No	Unit Size
229481	160

**Perforated Intervals**

From	To
8112	8119

**Acid Volumes**

500 GALLONS 7 1/2% NEFE HCL
-----------------------------

**Fracture Treatments**

NONE
------

Formation Name: VIOLA

Code: 202VIOL

Class: OIL

**Spacing Orders**

Order No	Unit Size
229481	160

**Perforated Intervals**

From	To
7814	7866

**Acid Volumes**

4,000 GALLONS 20% NE HCL
--------------------------

**Fracture Treatments**

420 BARRELS 20% HCL + 5,341 BARRELS SLICKWATER + 133,800 POUNDS 40/70 SAND + 42,000 POUNDS 40/70 SAND RESIN COATED
--

Formation	Top
CHECKERBOARD	6528
DEESE	6622
HART	7064
HUNTON	7112
SYLVAN	7230
VIOLA	7414
1ST BROMIDE	8108
2ND BROMIDE	8195

Were open hole logs run? Yes

Date last log run: July 22, 2019

Were unusual drilling circumstances encountered? No

Explanation:

ARBUCKLE	9600
----------	------

<b>Other Remarks</b>
FIRST BROMIDE DID FLOW 1.5 MILLION CFU UPON PERFORATING, BUT DEPLETED RAPIDLY OVER A TWO WEEK PERIOD. LIMITED RESERVOIR.

<b>Bottom Holes</b>
Sec: 3 TWP: 4N RGE: 3W County: GARVIN SW SW SE NE 80 FSL 1509 FWL of 1/4 SEC Depth of Deviation: 0 Radius of Turn: 0 Direction: 0 Total Length: 0 Measured Total Depth: 9915 True Vertical Depth: 9897 End Pt. Location From Release, Unit or Property Line: 80

<b>FOR COMMISSION USE ONLY</b>	
Status: Accepted	1144725

API NO. 049-25294X  
OTC PROD.  
UNIT NO. 049-226070

(PLEASE TYPE OR USE BLACK INK ONLY)

OKLAHOMA CORPORATION COMMISSION

Oil & Gas Conservation Division

Post Office Box 52000

Oklahoma City, Oklahoma 73152-2000

Rule 165:10-3-25

COMPLETION REPORT

RECEIVED

FEB 03 2020

Form 1002A

Rev. 2009

☒ ORIGINAL  
☐ AMENDED (Reason)

TYPE OF DRILLING OPERATION

☐ STRAIGHT HOLE ☒ DIRECTIONAL HOLE ☐ HORIZONTAL HOLE  
☐ SERVICE WELL

If directional or horizontal, see reverse for bottom hole location.

COUNTY	GARVIN	SEC	3	TWP	4N	RGE	3W	SPUD DATE	7/8/19
LEASE NAME	BARRON	WELL NO.	1 FEL	DRLG FINISHED DATE	7/22/19	DATE OF WELL COMPLETION	1/10/20	1st PROD DATE	11/24/19
SE 1/4 SE 1/4 SW 1/4 NE 1/4	FSL OF 1/4 SEC	260	SW 1/4 OF 1/4 SEC	1027	RECOMP DATE				
ELEVATION	Derrick FL	1009	Ground	992	Latitude (if known)	1613	Longitude (if known)		
OPERATOR NAME	GLB EXPLORATION, INC	OTC / OCC OPERATOR NO.	18634-0						
ADDRESS	7716 MELROSE LANE								
CITY	OKLAHOMA CITY	STATE	OK	ZIP	73127				

OKLAHOMA CORPORATION COMMISSION

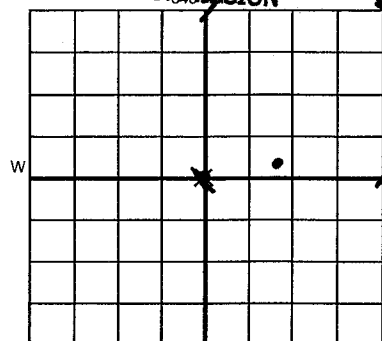

LOCATE WELL

COMPLETION TYPE

<input checked="" type="checkbox"/> SINGLE ZONE	
<input type="checkbox"/> MULTIPLE ZONE	
Application Date	
COMINGLED	
Application Date	
LOCATION EXCEPTION ORDER NO.	707485 F.D.
INCREASED DENSITY ORDER NO.	201847

CASING & CEMENT (Attach Form 1002C)

TYPE	SIZE	WEIGHT	GRADE	FEET	PSI	SAX	TOP OF CMT
CONDUCTOR	16	42	-	85	-	5 1/2	surf
SURFACE	8 5/8	24	J-55	523	500	300	surf
INTERMEDIATE						275	
PRODUCTION	5 1/2	17+20	L-80	8505	1800	375	6300
LINER							
						TOTAL DEPTH	9915

PACKER @ BRAND & TYPE

PACKER @ BRAND & TYPE

PLUG @ 8160 TYPE C10P

PLUG @ 8650 TYPE C10P

PLUG @ TYPE

PLUG @ TYPE

COMPLETION & TEST DATA BY PRODUCING FORMATION

FORMATION	1st Bromide	1st Bromide	VIOLA		
SPACING & SPACING ORDER NUMBER	160-229481	160-229481	160-229481		
CLASS: Oil, Gas, Dry, Inj, Disp, Comm Disp, Svc	DRY *	DRY	OIL		
PERFORATED INTERVALS	8170-80	8112-19	7814-41		
			7849-66		
ACID/VOLUME	1000 GAL 7 1/2% NE FEHCL	500 GAL NE FEHCL 7 1/2%	4000 GAL 20% NE HCL		
FRACTURE TREATMENT (Fluids/Prop Amounts)	NONE	NONE	420 bbls 20% HCL + 5241 bbls slick water + 133,500 # 40/70 SD + 42,000 # 40/70 SD RESIN CAPPED		

INITIAL TEST DATA

INITIAL TEST DATE	10/23/19	10/29/19	1/10/20		
OIL-BBL/DAY	tr	—	61		
OIL-GRAVITY (API)	—	—	38		
GAS-MCF/DAY	tr	tr	204		
GAS-OIL RATIO CU FT/BBL	—	—	3,344:1		
WATER-BBL/DAY	50	10	22 BBLW		
PUMPING OR FLOWING	SWAB	SWAB	Flowing		
INITIAL SHUT-IN PRESSURE	1400	200	1900		
CHOKE SIZE	—	—	20/64		
FLOW TUBING PRESSURE	—	—	295		

A record of the formations drilled through, and pertinent remarks are presented on the reverse. I declare that I have knowledge of the contents of this report and am authorized by my organization to make this report, which was prepared by me or under my supervision and direction, with the data and facts stated herein to be true, correct, and complete to the best of my knowledge and belief.

SIGNATURE

NAME (PRINT OR TYPE)

DATE

PHONE NUMBER

ADDRESS

CITY

STATE

ZIP

EMAIL ADDRESS

PLEASE TYPE OR USE BLACK INK ONLY  
FORMATION RECORD

Give formation names and tops, if available, or descriptions and thickness of formations drilled through. Show intervals cored or drillstem tested.

NAMES OF FORMATIONS	TOP
CHECKERBOARD	6528
DEESE	6622
HART	7064
HUNTON	7112
SYLVAN	7230
VIOLA	7414
1st Bromide	8108
2nd Bromide	8195
ARBUCKLE	9600

LEASE NAME BARRON

WELL NO. 1

FOR COMMISSION USE ONLY	
ITD on file <input type="checkbox"/> YES <input type="checkbox"/> NO	
APPROVED _____	DISAPPROVED _____
2) Reject Codes	

Were open hole logs run?	<u>X</u> yes <u> </u> no
Date Last log was run	<u>7/22/19</u>
Was CO <sub>2</sub> encountered?	<u> </u> yes <u>X</u> no at what depths? _____
Was H <sub>2</sub> S encountered?	<u> </u> yes <u>X</u> no at what depths? _____
Were unusual drilling circumstances encountered?	<u> </u> yes <u>X</u> no
If yes, briefly explain below	

Other remarks: \* First Bromide did flow 1.5 million cft upon PERFORATION, BUT DEPLETED RAPIDLY OVER A TWO WEEK PERIOD. LIMITED RESERVOIR.

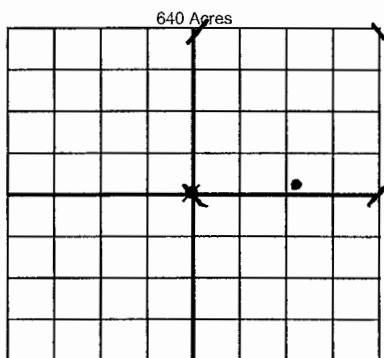

BOTTOM HOLE LOCATION FOR DIRECTIONAL HOLE

SEC <u>3</u>	TWP <u>4N</u>	RGE <u>3W</u>	COUNTY <u>GARVIN</u>
Spot Location <u>SW</u> 1/4 <u>SW</u> 1/4 <u>SE</u> 1/4 <u>NE</u> 1/4		Feet From 1/4 Sec Lines	FSL <u>80</u> FWL <u>1509</u>
Measured Total Depth <u>9915</u>		True Vertical Depth <u>9897.96</u>	BHL From Lease, Unit, or Property Line: <u>80</u>

BOTTOM HOLE LOCATION FOR HORIZONTAL HOLE: (LATERALS)

LATERAL #1

SEC	TWP	RGE	COUNTY
Spot Location 1/4 1/4 1/4 1/4		Feet From 1/4 Sec Lines	FSL FWL
Depth of Deviation		Radius of Turn	Direction
Measured Total Depth		True Vertical Depth	Total Length
BHL From Lease, Unit, or Property Line:			

LATERAL #2

SEC	TWP	RGE	COUNTY
Spot Location 1/4 1/4 1/4 1/4		Feet From 1/4 Sec Lines	FSL FWL
Depth of Deviation		Radius of Turn	Direction
Measured Total Depth		True Vertical Depth	Total Length
BHL From Lease, Unit, or Property Line:			

LATERAL #3

SEC	TWP	RGE	COUNTY
Spot Location 1/4 1/4 1/4 1/4		Feet From 1/4 Sec Lines	FSL FWL
Depth of Deviation		Radius of Turn	Direction
Measured Total Depth		True Vertical Depth	Total Length
BHL From Lease, Unit, or Property Line:			

If more than three drainholes are proposed, attach a separate sheet indicating the necessary information.

Direction must be stated in degrees azimuth. Please note, the horizontal drainhole and its end point must be located within the boundaries of the lease or spacing unit.

Directional surveys are required for all drainholes and directional wells.

