

Oklahoma Corporation Commission
Oil & Gas Conservation Division
Post Office Box 52000
Oklahoma City, Oklahoma 73152-2000
Rule 165: 10-3-25

Form 1002A

API No.: 35063247970000

Completion Report

Spud Date: May 04, 2018

OTC Prod. Unit No.:

Drilling Finished Date: May 09, 2018

1st Prod Date: June 16, 2019

Completion Date: June 12, 2019

Drill Type: STRAIGHT HOLE

Well Name: LOOKENBACK 8-1

Purchaser/Measurer:

Location: HUGHES 8 7N 8E
SE NW NW NE
480 FNL 380 FWL of 1/4 SEC
Derrick Elevation: 974 Ground Elevation: 944

First Sales Date:

Operator: RAYLAND OPERATING LLC 23674
PO BOX 93
6905 WEST DR
MORO, IL 62067-0093

Completion Type		Location Exception		Increased Density	
X	Single Zone	Order No		Order No	
	Multiple Zone	There are no Location Exception records to display.		There are no Increased Density records to display.	
	Commingled				

Casing and Cement								
Type		Size	Weight	Grade	Feet	PSI	SAX	Top of CMT
SURFACE		8 5/8	24	J	380		210	SURFACE
PRODUCTION		5 1/2	17	J-55	4471		120	4120

Liner								
Type	Size	Weight	Grade	Length	PSI	SAX	Top Depth	Bottom Depth
There are no Liner records to display.								

Total Depth: 4450

Packer	
Depth	Brand & Type
There are no Packer records to display.	

Plug	
Depth	Plug Type
1930	10K #
4000	10K #
4250	10K #

Initial Test Data

Test Date	Formation	Oil BBL/Day	Oil-Gravity (API)	Gas MCF/Day	Gas-Oil Ratio Cu FT/BBL	Water BBL/Day	Pumpin or Flowing	Initial Shut-In Pressure	Choke Size	Flow Tubing Pressure
May 30, 2018	1ST WILCOX					300	SWAB	150		
Jun 04, 2018	VIOLA					600	SWAB	180		
Jul 19, 2018	CROMWELL					400	SWAB	140		
Sep 16, 2019	SENORA	5	36			60	PUMPING	280	OPEN	

Completion and Test Data by Producing Formation

Formation Name: 1ST WILCOX

Code: 202WLCX1

Class: DRY

Spacing Orders

Order No	Unit Size
201708615	

Perforated Intervals

From	To
4270	4278

Acid Volumes

1,000 GALLONS 15% NEFE

Fracture Treatments

There are no Fracture Treatments records to display.

Formation Name: VIOLA

Code: 202VIOL

Class: DRY

Spacing Orders

Order No	Unit Size
201708615	

Perforated Intervals

From	To
4210	4224

Acid Volumes

2,000 GALLONS 15%

Fracture Treatments

There are no Fracture Treatments records to display.

Formation Name: CROMWELL

Code: 402CMWL

Class: DRY

Spacing Orders

Order No	Unit Size
266814	

Perforated Intervals

From	To
3292	3296

Acid Volumes

1,000 GALLONS 15%

Fracture Treatments

There are no Fracture Treatments records to display.

Formation Name: SENORA

Code: 404SNOR

Class: OIL

Spacing Orders

Order No	Unit Size
266814	

Perforated Intervals

From	To
1842	1848

Acid Volumes

12,000 GALLONS

Fracture Treatments

15,000 POUNDS SAND

Were open hole logs run? Yes

Formation	Top
SENORA	1842
CROMWELL	3292
VIOLA	4210
1ST WILCOX	4270

Date last log run: May 17, 2018

Were unusual drilling circumstances encountered? No
Explanation:

Other Remarks
There are no Other Remarks.

FOR COMMISSION USE ONLY	
Status: Accepted	1145096

API NO. 063-24797
OTC PROD.
UNIT NO.

(PLEASE TYPE OR USE BLACK INK ONLY)

OKLAHOMA CORPORATION COMMISSION
Oil & Gas Conservation Division
Post Office Box 52000
Oklahoma City, Oklahoma 73152-2000
Rule 165-10-3-25

Form 1002A
Rev. 2009

☒ ORIGINAL
☐ AMENDED (Reason)

COMPLETION REPORT

TYPE OF DRILLING OPERATION

☒ STRAIGHT HOLE ☐ DIRECTIONAL HOLE ☐ HORIZONTAL HOLE
☐ SERVICE WELL

If directional or horizontal, see reverse for bottom hole location.

COUNTY Hughes SEC 8 TWP 07N RGE 08E
LEASE NAME Lookenback
SE 1/4 NW 1/4 NW 1/4 NE 1/4 F&O OF 480 P&L OF 380
ELEVATION 974 Ground 944
Derrick FL 974
Latitude (if known)
Longitude (if known)
OPERATOR NAME RAYLAND OPERATING, LLC DTC / OCC OPERATOR NO. 23674
ADDRESS P.O. BOX 93
CITY MORO STATE IL ZIP 62067

SPUD DATE 5/4/18
DRLG FINISHED DATE 5/9/18
DATE OF WELL COMPLETION 6/12/19
1st PROD DATE 6/16/19
RECOMP DATE
WELL NO. 8-1

640 Acres
LOCATE WELL

COMPLETION TYPE

☒ SINGLE ZONE
☐ MULTIPLE ZONE
Application Date
COMINGLED
Application Date
LOCATION EXCEPTION
ORDER NO.
INCREASED DENSITY
ORDER NO.

CASING & CEMENT (Attach Form 1002C)

TYPE	SIZE	WEIGHT	GRADE	FEET	PSI	SAX	TOP OF CMT
CONDUCTOR						210	
SURFACE	85/8	24	J	380 380		58	210
INTERMEDIATE							
PRODUCTION	51/2	17	J-55	4120 4471		350	4120
LINER						170	
							4,450

PACKER @ BRAND & TYPE

PACKER @ BRAND & TYPE

PLUG @ 4250 TYPE 10K # PLUG @ 4000 TYPE 10K #

PLUG @ 1930 TYPE 10K # PLUG @ TYPE

TOTAL DEPTH

COMPLETION & TEST DATA BY PRODUCING FORMATION

202WLCX1 202V101 402C MWL 404SNDR

FORMATION	1st WILCOX	VIOLA	CROMWELL	SENORA	
SPACING & SPACING ORDER NUMBER	201708615	201708615	266814	266814	
CLASS: Oil, Gas, Dry, Inj, Dep, Comm Disp, Svc	DRY	DRY	DRY	OIL	
PERFORATED INTERVALS	427'0-4278'	4210'4224'	3292'3296'	1842'-1848'	
ACID/VOLUME	15% 1000 GAL NE/FE	15% 2000 GAL	15% 1000 GAL	12,000 GAL	
FRACTURE TREATMENT (Fluids/Prop Amounts)				15000 # SAND	

RECEIVED
APR 28 2020
Oklahoma Corporation
Commission

INITIAL TEST DATA

INITIAL TEST DATE	5/30/2018	6/4/2018	7/19/2018	9/16/2019	
OIL-BBL/DAY	0	0	0	5	
OIL-GRAVITY (API)	0	0	0	36	
GAS-MCF/DAY	0	0	0	TRACE	
GAS-OIL RATIO CU FT/BBL	0	0	0	0	
WATER-BBL/DAY	300	600	400	60	
PUMPING OR FLOWING	SWAB	SWAB	SWAB	PUMPING	
INITIAL SHUT-IN PRESSURE	150	180	140	280	
CHOKE SIZE	0	0	0	OPEN	
FLOW TUBING PRESSURE	0	0	0	0	

A record of the formations drilled through, and pertinent remarks are presented on the reverse. I declare that I have knowledge of the contents of this report and am authorized by my organization to make this report, which was prepared by me or under my supervision and direction, with the data and facts stated herein to be true, correct, and complete to the best of my knowledge and belief.

SIGNATURE Matt Rayms NAME (PRINT OR TYPE) Matt Rayms DATE 10/15/19 PHONE NUMBER 6183342567
P.O. Box 93 MORO, IL 62067 mrayms88@gmail.com

PLEASE TYPE OR USE BLACK INK ONLY
FORMATION RECORD

Give formation names and tops, if available, or descriptions and thickness of formations drilled through. Show intervals cored or drillstem tested.

LEASE NAME Lookin back WELL NO. 8-1

NAMES OF FORMATIONS	TOP
Senora	1842
Cromwell	3292
Viola	4210
1st Wilcox	4270

FOR COMMISSION USE ONLY	
ITD on file <input type="checkbox"/> YES <input type="checkbox"/> NO	
APPROVED _____	DISAPPROVED _____
2) Reject Codes	

Were open hole logs run? ☒ yes ☐ no

Date last log was run _____

Was CO₂ encountered? ☐ yes ☒ no at what depths? _____

Was H₂S encountered? ☐ yes ☒ no at what depths? _____

Were unusual drilling circumstances encountered? ☐ yes ☒ no
If yes, briefly explain below _____

Other remarks:

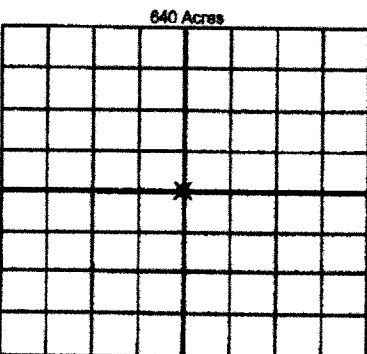

If more than three drainholes are proposed, attach a separate sheet indicating the necessary information.

Direction must be stated in degrees azimuth.
Please note, the horizontal drainhole and its end point must be located within the boundaries of the lease or spacing unit.

Directional surveys are required for all drainholes and directional wells.

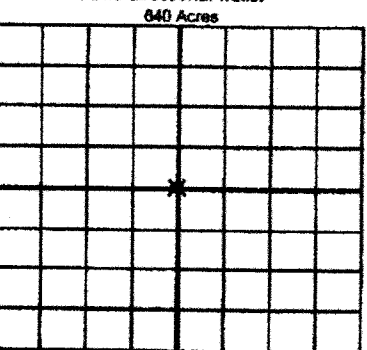

BOTTOM HOLE LOCATION FOR DIRECTIONAL HOLE

SEC	TWP	RGE	COUNTY
Spot Location			
1/4	1/4	1/4	1/4
Feet From 1/4 Sec Lines		FSL	FWL
Measured Total Depth		True Vertical Depth	BHL From Lease, Unit, or Property Line:

BOTTOM HOLE LOCATION FOR HORIZONTAL HOLE: (LATERALS)

LATERAL #1

SEC	TWP	RGE	COUNTY
Spot Location			
1/4	1/4	1/4	1/4
Feet From 1/4 Sec Lines		FSL	FWL
Depth of Deviation	Radius of Turn	Direction	Total Length
Measured Total Depth	True Vertical Depth	BHL From Lease, Unit, or Property Line:	

LATERAL #2

SEC	TWP	RGE	COUNTY
Spot Location			
1/4	1/4	1/4	1/4
Feet From 1/4 Sec Lines		FSL	FWL
Depth of Deviation	Radius of Turn	Direction	Total Length
Measured Total Depth	True Vertical Depth	BHL From Lease, Unit, or Property Line:	

LATERAL #3

SEC	TWP	RGE	COUNTY
Spot Location			
1/4	1/4	1/4	1/4
Feet From 1/4 Sec Lines		FSL	FWL
Depth of Deviation	Radius of Turn	Direction	Total Length
Measured Total Depth	True Vertical Depth	BHL From Lease, Unit, or Property Line:	