

Oklahoma Corporation Commission  
Oil & Gas Conservation Division  
Post Office Box 52000  
Oklahoma City, Oklahoma 73152-2000  
Rule 165: 10-3-25

Form 1002A

API No.: 35081243060001

**Completion Report**

Spud Date: January 02, 2019

OTC Prod. Unit No.: 081-226891-0-0000

Drilling Finished Date: January 11, 2019

1st Prod Date: November 21, 2020

Completion Date: November 15, 2020

**Drill Type:** HORIZONTAL HOLE

Min Gas Allowable: Yes

Well Name: MARK 3-16N-03E 1MH

Purchaser/Measurer: ENLINK OKLAHOMA GAS  
PROCESSING

First Sales Date: 11/22/2020

Location: LINCOLN 3 16N 3E  
SW SW SE SE  
265 FSL 1155 FEL of 1/4 SEC  
Latitude: 35.884741 Longitude: 96.968819  
Derrick Elevation: 0 Ground Elevation: 965

Operator: ROBERSON OIL COMPANY INC 19500  
PO BOX 8  
201 E COTTAGE ST  
ADA, OK 74821-0008

Completion Type		Location Exception		Increased Density	
X	Single Zone	Order No		Order No	
	Multiple Zone	716637		There are no Increased Density records to display.	
	Commingled				

Casing and Cement							
Type	Size	Weight	Grade	Feet	PSI	SAX	Top of CMT
CONDUCTOR	20			80			SURFACE
SURFACE	9 5/8	36	K-55	578	1000	300	SURFACE
PRODUCTION	5 1/2	20	P-110	9174	5000	1140	3433

Liner								
Type	Size	Weight	Grade	Length	PSI	SAX	Top Depth	Bottom Depth
There are no Liner records to display.								

**Total Depth: 9174**

Packer	
Depth	Brand & Type
There are no Packer records to display.	

Plug	
Depth	Plug Type
There are no Plug records to display.	

Initial Test Data
-------------------

Test Date	Formation	Oil BBL/Day	Oil-Gravity (API)	Gas MCF/Day	Gas-Oil Ratio Cu FT/BBL	Water BBL/Day	Pumpin or Flowing	Initial Shut-In Pressure	Choke Size	Flow Tubing Pressure
Dec 08, 2020	MISSISSIPPIAN	249	40	628	2522	1575	PUMPING	850	N/A	

Completion and Test Data by Producing Formation

Formation Name: MISSISSIPPIAN		Code: 359MSSP		Class: OIL	
Spacing Orders		Perforated Intervals			
Order No	Unit Size	From	To		
685869	640	5050	9035		
Acid Volumes		Fracture Treatments			
210,000 GALLONS 15%		1,100,000 POUNDS 20/40 SAND, 2,400,000 POUNDS 30/50 SAND, 168,230 BARRELS WATER			

Formation	Top
CHECKERBOARD LIME	3345
OSWEGO LIME	3862
VERDIGRIS	4043
RED FORK	4256
MISSISSIPPI	4800

Were open hole logs run? No  
Date last log run:  
  
Were unusual drilling circumstances encountered? No  
Explanation:

Other Remarks
There are no Other Remarks.

Lateral Holes
Sec: 3 TWP: 16N RGE: 3E County: LINCOLN  NW   NW   NE   NE  165 FNL   1275 FEL of 1/4 SEC  Depth of Deviation: 3677 Radius of Turn: 1325 Direction: 358 Total Length: 4168  Measured Total Depth: 9174 True Vertical Depth: 4421   End Pt. Location From Release, Unit or Property Line: 165

FOR COMMISSION USE ONLY
<div>Status: Accepted</div> <div>1145994</div>

API NO. 35-081-24306  
OTC PROD. UNIT NO. 081-226891

Oil and Gas Conservation Division  
P.O. Box 52000  
Oklahoma City, OK 73152-2000  
405-522-0577  
OCCentralProcessing@OCC.OK.GOV



OKLAHOMA  
Corporation  
Commission

Form 1002A  
Rev. 2020

☒ ORIGINAL  
☐ AMENDED (Reason) \_\_\_\_\_

Rule 165:10-3-25

COMPLETION REPORT

TYPE OF DRILLING OPERATION  
☐ STRAIGHT HOLE ☐ DIRECTIONAL HOLE ☒ HORIZONTAL HOLE  
☐ SERVICE WELL

If directional or horizontal, see reverse for bottom hole location.

COUNTY Lincoln SEC 3 TWP 16N RGE 3 E

LEASE NAME Mark 3-16N-03E WELL NO. 1MH

SW 1/4 SW 1/4 SE 1/4 SE 1/4 FSL 265 FEL 1155

ELEVATION Danick FL Ground 965' Latitude 35.884740 Longitude -96.968819

OPERATOR NAME Roberson Oil Co., Inc. OTC / OCC OPERATOR NO.

ADDRESS PO Box 8

CITY Ada STATE OK ZIP 74821

SPUD DATE 1-2-19

DRLG FINISHED DATE 1-11-19

DATE OF WELL COMPLETION 11-15-20

1st PROD DATE 11-21-20

RECOMP DATE

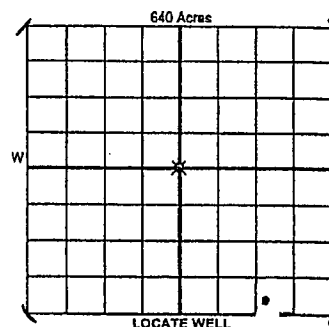

COMPLETION TYPE

☒ SINGLE ZONE Mississippi  
☐ MULTIPLE ZONE  
☐ COMMINGLED  
☐ LOCATION EXCEPTION ORDER NO. 716637  
☐ MULTIUNIT ORDER NO. 214245  
☐ INCREASED DENSITY ORDER NO.

CASING & CEMENT (Attach Form 1002C)

TYPE	SIZE	WEIGHT	GRADE	FEET	PSI	SAX	TOP OF GMT
CONDUCTOR	20"			80'			SURFACE
SURFACE	9 5/8"	36#	K-55	578'	1000	300	SURFACE
INTERMEDIATE							
PRODUCTION	5 1/2"	20#	P-110	9174'	5000	1140	3433'
LINER							9174'

PACKER @ \_\_\_\_\_ BRAND & TYPE \_\_\_\_\_ PLUG @ \_\_\_\_\_ TYPE \_\_\_\_\_ PLUG @ \_\_\_\_\_ TYPE \_\_\_\_\_ TOTAL DEPTH 9174'

COMPLETION & TEST DATA BY PRODUCING FORMATION 359MSSP

FORMATION	Mississippi						
SPACING & SPACING ORDER NUMBER	640 ac. / # 744425	685869					
CLASS: Oil, Gas, Dry, Inj. Disp, Comm Disp, Svc	Oil		7750-7755 7650-7655	6950-6955 6850-6855	6150-6155 6050-6055	5350-5355 5250-5255	
PERFORATED INTERVALS	8890-9035 8850-8855 8750-8755 8650-8655 8550-8555 8450-8455	8350-8355 8250-8255 8150-8155 8050-8055 7950-7955 7850-7855	7550-7555 7450-7455 7350-7355 7250-7255 7150-7155 7050-7055	6750-6755 6650-6655 6550-6555 6450-6455 6350-6355 6250-6255	5950-5955 5850-5855 5750-5755 5650-5655 5550-5555 5450-5455	5150-5155 5050-5055	
ACID/VOLUME	210,000 Gallons	15%					
FRACTURE TREATMENT (Fluids/Prop Amounts)	1,100,000 LBS 2,400,000 LBS 168,230 BBLS	20/40 Sand 30/50 Sand Water					

Reported to Frac Focus

Min Gas Allowable (165:10-17-7)

☒

OR

Oil Allowable (165:10-13-3)

Purchaser/Measurer

First Sales Date

Enlink Okla. Gas Proc.

11-22-2020

INITIAL TEST DATA

INITIAL TEST DATE	12-8-20						
OIL-BBL/DAY	249						
OIL-GRAVITY (API)	40						
GAS-MCF/DAY	628						
GAS-OIL RATIO CU FT/BBL	2522 : 1						
WATER-BBL/DAY	1575						
PUMPING OR FLOWING	pumping						
INITIAL SHUT-IN PRESSURE	850 PSI						
CHOKE SIZE	NA						
FLOW TUBING PRESSURE	NA						

RECEIVED

DEC 30 2020

Oklahoma Corporation  
Commission

A record of the formations drilled through, and pertinent remarks are presented on the reverse. I declare that I have knowledge of the contents of this report and am authorized by my organization to make this report, which was prepared by me or under my supervision and direction, with the data and facts stated herein to be true, correct, and complete to the best of my knowledge and belief.

SIGNATURE David Roberson, II, Pres. DATE 12/30/2020 PHONE NUMBER 580-332-6170  
P. O. Box 8 ADDRESS CITY Ada STATE OK ZIP 74821 EMAIL ADDRESS ROIL11@yahoo.com

PLEASE TYPE OR USE BLACK INK ONLY  
FORMATION RECORD

Give formation names and tops, if available, or descriptions and thickness of formations drilled through. Show intervals cored or drillstem tested.

LEASE NAME MARK 3-16N-03E

WELL NO. 1MH

NAMES OF FORMATIONS	TOP
Checker Board Lime	3345'
OSwego Lime	3862'
Verdigris	4043'
RedFork	4256'
Mississippi	4800'

FOR COMMISSION USE ONLY

ITD on file ☐ YES ☐ NO

APPROVED \_\_\_\_\_ DISAPPROVED \_\_\_\_\_

2) Reject Codes \_\_\_\_\_

\_\_\_\_\_

\_\_\_\_\_

\_\_\_\_\_

\_\_\_\_\_

Were open hole logs run? ☐ yes ☒ no

Date Last log was run \_\_\_\_\_

Was CO<sub>2</sub> encountered? ☐ yes ☒ no at what depths? \_\_\_\_\_

Was H<sub>2</sub>S encountered? ☐ yes ☒ no at what depths? \_\_\_\_\_

Were unusual drilling circumstances encountered? ☐ yes ☒ no

If yes, briefly explain below \_\_\_\_\_

Other remarks: \_\_\_\_\_

\_\_\_\_\_

\_\_\_\_\_

\_\_\_\_\_

\_\_\_\_\_

\_\_\_\_\_

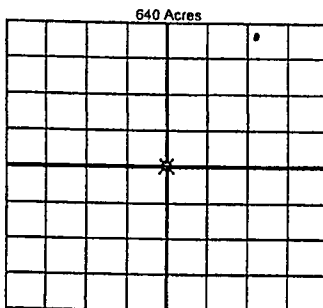

If more than three drainholes are proposed, attach a separate sheet indicating the necessary information.

Direction must be stated in degrees azimuth. Please note, the horizontal drainhole and its end point must be located within the boundaries of the lease or spacing unit.

Directional surveys are required for all drainholes and directional wells

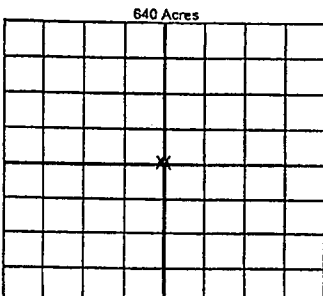

BOTTOM HOLE LOCATION FOR DIRECTIONAL HOLE

SEC	TWP	RGE	COUNTY
1/4	1/4	1/4	1/4
Measured Total Depth		True Vertical Depth	BHL From Lease, Unit, or Property Line:

BOTTOM HOLE LOCATION FOR HORIZONTAL HOLE: (LATERALS)

LATERAL #1

SEC	TWP	RGE	COUNTY
3	16N	3E	Lincoln
NW 1/4	NW 1/4	NE 1/4	NE 1/4
Depth of Deviation	3677'	Radius of Turn	1325'
Measured Total Depth	9174'	True Vertical Depth	4421'
Feet From 1/4 Sec Lines		Direction	380 degrees
165' FNL		Total Length	4168'
BHL From Lease, Unit, or Property Line:			

165' FNL

Per FD exhibit

LATERAL #2

SEC	TWP	RGE	COUNTY
1/4	1/4	1/4	1/4
Depth of Deviation	Radius of Turn	Direction	Total Length
Measured Total Depth	True Vertical Depth	BHL From Lease, Unit, or Property Line:	

LATERAL #3

SEC	TWP	RGE	COUNTY
1/4	1/4	1/4	1/4
Depth of Deviation	Radius of Turn	Direction	Total Length
Measured Total Depth	True Vertical Depth	BHL From Lease, Unit, or Property Line:	