

Oklahoma Corporation Commission
Oil & Gas Conservation Division
Post Office Box 52000
Oklahoma City, Oklahoma 73152-2000
Rule 165: 10-3-25

Form 1002A

API No.: 35081243080001

Completion Report

Spud Date: January 11, 2019

OTC Prod. Unit No.: 081-226890-0-0000

Drilling Finished Date: January 19, 2019

1st Prod Date: November 23, 2020

Completion Date: November 21, 2020

Drill Type: HORIZONTAL HOLE

Min Gas Allowable: Yes

Well Name: MARK 10-16N-3E 1MH

Purchaser/Measurer: ENLINK OKLAHOMA GAS
PROCESSING

First Sales Date: 11/22/2020

Location: LINCOLN 3 16N 3E
SW SW SE SE
235 FSL 1156 FEL of 1/4 SEC
Latitude: 35.884658 Longitude: -96.968819
Derrick Elevation: 0 Ground Elevation: 965

Operator: ROBERSON OIL COMPANY INC 19500
PO BOX 8
201 E COTTAGE ST
ADA, OK 74821-0008

Completion Type		Location Exception		Increased Density	
X	Single Zone	Order No		Order No	
	Multiple Zone	716670		There are no Increased Density records to display.	
	Commingled				

Casing and Cement								
Type		Size	Weight	Grade	Feet	PSI	SAX	Top of CMT
CONDUCTOR		20			80			SURFACE
SURFACE		9 5/8	36	J-55	666	1000	300	SURFACE
PRODUCTION		5 1/2	17	P-110	9467	5000	1195	3100

Liner								
Type	Size	Weight	Grade	Length	PSI	SAX	Top Depth	Bottom Depth
There are no Liner records to display.								

Total Depth: 9469

Packer		Plug	
Depth	Brand & Type	Depth	Plug Type
There are no Packer records to display.		There are no Plug records to display.	

Initial Test Data

Test Date	Formation	Oil BBL/Day	Oil-Gravity (API)	Gas MCF/Day	Gas-Oil Ratio Cu FT/BBL	Water BBL/Day	Pumpin or Flowing	Initial Shut-In Pressure	Choke Size	Flow Tubing Pressure
Dec 08, 2020	MISSISSIPPIAN	111	40	187	1684	1425	PUMPING	280	N/A	

Completion and Test Data by Producing Formation

Formation Name: MISSISSIPPIAN

Code: 359MSSP

Class: OIL

Spacing Orders

Order No	Unit Size
714426	640

Perforated Intervals

From	To
5150	9328

Acid Volumes

220,500 GALLONS 15%

Fracture Treatments

1,155,000 20/40 SAND, 2,520,000 30/50 SAND, 177,387 BARRELS WATER

Formation	Top
CHECKERBORD	3345
OSWEGO	3862
VERDIGRIS	4043
RED FORK	4256
MISSISSIPPI	4800

Were open hole logs run? No

Date last log run:

Were unusual drilling circumstances encountered? No

Explanation:

Other Remarks

There are no Other Remarks.

Lateral Holes

Sec: 10 TWP: 16N RGE: 3E County: LINCOLN

SW SW SE SE

165 FSL 1270 FEL of 1/4 SEC

Depth of Deviation: 3673 Radius of Turn: 1519 Direction: 180 Total Length: 4277

Measured Total Depth: 9469 True Vertical Depth: 4509 End Pt. Location From Release, Unit or Property Line: 165

FOR COMMISSION USE ONLY

1145996

Status: Accepted

35
API NO. 081-24308
OTC PROD.
UNIT NO. 081226890

Oil and Gas Conservation Division
P.O. Box 52000
Oklahoma City, OK 73152-2000
405-522-0577
OCCCentralProcessing@OCC.OK.GOV



OKLAHOMA
Corporation
Commission

Form 1002A
Rev. 2020

ORIGINAL
AMENDED (Reason)

Rule 165:10-3-25

COMPLETION REPORT

TYPE OF DRILLING OPERATION

☐ STRAIGHT HOLE ☐ DIRECTIONAL HOLE ☒ HORIZONTAL HOLE
☐ SERVICE WELL

If directional or horizontal, see reverse for bottom hole location.

COUNTY	Lincoln	SEC	3	TWP	16N	RGE	3E	SPUD DATE	1/11/2019
LEASE NAME	MARK 10-16N-3E			WELL NO.	1MH	DATE OF WELL COMPLETION	11/21/2020	DRLG FINISHED DATE	1/19/2019
SW 1/4	SW 1/4	SE 1/4	SE 1/4	fs1	235'	fe1	1156'	1st PROD DATE	11/23/2020
ELEVATION	Ground 965'			Latitude	35.884658	Longitude	-96.968819	RECOMP DATE	
OPERATOR NAME	ROBERSON OIL COMPANY, INC.			OTC / OCC OPERATOR NO.	19500				
ADDRESS	P O Box 8								
CITY	Ada			STATE	OK	ZIP	74821		

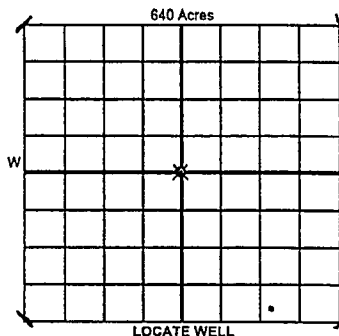

COMPLETION TYPE

☒ SINGLE ZONE Mississippi
☐ MULTIPLE ZONE
☐ COMMINGLED
☐ LOCATION EXCEPTION ORDER NO.
☐ MULTIUNIT ORDER NO.
☐ INCREASED DENSITY ORDER NO.

CASING & CEMENT (Attach Form 1002C)

TYPE	SIZE	WEIGHT	GRADE	FEET	PSI	SAX	TOP OF CMT
CONDUCTOR	20"			80			Surface
SURFACE	9 5/8"	36#	J-55	666'	1000	300	Surface
INTERMEDIATE							
PRODUCTION	5 1/2"	17#	P110	9467'	5000	1195	3100'
LINER							

PACKER @ _____ BRAND & TYPE _____ PLUG @ _____ TYPE _____ PLUG @ _____ TYPE _____ TOTAL DEPTH 9469'

COMPLETION & TEST DATA BY PRODUCING FORMATION

FORMATION	Mississippi						
SPACING & SPACING ORDER NUMBER	640 ac./714426						
CLASS: Oil, Gas, Dry, Inf, Disp, Comm Disp, Svc	Oil	8650-8655	7850-7855	7050-7055	6250-6255	5450-5455	
		8550-8555	7750-7755	6950-6955	6150-6155	5350-5355	
	9184-9328	8450-8455	7650-7655	6850-6855	6050-6055	5250-5255	
	9148-9153	8350-8355	7550-7555	6750-6755	5950-5955	5150-5155	
	9050-9055	8250-8255	7450-7455	6650-6655	5850-5855		
	8950-8955	8150-8155	7350-7355	6550-6555	5750-5755		
	8850-8855	8050-8055	7250-7255	6450-6455	5650-5655		
	8750-8755	7950-7955	7150-7155	6350-6355	5550-5555		
ACID/VOLUME	220,500 Gal's 15%						
FRACTURE TREATMENT (Fluids/Prop Amounts)	1,155,000 20/40 Sand 2,520,000 30/50 Sand 177,387 Bbls Water						

Reported to FractFocus

Min Gas Allowable (165:10-17-7)

Purchaser/Measurer

EnLink Okla. Gas Proc.



OR

First Sales Date

Nov. 22, 2020

INITIAL TEST DATA

INITIAL TEST DATE	12/08/2020				
OIL-BBL/DAY	111				
OIL-GRAVITY (API)	40				
GAS-MCF/DAY	187				
GAS-OIL RATIO CU FT/BBL	1684:1				
WATER-BBL/DAY	1425				
PUMPING OR FLOWING	Pumping				
INITIAL SHUT-IN PRESSURE	280 psi				
CHOKE SIZE	N/A				
FLOW TUBING PRESSURE	N/A				

RECEIVED

DEC 30 2020

Oklahoma Corporation
Commission

A record of the formations drilled through, and pertinent remarks are presented on the reverse. I declare that I have knowledge of the contents of this report and am authorized by my organization to make this report, which was prepared by me or under my supervision and direction, with the data and facts stated herein to be true, correct, and complete to the best of my knowledge and belief.

David Roberson, II, Pres. 12/23/2020 580-332-6170
SIGNATURE NAME (PRINT OR TYPE) DATE PHONE NUMBER
PO Box 8 Ada OK 74821 ROIL11@yahoo.com
ADDRESS CITY STATE ZIP EMAIL ADDRESS

PLEASE TYPE OR USE BLACK INK ONLY
FORMATION RECORD

Give formation names and tops, if available, or descriptions and thickness of formations drilled through. Show intervals cored or drillstem tested.

NAMES OF FORMATIONS	TOP
Checkerboard	3345'
Oswego	3862'
Verdigris	4043'
Redfork	4256'
Mississippi	4800'

LEASE NAME MARK 10-16N-3E

WELL NO. 1MH

FOR COMMISSION USE ONLY	
ITD on file <input type="checkbox"/> YES <input type="checkbox"/> NO	
APPROVED _____	DISAPPROVED _____
2) Reject Codes	

Were open hole logs run?	<input type="radio"/> yes <input checked="" type="radio"/> no
Date Last log was run	_____
Was CO ₂ encountered?	<input type="radio"/> yes <input checked="" type="radio"/> no at what depths? _____
Was H ₂ S encountered?	<input type="radio"/> yes <input checked="" type="radio"/> no at what depths? _____
Were unusual drilling circumstances encountered?	<input type="radio"/> yes <input checked="" type="radio"/> no
If yes, briefly explain below	

Other remarks:

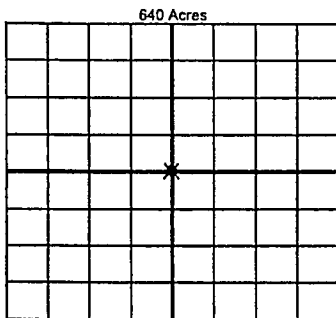

If more than three drainholes are proposed, attach a separate sheet indicating the necessary information.

Direction must be stated in degrees azimuth. Please note, the horizontal drainhole and its end point must be located within the boundaries of the lease or spacing unit.

Directional surveys are required for all drainholes and directional wells

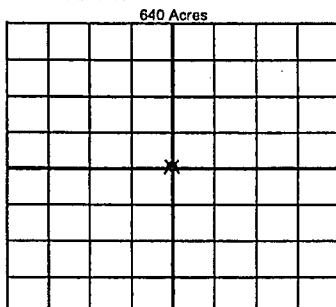

BOTTOM HOLE LOCATION FOR DIRECTIONAL HOLE

SEC	TWP	RGE	COUNTY
10	16N	3E	Lincoln
1/4		1/4	1/4
Measured Total Depth		True Vertical Depth	Feet From 1/4 Sec Lines
9469'		4509'	165' FSL

BOTTOM HOLE LOCATION FOR HORIZONTAL HOLE: (LATERALS)

LATERAL #1			
SEC	TWP	RGE	COUNTY
10	16N	3E	Lincoln
SW 1/4 SW 1/4 SE 1/4 SE 1/4		Feet From 1/4 Sec Lines	
Depth of Deviation 3673'		Radius of Turn 1519'	Direction 180 degree
Measured Total Depth 9469'		True Vertical Depth 4509'	Total Length 4277'
		BHL From Lease, Unit, or Property Line: 165' FSL	

LATERAL #2			
SEC	TWP	RGE	COUNTY
10	16N	3E	Lincoln
1/4		1/4	1/4
Depth of Deviation		Radius of Turn	Direction
Measured Total Depth		True Vertical Depth	Total Length
		BHL From Lease, Unit, or Property Line:	

LATERAL #3			
SEC	TWP	RGE	COUNTY
10	16N	3E	Lincoln
1/4		1/4	1/4
Depth of Deviation		Radius of Turn	Direction
Measured Total Depth		True Vertical Depth	Total Length
		BHL From Lease, Unit, or Property Line:	