

Oklahoma Corporation Commission
Oil & Gas Conservation Division
Post Office Box 52000
Oklahoma City, Oklahoma 73152-2000
Rule 165: 10-3-25

Form 1002A

API No.: 35073264090001

Completion Report

Spud Date: January 19, 2019

OTC Prod. Unit No.:

Drilling Finished Date: February 03, 2019

1st Prod Date: April 23, 2019

Completion Date: April 06, 2019

Drill Type: HORIZONTAL HOLE

Well Name: EAST HENNESSEY UNIT 255RH

Purchaser/Measurer:

Location: KINGFISHER 19 19N 6W
SE SE SE SW
320 FSL 2485 FWL of 1/4 SEC
Latitude: 36.1029197 Longitude: -97.881395479
Derrick Elevation: 1162 Ground Elevation: 1141

First Sales Date:

Operator: HINKLE OIL & GAS INC 21639

5600 N MAY AVE STE 295
OKLAHOMA CITY, OK 73112-4275

Completion Type		Location Exception		Increased Density	
X	Single Zone	Order No		Order No	
	Multiple Zone	There are no Location Exception records to display.		There are no Increased Density records to display.	
	Commingle				

Casing and Cement							
Type	Size	Weight	Grade	Feet	PSI	SAX	Top of CMT
CONDUCTOR	16			125		10	SURFACE
SURFACE	9 5/8	36	J-55	410		365	SURFACE
PRODUCTION	7	29	P-110	7160		280	4150

Liner								
Type	Size	Weight	Grade	Length	PSI	SAX	Top Depth	Bottom Depth
LINER	4 1/2	11.6	P-110	5987	0	0	6966	12953

Total Depth: 12955

Packer		Plug	
Depth	Brand & Type	Depth	Plug Type
6921	MODEL R	There are no Plug records to display.	

Initial Test Data

Test Date	Formation	Oil BBL/Day	Oil-Gravity (API)	Gas MCF/Day	Gas-Oil Ratio Cu FT/BBL	Water BBL/Day	Pumpin or Flowing	Initial Shut-In Pressure	Choke Size	Flow Tubing Pressure
May 17, 2019	MISSISSIPPIAN SOLID	691	37.7	86	124	1056	FLOWING		N/A	225

Completion and Test Data by Producing Formation

Formation Name: MISSISSIPPIAN SOLID

Code: 359MSSSD

Class: OIL

Spacing Orders

Order No	Unit Size
61709	UNIT

Perforated Intervals

From	To
There are no Perf. Intervals records to display.	

Acid Volumes

5,544 GALLONS 15% HCL

Fracture Treatments

138,144 BARRELS WATER, 2,867,050 POUNDS SAND
--

Formation	Top
-----------	-----

Were open hole logs run? No

Date last log run:

Were unusual drilling circumstances encountered? No

Explanation:

Other Remarks

OCC - THIS IS AN OPEN HOLE COMPLETION FROM BOTTOM OF THE 7" CASING AT 7160' TO TERMINUS AT 12955'. THE 4 1/2" LINER IS NOT CEMENTED.

Lateral Holes

Sec: 30 TWP: 19N RGE: 6W County: KINGFISHER

SW SW SW SE

50 FSL 2320 FEL of 1/4 SEC

Depth of Deviation: 7042 Radius of Turn: 853 Direction: 0 Total Length: 5060

Measured Total Depth: 12955 True Vertical Depth: 7513 End Pt. Location From Release, Unit or Property Line: 50

FOR COMMISSION USE ONLY

1142911

Status: Accepted

API NO. 073-26409
OTC PROD. Merge #0342
UNIT NO.

PLEASE TYPE OR USE BLACK INK ONLY
NOTE:

Attach copy of original 1002A
if recompletion or reentry.

OKLAHOMA CORPORATION COMMISSION
Oil & Gas Conservation Division
Post Office Box 52000
Oklahoma City, Oklahoma 73152-2000
Rule 165:10-3-25

RECEIVED

MAY 17 2019

OKLAHOMA CORPORATION
COMMISSION

Form 1002A
Rev. 2009

☒ ORIGINAL
☐ AMENDED (Reason)

COMPLETION REPORT

TYPE OF DRILLING OPERATION

☐ STRAIGHT HOLE ☐ DIRECTIONAL HOLE ☒ HORIZONTAL HOLE
☐ SERVICE WELL

If directional or horizontal, see reverse for bottom hole location.

COUNTY	Kingfisher	SEC	19	TWP	19N	RGE	06W	SPUD DATE	1/19/19
LEASE NAME	East Hennessey Unit			WELL NO.	255RH			DRLG FINISHED DATE	2/3/19
SE 1/4	SE 1/4	SE 1/4	SW 1/4	FSL 1/4 SEC	320'	FWL OF 1/4 SEC	2485'	DATE OF WELL COMPLETION	4/6/19
ELEVATION N Derrick	1162'	Ground	1141'	Latitude (if known)	36.1029197			1st PROD DATE	4/23/19
OPERATOR NAME	Hinkle Oil & Gas, Inc.			OTC/OCC OPERATOR NO.	21639				
ADDRESS	5600 N. May Avenue, Suite 295								
CITY	Oklahoma City			STATE	OK	ZIP	73112		

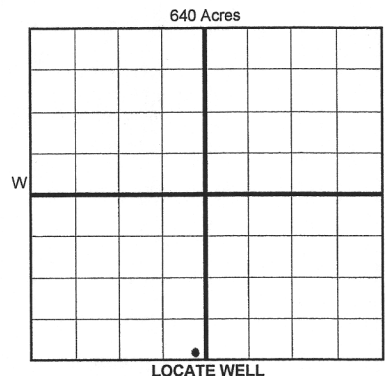

COMPLETION TYPE

<input checked="" type="checkbox"/> SINGLE ZONE
<input type="checkbox"/> MULTIPLE ZONE
<input type="checkbox"/> COMMINGLED
<input type="checkbox"/> LOCATION
<input type="checkbox"/> EXCEPTION ORDER
<input type="checkbox"/> INCREASED DENSITY
<input type="checkbox"/> ORDER NO.

CASING & CEMENT (Form 1002C must be attached)

TYPE	SIZE	WEIGHT	GRADE	FEET	PSI	SAX	TOP OF CMT
CONDUCTOR	16"			125'		10 yds	Surface
SURFACE	9 5/8"	36#	J55	410'		365	Surface
INTERMEDIATE							
PRODUCTION	7"	29#	P110	7160'		280	4150'
LINER	4 1/2"	11.6#	P110	6966'-12,953'		FS	
						TOTAL DEPTH	12,955'

PACKER @ 6921' BRAND & TYPE Mod. R PLUG @ TYPE PLUG @ TYPE
PACKER @ BRAND & TYPE PLUG @ TYPE PLUG @ TYPE

COMPLETION & TEST DATA BY PRODUCING FORMATION 359MSSSD

FORMATION	Mississippian Solid								
SPACING & SPACING ORDER NUMBER	61709 (unit)								
CLASS: Oil, Gas, Dry, Inj, Disp, Comm Disp, Svc	Oil								
PERFORATED INTERVALS	7710'-12,574'								
	open hole								
ACID/VOLUME									
FRACTURE TREATMENT (Fluids/Prop Amounts)	5544 Gal. 15% HCL, 138144 Bbl. Wtr								
	2867050# Sand								

Min Gas Allowable (165:10-17-7)

Gas Purchaser/Measurer

OR

First Sales Date

Oil Allowable (165:10-13-3)

INITIAL TEST DATA

INITIAL TEST DATE	5/17/2019						
OIL-BBL/DAY	691						
OIL-GRAVITY (API)	37.7						
GAS-MCF/DAY	86						
GAS-OIL RATIO CU FT/BBL	1209 124						
WATER-BBL/DAY	1056						
PUMPING OR FLOWING	Flowing						
INITIAL SHUT-IN PRESSURE	N/A						
CHOKE SIZE	N/A						
FLOW TUBING PRESSURE	225						

AS SUBMITTED

A record of the formations drilled through, and pertinent remarks are presented on the reverse. I declare that I have knowledge of the contents of this report and am authorized by my organization to make this report, which was prepared by me or under my supervision and direction, with the data and facts stated herein to be true, correct, and complete to the best of my knowledge and belief.

B. Hinkle SIGNATURE
5600 N. May Avenue, Suite 295 ADDRESS
Oklahoma City CITY
OK STATE
73112 ZIP

Bruce A. Hinkle NAME (PRINT OR TYPE)
5/17/2019 DATE
405-848-0924 PHONE NUMBER
Laurahinkle@hoagi.com EMAIL ADDRESS

Give formation names and tops, if available, or descriptions and thickness of formations drilled through. Show intervals cored or drillstem tested.

WELL NO. 255RH

NAMES OF FORMATIONS	TOP

FOR COMMISSION USE ONLY	
ITD on file <input type="checkbox"/> YES <input type="checkbox"/> NO	
APPROVED DISAPPROVED	2) Reject Codes

Were open hole logs run? ___ yes X no

Date Last log was run _____

Was CO₂ encountered? ___ yes X no at what depths? _____

Was H₂S encountered? ___ yes X no at what depths? _____

Were unusual drilling circumstances encountered? ___ yes X no

If yes, briefly explain below

Other remarks: OCC- This is an openhole completion from bottom of the 7" casing at 7160' to terminus at 12,955'. The 4½" Liner is not cemented.

Direction must be stated in degrees azimuth.
Please note, the horizontal drainhole and its end point must be located within the boundaries of the lease or spacing unit.

640 Acres

A blank 10x10 grid for graphing, with a horizontal and vertical axis intersecting at the center. The grid is divided into four quadrants by these axes. The top-left quadrant is labeled 'x' and the bottom-right quadrant is labeled 'y'.

SEC	TWP	RGE	COUNTY			
Spot Location				Feet From 1/4 Sec Lines	FSL	FWL
1/4		1/4	1/4	1/4		
Measured Total Depth		True Vertical Depth		BHL From Lease, Unit, or Property Line:		

LATERAL #1										
SEC	30	TWP	19N	RGE	06W	COUNTY Kingfisher				
Spot Location		SW 1/4		SW 1/4		SE 1/4		Feet From 1/4 Sec Lines	FSL 5054	FEL 2371
Depth of Deviation		7042'		Radius of Turn		853'		Direction 178 South	Total Length	5060'
Measured Total Depth				True Vertical Depth		BHL From Lease, Unit, or Property Line:				
12,955'				7513'		50 2909				

SEC	TWP	RGE	COUNTY			
Spot Location				Feet From 1/4 Sec Lines	FSL	FWL
1/4	1/4	1/4	1/4			
Depth of Deviation		Radius of Turn	Direction	Total Length		
Measured Total Depth		True Vertical Depth	BHL From Lease, Unit, or Property Line:			

LATERAL #3							
SEC	TWP	RGE	COUNTY				
Spot Location				Feet From 1/4 Sec Lines		FSL	FWL
1/4		1/4		1/4		1/4	
Depth of Deviation		Radius of Turn		Direction		Total Length	
Measured Total Depth		True Vertical Depth		BHL From Lease, Unit, or Property Line:			