

Oklahoma Corporation Commission
Oil & Gas Conservation Division
Post Office Box 52000
Oklahoma City, Oklahoma 73152-2000
Rule 165: 10-3-25

Form 1002A

API No.: 35073260080000

Completion Report

Spud Date: December 30, 2018

OTC Prod. Unit No.:

Drilling Finished Date: January 18, 2019

1st Prod Date: April 13, 2019

Completion Date: April 04, 2019

Drill Type: HORIZONTAL HOLE

Well Name: EAST HENNESSEY UNIT 252H

Purchaser/Measurer:

Location: KINGFISHER 19 19N 6W
SE SE SE SW
300 FSL 2485 FWL of 1/4 SEC
Latitude: 36.1028649 Longitude: -97.881395865
Derrick Elevation: 1162 Ground Elevation: 1144

First Sales Date:

Operator: HINKLE OIL & GAS INC 21639

5600 N MAY AVE STE 295
OKLAHOMA CITY, OK 73112-4275

Completion Type	
X	Single Zone
	Multiple Zone
	Commingled

Location Exception	
Order No	
There are no Location Exception records to display.	

Increased Density	
Order No	
There are no Increased Density records to display.	

Casing and Cement							
Type	Size	Weight	Grade	Feet	PSI	SAX	Top of CMT
CONDUCTOR	16			125		10	SURFACE
SURFACE	9 5/8	36	J-55	416		265	SURFACE
PRODUCTION	7	29	P-110	7310		280	4560

Liner								
Type	Size	Weight	Grade	Length	PSI	SAX	Top Depth	Bottom Depth
LINER	4 1/2	11.6	P-110	5930	0	0	7072	13002

Total Depth: 13002

Packer	
Depth	Brand & Type
6994	AS-III

Plug	
Depth	Plug Type
There are no Plug records to display.	

Initial Test Data

Test Date	Formation	Oil BBL/Day	Oil-Gravity (API)	Gas MCF/Day	Gas-Oil Ratio Cu FT/BBL	Water BBL/Day	Pumpin or Flowing	Initial Shut-In Pressure	Choke Size	Flow Tubing Pressure
May 17, 2019	MISSISSIPPIAN SOLID	905	38.5	549	606	487	FLOWING		N/A	145

Completion and Test Data by Producing Formation

Formation Name: MISSISSIPPIAN SOLID

Code: 359MSSSD

Class: OIL

Spacing Orders

Order No	Unit Size
61709	UNIT

Perforated Intervals

From	To
There are no Perf. Intervals records to display.	

Acid Volumes

6,552 GALLONS 15% HCL

Fracture Treatments

13,971 BARRELS WATER, 2,892,216 POUNDS SAND

Formation	Top
-----------	-----

Were open hole logs run? No

Date last log run:

Were unusual drilling circumstances encountered? No

Explanation:

Other Remarks

OCC - THIS IS AN OPEN HOLE COMPLETION FROM BOTTOM OF THE 7' CASIN AT 7310' TO TERMINUS AT 13002'. THE 4 1/2" LINER IS NOT CEMENTED.

Lateral Holes

Sec: 19 TWP: 19N RGE: 6W County: KINGFISHER

NE NW NW NE

3 FNL 2062 FEL of 1/4 SEC

Depth of Deviation: 7012 Radius of Turn: 883 Direction: 358 Total Length: 5107

Measured Total Depth: 13002 True Vertical Depth: 7298 End Pt. Location From Release, Unit or Property Line: 3218

FOR COMMISSION USE ONLY

1142908

Status: Accepted

API NO. 073-26008
OTC PROD. UNIT NO. Merge #0342

PLEASE TYPE OR USE BLACK INK ONLY
NOTE:

Attach copy of original 1002A
if recompletion or reentry.

OKLAHOMA CORPORATION COMMISSION
Oil & Gas Conservation Division
Post Office Box 52000
Oklahoma City, Oklahoma 73152-2000
Rule 165:10-3-25

RECEIVED

Form 1002A
Rev. 2009

MAY 17 2019

OKLAHOMA CORPORATION
COMMISSION

☒ ORIGINAL
☐ AMENDED (Reason)

COMPLETION REPORT

TYPE OF DRILLING OPERATION

☐ STRAIGHT HOLE ☐ DIRECTIONAL HOLE ☒ HORIZONTAL HOLE
☐ SERVICE WELL

If directional or horizontal, see reverse for bottom hole location.

COUNTY	Kingfisher	SEC	19	TWP	19N	RGE	06W
LEASE NAME	East Hennessey Unit			WELL NO.	252H		
SE 1/4	SE 1/4	SE 1/4	SW 1/4	FSL 1/4 SEC	300'	FWL OF 1/4 SEC	2485'
ELEVATION Derrick	1162'	Ground	1144'	Latitude (if known)	36.1028649		
OPERATOR NAME	Hinkle Oil & Gas, Inc.			OTC/OCC OPERATOR NO.	21639		
ADDRESS	5600 N. May Avenue, Suite 295						
CITY	Oklahoma City		STATE	OK		ZIP	73112

SPUD DATE 12/30/18
DRLG FINISHED DATE 1/18/19
DATE OF WELL COMPLETION 4/4/19
1st PROD DATE 4/13/19
RECOMP DATE
Longitude (if known) -97.881395865

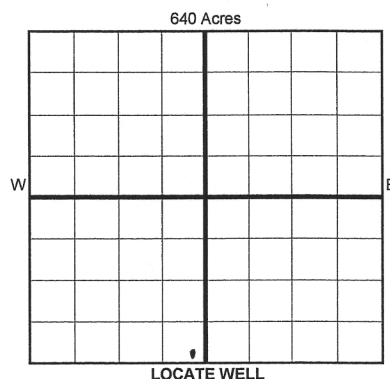

COMPLETION TYPE

<input checked="" type="checkbox"/> SINGLE ZONE
<input type="checkbox"/> MULTIPLE ZONE
Application Date
<input type="checkbox"/> COMMINGLED
Application Date
LOCATION
EXCEPTION ORDER
INCREASED DENSITY
ORDER NO.

CASING & CEMENT (Form 1002C must be attached)

TYPE	SIZE	WEIGHT	GRADE	FEET	PSI	SAX	TOP OF CMT
CONDUCTOR	16"			125'		10 yds	Surface
SURFACE	9 5/8"	36#	J55	416'		265	Surface
INTERMEDIATE							
PRODUCTION	7"	29#	P110	7310'		280	4560'
LINER	4 1/2"	11.6#	P110	7072'-13,002'		FS	
						TOTAL DEPTH	13,002'

PACKER @ 6994' BRAND & TYPE AS-III PLUG @ TYPE PLUG @ TYPE
PACKER @ BRAND & TYPE PLUG @ TYPE PLUG @ TYPE

COMPLETION & TEST DATA BY PRODUCING FORMATION

FORMATION	Mississippian Solid						
SPACING & SPACING ORDER NUMBER	61709 (unit)						
CLASS: Oil, Gas, Dry, Inj, Disp, Comm Disp, Svc	Oil						
PERFORATED INTERVALS	7872'-12,618'						
	open hole						
ACID/VOLUME							
FRACTURE TREATMENT (Fluids/Prop Amounts)	6552 Gal. 15% HCL, 2892216# Sand	13971 Bbl. Water					

Reported to
Frac Focus

☐ Min Gas Allowable (165:10-17-7)
OR
☐ Oil Allowable (165:10-13-3)

Gas Purchaser/Measurer
First Sales Date

INITIAL TEST DATA

INITIAL TEST DATE	5/17/2019					
OIL-BBL/DAY	905					
OIL-GRAVITY (API)	38.5					
GAS-MCF/DAY	549					
GAS-OIL RATIO CU FT/BBL	606					
WATER-BBL/DAY	487					
PUMPING OR FLOWING	Flowing					
INITIAL SHUT-IN PRESSURE	N/A					
CHOKE SIZE	N/A					
FLOW TUBING PRESSURE	145					

AS SUBMITTED

A record of the formations drilled through, and pertinent remarks are presented on the reverse. I declare that I have knowledge of the contents of this report and am authorized by my organization to make this report, which was prepared by me or under my supervision and direction, with the data and facts stated herein to be true, correct, and complete to the best of my knowledge and belief.

Bruce A. Hinkle
SIGNATURE
5600 N. May Avenue, Suite 295
ADDRESS
Oklahoma City
CITY
OK
STATE
73112
ZIP
4/17/2019
DATE
405-848-0924
PHONE NUMBER
Laurahinkle@hoagi.com
EMAIL ADDRESS

FORMATION RECORD

LEASE NAME	East Hennessey Unit
------------	---------------------

WELL NO. 252H

NAMES OF FORMATIONS	TOP

FOR COMMISSION USE ONLY	
ITD on file	<input type="checkbox"/> YES <input type="checkbox"/> NO
APPROVED	DISAPPROVED
2) Reject Codes	

Were open hole logs run? ☐ yes ☒ no

Date Last log was run _____

Was CO₂ encountered? ☐ yes ☒ no at what depths? _____

Was H₂S encountered? ☐ yes ☒ no at what depths? _____

Were unusual drilling circumstances encountered? ☐ yes ☒ no

If yes, briefly explain below

Other remarks:

Other remarks: OCC - This is an open hole completion from bottom of the 7" casing at 7310' to terminus at 13002'. The 4 1/2" liner is not cemented.

640 Acres

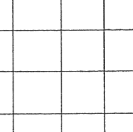

Direction must be stated in degrees azimuth.
Please note, the horizontal drainhole and its end point must be located within the boundaries of the lease or spacing unit.

Directional surveys are required for all drainholes and directional wells.

640 Acres

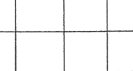
A 10x10 grid representing 640 acres. The grid is divided into four 5x5 quadrants by a thick horizontal line and a thick vertical line that intersect at the center. The top-left quadrant is shaded gray. The other three quadrants (top-right, bottom-left, and bottom-right) are white. The text "640 Acres" is centered above the grid.

BOTTOM HOLE LOCATION FOR DIRECTIONAL HOLE

SEC	TWP	RGE	COUNTY			
Spot Location				Feet From 1/4 Sec Lines	FSL	FWL
1/4	1/4	1/4	1/4			
Measured Total Depth		True Vertical Depth		BHL From Lease, Unit, or Property Line:		

BOTTOM HOLE LOCATION FOR HORIZONTAL HOLE: (LATERALS)

LATERAL #1

EXTERNAL #1									
SEC 19	TWP 19N	RGE 06W	COUNTY Kingfisher						
Spot Location				Feet From 1/4 Sec Lines		FNL 3'		FEL 2218'	
NE 1/4		NW 1/4		NE 1/4					
Depth of Deviation		7012'		Radius of Turn		883'		Direction 358-North	
Measured Total Depth		13,002'		True Vertical Depth		7298'		Total Length 5107'	
								BHL From Lease, Unit, or Property Line: 420' 3218'	

LATERAL #2

LATERAL #2							
SEC	TWP	RGE	COUNTY				
Spot Location				Feet From 1/4 Sec Lines	FSL	FWL	
1/4	1/4	1/4	1/4				
Depth of Deviation		Radius of Turn	Direction		Total Length		
Measured Total Depth		True Vertical Depth	BHL From Lease, Unit, or Property Line:				

LATERAL #3

LATERAL #3						
SEC	TWP	RGE	COUNTY			
Spot Location				Feet From 1/4 Sec Lines	FSL	FWL
1/4		1/4	1/4	1/4		
Depth of Deviation		Radius of Turn		Direction	Total Length	
Measured Total Depth		True Vertical Depth		BHL From Lease, Unit, or Property Line:		