

Oklahoma Corporation Commission  
Oil & Gas Conservation Division  
Post Office Box 52000  
Oklahoma City, Oklahoma 73152-2000  
Rule 165: 10-3-25

Form 1002A

API No.: 35059224670002

**Completion Report**

Spud Date: February 13, 2008

OTC Prod. Unit No.: 059-123357-0-0000

Drilling Finished Date: February 23, 2008

**Amended**

1st Prod Date: April 05, 2008

Amend Reason: COMMINGLE ZONES

Completion Date: April 04, 2008

Recomplete Date: December 18, 2020

**Drill Type: STRAIGHT HOLE**

Min Gas Allowable: Yes

Well Name: J C LOVE 1-14

Purchaser/Measurer: DCP MIDSTREAM

Location: HARPER 14 26N 24W  
SE NW NE NW  
2010 FSL 1870 FWL of 1/4 SEC  
Latitude: 36.7385171 Longitude: -99.7577824  
Derrick Elevation: 2325 Ground Elevation: 0

First Sales Date: 04/06/2008

Operator: LATIGO OIL AND GAS INC 10027  
PO BOX 1208  
5815 OKLAHOMA AVE  
WOODWARD, OK 73802-1208

Completion Type		Location Exception		Increased Density	
	Single Zone	Order No		Order No	
	Multiple Zone	550643		There are no Increased Density records to display.	
X	Commingled	715680			

Casing and Cement							
Type	Size	Weight	Grade	Feet	PSI	SAX	Top of CMT
SURFACE	8 5/8	24 / 32	K-55	950		530	SURFACE
PRODUCTION	4.5	11.8	N-80	7221		490	2660

Liner								
Type	Size	Weight	Grade	Length	PSI	SAX	Top Depth	Bottom Depth
There are no Liner records to display.								

**Total Depth: 7221**

Packer	
Depth	Brand & Type
There are no Packer records to display.	

Plug	
Depth	Plug Type
There are no Plug records to display.	

Initial Test Data
-------------------

Test Date	Formation	Oil BBL/Day	Oil-Gravity (API)	Gas MCF/Day	Gas-Oil Ratio Cu FT/BBL	Water BBL/Day	Pumpin or Flowing	Initial Shut-In Pressure	Choke Size	Flow Tubing Pressure
Jan 10, 2021	CHEROKEE-MORROW SAND-CHESTER LIME	2	42	55	27500	1	PUMPING	200		50

#### Completion and Test Data by Producing Formation

Formation Name: CHEROKEE

Code: 404CHRK

Class: GAS

##### Spacing Orders

Order No	Unit Size
UNSPACED 8	

##### Perforated Intervals

From	To
6677	6683
6687	6692
6714	6718
6726	6730

##### Acid Volumes

12,348 GALLONS 20% HCL

##### Fracture Treatments

There are no Fracture Treatments records to display.

Formation Name: MORROW SAND

Code: 402MWSD

Class: GAS

##### Spacing Orders

Order No	Unit Size
34971	640

##### Perforated Intervals

From	To
6893	6895

##### Acid Volumes

12,137 GALLONS 20% HCL

##### Fracture Treatments

16,002 GALLONS 2% KCL & 19,341 GALLONS WATERFRAC G-R (24) SLICKWATER IN 3 STAGES

Formation Name: CHESTER LIME

Code: 354CRLM

Class: GAS

##### Spacing Orders

Order No	Unit Size
34971	640

##### Perforated Intervals

From	To
6918	6925
7004	7015
7075	7081
7102	7116

##### Acid Volumes

There are no Acid Volume records to display.

##### Fracture Treatments

TREATED WITH MORROW SAND

Formation Name: CHEROKEE-MORROW SAND-CHESTER LIME

Code:

Class: GAS

Formation	Top
CHEROKEE	6677

Were open hole logs run? Yes

Date last log run: February 22, 2007

MORROW SAND	6888
CHESTER LIME	6916

Were unusual drilling circumstances encountered? No  
Explanation:

<b>Other Remarks</b>
DRILL OUT CIBP FROM ORIGINAL COMPLETION. COMMINGLE ZONES.

<b>FOR COMMISSION USE ONLY</b>	
Status: Accepted	1146093

API NO. 35-059-22467  
OTC PROD. UNIT NO. 059-123357

Oil and Gas Conservation Division  
P.O. Box 52000  
Oklahoma City, OK 73152-2000  
405-522-0577  
OCCentralProcessing@OCC.OK.GOV



Form 1002A  
Rev. 2020

ORIGINAL  
AMENDED (Reason) Commingle zones

Rule 165:10-3-25

COMPLETION REPORT

TYPE OF DRILLING OPERATION

☒ STRAIGHT HOLE ☐ DIRECTIONAL HOLE ☐ HORIZONTAL HOLE  
☐ SERVICE WELL

If directional or horizontal, see reverse for bottom hole location.

COUNTY Harper SEC 14 TWP 26N RGE 24W

LEASE NAME J C Love

SE 1/4 NW 1/4 NE 1/4 NW 1/4

ELEVATION 2325' Ground

Latitude 36.7385171

Longitude -99.7577824

OPERATOR NAME Latigo Oil & Gas, Inc.

ADDRESS P.O. Box 1208

CITY Woodward STATE OK ZIP 73802

SPUD DATE 2/13/2008

DRLG FINISHED DATE 2/29/2008

DATE OF WELL COMPLETION 4/4/2008

1st PROD DATE 4/5/2008

RECOMP DATE 12/18/2020

WELL NO. 1-14

FWL 1870

OTC/OCC OPERATOR NO. 10027

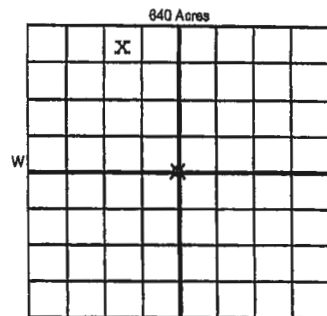

COMPLETION TYPE

☐ SINGLE ZONE  
☐ MULTIPLE ZONE  
☒ COMMINGLED  
Application Date 7/1/2020  
LOCATION EXCEPTION ORDER NO. 550643/715480  
MULTIUNIT ORDER NO.  
INCREASED DENSITY ORDER NO.

CASING & CEMENT (Attach Form 1002C)

TYPE	SIZE	WEIGHT	GRADE	FEET	PSI	SAX	TOP OF CMT
CONDUCTOR							
SURFACE	8 5/8	24/32	K-55	950		530	SURFACE
INTERMEDIATE							
PRODUCTION	4.5	11.6	N-80	7221		490	2660
LINER							

PACKER @ BRAND & TYPE PLUG @ TYPE PLUG @ TYPE TOTAL DEPTH 7221

COMPLETION & TEST DATA BY PRODUCING FORMATION 404CHRK, 402MWSD, 354CRLM

FORMATION	Cherokee	Morrow Sand	Chester Lime	Old Frac 5
SPACING & SPACING ORDER NUMBER	Unspaced 80 acres	34971 (640)	34971 (640)	
CLAS: Oil, Gas, Dry, Inj, Disp, Comm Disp, Svc	Oil Gas	Gas	Gas	
PERFORATED INTERVALS	6677-6683 6687-6692 6714-6718, 6726-6730	6893-6895'	6918-6925 7004-7015 7075-7081, 7102-7116	RECEIVED FEB 10 2021 Oklahoma Corporation Commission
ACID/VOLUME	12,348 gal 20% HCL	12,376 gal 20% HCL		
FRACTURE TREATMENT (Fluids/Prop Amounts)	See Orig 1002A	See Orig 1002A 16,002 Gals 2% HCL + 19,344 gals water 10.3 stages	See Orig 1002A	

☒ Min Gas Allowable (165:10-17-7)  
OR  
☐ Oil Allowable (165:10-13-3)

Purchaser/Measurer  
First Sales Date

DCP Midstream  
4/2/2008

INITIAL TEST DATA

INITIAL TEST DATE	1/10/2021				
OIL-BBL/DAY	2 BO				
OIL-GRAVITY (API)	42				
GAS-MCF/DAY	55 MCF				
GAS-OIL RATIO CU FT/BBL	27500				
WATER-BBL/DAY	1.67 BW				
PUMPING OR FLOWING	Pumping				
INITIAL SHUT-IN PRESSURE	200#				
CHOKE SIZE					
FLOW TUBING PRESSURE	50#				

A record of the formations drilled through, and pertinent remarks are presented on the reverse. I declare that I have knowledge of the contents of this report and am authorized by my organization to make this report, which was prepared by me or under my supervision and direction, with the data and facts stated herein to be true, correct, and complete to the best of my knowledge and belief.

SIGNATURE Ryan Barby VP-Operations  
P.O. Box 1208 Woodward OK 73802  
ADDRESS CITY STATE ZIP  
DATE 1/11/2021 PHONE NUMBER 580-258-1418  
EMAIL ADDRESS ryanb@latigooll.com

PLEASE TYPE OR USE BLACK INK ONLY  
FORMATION RECORD

Give formation names and tops, if available, or descriptions and thickness of formations drilled through. Show intervals cored or drillem tested.

NAMES OF FORMATIONS	TOP
Cherokee	6677
Morrow Sand	6888
Chester Lime	6916

LEASE NAME J C LOVE WELL NO. 1-14

FOR COMMISSION USE ONLY	
ITD on file <input type="checkbox"/> YES <input type="checkbox"/> NO	
APPROVED _____	DISAPPROVED _____
2) Reject Codes	
_____	
_____	
_____	
_____	

Were open hole logs run?	<input checked="" type="radio"/> yes <input type="radio"/> no
Date Last log was run	2-22-2008
Was CO <sub>2</sub> encountered?	<input type="radio"/> yes <input checked="" type="radio"/> no at what depths? _____
Was H <sub>2</sub> S encountered?	<input type="radio"/> yes <input checked="" type="radio"/> no at what depths? _____
Were unusual drilling circumstances encountered?	<input type="radio"/> yes <input checked="" type="radio"/> no
If yes, briefly explain below	

Other remarks: Drill out CIBP from original completion. Commingle Zones.

\_\_\_\_\_

\_\_\_\_\_

\_\_\_\_\_

\_\_\_\_\_

\_\_\_\_\_

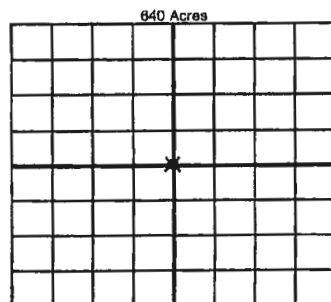

If more than three drainholes are proposed, attach a separate sheet indicating the necessary information.

Direction must be stated in degrees azimuth. Please note, the horizontal drainhole and its end point must be located within the boundaries of the lease or spacing unit.

Directional surveys are required for all drainholes and directional wells

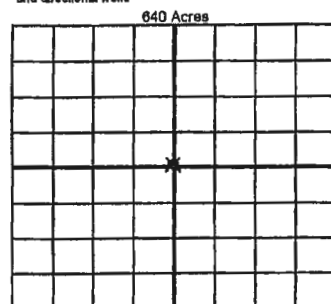

BOTTOM HOLE LOCATION FOR DIRECTIONAL HOLE

SEC	TWP	RGE	COUNTY
1/4	1/4	1/4	1/4
Measured Total Depth		True Vertical Depth	BHL From Lease, Unit, or Property Line:

BOTTOM HOLE LOCATION FOR HORIZONTAL HOLE: (LATERALS)

LATERAL #1			
SEC	TWP	RGE	COUNTY
1/4	1/4	1/4	1/4
Depth of Deviation		Radius of Turn	Direction
Measured Total Depth		True Vertical Depth	Total Length
BHL From Lease, Unit, or Property Line:			

LATERAL #2			
SEC	TWP	RGE	COUNTY
1/4	1/4	1/4	1/4
Depth of Deviation		Radius of Turn	Direction
Measured Total Depth		True Vertical Depth	Total Length
BHL From Lease, Unit, or Property Line:			

LATERAL #3			
SEC	TWP	RGE	COUNTY
1/4	1/4	1/4	1/4
Depth of Deviation		Radius of Turn	Direction
Measured Total Depth		True Vertical Depth	Total Length
BHL From Lease, Unit, or Property Line:			

API NO. 35-059-22467  
OTC PROD. UNIT NO. 059-123357

Oil and Gas Conservation Division  
P.O. Box 52000  
Oklahoma City, OK 73152-2000  
405-522-0577  
OCCCentralProcessing@OCC.OK.GOV



OKLAHOMA  
Corporation  
Commission

Form 1002A  
Rev. 2020

A: 123357 I



ORIGINAL  
AMENDED (Reason)

Commingle zones

Rule 165:10-3-25

COMPLETION REPORT

1002A

Addendum

TYPE OF DRILLING OPERATION

☒ STRAIGHT HOLE ☐ DIRECTIONAL HOLE ☐ HORIZONTAL HOLE  
☐ SERVICE WELL

If directional or horizontal, see reverse for bottom hole location.

COUNTY Harper SEC 14 TWP 26N RGE 24W

LEASE NAME J C Love

SE 1/4 NW 1/4 NE 1/4 NW 1/4

ELEVATION 2325' Ground

Latitude 36.7385171

Longitude -99.7577824

OPERATOR NAME Latigo Oil & Gas, Inc.

OTC/OCC OPERATOR NO. 10027

ADDRESS P.O. Box 1208

CITY Woodward

STATE OK

ZIP 73802

SPUD DATE 2/13/2008

DRLG FINISHED DATE 2/29/2008

DATE OF WELL COMPLETION 4/4/2008

1st PROD DATE 4/5/2008

RECOMP DATE 12/18/2020

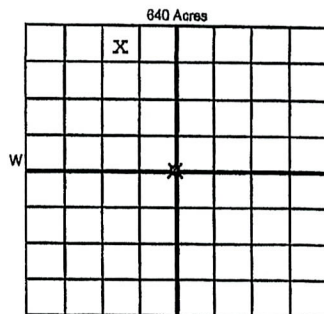

LOCATE WELL

COMPLETION TYPE

☐ SINGLE ZONE  
☐ MULTIPLE ZONE  
☒ COMMINGLED  
Application Date 7/1/2020  
LOCATION EXCEPTION ORDER NO. 550643/715680  
MULTIUNIT ORDER NO.  
INCREASED DENSITY ORDER NO.

CASING & CEMENT (Attach Form 1002C)

TYPE	SIZE	WEIGHT	GRADE	FEET	PSI	SAX	TOP OF CMT
CONDUCTOR							
SURFACE	8 5/8	24/32	K-55	950		530	SURFACE
INTERMEDIATE							
PRODUCTION	4.5	11.6	N-80	7221		490	2660
LINER							

PACKER @ BRAND & TYPE

PLUG @ TYPE

PLUG @ TYPE

TOTAL DEPTH 7221

COMPLETION & TEST DATA BY PRODUCING FORMATION

FORMATION	Cherokee	Morrow Sand	Chester Lime		
SPACING & SPACING ORDER NUMBER	Unspaced 80 acres	34971 (640)	34971 (640)		
CLASS: Oil, Gas, Dry, Inj, Disp, Comm Disp, Svc	Oil Gas	Gas	Gas		
PERFORATED INTERVALS	6677-6683	6893-6895	6918-6925		
	6687-6692		7004-7015		
	6714-6718, 6726-6730		7075-7081, 7102-7110		
ACID/VOLUME	12,348 gal 120% HCL	12137 gal 20% HCL			
FRACTURE TREATMENT (Fluids/Prop Amounts)	See Orig 1002A	See Orig 1002A	See Orig 1002A		



Min Gas Allowable (165:10-17-7)  
OR  
Oil Allowable (165:10-13-3)

Purchaser/Measurer  
First Sales Date

DCP Midstream  
4/5/2008

INITIAL TEST DATA

INITIAL TEST DATE	1/10/2021				
OIL-BBL/DAY	2 BO				
OIL-GRAVITY ( API)	42				
GAS-MCF/DAY	55 MCF				
GAS-OIL RATIO CU FT/BBL	27500				
WATER-BBL/DAY	1.67 BW				
PUMPING OR FLOWING	Pumping				
INITIAL SHUT-IN PRESSURE	200#				
CHOKE SIZE					
FLOW TUBING PRESSURE	50#				

A record of the formations drilled through, and pertinent remarks are presented on the reverse. I declare that I have knowledge of the contents of this report and am authorized by my organization to make this report, which was prepared by me or under my supervision and direction, with the data and facts stated herein to be true, correct, and complete to the best of my knowledge and belief.

SIGNATURE  
P.O. Box 1208

Woodward OK 73802  
CITY STATE ZIP

1/11/2021 580-258-1416  
DATE PHONE NUMBER  
ryanb@latigooil.com  
EMAIL ADDRESS