

Oklahoma Corporation Commission
Oil & Gas Conservation Division
Post Office Box 52000
Oklahoma City, Oklahoma 73152-2000
Rule 165: 10-3-25

Form 1002A

API No.: 35059203100003

Completion Report

Spud Date: December 15, 1972

OTC Prod. Unit No.: 059-045548-0-0000

Drilling Finished Date: December 31, 1972

Amended

1st Prod Date: January 12, 1973

Amend Reason: COMMINGLE ZONES

Completion Date: January 25, 1973

Recomplete Date: January 13, 2021

Drill Type: STRAIGHT HOLE

Min Gas Allowable: Yes

Well Name: FREEMAN 1-6

Purchaser/Measurer: ENERGY TRANSFER

Location: HARPER 6 27N 25W
C SE NW
660 FSL 1980 FWL of 1/4 SEC
Latitude: 36.8503853 Longitude: -99.9382605
Derrick Elevation: 2213 Ground Elevation: 2203

First Sales Date: 01/12/1973

Operator: LATIGO OIL AND GAS INC 10027
PO BOX 1208
5815 OKLAHOMA AVE
WOODWARD, OK 73802-1208

Completion Type		Location Exception		Increased Density	
	Single Zone	Order No		Order No	
	Multiple Zone	There are no Location Exception records to display.		There are no Increased Density records to display.	
X	Commingled				

Casing and Cement							
Type	Size	Weight	Grade	Feet	PSI	SAX	Top of CMT
SURFACE	8 5/8	32	J-55	751		650	SURFACE
PRODUCTION	4.5	11.6 / 10.5 / 9.5	K-55	6770		250	5870

Liner								
Type	Size	Weight	Grade	Length	PSI	SAX	Top Depth	Bottom Depth
There are no Liner records to display.								

Total Depth: 6770

Packer	
Depth	Brand & Type
There are no Packer records to display.	

Plug	
Depth	Plug Type
There are no Plug records to display.	

Initial Test Data

Test Date	Formation	Oil BBL/Day	Oil-Gravity (API)	Gas MCF/Day	Gas-Oil Ratio Cu FT/BBL	Water BBL/Day	Pumpin or Flowing	Initial Shut-In Pressure	Choke Size	Flow Tubing Pressure
Jan 24, 2021	CHEROKEE GROUP-MORROW SAND-CHESTER LIME	2	40	37	18500		PUMPING	100		10

Completion and Test Data by Producing Formation

Formation Name: CHEROKEE GROUP

Code: 404CHRG

Class: GAS

Spacing Orders		Perforated Intervals	
Order No	Unit Size	From	To
544570	640	6304	6311
		6320	6326
Acid Volumes		Fracture Treatments	
4,995 GALLONS 15% HCL		14,990 GALLONS 2% KCL NITROGEN (N2), 619,241 SCF	

Formation Name: MORROW SAND

Code: 402MWSD

Class: GAS

Spacing Orders		Perforated Intervals	
Order No	Unit Size	From	To
39174	640	6526	6532
Acid Volumes		Fracture Treatments	
NONE		26,000 GALLONS FLUID, REFRAC 25,000 POUNDS SAND, 160,500 SCF N2, 50% CO2	

Formation Name: CHESTER LIME

Code: 354CRLM

Class: GAS

Spacing Orders		Perforated Intervals	
Order No	Unit Size	From	To
52944	640	6615	6618
		6639	6645
		6670	6676
Acid Volumes		Fracture Treatments	
1,000 GALLONS		25,000 GALLONS FLUID, REFRAC 22,250 POUNDS 20/40 SAND, 1,200 POUNDS 100 MESH SAND, 137,000 SCF N2, 37 TONS CO2 TOTAL FLUID 224 BARRELS	

Formation Name: CHEROKEE GROUP-MORROW SAND-CHESTER LIME

Code:

Class: GAS

Formation	Top
CHEROKEE	6304
MORROW SAND	6526

Were open hole logs run? Yes

Date last log run: December 31, 1971

Were unusual drilling circumstances encountered? No

CHESTER LIME	6615
--------------	------

Explanation:

Other Remarks
DRILL UP AND PUSH CIBP REMNANTS TO 6,564'. CHESTER, MORROW AND CHEROKEE COMMINGLED AND PUT ON PUMP. COMMINGLE APPLICATION APPROVED PER EMAIL FROM SAMIR ALWAZZI ON JANUARY 13, 2021.

FOR COMMISSION USE ONLY	
Status: Accepted	1146095

API NO. 35-059-20310
OTC PROD. UNIT NO. 059-045548

Oil and Gas Conservation Division
P.O. Box 52000
Oklahoma City, OK 73152-2000
405-522-0577
OCCCentralProcessing@OCC.OK.GOV



OKLAHOMA
Corporation
Commission

Form 1002A
Rev. 2020



ORIGINAL
AMENDED (Reason)

Commingling zones

Rule 165:10-3-25

COMPLETION REPORT

TYPE OF DRILLING OPERATION

☒ STRAIGHT HOLE ☐ DIRECTIONAL HOLE ☐ HORIZONTAL HOLE
☐ SERVICE WELL

If directional or horizontal, see reverse for bottom hole location.

COUNTY	Harper	SEC	6	TWP	27N	RGE	25W
LEASE NAME	Freeman	WELL NO.	1-6	DATE OF WELL COMPLETION	1/25/1973	1st PROD DATE	1/12/1973
1/4 C 1/4 se 1/4 nw 1/4	FWL	1980	FWL	1980	RECOMP DATE	1/13/2021	
ELEVATION Derrick FL	2213	Ground	2203	Latitude	36.8503653	Longitude	-99.9382605
OPERATOR NAME	Latigo Oil & Gas, Inc.	OTC / OCC OPERATOR NO.	10027				
ADDRESS	P.O. Box 1208						
CITY	Woodward	STATE	OK	ZIP	73802		

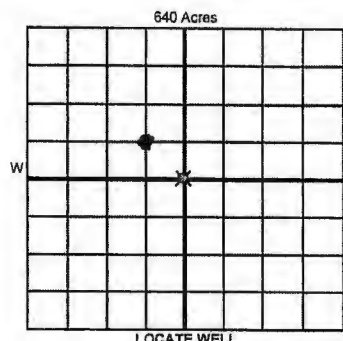

COMPLETION TYPE

<input type="radio"/> SINGLE ZONE	
<input type="radio"/> MULTIPLE ZONE	
<input checked="" type="radio"/> COMMINGLED	12/31/2020
LOCATION EXCEPTION ORDER NO.	
MULTIUNIT ORDER NO.	
INCREASED DENSITY ORDER NO.	

CASING & CEMENT (Attach Form 1002G)

TYPE	SIZE	WEIGHT	GRADE	FEET	PSI	SAX	TOP OF CMT
CONDUCTOR							
SURFACE	8 5/8	32	J-55	751		650	SURFACE
INTERMEDIATE							
PRODUCTION	4.5	11.6, 10.5, 9.5	K-55	6770		250	5870 5870
LINER							

PACKER @ BRAND & TYPE PLUG @ TYPE PLUG @ TYPE TOTAL DEPTH 6770

COMPLETION & TEST DATA BY PRODUCING FORMATION 404CHRG6P / 402MWSO / 354CRLM

FORMATION	Cherokee Group	Morrow Sand	Chester Lime	Old Fm
SPACING & SPACING ORDER NUMBER	544570-05323 (640)	39174 (640)	52944 (640)	
CLASS: Oil, Gas, Dry, Inj, Disp, Comm Disp, Svc	Gas	Gas	Gas	
PERFORATED INTERVALS	6304-6311	6526-32	6615-6618	
	6320-6326		6639-6645	
			6670-6676	
ACID/VOLUME	4995 gals 15% HCL	none	1000 gals	
FRACTURE TREATMENT (Fluids/Prop Amounts)	See Orig 1002A 14,990 gals 2% KCL Nitrogen (N2) 619,241 scf	See Orig 1002A 26,000 gals Fluid Refrac 25,000 lbs sand, 16,050	See Orig 1002A 25,000 gals Fluid Refrac 22,250 lbs 137,000 scf N2 37 tons CO2 + total fluid 224 bbls	

Min Gas Allowable (165:10-17-7) OR Oil Allowable (165:10-13-3) Purchaser/Measurer First Sales Date Energy Transfer 1/12/1973

INITIAL TEST DATA

INITIAL TEST DATE	1/24/2021				
OIL-BBL/DAY	2 BO				
OIL-GRAVITY (API)	40				
GAS-MCF/DAY	37 MCF				
GAS-OIL RATIO CU FT/BBL	18500				
WATER-BBL/DAY	0 BW				
PUMPING OR FLOWING	Pumping				
INITIAL SHUT-IN PRESSURE	100#				
CHOKE SIZE					
FLOW TUBING PRESSURE	10#				

A record of the formations drilled through, and pertinent remarks are presented on the reverse. I declare that I have knowledge of the contents of this report and am authorized by my organization to make this report, which was prepared by me or under my supervision and direction, with the data and facts stated herein to be true, correct, and complete to the best of my knowledge and belief.

SIGNATURE Ryan Barby VP-Operations 2/8/2021 580-256-1416
P.O. Box 1208 Woodward OK 73802 DATE PHONE NUMBER
ADDRESS CITY STATE ZIP EMAIL ADDRESS ryanb@latigooil.com

PLEASE TYPE OR USE BLACK INK ONLY

FORMATION RECORD

Give formation names and tops, if available, or descriptions and thickness of formations drilled through. Show intervals cored or drillstem tested.

NAMES OF FORMATIONS	TOP
Cherokee	6304
Morrow Sand	6526
Chester Lime	6615

LEASE NAME _____ FREEMAN WELL NO. _____ 1-8

FOR COMMISSION USE ONLY	
ITD on file <input type="checkbox"/> YES <input type="checkbox"/> NO	
APPROVED _____ DISAPPROVED _____	2) Reject Codes _____

Were open hole logs run?	<input checked="" type="radio"/> yes <input type="radio"/> no
Date Last log was run	12/31/1972
Was CO ₂ encountered?	<input type="radio"/> yes <input checked="" type="radio"/> no at what depths? _____
Was H ₂ S encountered?	<input type="radio"/> yes <input checked="" type="radio"/> no at what depths? _____
Were unusual drilling circumstances encountered?	<input type="radio"/> yes <input checked="" type="radio"/> no
If yes, briefly explain below _____	

Other remarks: Drill up and push CIBP remnants to 6564'. Chester, Morrow and Cherokee commingled and put on pump.

Commingled application approved per email from Samir Alwazzi on 1/13/2021

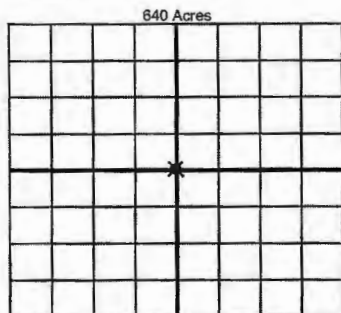

If more than three drainholes are proposed, attach a separate sheet indicating the necessary information.

Direction must be stated in degrees azimuth. Please note, the horizontal drainhole and its end point must be located within the boundaries of the lease or spacing unit.

Directional surveys are required for all drainholes and directional wells

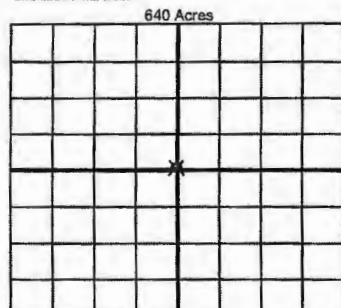

BOTTOM HOLE LOCATION FOR DIRECTIONAL HOLE

SEC	TWP	RGE	COUNTY
1/4	1/4	1/4	1/4
Measured Total Depth		True Vertical Depth	BHL From Lease, Unit, or Property Line: _____

BOTTOM HOLE LOCATION FOR HORIZONTAL HOLE: (LATERALS)

LATERAL #1			
SEC	TWP	RGE	COUNTY
1/4	1/4	1/4	1/4
Depth of Deviation		Radius of Turn	Direction
Measured Total Depth		True Vertical Depth	BHL From Lease, Unit, or Property Line: _____

LATERAL #2			
SEC	TWP	RGE	COUNTY
1/4	1/4	1/4	1/4
Depth of Deviation		Radius of Turn	Direction
Measured Total Depth		True Vertical Depth	BHL From Lease, Unit, or Property Line: _____

LATERAL #3			
SEC	TWP	RGE	COUNTY
1/4	1/4	1/4	1/4
Depth of Deviation		Radius of Turn	Direction
Measured Total Depth		True Vertical Depth	BHL From Lease, Unit, or Property Line: _____

API NO. 35-059-20310
OTC PROD. UNIT NO. 059-045548

Oil and Gas Conservation Division
P.O. Box 52000
Oklahoma City, OK 73152-2000
405-522-0577
OCCCentralProcessing@OCC.OK.GOV



OKLAHOMA
Corporation
Commission

Form 1002A
Rev. 2020

A: 097207 S



ORIGINAL
AMENDED (Reason)

Commingling zones

Rule 165:10-3-25

COMPLETION REPORT

TYPE OF DRILLING OPERATION

☒ STRAIGHT HOLE ☐ DIRECTIONAL HOLE ☐ HORIZONTAL HOLE
☐ SERVICE WELL

If directional or horizontal, see reverse for bottom hole location.

COUNTY	Harper	SEC	6	TWP	27N	RGE	25W
LEASE NAME	Freeman	WELL NO.	1-6	DATE OF WELL COMPLETION	1/25/1973	1st PROD DATE	1/12/1973
1/4 C 1/4 se 1/4 nw 1/4 FSL 660 FNL 1980	FWL	1980	RECOMP DATE	1/13/2021	Longitude	-99.9382605	
ELEVATION Derrick FL	2213	Ground	2203	Latitude	36.8503653		
OPERATOR NAME	Latigo Oil & Gas, Inc.	OTC / OCC OPERATOR NO.	10027				
ADDRESS	P.O. Box 1208						
CITY	Woodward	STATE	OK	ZIP	73802		

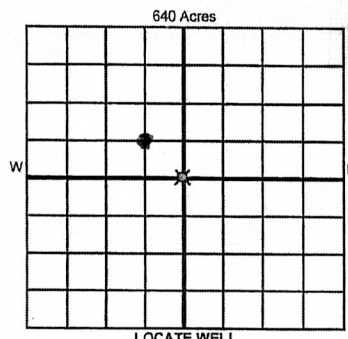

1002A
Addendum

COMPLETION TYPE

<input type="radio"/> SINGLE ZONE	
<input type="radio"/> MULTIPLE ZONE	
<input type="radio"/> COMMINGLED	12/31/2020
LOCATION EXCEPTION ORDER NO.	
MULTIUNIT ORDER NO.	
INCREASED DENSITY ORDER NO.	

CASING & CEMENT (Attach Form 1002C)

TYPE	SIZE	WEIGHT	GRADE	FEET	PSI	SAX	TOP OF CMT
CONDUCTOR							
SURFACE	8 5/8	32	J-55	751		650	SURFACE
INTERMEDIATE							
PRODUCTION	4.5	11.6, 10.5, 9.5	K-55	6770		250	5870 5870
LINER							

PACKER @ BRAND & TYPE PLUG @ TYPE PLUG @ TYPE PLUG @ TYPE
PACKER @ BRAND & TYPE PLUG @ TYPE PLUG @ TYPE PLUG @ TYPE
TOTAL DEPTH 6770

COMPLETION & TEST DATA BY PRODUCING FORMATION

FORMATION	Cherokee Group	Morrow Sand	Chester Lime	Old Face
SPACING & SPACING ORDER NUMBER	544570-05323 (640)	39174 (640)	52944 (640)	
CLASS: Oil, Gas, Dry, Inj, Disp, Comm Disp, Svc	Gas	Gas	Gas	
PERFORATED INTERVALS	6304-6311 6320-6326	6526-32	6615-6618 6639-6645 6670-6676	
ACID/VOLUME	4995 gals 15% HCL	none	1000 gals	
FRACTURE TREATMENT (Fluids/Prop Amounts)	See Orig 1002A 14,990 gals 2% KCL Nitrogen (N ₂) 619,241 scf	See Orig 1002A 26,000 gals Fluid Refrac 25,000 lbs sand, 11,050	See Orig 1002A 25,000 gals Fluid Refrac 22,250 lbs 137,000 scf N ₂ 37 tons CO ₂ total Fluid 224 bbls	

Min Gas Allowable (165:10-17-7)



OR

Oil Allowable (165:10-13-3)

Purchaser/Measurer

First Sales Date

Energy Transfer

1/12/1973

INITIAL TEST DATA

INITIAL TEST DATE	1/24/2021				
OIL-BBL/DAY	2 BO				
OIL-GRAVITY (API)	40				
GAS-MCF/DAY	37 MCF				
GAS-OIL RATIO CU FT/BBL	18500				
WATER-BBL/DAY	0 BW				
PUMPING OR FLOWING	Pumping				
INITIAL SHUT-IN PRESSURE	100#				
CHOKE SIZE					
FLOW TUBING PRESSURE	10#				

A record of the formations drilled through, and pertinent remarks are presented on the reverse. I declare that I have knowledge of the contents of this report and am authorized by my organization to make this report, which was prepared by me or under my supervision and direction, with the data and facts stated herein to be true, correct, and complete to the best of my knowledge and belief.

SIGNATURE	Ryan Barby VP-Operations	2/8/2021	580-256-1416
P.O. Box 1208	NAME (PRINT OR TYPE)	DATE	PHONE NUMBER
ADDRESS	Woodward OK 73802	ryanb@latigoil.com	
CITY	STATE	ZIP	EMAIL ADDRESS