

Oklahoma Corporation Commission
Oil & Gas Conservation Division
Post Office Box 52000
Oklahoma City, Oklahoma 73152-2000
Rule 165: 10-3-25

Form 1002A

API No.: 35011241340000

Completion Report

Spud Date: December 13, 2018

OTC Prod. Unit No.: 043-224316-0-0000

Drilling Finished Date: February 08, 2019

1st Prod Date: May 04, 2019

Completion Date: May 04, 2019

Drill Type: HORIZONTAL HOLE

Min Gas Allowable: Yes

Well Name: ACRE FEDERAL 5-32-1XH

Purchaser/Measurer: ONEOK

Location: BLAINE 8 18N 13W
SW NE NW NW
475 FNL 885 FWL of 1/4 SEC
Latitude: 36.05651991 Longitude: -98.615861134
Derrick Elevation: 1697 Ground Elevation: 1690

First Sales Date: 05/04/2019

Operator: DERBY EXPLORATION LLC 24143
PO BOX 779
100 PARK AVE STE 400
OKLAHOMA CITY, OK 73101-0779

Completion Type		Location Exception		Increased Density	
X	Single Zone	Order No		Order No	
	Multiple Zone	690018		There are no Increased Density records to display.	
	Commingled				

Casing and Cement							
Type	Size	Weight	Grade	Feet	PSI	SAX	Top of CMT
SURFACE	13.375	54.5	J-55	400		381	SURFACE
INTERMEDIATE	9.625	40	P-110	8456		770	4049
PRODUCTION	5.5	23	P-110	20230		3252	5386

Liner								
Type	Size	Weight	Grade	Length	PSI	SAX	Top Depth	Bottom Depth
There are no Liner records to display.								

Total Depth: 20230

Packer		Plug	
Depth	Brand & Type	Depth	Plug Type
There are no Packer records to display.		There are no Plug records to display.	

Initial Test Data

Test Date	Formation	Oil BBL/Day	Oil-Gravity (API)	Gas MCF/Day	Gas-Oil Ratio Cu FT/BBL	Water BBL/Day	Pumpin or Flowing	Initial Shut-In Pressure	Choke Size	Flow Tubing Pressure
May 31, 2019	MISSISSIPPIAN	352	52	3879	11020	605	FLOWING		24/64	

Completion and Test Data by Producing Formation

Formation Name: MISSISSIPPIAN

Code: 359MSSP

Class: OIL

Spacing Orders

Order No	Unit Size
687005	640
687347	640
690447	MULTIUNIT

Perforated Intervals

From	To
10140	20132

Acid Volumes

164,068 GALLONS 15% HCL

Fracture Treatments

15,953,720 POUNDS 40/70 PROPPANT, 17,705,100 GALLONS SLICKWATER

Formation	Top
HOGSHOOTER	7475
CHECKERBOARD	7742
BIG LIME	7925
VERDIGRIS	8184
INOLA	8443
ATOKA	8547

Were open hole logs run? No

Date last log run:

Were unusual drilling circumstances encountered? No

Explanation:

Other Remarks

OCC - THIS DOCUMENT IS ACCEPTED BASED ON THE DATA SUBMITTED NEITHER THE FINAL LOCATION EXCEPTION NOR THE FINAL MULTIUNIT ORDERS HAVE BEEN ISSUED.

Lateral Holes

Sec: 32 TWP: 19N RGE: 13W County: BLAINE

SE NW NW NW

344 FNL 429 FWL of 1/4 SEC

Depth of Deviation: 8600 Radius of Turn: 575 Direction: 1 Total Length: 11055

Measured Total Depth: 20230 True Vertical Depth: 9442 End Pt. Location From Release, Unit or Property Line: 344

FOR COMMISSION USE ONLY

1143474

Status: Accepted

(PLEASE TYPE OR USE BLACK INK ONLY)

OKLAHOMA CORPORATION COMMISSION

Oil & Gas Conservation Division

Post Office Box 52000

Oklahoma City, Oklahoma 73152-2000

Rule 165:10-3-25

COMPLETION REPORT

<input checked="" type="checkbox"/>	ORIGINAL
<input type="checkbox"/>	AMENDED (Reason)

TYPE OF DRILLING OPERATION

☐ STRAIGHT HOLE ☐ DIRECTIONAL HOLE ☒ HORIZONTAL HOLE

If directional or horizontal, see reverse for bottom hole location.

COUNTY	Blaine	SEC	8	TWP	18N	RGE	13W	DATE OF WELL COMPLETION	05/04/2019
LEASE NAME	ACRE FEDERAL					WELL NO.	5-32-1XH	1st PROD DATE	05/04/2019
SW 1/4		NE 1/4		NW 1/4		N 1/4		FNL OF 1/4 SEC	475
SW 1/4		NE 1/4		NW 1/4		N 1/4		FWL OF 1/4 SEC	885
ELEVATION		Derrick FL		1697		Ground		1690	
Latitude (if known)		36.08651991		Longitude (if known)		-98.61586134			
OPERATOR NAME		Derby Exploration, LLC					OTC/OCC OPERATOR NO.		24143 0
ADDRESS		P.O. Box 779							
CITY		OKC		STATE		OK		ZIP 73101-0779	

640 Acres

W

X

8

LOCATE WELL

COMPLETION TYPE

X	SINGLE ZONE	
	MULTIPLE ZONE	
	Application Date	I.O.
	COMMINGLED	
	Application Date	690018
LOCATION EXCEPTION		201806186
ORDER NO.		
INCREASED DENSITY		
ORDER NO.		

CASING & CEMENT (Form 1002C must be attached)

TYPE	SIZE	WEIGHT	GRADE	FEET	PSI	SAX	TOP OF CMT
CONDUCTOR							
SURFACE	13 375	54.5	J55	400		381	surface
INTERMEDIATE	9.625	40	P 110	8,456		770	4,407
PRODUCTION	5.5	23	P110	20,230		3,252	5,386
LINER							

PACKER @ _____ BRAND & TYPE _____ PLUG @ _____ TYPE _____ PLUG @ _____ TYPE _____
 PACKER @ _____ BRAND & TYPE _____ PLUG @ _____ TYPE _____ PLUG @ _____ TYPE _____

TOTAL DEPTH	20,230
-------------	--------

COMPLETION & TEST DATA BY PRODUCING FORMATION

FORMATION	Mississippian	5	32		Reported / 7
SPACING & SPACING ORDER NUMBER	201806197 (B40MU)	687005(640)	687347(640)		Frac Focus
CLASS: Oil, Gas, Dry, Inj, Disp, Comm Disp, Svc	Oil				
PERFORATED INTERVALS	10140	15264			
	15300	20132			
ACID/VOLUME	15% HCl:	164,068 gals			
FRACTURE TREATMENT (Fluids/Prop Amounts)	40/70 Proppant:	15,953,720 lbs			
	Slickwater:	17,705,100 gals			

Min Gas Allowable (165:10-17-7)

Gas Purchaser/Measurer

First Sales Date

~~See~~ One OK

5/4/19

INITIAL TEST DATA

Oil Allowable (165:10-13-3)

INITIAL TEST DATE	5/31/2019					
OIL-BBL/DAY	352					
OIL-GRAVITY (API)	52					
GAS-MCF/DAY	3879					
GAS-OIL RATIO CU FT/BBL	41.020 11020					
WATER-BBL/DAY	605					
PUMPING OR FLOWING	Flowing					
INITIAL SHUT-IN PRESSURE						
CHOKE SIZE	24/64					
FLOW TUBING PRESSURE						

AS SUBMITTED

A record of the formations drilled through, and pertinent remarks are presented on the reverse. I declare that I have knowledge of the contents of this report and am authorized by my organization to make this report, which was prepared by me or under my supervision and direction, with the data and facts stated herein to be true, correct, and complete to the best of my knowledge and belief.

Shelley Kennedy
SIGNATURE

Shellee Kennedy
NAME (PRINT OR TYPE)

6/26/19 405-202-4535
DATE PHONE NUMBER

P.O. Box 779

OKC

OK 73101

skennedy@derbyenergy.com

ADDRESS

CITY

STATE

ZIP

EMAIL ADDRESS

Give formation names and tops, if available, or descriptions and thickness of formations drilled through. Show intervals cored or drillstem tested.

FOR COMMISSION USE ONLY		
ITD on file	<input type="checkbox"/> YES	<input type="checkbox"/> NO
APPROVED	DISAPPROVED	2) Reject Codes

Were open hole logs run?	___ yes	<u>X</u> no	
Date Last log was run	_____		
Was CO ₂ encountered?	___ yes	<u>X</u> no	at what depths? _____
Was H ₂ S encountered?	___ yes	<u>X</u> no	at what depths? _____
Were unusual drilling circumstances encountered?	___ yes	<u>X</u> no	
If yes, briefly explain below			

Other remarks:

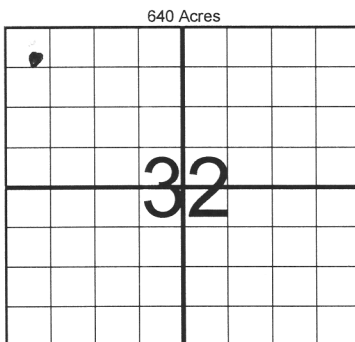

Direction must be stated in degrees azimuth.
Please note, the horizontal drainhole and its end point must be located within the boundaries of the lease or spacing unit.

640 Acres

SEC 32	TWP 19N	RGE 13W	COUNTY Blaine
Spot Location	1/4 NW 1/4 NW 1/4	Feet From 1/4 Sec Lines	FNL 344 FWL 429
Measured Total Depth	20230	True Vertical Depth	9442
		BHL From Lease, Unit, or Property Line:	
		344 FNL	

LATERAL #1											
SEC	32	TWP	19N	RGE	13W	COUNTY	Blaine				
Spot Location	SE	1/4	NW	1/4	NW	SE	1/4	Feet From 1/4 Sec Lines	EST 344	FWL 429	
Depth of Deviation	8600			Radius of Turn	575			Direction	1	Total Length	11,055
Measured Total Depth	30230			True Vertical Depth	9442			BHL From Lease, Unit, or Property Line:	344		

INTERNAL #2							
SEC	TWP	RGE	COUNTY				
Spot Location				Feet From 1/4 Sec Lines		FSL	FWL
1/4	1/4	1/4	1/4				
Depth of Deviation		Radius of Turn		Direction		Total Length	
Measured Total Depth		True Vertical Depth		BHL From Lease, Unit, or Property Line:			

LATERAL #3						
SEC	TWP	RGE	COUNTY			
Spot Location				Feet From 1/4 Sec Lines	FSL	FWL
1/4	1/4	1/4	1/4			
Depth of Deviation		Radius of Turn	Direction	Total Length		
Measured Total Depth		True Vertical Depth	BHL From Lease, Unit, or Property Line:			