

Oklahoma Corporation Commission
Oil & Gas Conservation Division
Post Office Box 52000
Oklahoma City, Oklahoma 73152-2000
Rule 165: 10-3-25

Form 1002A

API No.: 35071016200002

Completion Report

Spud Date: May 05, 1956

OTC Prod. Unit No.:

Drilling Finished Date: May 20, 1956

Amended

1st Prod Date:

Amend Reason: PLUGGED AND ABANDONED

Completion Date: June 26, 1956

Recomplete Date: November 18, 2019

Drill Type: STRAIGHT HOLE

Well Name: JOHN CAUGHLIN B 1

Purchaser/Measurer:

Location: KAY 30 25N 1E
C NW SE NW
990 FSL 1650 FWL of 1/4 SEC
Latitude: 36.617946 Longitude: -97.24102
Derrick Elevation: 0 Ground Elevation: 940

First Sales Date:

Operator: CITATION OIL & GAS CORPORATION 14156

14077 CUTTEN RD
HOUSTON, TX 77069-2212

Completion Type	
	Single Zone
	Multiple Zone
	Commingled

Location Exception	
Order No	
There are no Location Exception records to display.	

Increased Density	
Order No	
There are no Increased Density records to display.	

Casing and Cement							
Type	Size	Weight	Grade	Feet	PSI	SAX	Top of CMT
SURFACE	10.75		H-40	196		200	SURFACE
PRODUCTION	5.5		J-55	4350		50	4056

Liner								
Type	Size	Weight	Grade	Length	PSI	SAX	Top Depth	Bottom Depth
There are no Liner records to display.								

Total Depth: 4350

Packer	
Depth	Brand & Type
There are no Packer records to display.	

Plug	
Depth	Plug Type
320	CEMENT
750	CEMENT
2390	CEMENT
2914	CIBP
3450	CIBP

Initial Test Data										
Test Date	Formation	Oil BBL/Day	Oil-Gravity (API)	Gas MCF/Day	Gas-Oil Ratio Cu FT/BBL	Water BBL/Day	Pumpin or Flowing	Initial Shut-In Pressure	Choke Size	Flow Tubing Pressure
There are no Initial Data records to display.										

Completion and Test Data by Producing Formation									
Formation Name: TONKAWA				Code: 406TNKW			Class: PLUG AND ABANDON		
Spacing Orders				Perforated Intervals					
Order No		Unit Size		From			To		
There are no Spacing Order records to display.				2566			3701		
Acid Volumes				Fracture Treatments					
N/A				N/A					

Formation	Top
TONKAWA	2564

Were open hole logs run? No

Date last log run:

Were unusual drilling circumstances encountered? No

Explanation:

Other Remarks
CAUGHLIN B 1 WAS PLUGGED AND ABANDONED ON NOVEMBER 18, 2019. 1003 FILED DECEMBER 11, 2019. OCC - ORIGINAL 1002A SHOWS WELL BLEW OUT AT 592', WAS KILLED WITH WEIGHTED MUD, AFTER CEMENTING AT BOTTOM OF HOLE. WELL WAS PERFORATED AND SQUEEZED AT 3,700' - 3,701' WITH 125 SACKS CEMENT, TOP CEMENT AT 2,886'. THEN PERFORATED AT 2,750' - 2,751' WITH 100 SACKS CEMENT, TOP CEMENT AT 2,550'.

FOR COMMISSION USE ONLY
<div>Status: Accepted</div> <div>1145082</div>

11-3-98

API
NO. 3507101620
OTC PROD.
UNIT NO.

(PLEASE TYPE OR USE BLACK INK ONLY)

OKLAHOMA CORPORATION COMMISSION
Oil & Gas Conservation Division
Post Office Box 52000
Oklahoma City, Oklahoma 73152-2000
Rule 165:10-3-25

Form 1002A
Rev. 2009

☐ ORIGINAL
☒ AMENDED (Reason) PLUG AND ABANDON

TYPE OF DRILLING OPERATION

☒ STRAIGHT HOLE ☐ DIRECTIONAL HOLE ☐ HORIZONTAL HOLE
☐ SERVICE WELL

If directional or horizontal, see reverse for bottom hole location.

COUNTY KAY	SEC 30	TWP 25N	RGE 1E	SPUD DATE 5-5-1956
LEASE CAUGHLIN B	WELL NO. 1	DATE OF WELL COMPLETION NA 6-26-1956		
1/4 NW 1/4 SE 1/4 NW 1/4	FSL OF 1/4 SEC 990	FWL OF 1/4 SEC 1650	1st PROD DATE NA	
ELEVATION Derrick FL	Ground 940	Latitude (if known) 36.617946	Longitude (if known) -97.24102	
OPERATOR NAME	Citation Oil & Gas Corp.		OTC / OCC OPERATOR NO. 14156	
ADDRESS 14077 Cutten Rd				
CITY Houston	STATE Texas	ZIP 77069-2212		

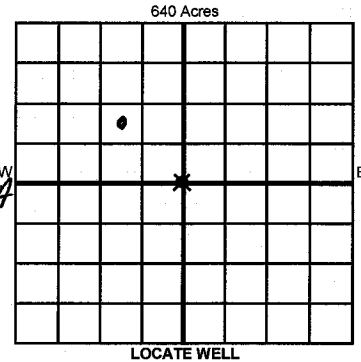

COMPLETION TYPE

SINGLE ZONE	TOKAWA
MULTIPLE ZONE	
Application Date	
COMMINGLED	
Application Date	
LOCATION EXCEPTION ORDER NO.	
INCREASED DENSITY ORDER NO.	

CASING & CEMENT (Attach Form 1002C)

TYPE	SIZE	WEIGHT	GRADE	FEET	PSI	SAX	TOP OF CMT
CONDUCTOR							
SURFACE	10.75		H40	196		200	surface
INTERMEDIATE							
PRODUCTION	5.5		J55	4350		50	4056
LINER							
						TOTAL DEPTH	4350

PACKER @ NA BRAND & TYPE NA PLUG @ 2914 TYPE CIBP PLUG @ 2390 TYPE Cement
 PACKER @ BRAND & TYPE PLUG @ 3950 TYPE CIBP PLUG @ 250 TYPE cement
 COMPLETION & TEST DATA BY PRODUCING FORMATION 406 TNKW 320 - cement

FORMATION	Tonkawa					
SPACING & SPACING ORDER NUMBER						
CLASS: Oil, Gas, Dry, Inj, Disp, Comm Disp, Svc	Dry P+A					
PERFORATED INTERVALS	2566-3701					
ACID VOLUME	NA					
FRACTURE TREATMENT (Fluids/Prop Amounts)	NA					

RECEIVED
APR 2 0 2020
Oklahoma Corporation
Commission

Min Gas Allowable (165:10-17-7)

Gas Purchaser/Measurer



OR

First Sales Date

INITIAL TEST DATA

Oil Allowable (165:10-13-3)

INITIAL TEST DATE	NA				
OIL-BBL/DAY					
OIL-GRAVITY (API)					
GAS-MCF/DAY					
GAS-OIL RATIO CU FT/BBL					
WATER-BBL/DAY					
PUMPING OR FLOWING					
INITIAL SHUT-IN PRESSURE					
CHOKE SIZE					
FLOW TUBING PRESSURE					

A record of the formations drilled through, and pertinent remarks are presented on the reverse. I declare that I have knowledge of the contents of this report and am authorized by my organization to make this report, which was prepared by me or under my supervision and direction, with the data and facts stated herein to be true, correct, and complete to the best of my knowledge and belief.

Sharon Ward

Sharon Ward

4/14/2020 281-891-1556

SIGNATURE

NAME (PRINT OR TYPE)

DATE

PHONE NUMBER

14077 Cutten Rd

Houston

Texas 77069

sward@cogc.com

ADDRESS

CITY

STATE

ZIP

EMAIL ADDRESS

PLEASE TYPE OR USE BLACK INK ONLY
FORMATION RECORD

Give formation names and tops, if available, or descriptions and thickness of formations drilled through. Show intervals cored or drillstem tested.

LEASE NAME CAUGHLIN B

WELL NO. 1

NAMES OF FORMATIONS	TOP
TONKAWA	2564

FOR COMMISSION USE ONLY	
ITD on file <input type="checkbox"/> YES <input type="checkbox"/> NO	
APPROVED _____	DISAPPROVED _____
2) Reject Codes	

Were open hole logs run?	____ yes ____ no
Date Last log was run	_____
Was CO ₂ encountered?	____ yes ____ no at what depths? _____
Was H ₂ S encountered?	____ yes ____ no at what depths? _____
Were unusual drilling circumstances encountered?	____ yes ____ no
If yes, briefly explain below	

Other remarks:

Caughlin B 1 was plugged and abandoned on 11/18/19. 1003 filed 12/11/19

OCC - Original 1002A shows well blew out at 592' was killed with weighted mud, after cementing at bottom of hole well was perforated and squeezed at 3700-01 with 125 sacks cement top cement at 2886'. Then perforated at 2750-51 with 100 sacks cement top cement at 2550'.

640 Acres

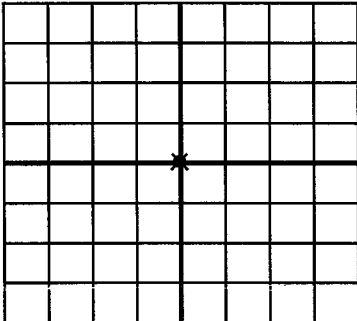

If more than three drainholes are proposed, attach a separate sheet indicating the necessary information.

Direction must be stated in degrees azimuth. Please note, the horizontal drainhole and its end point must be located within the boundaries of the lease or spacing unit.

Directional surveys are required for all drainholes and directional wells.

640 Acres

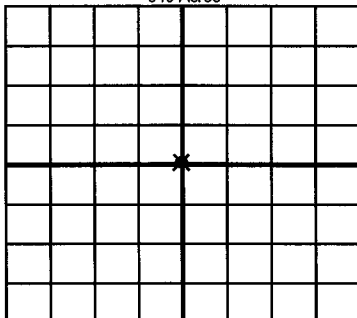

BOTTOM HOLE LOCATION FOR DIRECTIONAL HOLE

SEC	TWP	RGE	COUNTY		
Spot Location			Feet From 1/4 Sec Lines	FSL	FWL
1/4 1/4 1/4					
Measured Total Depth		True Vertical Depth	BHL From Lease, Unit, or Property Line:		

BOTTOM HOLE LOCATION FOR HORIZONTAL HOLE: (LATERALS)

SEC	TWP	RGE	COUNTY		
Spot Location			Feet From 1/4 Sec Lines	FSL	FWL
1/4 1/4 1/4					
Depth of Deviation		Radius of Turn	Direction	Total Length	
Measured Total Depth		True Vertical Depth	BHL From Lease, Unit, or Property Line:		

LATERAL #2

SEC	TWP	RGE	COUNTY		
Spot Location			Feet From 1/4 Sec Lines	FSL	FWL
1/4 1/4 1/4					
Depth of Deviation		Radius of Turn	Direction	Total Length	
Measured Total Depth		True Vertical Depth	BHL From Lease, Unit, or Property Line:		

LATERAL #3

SEC	TWP	RGE	COUNTY		
Spot Location			Feet From 1/4 Sec Lines	FSL	FWL
1/4 1/4 1/4					
Depth of Deviation		Radius of Turn	Direction	Total Length	
Measured Total Depth		True Vertical Depth	BHL From Lease, Unit, or Property Line:		