

Oklahoma Corporation Commission
Oil & Gas Conservation Division
Post Office Box 52000
Oklahoma City, Oklahoma 73152-2000
Rule 165: 10-3-25

Form 1002A

API No.: 35071016150001

Completion Report

Spud Date: November 23, 1960

OTC Prod. Unit No.:

Drilling Finished Date: December 05, 1960

Amended

1st Prod Date: December 09, 1960

Amend Reason: PLUGGED AND ABANDONED

Completion Date: December 09, 1960

Recomplete Date: November 15, 2019

Drill Type: STRAIGHT HOLE

Well Name: CAUGHLIN B 3

Purchaser/Measurer:

Location: KAY 30 25N 1E
C SW SE NW
330 FSL 1650 FWL of 1/4 SEC
Latitude: 36.616134 Longitude: -97.24102
Derrick Elevation: 0 Ground Elevation: 938

First Sales Date:

Operator: CITATION OIL & GAS CORPORATION 14156

14077 CUTTEN RD
HOUSTON, TX 77069-2212

Completion Type		Location Exception		Increased Density	
	Single Zone	Order No		Order No	
	Multiple Zone	There are no Location Exception records to display.		There are no Increased Density records to display.	
	Commingled				

Casing and Cement							
Type	Size	Weight	Grade	Feet	PSI	SAX	Top of CMT
SURFACE	8.625	24	8RD	240		230	SURFACE
PRODUCTION	5.5	15	8RD	4406		360	N/A

Liner								
Type	Size	Weight	Grade	Length	PSI	SAX	Top Depth	Bottom Depth
There are no Liner records to display.								

Total Depth: 4408

Packer	
Depth	Brand & Type
There are no Packer records to display.	

Plug	
Depth	Plug Type
320	CEMENT
4248	CIBP

Initial Test Data

Test Date	Formation	Oil BBL/Day	Oil-Gravity (API)	Gas MCF/Day	Gas-Oil Ratio Cu FT/BBL	Water BBL/Day	Pumpin or Flowing	Initial Shut- In Pressure	Choke Size	Flow Tubing Pressure
-----------	-----------	----------------	----------------------	----------------	----------------------------	------------------	----------------------	---------------------------------	---------------	-------------------------

There are no Initial Data records to display.

Completion and Test Data by Producing Formation

Formation Name: MISSISSIPPI CHAT Code: 401MSSCT Class: PLUG AND ABANDON

Spacing Orders		Perforated Intervals	
Order No	Unit Size	From	To
There are no Spacing Order records to display.		4313	4374
Acid Volumes		Fracture Treatments	
N/A		N/A	

Formation	Top
MISSISSIPPI	4310

Were open hole logs run? No
Date last log run:

Were unusual drilling circumstances encountered? No
Explanation:

Other Remarks
CAUGHLIN B 3 WAS PLUGGED AND ABANDONED ON NOVEMBER 15, 2019. 1003 FILED DECEMBER 11, 2019. OCC - ON PLUGGING THE 5 1/2" CASING WAS PERFORATED AT 320' USED 120 SACKS OF CEMENT CIRCULATED TO SURFACE.

FOR COMMISSION USE ONLY	
Status: Accepted	1145083

API NO. 3507101615
OTC PROD.
UNIT NO.

(PLEASE TYPE OR USE BLACK INK ONLY)

OKLAHOMA CORPORATION COMMISSION
Oil & Gas Conservation Division
Post Office Box 52000
Oklahoma City, Oklahoma 73152-2000
Rule 165:10-3-25

Form 1002A
Rev. 2009

☐ ORIGINAL
☒ AMENDED (Reason) PLUG AND ABANDON

TYPE OF DRILLING OPERATION
☒ STRAIGHT HOLE ☐ DIRECTIONAL HOLE ☐ HORIZONTAL HOLE
☐ SERVICE WELL
If directional or horizontal, see reverse for bottom hole location.

COUNTY KAY SEC 30 TWP 25N RGE 1E
LEASE NAME CAUGHLIN B
WELL NO. 3
1st PROD DATE 12/9/1960
RECOMP DATE NA 11-15-2019 P&A
FSL OF 1/4 SEC 2970 FWL OF 1/4 SEC 1650
ELEVATION Ground 938 Latitude (if known) 36.616134 Longitude (if known) -97.24102
OPERATOR NAME Citation Oil & Gas Corp. OTC / OCC OPERATOR NO. 14156
ADDRESS 14077 Cutten Rd
CITY Houston STATE Texas ZIP 77069-2212

SPUD DATE 11/23/1960
DRLG FINISHED DATE 12/5/1960
DATE OF WELL COMPLETION NA 12-9-1960
1st PROD DATE 12/9/1960
RECOMP DATE NA 11-15-2019 P&A

640 Acres
LOCATE WELL

COMPLETION TYPE
☒ SINGLE ZONE
☐ MULTIPLE ZONE
Application Date
COMINGLED
Application Date
LOCATION EXCEPTION ORDER NO.
INCREASED DENSITY ORDER NO.

TYPE	SIZE	WEIGHT	GRADE	FEET	PSI	SAX	TOP OF CMT
CONDUCTOR							
SURFACE	8.625	24	8RD	240		230	surface
INTERMEDIATE							
PRODUCTION	5.5	15	8RD	4406		360	NA
LINER							

PACKER @ NA BRAND & TYPE NA PLUG @ 4248 TYPE CIBP PLUG @ 320 TYPE cement TOTAL DEPTH 4408
PACKER @ BRAND & TYPE PLUG @ TYPE PLUG @ TYPE

COMPLETION & TEST DATA BY PRODUCING FORMATION

FORMATION	MISSISSIPPI Chat					
SPACING & SPACING ORDER NUMBER						
CLASS: Oil, Gas, Dry, Inj, Disp, Comm Disp, Svc	off P&A					
PERFORATED INTERVALS	4313-4374					
ACID VOLUME	NA					
FRACTURE TREATMENT (Fluids/Prop Amounts)	NA					

RECEIVED
APR 2 02020
Oklahoma Corporation
Commission

Min Gas Allowable (165:10-17-7) Gas Purchaser/Measurer
OR
Oil Allowable (165:10-13-3) First Sales Date

INITIAL TEST DATA

INITIAL TEST DATE	NA					
OIL-BBL/DAY						
OIL-GRAVITY (API)						
GAS-MCF/DAY						
GAS-OIL RATIO CU FT/BBL						
WATER-BBL/DAY						
PUMPING OR FLOWING						
INITIAL SHUT-IN PRESSURE						
CHOKE SIZE						
FLOW TUBING PRESSURE						

A record of the formations drilled through, and pertinent remarks are presented on the reverse. I declare that I have knowledge of the contents of this report and am authorized by my organization to make this report, which was prepared by me or under my supervision and direction, with the data and facts stated herein to be true, correct, and complete to the best of my knowledge and belief.

SIGNATURE Sharon Ward
14077 Cutten Rd Houston Texas 77069
ADDRESS CITY STATE ZIP
DATE 4/14/2020 PHONE NUMBER 281-891-1556
EMAIL ADDRESS sward@cogc.com

PLEASE TYPE OR USE BLACK INK ONLY
FORMATION RECORD

Give formation names and tops, if available, or descriptions and thickness of formations drilled through. Show intervals cored or drillstem tested.

LEASE NAME CAUGHLIN B

WELL NO. 3

NAMES OF FORMATIONS	TOP
MISSISSIPPI	4310

FOR COMMISSION USE ONLY	
ITD on file <input type="checkbox"/> YES <input type="checkbox"/> NO	
APPROVED _____	DISAPPROVED _____
2) Reject Codes	

Were open hole logs run?	_____ yes _____ no
Date Last log was run	_____
Was CO ₂ encountered?	_____ yes _____ no at what depths? _____
Was H ₂ S encountered?	_____ yes _____ no at what depths? _____
Were unusual drilling circumstances encountered?	_____ yes _____ no
If yes, briefly explain below	

Other remarks:

Caughlin B 3 was plugged and abandoned on 11/15/19. 1003 filed 12/11/19

OCC-Perf 5 1/2" casing at 320 used 120 sacks cement circulated to surface

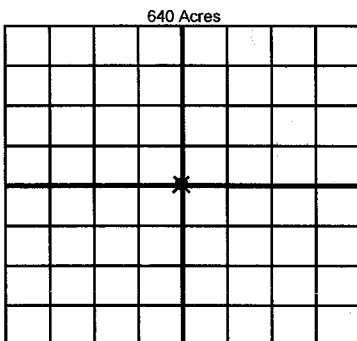

If more than three drainholes are proposed, attach a separate sheet indicating the necessary information.

Direction must be stated in degrees azimuth.
Please note, the horizontal drainhole and its end point must be located within the boundaries of the lease or spacing unit.

Directional surveys are required for all drainholes and directional wells.

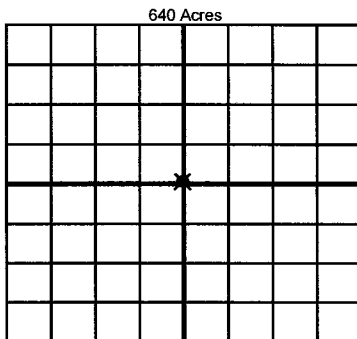

BOTTOM HOLE LOCATION FOR DIRECTIONAL HOLE

SEC	TWP	RGE	COUNTY
Spot Location			
1/4	1/4	1/4	1/4
Measured Total Depth		True Vertical Depth	Feet From 1/4 Sec Lines FSL FWL
BHL From Lease, Unit, or Property Line:			

BOTTOM HOLE LOCATION FOR HORIZONTAL HOLE: (LATERALS)

LATERAL #1

SEC	TWP	RGE	COUNTY
Spot Location			
1/4	1/4	1/4	1/4
Depth of Deviation		Radius of Turn	Direction Total Length
Measured Total Depth		True Vertical Depth	BHL From Lease, Unit, or Property Line:

LATERAL #2

SEC	TWP	RGE	COUNTY
Spot Location			
1/4	1/4	1/4	1/4
Depth of Deviation		Radius of Turn	Direction Total Length
Measured Total Depth		True Vertical Depth	BHL From Lease, Unit, or Property Line:

LATERAL #3

SEC	TWP	RGE	COUNTY
Spot Location			
1/4	1/4	1/4	1/4
Depth of Deviation		Radius of Turn	Direction Total Length
Measured Total Depth		True Vertical Depth	BHL From Lease, Unit, or Property Line: