

Oklahoma Corporation Commission
Oil & Gas Conservation Division
Post Office Box 52000
Oklahoma City, Oklahoma 73152-2000
Rule 165: 10-3-25

Form 1002A

API No.: 35071016140002

Completion Report

Spud Date: May 23, 1960

OTC Prod. Unit No.:

Drilling Finished Date: June 05, 1960

Amended

1st Prod Date: June 11, 1960

Amend Reason: PLUGGED AND ABANDONED

Completion Date: June 11, 1960

Recomplete Date: November 04, 2019

Drill Type: STRAIGHT HOLE

Well Name: CAUGHLIN B-2

Purchaser/Measurer:

Location: KAY 30 25N 1E
C SE SE NW
330 FSL 2310 FWL of 1/4 SEC
Latitude: 36.616134 Longitude: -97.23877
Derrick Elevation: 0 Ground Elevation: 940

First Sales Date:

Operator: CITATION OIL & GAS CORPORATION 14156

14077 CUTTEN RD
HOUSTON, TX 77069-2212

Completion Type		Location Exception		Increased Density	
	Single Zone	Order No		Order No	
	Multiple Zone	There are no Location Exception records to display.		There are no Increased Density records to display.	
	Commingled				

Casing and Cement							
Type	Size	Weight	Grade	Feet	PSI	SAX	Top of CMT
SURFACE	8.625	24	8RD	240		200	SURFACE
PRODUCTION	5.5	15	8RD	4311		315	2500

Liner								
Type	Size	Weight	Grade	Length	PSI	SAX	Top Depth	Bottom Depth
There are no Liner records to display.								

Total Depth: 4360

Packer	
Depth	Brand & Type
There are no Packer records to display.	

Plug	
Depth	Plug Type
310	CEMENT
4079	CEMENT
4250	CEMENT
4250	CIBP

Initial Test Data										
Test Date	Formation	Oil BBL/Day	Oil-Gravity (API)	Gas MCF/Day	Gas-Oil Ratio Cu FT/BBL	Water BBL/Day	Pumpin or Flowing	Initial Shut-In Pressure	Choke Size	Flow Tubing Pressure
There are no Initial Data records to display.										

Completion and Test Data by Producing Formation									
Formation Name: MISSISSIPPIAN				Code: 359MSSP			Class: PLUG AND ABANDON		
Spacing Orders				Perforated Intervals					
Order No		Unit Size		From		To			
There are no Spacing Order records to display.				4303		4336			
Acid Volumes				Fracture Treatments					
N/A				N/A					

Formation Name: RED FORK		Code: 404RDFK		Class: PLUG AND ABANDON	
Spacing Orders		Perforated Intervals			
Order No	Unit Size	From	To		
There are no Spacing Order records to display.		4093	4116		
Acid Volumes		Fracture Treatments			
N/A		N/A			

Formation	Top
MISSISSIPPI	4298

Were open hole logs run? No

Date last log run:

Were unusual drilling circumstances encountered? No

Explanation:

Other Remarks
CAUGHLIN B 2 WAS PLUGGED AND ABANDONED ON NOVEMBER 18, 2019. 1003 FILED NOVEMBER 4, 2019.

FOR COMMISSION USE ONLY
Status: Accepted
1145081

API NO. 3507101614
OTC PROD.
UNIT NO.

(PLEASE TYPE OR USE BLACK INK ONLY)

OKLAHOMA CORPORATION COMMISSION
Oil & Gas Conservation Division
Post Office Box 52000
Oklahoma City, Oklahoma 73152-2000
Rule 165-10-3-25

Form 1002A
Rev. 2009

☐ ORIGINAL
☒ AMENDED (Reason) PLUG AND ABANDON

COMPLETION REPORT

TYPE OF DRILLING OPERATION
☒ STRAIGHT HOLE ☐ DIRECTIONAL HOLE ☐ HORIZONTAL HOLE
☐ SERVICE WELL
If directional or horizontal, see reverse for bottom hole location.

SPUD DATE 5/23/1960
DRLG FINISHED DATE 6/5/1960
DATE OF WELL COMPLETION NA 6-11-1960
1st PROD DATE 11/6/1960 6-11-1960
RECOMP DATE NA 11/4/2019 PTA^W
WELL NO. 2
FWL OF 1/4 SEC 2310
Longitude (if known) -97.23877
OTC / OCC OPERATOR NO. 14156

COUNTY KAY SEC 30 TWP 25N RGE 1E
LEASE NAME CAUGHLIN B
1/4 SE 1/4 SE 1/4 NW 1/4 ESL 32D
ELEVATION Ground 940
Derrick FL
Latitude (if known) 36.616134
OPERATOR NAME Citation Oil & Gas Corp.
ADDRESS 14077 Cutten Rd
CITY Houston STATE Texas ZIP 77069-2212

640 Acres
LOCATE WELL

COMPLETION TYPE
☐ SINGLE ZONE
☒ MULTIPLE ZONE
Application Date
COMMINGLED
Application Date
LOCATION EXCEPTION
ORDER NO.
INCREASED DENSITY
ORDER NO.

TYPE	SIZE	WEIGHT	GRADE	FEET	PSI	SAX	TOP OF CMT
CONDUCTOR							
SURFACE	8.625	24	8RD	240		200	<u>surface</u>
INTERMEDIATE							
PRODUCTION	5.5	15	8RD	<u>3259 4311</u>		315	2500
LINER							

PACKER @ NA BRAND & TYPE NA PLUG @ 4250 TYPE CIBP PLUG @ 4079 TYPE cement
PACKER @ BRAND & TYPE PLUG @ 310 TYPE cement PLUG @ 4230 TYPE cement

TOTAL DEPTH 4360

COMPLETION & TEST DATA BY PRODUCING FORMATION

FORMATION	MISSISSIPPIAN	Red Fork
SPACING & SPACING		
ORDER NUMBER		
CLASS: Oil, Gas, Dry, Inj, Disp, Comm Disp, Svc	<u>ONE PTA</u>	<u>PTA</u>
PERFORATED INTERVALS	4303-4336	4093-4116
ACID/VOLUME	NA	
FRACTURE TREATMENT (Fluids/Prop Amounts)	NA	

RECEIVED
APR 2 0 2020
Oklahoma Corporation
Commission

Min Gas Allowable (165:10-17-7) OR Oil Allowable (165:10-13-3) Gas Purchaser/Measurer First Sales Date

INITIAL TEST DATA

INITIAL TEST DATE	NA
OIL-BBL/DAY	
OIL-GRAVITY (API)	
GAS-MCF/DAY	
GAS-OIL RATIO CU FT/BBL	
WATER-BBL/DAY	
PUMPING OR FLOWING	
INITIAL SHUT-IN PRESSURE	
CHOKE SIZE	
FLOW TUBING PRESSURE	

A record of the formations drilled through, and pertinent remarks are presented on the reverse. I declare that I have knowledge of the contents of this report and am authorized by my organization to make this report, which was prepared by me or under my supervision and direction, with the data and facts stated herein to be true, correct, and complete to the best of my knowledge and belief.

SIGNATURE Sharon Ward NAME (PRINT OR TYPE) Sharon Ward DATE 4/14/2020 PHONE NUMBER 281-891-1556
14077 Cutten Rd Houston Texas 77069 sward@cogc.com
ADDRESS CITY STATE ZIP EMAIL ADDRESS

PLEASE TYPE OR USE BLACK INK ONLY

FORMATION RECORD

Give formation names and tops, if available, or descriptions and thickness of formations drilled through. Show intervals cored or drillstem tested.

LEASE NAME CAUGHLIN B

WELL NO. 2

NAMES OF FORMATIONS	TOP
MISSISSIPPI	4298

FOR COMMISSION USE ONLY	
ITD on file	<input type="checkbox"/> YES <input type="checkbox"/> NO
APPROVED	DISAPPROVED
2) Reject Codes	

Were open hole logs run?	<input type="checkbox"/> yes <input type="checkbox"/> no
Date Last log was run	
Was CO ₂ encountered?	<input type="checkbox"/> yes <input type="checkbox"/> no at what depths? <input type="text"/>
Was H ₂ S encountered?	<input type="checkbox"/> yes <input type="checkbox"/> no at what depths? <input type="text"/>
Were unusual drilling circumstances encountered?	<input type="checkbox"/> yes <input type="checkbox"/> no
If yes, briefly explain below	

Other remarks:

Caughlin B 2 was plugged and abandoned on 11/18/19. 1003 filed 11/04/19

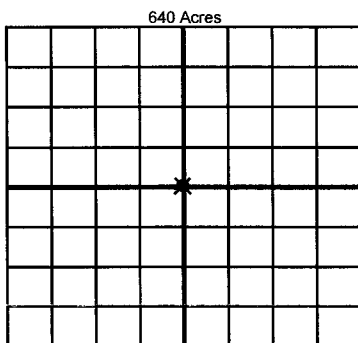

If more than three drainholes are proposed, attach a separate sheet indicating the necessary information.

Direction must be stated in degrees azimuth.
Please note, the horizontal drainhole and its end point must be located within the boundaries of the lease or spacing unit.

Directional surveys are required for all drainholes and directional wells.

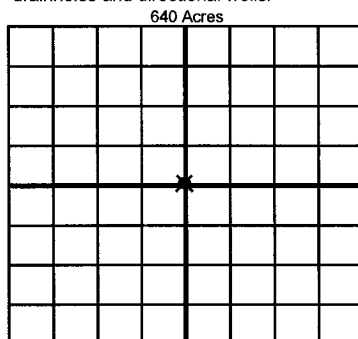

BOTTOM HOLE LOCATION FOR DIRECTIONAL HOLE

SEC	TWP	RGE	COUNTY
Spot Location			
1/4	1/4	1/4	1/4
Measured Total Depth		True Vertical Depth	BHL From Lease, Unit, or Property Line:

BOTTOM HOLE LOCATION FOR HORIZONTAL HOLE: (LATERALS)

LATERAL #1

SEC	TWP	RGE	COUNTY
Spot Location			
1/4	1/4	1/4	1/4
Depth of Deviation		Radius of Turn	Direction
Measured Total Depth		True Vertical Depth	BHL From Lease, Unit, or Property Line:

LATERAL #2

SEC	TWP	RGE	COUNTY
Spot Location			
1/4	1/4	1/4	1/4
Depth of Deviation		Radius of Turn	Direction
Measured Total Depth		True Vertical Depth	BHL From Lease, Unit, or Property Line:

LATERAL #3

SEC	TWP	RGE	COUNTY
Spot Location			
1/4	1/4	1/4	1/4
Depth of Deviation		Radius of Turn	Direction
Measured Total Depth		True Vertical Depth	BHL From Lease, Unit, or Property Line: