

Oklahoma Corporation Commission
Oil & Gas Conservation Division
Post Office Box 52000
Oklahoma City, Oklahoma 73152-2000
Rule 165: 10-3-25

Form 1002A

API No.: 35019262900000

Completion Report

Spud Date: April 24, 2018

OTC Prod. Unit No.: 019-225342-0-0000

Drilling Finished Date: June 29, 2018

1st Prod Date: February 20, 2020

Completion Date: February 20, 2020

Drill Type: HORIZONTAL HOLE

Well Name: LAWSON 6-13H14X

Purchaser/Measurer:

Location: CARTER 13 3S 2E
NE SE NE NE
880 FNL 300 FEL of 1/4 SEC
Latitude: 34.300868 Longitude: -97.039006
Derrick Elevation: 0 Ground Elevation: 775

First Sales Date:

Operator: XTO ENERGY INC 21003

22777 SPRINGWOODS VILLAGE PKWY
SPRING, TX 77389-1425

Completion Type	
X	Single Zone
	Multiple Zone
	Commingled

Location Exception	
Order No	
703653	

Increased Density	
Order No	
674954	

Casing and Cement							
Type	Size	Weight	Grade	Feet	PSI	SAX	Top of CMT
CONDUCTOR	20	94	J-55	110			SURFACE
SURFACE	13 3/8	54.5	J-55	2050		845	SURFACE
PRODUCTION	5 1/2	23	P-110	17068		1220	10423

Liner								
Type	Size	Weight	Grade	Length	PSI	SAX	Top Depth	Bottom Depth
There are no Liner records to display.								

Total Depth: 22454

Packer	
Depth	Brand & Type
There are no Packer records to display.	

Plug	
Depth	Plug Type
There are no Plug records to display.	

Initial Test Data

Test Date	Formation	Oil BBL/Day	Oil-Gravity (API)	Gas MCF/Day	Gas-Oil Ratio Cu FT/BBL	Water BBL/Day	Pumpin or Flowing	Initial Shut-In Pressure	Choke Size	Flow Tubing Pressure
Mar 16, 2020	WOODFORD	258	47	3821	14810	500	FLOWING	957	42/64	647

Completion and Test Data by Producing Formation

Formation Name: WOODFORD		Code: 319WDFD		Class: OIL	
Spacing Orders			Perforated Intervals		
Order No	Unit Size	From	To		
197431	640	12263	16690		
Acid Volumes			Fracture Treatments		
NONE			17 STAGES - 262,231 BBLs TREATED WATER & 786,380 POUNDS 100 MESH SAND, 6,583,398 POUNDS 40/70 SAND.		

Formation	Top
WOODFORD	11937

Were open hole logs run? No

Date last log run:

Were unusual drilling circumstances encountered? No

Explanation:

Other Remarks
IRREGULAR SECTION. OCC - THIS WELL WAS COMPLETED ONLY IN SECTION 13 -3S-2E. THE MULTIUNIT APPLICATION WAS DISMISSED BY ORDER 699258.

Lateral Holes
Sec: 14 TWP: 3S RGE: 2E County: CARTER SW NW NW NW 487 FNL 111 FWL of 1/4 SEC Depth of Deviation: 11800 Radius of Turn: 445 Direction: 270 Total Length: 9969 Measured Total Depth: 22454 True Vertical Depth: 11738 End Pt. Location From Release, Unit or Property Line: 111

FOR COMMISSION USE ONLY
<div>Status: Accepted</div> <div>1145074</div>

API NO. 019-26290
OTC PROD. UNIT NO. 019-225342

PLEASE TYPE OR USE BLACK INK ONLY

NOTE:

Attach copy of original 1002A
if recompletion or reentry.

OKLAHOMA CORPORATION COMMISSION

Oil & Gas Conservation Division

Post Office Box 52000

Oklahoma City, Oklahoma 73152-2000

Rule 165:10-3-25

Form 1002A
Rev. 2009

☒ ORIGINAL
☐ AMENDED (Reason)

COMPLETION REPORT

TYPE OF DRILLING OPERATION

☐ STRAIGHT HOLE ☐ DIRECTIONAL HOLE ☒ HORIZONTAL HOLE
☐ SERVICE WELL

If directional or horizontal, see reverse for bottom hole location.

COUNTY	Carter	SEC	13	TWP	3S	RGE	2E	SPUD DATE	4/24/2018
LEASE NAME	Lawson 6-13H14X	WELL NO.		DATE OF WELL COMPLETION	2/20/2020	1st PROD DATE	2/20/2020	DRLG FINISHED DATE	6/29/2018
NE 1/4 SE 1/4 NE 1/4 NE 1/4		FNL OF 1/4 SEC	880	FEL OF 1/4 SEC	300	RECOMP DATE			
ELEVATION N Derrick	Ground	775	Latitude (if known)	34.200868	Longitude (if known)	-117.039006			
OPERATOR NAME	XTO Energy Inc.	OTC/OCC OPERATOR NO.	21003						
ADDRESS	210 Park Avenue, Suite 2350								
CITY	Oklahoma City	STATE	Oklahoma	ZIP	73102				

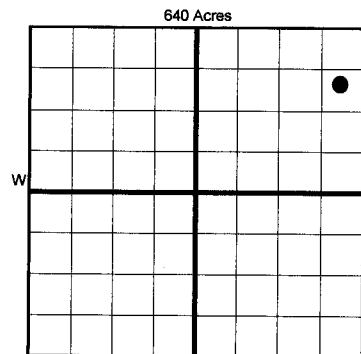

COMPLETION TYPE

<input checked="" type="checkbox"/> SINGLE ZONE	
<input type="checkbox"/> MULTIPLE ZONE	
Application Date	
<input type="checkbox"/> COMMINGLED	
Application Date	
LOCATION	
EXCEPTION ORDER	674791, 674573
INCREASED DENSITY ORDER NO.	674954, 674284

CASING & CEMENT (Form 1002C must be attached)

TYPE	SIZE	WEIGHT	GRADE	FEET	PSI	SAX	TOP OF CMT
CONDUCTOR	20"	94	J-55	110			Surface
SURFACE	13 3/8"	54.5	J-55	2050		845	Surface
INTERMEDIATE							
PRODUCTION	5 1/2"	23	P-110	17,068		1220	10423
LINER							
						TOTAL DEPTH	22,454

PACKER @ _____ BRAND & TYPE _____ PLUG @ _____ TYPE _____ PLUG @ _____ TYPE _____
PACKER @ _____ BRAND & TYPE _____ PLUG @ _____ TYPE _____ PLUG @ _____ TYPE _____

COMPLETION & TEST DATA BY PRODUCING FORMATION

FORMATION	Woodford						
SPACING & SPACING ORDER NUMBER	197431 (640)						
CLASS: Oil, Gas, Dry, Inj, Disp, Comm Disp, Svc	Oil						
PERFORATED INTERVALS	17 Stages						
	12263-16690						
ACID/VOLUME	0						
FRACTURE TREATMENT (Fluids/Prop Amounts)	262,231 BTW						
	786,380# 100 Mesh						
	6,583,398# 40/70						

Min Gas Allowable (165:10-17-7)

OR

Oil Allowable (165:10-13-3)

Gas Purchaser/Measurer

First Sales Date

INITIAL TEST DATA

INITIAL TEST DATE	3/16/2020						
OIL-BBL/DAY	258						
OIL-GRAVITY (API)	47						
GAS-MCF/DAY	3821						
GAS-OIL RATIO CU FT/BBL	14810						
WATER-BBL/DAY	500						
PUMPING OR FLOWING	Flowing						
INITIAL SHUT-IN PRESSURE	957						
CHOKE SIZE	42/64"						
FLOW TUBING PRESSURE	647						

A record of the formations drilled through, and pertinent remarks are presented on the reverse. I declare that I have knowledge of the contents of this report and am authorized by my organization to make this report, which was prepared by me or under my supervision and direction, with the data and facts stated herein to be true, correct, and complete to the best of my knowledge and belief.

Debbie Waggoner

Debbie Waggoner

4/9/2020

405-319-3243

SIGNATURE

NAME (PRINT OR TYPE)

DATE

PHONE NUMBER

210 Park Avenue, Suite 2350

Oklahoma City

Ok

73102

debbie_waggoner@xtoenergy.com

ADDRESS

CITY

STATE

ZIP

EMAIL ADDRESS

FORMATION RECORD

LEASE NAME Lawson WELL NO. 6-13H14X

NAMES OF FORMATIONS	TOP
Woodford	11,937

FOR COMMISSION USE ONLY	
ITD on file	<input type="checkbox"/> YES <input type="checkbox"/> NO
APPROVED	DISAPPROVED
2) Reject Codes	

Were open hole logs run? yes X no

Date Last log was run _____

Was CO₂ encountered? yes X no at what depths? _____

Was H₂S encountered? yes X no at what depths? _____

Were unusual drilling circumstances encountered? yes X no

If yes, briefly explain below

Other remarks: Irregular Section

640 Acres

Direction must be stated in degrees azimuth.
Please note, the horizontal drainhole and its end
point must be located within the boundaries of the
lease or spacing unit.

640 Acres

A 10x10 grid of squares, representing 640 acres. The grid is divided into four equal quadrants (5x5 squares each) by a thick horizontal line and a thick vertical line intersecting at the center. The text '640 Acres' is centered above the grid.

SEC	TWP	RGE	COUNTY
Spot Location			
1/4	1/4	1/4	1/4
Feet From 1/4 Sec Lines		FSL	FWL
Measured Total Depth	True Vertical Depth	BHL From Lease, Unit, or Property Line:	

LATERAL #1										Per LE exhibit													
SEC 14		TWP		3S		RGE		2E		COUNTY Carter													
Spot Location										Feet From 1/4 Sec Lines										FNL 487		FWL 212	
SW 1/4		NW 1/4		NW 1/4		NW 1/4		NW 1/4															
Depth of Deviation				11,800				Radius of Turn				445.6				Direction 270 274.7				Total Length 9,969			
Measured Total Depth						True Vertical Depth						BHL From Lease, Unit, or Property Line:											
22,454						11,738						487 FNL & 212 FWL											

LATERAL #2						
SEC	TWP	RGE	COUNTY			
Spot Location				Feet From 1/4 Sec Lines	FSL	FWL
1/4	1/4	1/4	1/4			
Depth of Deviation		Radius of Turn	Direction	Total Length		
Measured Total Depth		True Vertical Depth	BHL From Lease, Unit, or Property Line:			

LATERAL #3								
SEC	TWP	RGE	COUNTY					
Spot Location			1/4	1/4	1/4	Feet From 1/4 Sec Lines	FSL	FWL
Depth of Deviation		Radius of Turn		Direction		Total Length		
Measured Total Depth		True Vertical Depth		BHL From Lease, Unit, or Property Line:				

API NO. 019-26290
OTC PROD. UNIT NO. 019-225342

PLEASE TYPE OR USE BLACK INK ONLY
NOTE:

Attach copy of original 1002A
if recompletion or reentry.

OKLAHOMA CORPORATION COMMISSION
Oil & Gas Conservation Division
Post Office Box 52000
Oklahoma City, Oklahoma 73152-2000
Rule 185-10-3-25

Form 1002A
Rev. 2009

☐ ORIGINAL
☒ AMENDED (Reason)

Classification: See Comments

COMPLETION REPORT

TYPE OF DRILLING OPERATION

☐ STRAIGHT HOLE ☐ DIRECTIONAL HOLE ☒ HORIZONTAL HOLE
☐ SERVICE WELL

If directional or horizontal, see reverse for bottom hole location.

COUNTY	Carter	SEC	13	TWP	3S	RGE	2E	SPUD DATE	4/24/2018
LEASE NAME	Lawson 6-13H14X	WELL NO.	880	FEL OF 1/4 SEC	300	DATE OF WELL COMPLETION	2/20/2020	1st PROD DATE	2/20/2020
ELEVATION N Derrick	Ground	775	Latitude (if known)			RECOMP DATE		Longitude (if known)	
OPERATOR NAME	XTO Energy Inc.	OTC/OCC OPERATOR NO.	21003						
ADDRESS	210 Park Avenue, Suite 2350								
CITY	Oklahoma City	STATE	Oklahoma	ZIP	73102				

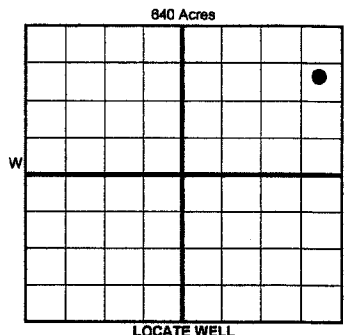

COMPLETION TYPE

<input checked="" type="checkbox"/> SINGLE ZONE
<input type="checkbox"/> MULTIPLE ZONE
Application Date
COMINGLED
Application Date
LOCATION
EXCEPTION ORDER
INCREASED DENSITY
ORDER NO.

703653
674791, 674573
674954, 674281

CASING & CEMENT (Form 1002C must be attached)

TYPE	SIZE	WEIGHT	GRADE	FEET	PSI	SAX	TOP OF CMT
CONDUCTOR	20"	94	J-55	110			Surface
SURFACE	13 3/8"	54.5	J-55	2050		845	Surface
INTERMEDIATE							
PRODUCTION	5 1/2"	23	P-110	17,068		1340	5,580'
LINER							
						TOTAL DEPTH	22,454

PACKER @ _____ BRAND & TYPE _____ PLUG @ _____ TYPE _____ PLUG @ _____ TYPE _____
PACKER @ _____ BRAND & TYPE _____ PLUG @ _____ TYPE _____ PLUG @ _____ TYPE _____

COMPLETION & TEST DATA BY PRODUCING FORMATION *319 W/PED*

FORMATION	Woodford						
SPACING & SPACING ORDER NUMBER	197431 (640)						
CLASS: Oil, Gas, Dry, Inj, Disp, Comm Disp, Svc	Oil						
PERFORATED INTERVALS	13 Stages						
	12263-10087 16690						
ACID/VOLUME	0						
FRACTURE TREATMENT (Fluids/Prop Amounts)	262,231 BTW						
	786,380# 100 Mesh						
	6,583,398# 40/70						

Reported to FracFocus

☒ Min Gas Allowable (185:10-17-7)
OR
☐ Oil Allowable (185:10-13-3)

Gas Purchaser/Measurer
First Sales Date

2/20/2020

INITIAL TEST DATA

INITIAL TEST DATE	3/16/2020						
OIL-BBL/DAY	258						
OIL-GRAVITY (API)	47						
GAS-MCF/DAY	3821						
GAS-OIL RATIO CU FT/BBL	14810						
WATER-BBL/DAY	500						
PUMPING OR FLOWING	Flowing						
INITIAL SHUT-IN PRESSURE	957						
CHOKE SIZE	42/64"						
FLOW TUBING PRESSURE	647						

RECEIVED

APR 03 2020

Oklahoma Corporation
Commission

A record of the formations drilled through, and pertinent remarks are presented on the reverse. I declare that I have knowledge of the contents of this report and am authorized by my organization to make this report, which was prepared by me or under my supervision and direction, with the data and facts stated herein to be true, correct, and complete to the best of my knowledge and belief.

Debbie Waggoner

Debbie Waggoner

3/31/2020

405-594-9455

SIGNATURE

NAME (PRINT OR TYPE)

DATE

PHONE NUMBER

210 Park Avenue, Suite 2350

Oklahoma City

Ok

73102

debbie_waggoner@xtoenergy.com

ADDRESS

CITY

STATE

ZIP

EMAIL ADDRESS

FORMATION RECORD

LEASE NAME Lawson WELL NO. 6-13H14X

NAMES OF FORMATIONS	TOP
W600FORD	11,937 ft

FOR COMMISSION USE ONLY	
ITD on file	<input type="checkbox"/> YES <input type="checkbox"/> NO
APPROVED	DISAPPROVED
2) Reject Codes	

Were open hole logs run? _____ yes X no

Date Last log was run _____

Was CO₂ encountered? _____ yes X no at what depths? _____

Was H₂S encountered? _____ yes X no at what depths? _____

Were unusual drilling circumstances encountered? _____ yes X no
If yes, briefly explain below

Other remarks: Irregular Section

The test was correct as an oil well but the classification was wrong. It should have been an oil well and not gas according to test.

OCC-This well was completed only in Sec 13-35-2E. The Multicourt Application was dismissed by order 699258

640 Acres

If more than three drainholes are proposed, attach a separate sheet indicating the necessary information.

Direction must be stated in degrees azimuth.
Please note, the horizontal drainhole and its end
point must be located within the boundaries of the
lease or spacing unit.

Directional surveys are required for all drainholes and directional wells.

640 Acres

BOTTOM HOLE LOCATION FOR DIRECTIONAL HOLE

SEC	TWP	RGE	COUNTY
Spot Location			
1/4	1/4	1/4	1/4
Measured Total Depth		True Vertical Depth	Feet From 1/4 Sec Lines FSL FWL BHL From Lease, Unit, or Property Line:

BOTTOM HOLE LOCATION FOR HORIZONTAL HOLE: (LATERALS)

LATERAL #1

SEC 14	TWP	3S	RGE	2E	COUNTY	<i>Carter Love</i>			
Spot Location						Feet From 1/4 Sec Lines		FNL 487	FWL <i>111</i> 212
SW 1/4		NW 1/4		NW 1/4					
Depth of Deviation		11,800		Radius of Turn		445.6			
Measured Total Depth		22,454		True Vertical Depth		11,738			
Direction						<i>270</i> 274.7		Total Length 9,969	
BHL From Lease, Unit, or Property Line:						487 FNL & 212 FWL <i>111</i>			

LATERAL #2

SEC	TWP	RGE	COUNTY
Spot Location			
1/4	1/4	1/4	1/4
Feet From 1/4 Sec Lines		FSL	FWL
Depth of Deviation	Radius of Turn	Direction	Total Length
Measured Total Depth		True Vertical Depth	
BHL From Lease, Unit, or Property Line:			

LATERAL #3

LATERAL #3						
SEC	TWP	RGE	COUNTY			
Spot Location						
1/4	1/4	1/4	1/4	Feet From 1/4 Sec Lines	FSL	FWL
Depth of Deviation		Radius of Turn	Direction		Total Length	
Measured Total Depth		True Vertical Depth	BHL From Lease, Unit, or Property Line:			

API NO. 019-26290
OTC PROD. 019-225342
UNIT NO.

PLEASE TYPE OR USE BLACK INK ONLY
NOTE:

Attach copy of original 1002A
if recompletion or reentry.

OKLAHOMA CORPORATION COMMISSION
Oil & Gas Conservation Division
Post Office Box 52000
Oklahoma City, Oklahoma 73152-2000
Rule 165:10-3-25

RECEIVED

MAR 19 2020

Form 1002A
Rev. 2009

☒ ORIGINAL
☐ AMENDED (Reason)

COMPLETION REPORT

TYPE OF DRILLING OPERATION

☐ STRAIGHT HOLE ☐ DIRECTIONAL HOLE ☒ HORIZONTAL HOLE
☐ SERVICE WELL

If directional or horizontal, see reverse for bottom hole location.

COUNTY	Carter	SEC	13	TWP	3S	RGE	2E	SPUD DATE	4/24/2018
LEASE NAME	Lawson 6-13H14X	WELL NO.		DRLG FINISHED DATE	6/29/2018	DATE OF WELL COMPLETION		1st PROD DATE	2/20/2020
NE 1/4 SE 1/4 NE 1/4 NE 1/4	FNL OF 1/4 SEC	880	FEL OF 1/4 SEC	300	RECOMP DATE				
ELEVATION N Derrick	Ground	775	Latitude (if known)		Longitude (if known)				
OPERATOR NAME	XTO Energy Inc.	OTC/OCC OPERATOR NO.	21003						
ADDRESS	210 Park Avenue, Suite 2350								
CITY	Oklahoma City	STATE	Oklahoma	ZIP	73102				

OKLAHOMA CORPORATION COMMISSION

640 Acres

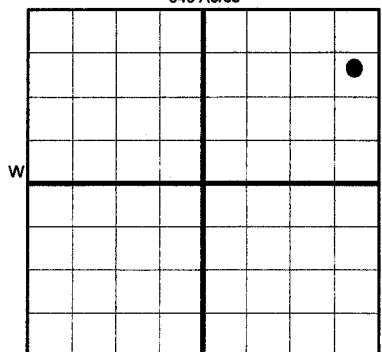

COMPLETION TYPE

<input checked="" type="checkbox"/> SINGLE ZONE
<input type="checkbox"/> MULTIPLE ZONE
Application Date
COMINGLED
Application Date
LOCATION
EXCEPTION ORDER
INCREASED DENSITY
ORDER NO.

CASING & CEMENT (Form 1002C must be attached)

TYPE	SIZE	WEIGHT	GRADE	FEET	PSI	SAX	TOP OF CMT
CONDUCTOR	20"	94	J-55	110			Surface
SURFACE	13 3/8"	54.5	J-55	2050		845	Surface
INTERMEDIATE							
PRODUCTION	5 1/2"	23	P-110	17,068		1340	5,580'
LINER							
TOTAL DEPTH							22,454

PACKER @ _____ BRAND & TYPE _____ PLUG @ _____ TYPE _____ PLUG @ _____ TYPE _____
PACKER @ _____ BRAND & TYPE _____ PLUG @ _____ TYPE _____ PLUG @ _____ TYPE _____

COMPLETION & TEST DATA BY PRODUCING FORMATION 319W DFD

FORMATION	Woodford							
SPACING & SPACING ORDER NUMBER	197431 (640)							
CLASS: Oil, Gas, Dry, Inj, Disp, Comm Disp, Svc	Gas							
PERFORATED INTERVALS	13 Stages							
	12263-15687'							
ACID/VOLUME	0							
FRACTURE TREATMENT (Fluids/Prop Amounts)	262,231 BTW							
	786,380# 100 Mesh							
	6,583,398# 40/70							

Min Gas Allowable (165:10-17-7)

Gas Purchaser/Measurer

☒

OR

First Sales Date

Oil Allowable (165:10-13-3)

2/20/2020

INITIAL TEST DATA

INITIAL TEST DATE	3/16/2020						
OIL-BBL/DAY	258						
OIL-GRAVITY (API)	47						
GAS-MCF/DAY	3821						
GAS-OIL RATIO CU FT/BBL	14810						
WATER-BBL/DAY	500						
PUMPING OR FLOWING	Flowing						
INITIAL SHUT-IN PRESSURE	957						
CHOKE SIZE	42/64"						
FLOW TUBING PRESSURE	647						

A record of the formations drilled through, and pertinent remarks are presented on the reverse. I declare that I have knowledge of the contents of this report and am authorized by my organization to make this report, which was prepared by me or under my supervision and direction, with the data and facts stated herein to be true, correct, and complete to the best of my knowledge and belief.

Debbie Waggoner
SIGNATURE

Debbie Waggoner

3-17-2020

405-319-3243

210 Park Avenue, Suite 2350

Oklahoma City

Ok

73102

debbie_waggoner@xtoenergy.com

ADDRESS

CITY

STATE

ZIP

EMAIL ADDRESS

Give formation names and tops, if available, or descriptions and thickness of formations drilled through. Show intervals cored or drillstem tested.

LEASE NAME Lawson WELL NO. 6-13H14X

NAMES OF FORMATIONS	TOP

FOR COMMISSION USE ONLY	
ITD on file	<input type="checkbox"/> YES <input type="checkbox"/> NO
APPROVED	DISAPPROVED
<div>2) Reject Codes</div> <div> <div></div> <div></div> <div></div> <div></div> <div></div> </div>	

Were open hole logs run? yes X no

Date Last log was run _____

Was CO₂ encountered? yes X no at what depths? _____

Was H₂S encountered? yes X no at what depths? _____

Were unusual drilling circumstances encountered? yes X no

If yes, briefly explain below

Other remarks: Irregular Section

640 Acres

If more than three drainholes are proposed, attach a separate sheet indicating the necessary information.

Direction must be stated in degrees azimuth.
Please note, the horizontal drainhole and its end
point must be located within the boundaries of the
lease or spacing unit.

Directional surveys are required for all drainholes and directional wells.

640 Acres

SEC	TWP	RGE	COUNTY
Spot Location			
1/4	1/4	1/4	1/4
Measured Total Depth		True Vertical Depth	Feet From 1/4 Sec Lines
			FSL
		FWL	
		BHL From Lease, Unit, or Property Line:	

LATERAL #1									
SEC	14	TWP	3S	RGE	2E	COUNTY Love			
Spot Location						Feet From 1/4 Sec Lines		FNL 487	FWL 212
SW	1/4	NW	1/4	NW	1/4	NW	1/4		
Depth of Deviation 11,800				Radius of Turn 445.6		Direction 274.7°		Total Length 9,969	
Measured Total Depth 22,454				True Vertical Depth 11,738		BHL From Lease, Unit, or Property Line: 487 FNL & 212 FWL			

LATERAL #2						
SEC	TWP	RGE	COUNTY			
Spot Location				Feet From 1/4 Sec Lines	FSL	FWL
1/4	1/4	1/4	1/4			
Depth of Deviation		Radius of Turn	Direction	Total Length		
Measured Total Depth		True Vertical Depth	BHL From Lease, Unit, or Property Line:			

LATERAL #3						
SEC	TWP	RGE	COUNTY			
Spot Location			Feet From 1/4 Sec Lines		FSL	FWL
1/4	1/4	1/4	1/4			
Depth of Deviation		Radius of Turn	Direction	Total Length		
Measured Total Depth		True Vertical Depth	BHL From Lease, Unit, or Property Line:			