

Oklahoma Corporation Commission  
Oil & Gas Conservation Division  
Post Office Box 52000  
Oklahoma City, Oklahoma 73152-2000  
Rule 165: 10-3-25

Form 1002A

API No.: 35035215690000

**Completion Report**

Spud Date: July 31, 2019

OTC Prod. Unit No.: 035-226741-0-0000

Drilling Finished Date: August 01, 2019

1st Prod Date: September 24, 2019

Completion Date: September 23, 2019

**Drill Type:** STRAIGHT HOLE

Min Gas Allowable: Yes

Well Name: F HARTLEY 22-18B

Purchaser/Measurer: CVR

Location: CRAIG 18 27N 19E  
SE NE SE NW  
1900 FNL 2490 FWL of 1/4 SEC  
Derrick Elevation: 0 Ground Elevation: 871

First Sales Date: 01/06/2020

Operator: NEOK PRODUCTION COMPANY LLC 21838  
PO BOX 428  
322 E CHEROKEE  
NOWATA, OK 74048-0428

Completion Type		Location Exception		Increased Density	
	Single Zone	Order No		Order No	
	Multiple Zone	There are no Location Exception records to display.		There are no Increased Density records to display.	
X	Commingled				

Casing and Cement							
Type	Size	Weight	Grade	Feet	PSI	SAX	Top of CMT
CONDUCTOR	8 5/8	20	J-55	21		12	SURFACE
PRODUCTION	5 1/2	17	J-55	1006		130	SURFACE

Liner								
Type	Size	Weight	Grade	Length	PSI	SAX	Top Depth	Bottom Depth
There are no Liner records to display.								

**Total Depth: 1025**

Packer		Plug	
Depth	Brand & Type	Depth	Plug Type
There are no Packer records to display.		There are no Plug records to display.	

Initial Test Data
-------------------

Test Date	Formation	Oil BBL/Day	Oil-Gravity (API)	Gas MCF/Day	Gas-Oil Ratio Cu FT/BBL	Water BBL/Day	Pumpin or Flowing	Initial Shut-In Pressure	Choke Size	Flow Tubing Pressure
Sep 24, 2019	WOODFORD						PUMPING			
Sep 24, 2019	ARBUCKLE	0.25	22			15	PUMPING			10

#### Completion and Test Data by Producing Formation

Formation Name: WOODFORD

Code: 319WDFD

Class: DRY

##### Spacing Orders

Order No	Unit Size
N/A	

##### Perforated Intervals

From	To
There are no Perf. Intervals records to display.	

##### Acid Volumes

150 GALLONS 15% HCL
---------------------

##### Fracture Treatments

N/A
-----

Formation Name: ARBUCKLE

Code: 169ABCK

Class: OIL

##### Spacing Orders

Order No	Unit Size
N/A	

##### Perforated Intervals

From	To
There are no Perf. Intervals records to display.	

##### Acid Volumes

150 GALLONS 15% HCL
---------------------

##### Fracture Treatments

N/A
-----

Formation	Top
CROWEBURG COAL	119
TEBO COAL	256
BARTLESVILLE SAND	370
WARNER SAND	554
MISSISSIPPI CHAT	608
WOODFORD SHALE	967
ARBUCKLE	1016

Were open hole logs run? Yes

Date last log run: August 13, 2019

Were unusual drilling circumstances encountered? No

Explanation:

#### Other Remarks

OCC - THIS WELL IS AN OPEN COMPLETION IN BOTH THE WOODFORD FROM 1006' TO 1,016' AND ARBUCKLE FROM 1,016' TO 1,025' TOTAL DEPTH.

#### FOR COMMISSION USE ONLY

1145071

Status: Accepted

API  
NO. 03521569  
OTC PROD.  
UNIT NO. 035-226741

(PLEASE TYPE OR USE BLACK INK ONLY)

OKLAHOMA CORPORATION COMMISSION  
Oil & Gas Conservation Division  
Post Office Box 52000  
Oklahoma City, Oklahoma 73152-2000  
Rule 165:10-3-25☒ ORIGINAL  
☐ AMENDED (Reason) \_\_\_\_\_

## COMPLETION REPORT

## TYPE OF DRILLING OPERATION

☒ STRAIGHT HOLE ☐ DIRECTIONAL HOLE ☐ HORIZONTAL HOLE  
☐ SERVICE WELL

If directional or horizontal, see reverse for bottom hole location.

COUNTY	Craig	SEC	18	TWP	27N	RGE	19E	SPUD DATE	07/31/2019
LEASE NAME	Fred Hartley			WELL NO.	22-18B			DRLG FINISHED DATE	08/01/2019
SE 1/4 NE 1/4 SE 1/4 NW 1/4	1/4 SEC			FWL OF 1/4 SEC	2490			DATE OF WELL COMPLETION	09/23/2019
ELEVATION	Ground	871	Latitude (if known)	36°49'27.9"			Longitude (if known)	95°18'54.3"	
OPERATOR NAME	Neok Production Company LLC				OTC / OCC OPERATOR NO.	21838			
ADDRESS	P.O. Box 428								
CITY	Nowata			STATE	Ok		ZIP	74048	

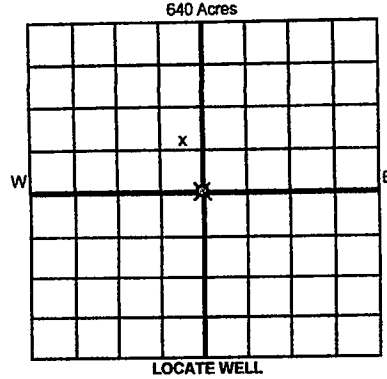

## COMPLETION TYPE

<input type="checkbox"/>	SINGLE ZONE
<input type="checkbox"/>	MULTIPLE ZONE
<input type="checkbox"/>	Application Date
<input checked="" type="checkbox"/>	COMINGLED
<input type="checkbox"/>	Application Date
<input type="checkbox"/>	LOCATION EXCEPTION
<input type="checkbox"/>	ORDER NO.
<input type="checkbox"/>	INCREASED DENSITY
<input type="checkbox"/>	ORDER NO.

## CASING &amp; CEMENT (Attach Form 1002C)

TYPE	SIZE	WEIGHT	GRADE	FEET	PSI	SAX	TOP OF CMT
CONDUCTOR	8-5/8"	20	J55	21		12	Surface
SURFACE							
INTERMEDIATE							
PRODUCTION	5-1/2"	17	J55	1006		130	Surface
LINER							
TOTAL DEPTH							1,010

PACKER @ \_\_\_\_\_ BRAND & TYPE \_\_\_\_\_ PLUG @ \_\_\_\_\_ TYPE \_\_\_\_\_ PLUG @ \_\_\_\_\_ TYPE \_\_\_\_\_  
PACKER @ \_\_\_\_\_ BRAND & TYPE \_\_\_\_\_ PLUG @ \_\_\_\_\_ TYPE \_\_\_\_\_ PLUG @ \_\_\_\_\_ TYPE \_\_\_\_\_

## COMPLETION &amp; TEST DATA BY PRODUCING FORMATION

FORMATION	Woodford-319 WDFD	169 ABCK - Arbuckle			
SPACING & SPACING	N/A	N/A			
ORDER NUMBER					
CLASS: Oil, Gas, Dry, Inj.	DRY	OIL			
Disp, Comm Disp, Svc					
PERFORATED INTERVALS	OH 1006'-1016'	OH 1016'-1025'			
	open hole	open hole			
ACID/VOLUME	150 GAL 15% HCL	150 GAL 15% HCL			
FRACTURE TREATMENT (Fluids/Prop Amounts)	N/A	N/A			
	N/A	N/A			
	N/A	N/A			

☒ Min Gas Allowable OR (165:10-17-7) Gas Purchaser/Measurer  
Oil Allowable (165:10-13-3) First Sales Date  
CVR  
1/6/2020

## INITIAL TEST DATA

INITIAL TEST DATE	9/24/2019	9/24/2019			
OIL-BBL/DAY	0	0.25			
OIL-GRAVITY ( API)	0	22			
GAS-MCF/DAY	0	0			
GAS-OIL RATIO CU FT/BBL	0	0			
WATER-BBL/DAY	0	15			
PUMPING OR FLOWING	Pumping	Pumping			
INITIAL SHUT-IN PRESSURE	0	0			
CHOKE SIZE					
FLOW TUBING PRESSURE	0	10			

A record of the formations drilled through, and pertinent remarks are presented on the reverse. I declare that I have knowledge of the contents of this report and am authorized by my organization to make this report, which was prepared by me or under my supervision and direction, with the data and facts stated herein to be true, correct, and complete to the best of my knowledge and belief.

SIGNATURE	Michael Frauenberger	DATE	1/28/2020	PHONE NUMBER	918.695.2230
P.O. Box 428	Nowata Ok 74048	mfrauenberger@neokprod.com			
ADDRESS	CITY	STATE	ZIP	EMAIL ADDRESS	

PLEASE TYPE OR USE BLACK INK ONLY

## FORMATION RECORD

Give formation names and tops, if available, or descriptions and thickness of formations drilled through. Show intervals cored or drillstem tested.

NAMES OF FORMATIONS	TOP
Croweburg Coal	119
Tebo Coal	256
Bartlesville Sand	370
Warner Sand	554
Mississippi Chat	608
Woddford Shale	967
Arbuckle	1,016

LEASE NAME Fred HartleyWELL NO. 22-18B

FOR COMMISSION USE ONLY	
ITD on file <input type="checkbox"/> YES <input type="checkbox"/> NO	
APPROVED _____ DISAPPROVED _____	2) Reject Codes
_____	
_____	
_____	
_____	

Were open hole logs run? ☒ yes ☐ no  
 Date Last log was run 8/13/2019  
 Was CO<sub>2</sub> encountered? ☐ yes ☒ no at what depths? \_\_\_\_\_  
 Was H<sub>2</sub>S encountered? ☐ yes ☒ no at what depths? \_\_\_\_\_  
 Were unusual drilling circumstances encountered? ☐ yes ☒ no  
 If yes, briefly explain below \_\_\_\_\_

Other remarks:

*OCC - This well is an open completion in both the Woddford from 1006' to 1016' and Arbuckle from 1016' to 1025' total depth.*

640 Acres

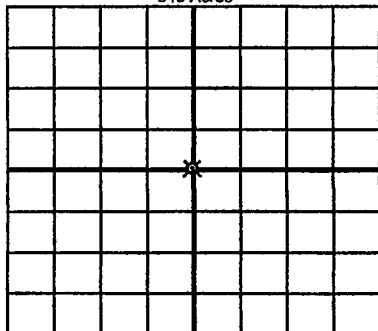

If more than three drainholes are proposed, attach a separate sheet indicating the necessary information.

Direction must be stated in degrees azimuth. Please note, the horizontal drainhole and its end point must be located within the boundaries of the lease or spacing unit.

Directional surveys are required for all drainholes and directional wells.

640 Acres

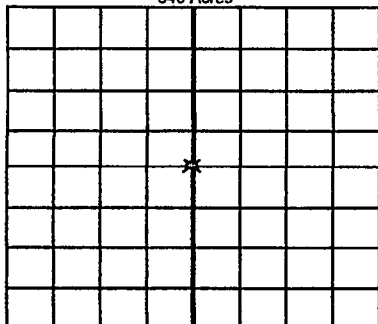

## BOTTOM HOLE LOCATION FOR DIRECTIONAL HOLE

SEC	TWP	RGE	COUNTY
Spot Location			
1/4	1/4	1/4	Feet From 1/4 Sec Lines
Measured Total Depth		True Vertical Depth	BHL From Lease, Unit, or Property Line:

## BOTTOM HOLE LOCATION FOR HORIZONTAL HOLE: (LATERALS)

SEC	TWP	RGE	COUNTY
Spot Location			
1/4	1/4	1/4	Feet From 1/4 Sec Lines
Depth of Deviation		Radius of Turn	Direction
Measured Total Depth		True Vertical Depth	BHL From Lease, Unit, or Property Line:

## LATERAL #2

SEC	TWP	RGE	COUNTY
Spot Location			
1/4	1/4	1/4	Feet From 1/4 Sec Lines
Depth of Deviation		Radius of Turn	Direction
Measured Total Depth		True Vertical Depth	BHL From Lease, Unit, or Property Line:

## LATERAL #3

SEC	TWP	RGE	COUNTY
Spot Location			
1/4	1/4	1/4	Feet From 1/4 Sec Lines
Depth of Deviation		Radius of Turn	Direction
Measured Total Depth		True Vertical Depth	BHL From Lease, Unit, or Property Line: