

Oklahoma Corporation Commission
Oil & Gas Conservation Division
Post Office Box 52000
Oklahoma City, Oklahoma 73152-2000
Rule 165: 10-3-25

Form 1002A

API No.: 35037294750000

Completion Report

Spud Date: June 19, 2021

OTC Prod. Unit No.:

Drilling Finished Date: July 23, 2021

1st Prod Date: September 23, 2021

Completion Date: August 10, 2021

Drill Type: STRAIGHT HOLE

Well Name: MANNING 2

Purchaser/Measurer:

Location: CREEK 29 15N 9E
NW SE SW NE
1990 FNL 1975 FEL of 1/4 SEC
Derrick Elevation: 0 Ground Elevation: 841

First Sales Date:

Operator: WFD OIL CORPORATION 17501

16800 CONIFER LN
EDMOND, OK 73012-0619

Completion Type		Location Exception		Increased Density	
X	Single Zone	Order No		Order No	
	Multiple Zone	There are no Location Exception records to display.		718100	
	Commingled				

Casing and Cement							
Type	Size	Weight	Grade	Feet	PSI	SAX	Top of CMT
SURFACE	9 5/8		NEW	443		200	SURFACE
PRODUCTION	7		NEW	2358		150	1250

Liner								
Type	Size	Weight	Grade	Length	PSI	SAX	Top Depth	Bottom Depth
There are no Liner records to display.								

Total Depth: 2387

Packer		Plug	
Depth	Brand & Type	Depth	Plug Type
There are no Packer records to display.		There are no Plug records to display.	

Initial Test Data										
Test Date	Formation	Oil BBL/Day	Oil-Gravity (API)	Gas MCF/Day	Gas-Oil Ratio Cu FT/BBL	Water BBL/Day	Pumpin or Flowing	Initial Shut-In Pressure	Choke Size	Flow Tubing Pressure
Sep 11, 2021	SKINNER	10	43				PUMPING			

Completion and Test Data by Producing Formation			
Formation Name: SKINNER		Code: 404SKNR	Class: OIL
Spacing Orders		Perforated Intervals	
Order No	Unit Size	From	To
264812	40	There are no Perf. Intervals records to display.	
Acid Volumes		Fracture Treatments	
200 GALLONS		There are no Fracture Treatments records to display.	

Formation	Top
LAYTON	1250
SKINNER	2288

Were open hole logs run? Yes
Date last log run: July 23, 2021

Were unusual drilling circumstances encountered? No
Explanation:

Other Remarks
There are no Other Remarks.

FOR COMMISSION USE ONLY	
Status: Accepted	1146931

OIL AND GAS CONSERVATION DIVISION
P.O. Box 52000
Oklahoma City, OK 73152-2000
405-522-0577
occentralprocessing@occ.ok.gov

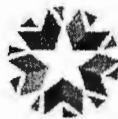

OKLAHOMA
Corporation
Commission

Form 1002A
Rev. 2009

<input checked="" type="checkbox"/> ORIGINAL <input type="checkbox"/> AMENDED (Reason)		WELL COMPLETION REPORT		OAC 165:10-3-25		(PLEASE TYPE OR USE BLACK INK ONLY)	
TYPE OF DRILLING OPERATION <input checked="" type="checkbox"/> STRAIGHT HOLE <input type="checkbox"/> DIRECTIONAL HOLE <input type="checkbox"/> HORIZONTAL HOLE		SPUD DATE 6/19/21		DRLG FINISHED DATE 7/23/21		DATE OF WELL COMPLETION 8/10/21	
If directional or horizontal, see reverse for bottom hole location.		DATE OF WELL COMPLETION 8/10/21		1st PROD DATE 9/23/21		RECOMP DATE	
COUNTY	CLARK	SEC	29	TWP	15N	RGE	9E
LEASE NAME	MORNING	WELL NO.	2	1st PROD DATE	9/23/21	RECOMP DATE	
NE 1/4 SE 1/4 SW 1/4 NE 1/4	1/4 SEC 1980	1/4 SEC	1975	Longitude (if known)		Latitude (if known)	
ELEVATION	Derick FL	Ground	841	Longitude (if known)		Latitude (if known)	
OPERATOR NAME	WFO OIL CORP	OTC / OCC OPERATOR NO.		17501			
ADDRESS	16800 Conifer Lane						
CITY	EDMOND	STATE	OK	ZIP	73012		

API NO. 037-2948
OTC PROD. UNIT NO.

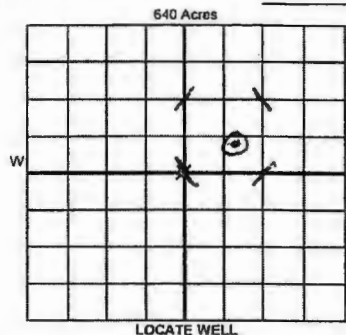

COMPLETION TYPE		CASING & CEMENT (Attach Form 1002C)							
<input checked="" type="checkbox"/> SINGLE ZONE		TYPE	SIZE	WEIGHT	GRADE	FEET	PSI	SAX	TOP OF CMT
<input type="checkbox"/> MULTIPLE ZONE		CONDUCTOR							
Application Date		SURFACE	956		NW	443		000	Surface
COMINGLED		INTERMEDIATE							
Application Date		PRODUCTION	7		NW	2358		150	1250
LOCATION EXCEPTION ORDER NO.		LINER							
INCREASED DENSITY ORDER NO.	718100								
PACKER @ BRAND & TYPE		PLUG @ TYPE	PLUG @ TYPE	TOTAL DEPTH		3387			
PACKER @ BRAND & TYPE		PLUG @ TYPE	PLUG @ TYPE						

COMPLETION & TEST DATA BY PRODUCING FORMATION		4045KNR	
FORMATION	Skinner	No Fr.	
SPACING & SPACING ORDER NUMBER	244812(40)		
CLASS: Oil, Gas, Dry, Inj, Disp, Comm Disp, Svc	Oil		
PERFORATED INTERVALS			
ACID/VOLUME	200 gals		
FRACTURE TREATMENT (Fluids/Prop Amounts)			

RECEIVED

SEP 28 2021

OKLAHOMA CORPORATION
COMMISSION

Min Gas Allowable (165:10-17-7)		Gas Purchaser/Measurer	
OR		First Sales Date	
Oil Allowable (165:10-13-3)			
INITIAL TEST DATE	9/11/21		
OIL-BBL/DAY	10		
OIL-GRAVITY (API)	43		
GAS-MCF/DAY	TSTM		
GAS-OIL RATIO CU FT/BBL	-		
WATER-BBL/DAY	-		
PUMPING OR FLOWING	Pumping		
INITIAL SHUT-IN PRESSURE			
CHOKE SIZE			
FLOW TUBING PRESSURE			
I record the formations drilled through, and pertinent remarks are presented on the reverse. I declare that I have knowledge of the contents of this report and am authorized by my organization to make this report, which was prepared by me or under my supervision and direction, with the data and facts stated herein to be true, correct, and complete to the best of my knowledge and belief.			
SIGNATURE		NAME (PRINT OR TYPE)	
16800 Conifer Lane		Edmond OK 73012	
ADDRESS		CITY STATE ZIP	
		DATE 9/23/2021 PHONE NUMBER 405-715-5157	
		EMAIL ADDRESS Bdot.wld@cox.int.net	

PLEASE TYPE OR USE BLACK INK ONLY

FORMATION RECORD

Give formation names and tops, if available, or descriptions and thickness of formations drilled through. Show intervals cored or drillstem tested.

NAMES OF FORMATIONS	TOP
LAYTON	1250
SKINNER	2288

LEASE NAME MANNING WELL NO. 2

FOR COMMISSION USE ONLY	
ITD on file <input type="checkbox"/> YES <input type="checkbox"/> NO	
APPROVED _____	DISAPPROVED _____
2) Reject Codes	

Were open hole logs run?	<input checked="" type="checkbox"/> yes <input type="checkbox"/> no
Date last log was run	<u>7/23/21</u>
Was CO ₂ encountered?	<input type="checkbox"/> yes <input checked="" type="checkbox"/> no at what depths? _____
Was H ₂ S encountered?	<input type="checkbox"/> yes <input checked="" type="checkbox"/> no at what depths? _____
Were unusual drilling circumstances encountered?	<input type="checkbox"/> yes <input checked="" type="checkbox"/> no
If yes, briefly explain below	

Other remarks:

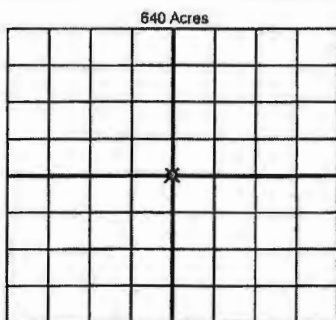

If more than three drainholes are proposed, attach a separate sheet indicating the necessary information.

Direction must be stated in degrees azimuth. Please note, the horizontal drainhole and its end point must be located within the boundaries of the lease or spacing unit.

Directional surveys are required for all drainholes and directional wells.
640 Acres

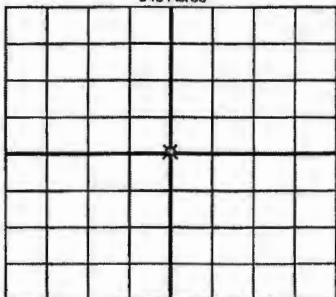

BOTTOM HOLE LOCATION FOR DIRECTIONAL HOLE

SEC	TWP	RGE	COUNTY
Spot Location		1/4	1/4
Measured Total Depth		True Vertical Depth	BHL From Lease, Unit, or Property Line:

BOTTOM HOLE LOCATION FOR HORIZONTAL HOLE: (LATERALS)

LATERAL #1			
SEC	TWP	RGE	COUNTY
Spot Location		1/4	1/4
Depth of Deviation		Radius of Turn	Direction
Measured Total Depth		True Vertical Depth	BHL From Lease, Unit, or Property Line:

LATERAL #2

SEC	TWP	RGE	COUNTY
Spot Location		1/4	1/4
Depth of Deviation		Radius of Turn	Direction
Measured Total Depth		True Vertical Depth	BHL From Lease, Unit, or Property Line:

LATERAL #3

SEC	TWP	RGE	COUNTY
Spot Location		1/4	1/4
Depth of Deviation		Radius of Turn	Direction
Measured Total Depth		True Vertical Depth	BHL From Lease, Unit, or Property Line: