

Oklahoma Corporation Commission
Oil & Gas Conservation Division
Post Office Box 52000
Oklahoma City, Oklahoma 73152-2000
Rule 165: 10-3-25

Form 1002A

API No.: 35119244470000

Completion Report

Spud Date: August 26, 2021

OTC Prod. Unit No.:

Drilling Finished Date: August 31, 2021

1st Prod Date:

Completion Date: August 31, 2021

Drill Type: STRAIGHT HOLE

Well Name: MARILYN 2-13

Purchaser/Measurer:

Location: PAYNE 13 19N 4E
C NE NE NW
330 FNL 2310 FWL of 1/4 SEC
Latitude: 36.129086 Longitude: -96.829462
Derrick Elevation: 0 Ground Elevation: 0

First Sales Date:

Operator: ROBERSON OIL COMPANY INC 19500
PO BOX 8
201 E COTTAGE ST
ADA, OK 74821-0008

Completion Type		Location Exception		Increased Density	
	Single Zone	Order No		Order No	
	Multiple Zone	There are no Location Exception records to display.		There are no Increased Density records to display.	
	Commingled				

Casing and Cement							
Type	Size	Weight	Grade	Feet	PSI	SAX	Top of CMT
SURFACE	8 5/8	24	J-55	252	2000	180	SURFACE

Liner								
Type	Size	Weight	Grade	Length	PSI	SAX	Top Depth	Bottom Depth
There are no Liner records to display.								

Total Depth: 3780

Packer		Plug	
Depth	Brand & Type	Depth	Plug Type
There are no Packer records to display.		There are no Plug records to display.	

Initial Test Data										
Test Date	Formation	Oil BBL/Day	Oil-Gravity (API)	Gas MCF/Day	Gas-Oil Ratio Cu FT/BBL	Water BBL/Day	Pumpin or Flowing	Initial Shut-In Pressure	Choke Size	Flow Tubing Pressure
There are no Initial Data records to display.										
Completion and Test Data by Producing Formation										

Formation Name: NONE

Code:

Class: DRY

Formation	Top
HOGSHOOTER LIME	2417
CHECKERBOARD LIME	2706
PRUE	2999
BIG LIME	3050
OSWEGO LIME	3126
VERDIGRIS	3251
PINK LIME	3397
RED FORK	3428
MISSISSIPPI	3672

Were open hole logs run? Yes

Date last log run: August 30, 2021

Were unusual drilling circumstances encountered? No

Explanation:

Other Remarks

There are no Other Remarks.

FOR COMMISSION USE ONLY

1146945

Status: Accepted

API NO. 119-24447
OTC PROD.
UNIT NO.

Oil and Gas Conservation Division
P.O. Box 52000
Oklahoma City, OK 73152-2000
405-521-2331
OCCCentralProcessing@OCC.OK.GOV



OKLAHOMA
Corporation
Commission

Form 1002A
Rev. 2020

☒ ORIGINAL
☐ AMENDED (Reason) _____

Rule 165:10-3-25

COMPLETION REPORT

TYPE OF DRILLING OPERATION

☒ STRAIGHT HOLE ☐ DIRECTIONAL HOLE ☐ HORIZONTAL HOLE

☐ SERVICE WELL

If directional or horizontal, see reverse for bottom hole location.

COUNTY	Payne	SEC	13	TWP	19N	RGE	04E	SPUD DATE	8/26/2021	
LEASE NAME	MARILYN	WELL NO.	2-13	DRLG FINISHED DATE	8/31/2021	DATE OF WELL COMPLETION			8/31/2021	
C	1/4 NE 1/4 NE 1/4 NW 1/4	FNL 330	FNL 2310	1st PROD DATE	N/A	RECOMP DATE				
ELEVATION	Ground	Latitude	36.129086	Longitude	-96.829462	OPERATOR NAME			ROBERSON OIL CO., INC.	
ADDRESS	P O BOX 8								OTC / OCC OPERATOR NO.	19500
CITY	ADA	STATE	OK	ZIP	74821					

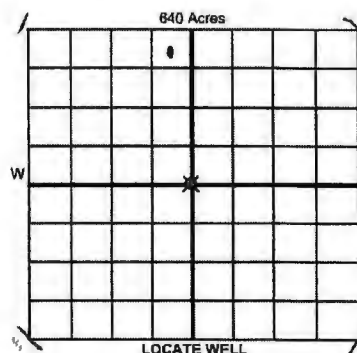

COMPLETION TYPE

<input type="radio"/> SINGLE ZONE	
<input type="radio"/> MULTIPLE ZONE	
<input type="radio"/> COMMINGLED	
LOCATION EXCEPTION ORDER NO.	
MULTIUNIT ORDER NO.	
INCREASED DENSITY ORDER NO.	

CASING & CEMENT (Attach Form 1002C)

TYPE	SIZE	WEIGHT	GRADE	FEET	PSI	SAX	TOP OF CMT
CONDUCTOR							
SURFACE	8 5/8"	24#	J-55	252'	2000	180	Surface
INTERMEDIATE							
PRODUCTION							
LINER							

PACKER @ _____ BRAND & TYPE _____ PLUG @ _____ TYPE _____ PLUG @ _____ TYPE _____ TOTAL DEPTH 3780

COMPLETION & TEST DATA BY PRODUCING FORMATION

FORMATION							
SPACING & SPACING ORDER NUMBER	No Spacing						
CLASS: Oil, Gas, Dry, Inj, Disp, Comm Disp, Svc	Dry Hole						
PERFORATED INTERVALS							
ACID/VOLUME							
FRACTURE TREATMENT (Fluids/Prop Amounts)							

RECEIVED

SEP 27 2021

OKLAHOMA CORPORATION COMMISSION

Min Gas Allowable (165:10-17-7)

OR

Oil Allowable (165:10-13-3)

Purchaser/Measurer

First Sales Date

INITIAL TEST DATA

INITIAL TEST DATE							
OIL-BBL/DAY							
OIL-GRAVITY (API)							
GAS-MCF/DAY							
GAS-OIL RATIO CU FT/BBL							
WATER-BBL/DAY							
PUMPING OR FLOWING							
INITIAL SHUT-IN PRESSURE							
CHOKE SIZE							
FLOW TUBING PRESSURE							

A record of the formations drilled through, and pertinent remarks are presented on the reverse. I declare that I have knowledge of the contents of this report and am authorized by my organization to make this report, which was prepared under my supervision and direction, with the data and facts stated herein to be true, correct, and complete to the best of my knowledge and belief.

SIGNATURE _____ NAME (PRINT OR TYPE) David Roberson, II
ADDRESS PO Box 8 CITY ADA STATE OK ZIP 74821
EMAIL ADDRESS ROIL11@yahoo.com

DATE 9-22-21 PHONE NUMBER 580-332-6170

PLEASE TYPE OR USE BLACK INK ONLY

FORMATION RECORD

Give formation names and tops, if available, or descriptions and thickness of formations drilled through. Show intervals cored or drillstem tested.

NAMES OF FORMATIONS	TOP
Hog shooter Lime	2417
Checkerboard Lime	2706
Prue	2999
Big Lime	3050
Oswego Lime	3126
Verdi. Gris	3251
Pink Lime	3397
Red Fork	3428
Mississippi	3672

LEASE NAME Marilyn 2-13

WELL NO. _____

FOR COMMISSION USE ONLY	
ITD on file <input type="checkbox"/> YES <input type="checkbox"/> NO	
APPROVED _____	DISAPPROVED _____
2) Reject Codes	

Were open hole logs run?	<input checked="" type="radio"/> yes <input type="radio"/> no	
Date Last log was run	<u>8-30-21</u>	
Was CO ₂ encountered?	<input type="radio"/> yes <input checked="" type="radio"/> no	at what depths? _____
Was H ₂ S encountered?	<input type="radio"/> yes <input checked="" type="radio"/> no	at what depths? _____
Were unusual drilling circumstances encountered?	<input type="radio"/> yes <input checked="" type="radio"/> no	
If yes, briefly explain below		

Other remarks: _____

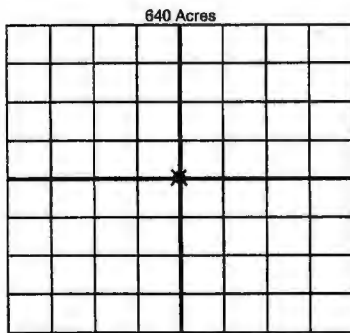

If more than three drainholes are proposed, attach a separate sheet indicating the necessary information.

Direction must be stated in degrees azimuth.
Please note, the horizontal drainhole and its end point must be located within the boundaries of the lease or spacing unit.

Directional surveys are required for all drainholes and directional wells

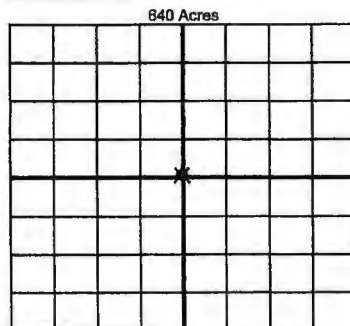

BOTTOM HOLE LOCATION FOR DIRECTIONAL HOLE

SEC	TWP	RGE	COUNTY
1/4	1/4	1/4	1/4
Measured Total Depth		True Vertical Depth	Feet From 1/4 Sec Lines BHL From Lease, Unit, or Property Line:

BOTTOM HOLE LOCATION FOR HORIZONTAL HOLE: (LATERALS)

LATERAL #1

SEC	TWP	RGE	COUNTY
1/4	1/4	1/4	1/4
Depth of Deviation		Radius of Turn	Direction
Measured Total Depth		True Vertical Depth	Total Length
		BHL From Lease, Unit, or Property Line:	

LATERAL #2

SEC	TWP	RGE	COUNTY
1/4	1/4	1/4	1/4
Depth of Deviation		Radius of Turn	Direction
Measured Total Depth		True Vertical Depth	Total Length
		BHL From Lease, Unit, or Property Line:	

LATERAL #3

SEC	TWP	RGE	COUNTY
1/4	1/4	1/4	1/4
Depth of Deviation		Radius of Turn	Direction
Measured Total Depth		True Vertical Depth	Total Length
		BHL From Lease, Unit, or Property Line:	