

Oklahoma Corporation Commission
Oil & Gas Conservation Division
Post Office Box 52000
Oklahoma City, Oklahoma 73152-2000
Rule 165: 10-3-25

Form 1002A

API No.: 35045237500000

Completion Report

Spud Date: August 19, 2018

OTC Prod. Unit No.: 045-225396-0-0000

Drilling Finished Date: October 04, 2018

1st Prod Date: April 15, 2019

Completion Date: April 13, 2019

Drill Type: HORIZONTAL HOLE

Min Gas Allowable: Yes

Well Name: SHREWDER 26-23 1H

Purchaser/Measurer: MARKWEST

Location: ELLIS 35 18N 23W
SE NE NW NE
500 FNL 1455 FEL of 1/4 SEC
Latitude: 35.99767 Longitude: -99.61775
Derrick Elevation: 27 Ground Elevation: 2260

First Sales Date: 04/15/2019

Operator: VALPOINT OPERATING LLC 23241

600 S TYLER ST STE 1701
AMARILLO, TX 79101-2353

Completion Type		Location Exception		Increased Density	
X	Single Zone	Order No		Order No	
	Multiple Zone	685032		There are no Increased Density records to display.	
	Commingled				

Casing and Cement							
Type	Size	Weight	Grade	Feet	PSI	SAX	Top of CMT
CONDUCTOR	20	54	H-40	120			SURFACE
SURFACE	13 3/8	48	J-55	538		470	SURFACE
INTERMEDIATE	9 5/8	40	L-80	4749		1240	SURFACE
INTERMEDIATE	7 5/8	29.7	P-110	9997		1145	3500
PRODUCTION	5 1/2	20	P-110	20475		990	8000

Liner								
Type	Size	Weight	Grade	Length	PSI	SAX	Top Depth	Bottom Depth
There are no Liner records to display.								

Total Depth: 20485

Packer	
Depth	Brand & Type
There are no Packer records to display.	

Plug	
Depth	Plug Type
There are no Plug records to display.	

Initial Test Data										
Test Date	Formation	Oil BBL/Day	Oil-Gravity (API)	Gas MCF/Day	Gas-Oil Ratio Cu FT/BBL	Water BBL/Day	Pumpin or Flowing	Initial Shut-In Pressure	Choke Size	Flow Tubing Pressure
Apr 15, 2019	OSWEGO	1076	38	1144	1063	1978	FLOWING	2000	35	975

Completion and Test Data by Producing Formation									
Formation Name: OSWEGO				Code: 404OSWG			Class: OIL		
Spacing Orders				Perforated Intervals					
Order No		Unit Size		From			To		
680103		1280		10179			20346		
Acid Volumes				Fracture Treatments					
121,716 GALS HCL				9,537,318 GALS WATER, 1,803,924 POUNDS 100 MESH SAND, 1,664,161 POUNDS 40/70 SAND					

Formation	Top
BASE HEEBNER	7367
DOUGLAS	7424
TONKAWA	7946
COTTAGE GROVE	8486
CLEVELAND SS	9088
BIG LIME	9565
OSWEGO	9750
EXCELLO SHALE	9798
CHEROKEE	10084

Were open hole logs run? No

Date last log run:

Were unusual drilling circumstances encountered? No

Explanation:

Other Remarks
7-5/8" CASING IS INTERMEDIATE AND 5-1/2" 20# CASING IS PRODUCTION. FRAC COMPLETED ON APRIL 3, 2019. FIRST OIL SALES ON APRIL 14, 2019. FIRST GAS SALES AND STARTED THROUGH PRODUCTION EQUIPMENT ON APRIL 15, 2019. OCC - THIS DOCUMENT IS ACCEPTED BASED ON THE DATA SUBMITTED THE FINAL LOCATION EXCEPTION HAS NOT BEEN ISSUED.

Lateral Holes
Sec: 23 TWP: 18N RGE: 23W County: ELLIS
NE NE NW NE
167 FNL 1459 FEL of 1/4 SEC
Depth of Deviation: 9270 Radius of Turn: 760 Direction: 354 Total Length: 10455
Measured Total Depth: 20485 True Vertical Depth: 9495 End Pt. Location From Release, Unit or Property Line: 167

FOR COMMISSION USE ONLY
Status: Accepted
1142976

Give formation names and tops, if available, or descriptions and thickness of formations drilled through. Show intervals cored or drillstem tested.

FOR COMMISSION USE ONLY	
ITD on file <input type="checkbox"/> YES <input type="checkbox"/> NO	
APPROVED DISAPPROVED	2) Reject Codes

Were open hole logs run? ___ yes X no

Date Last log was run N/A

Was CO₂ encountered? ___ yes X no at what depths? _____

Was H₂S encountered? ___ yes X no at what depths? _____

Were unusual drilling circumstances encountered? ___ yes X no
If yes, briefly explain below

Other remarks: 7-5/8" is Intermediate and 5 1/2" is production. 5-1/2" 20# is Production.

Frac Completed on 4/3/2019. First oil sales on 4/14/2019. First gas sales and started through production equipment on 4/15/2019.

~~PUN - 045 225396-0-0000~~

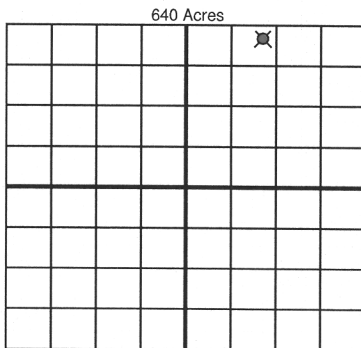

If more than three drainholes are proposed, attach a separate sheet indicating the necessary information.

Direction must be stated in degrees azimuth.
Please note, the horizontal drainhole and its end point must be located within the boundaries of the lease or spacing unit.

Directional surveys are required for all drainholes and directional wells.

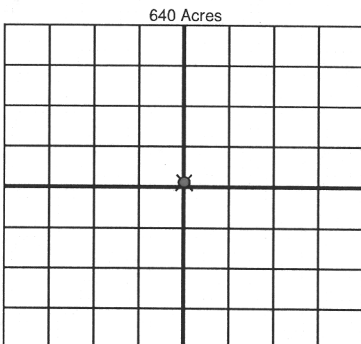

SEC	TWP	RGE	COUNTY			
Spot Location			Feet From 1/4 Sec Lines		FSL	FWL
1/4	1/4	1/4	1/4			
Measured Total Depth		True Vertical Depth		BHL From Lease, Unit, or Property Line:		

LATERAL #1										Per LE exhibit									
SEC	23	TWP	18	RGE	23W	COUNTY					Ellys								
Spot Location		NE 1/4		NW 1/4		NE 1/4		Feet From 1/4 Sec Lines			FNL 167' FEL 1459'								
NE		NE 1/4		NW 1/4		NE 1/4		FSL 2474'			EWL 1184'								
Depth of Deviation		9,270'		Radius of Turn		760'		Direction			Total Length								
Measured Total Depth		20,485		True Vertical Depth		9,495		BHL From Lease, Unit, or Property Line:			167' FNL and 1459' FEL								
								354' - 350.5'			10,455'								

SEC	TWP	RGE	COUNTY				
Spot Location			Feet From 1/4 Sec Lines		FSL		FWL
1/4	1/4	1/4	1/4				
Depth of Deviation		Radius of Turn		Direction	Total Length		
Measured Total Depth		True Vertical Depth		BHL From Lease, Unit, or Property Line:			

EXTERNAL #3									
SEC	TWP	RGE	COUNTY						
Spot Location				Feet From 1/4 Sec Lines		FSL		FWL	
1/4		1/4		1/4		1/4			
Depth of Deviation		Radius of Turn		Direction		Total Length			
Measured Total Depth		True Vertical Depth		BHL From Lease, Unit, or Property Line:					