

Oklahoma Corporation Commission  
Oil & Gas Conservation Division  
Post Office Box 52000  
Oklahoma City, Oklahoma 73152-2000  
Rule 165: 10-3-25

Form 1002A

API No.: 35103247630000

**Completion Report**

Spud Date: October 14, 2019

OTC Prod. Unit No.:

Drilling Finished Date: October 23, 2019

1st Prod Date:

Completion Date: January 09, 2020

**Drill Type: STRAIGHT HOLE**

Well Name: SLECSU 131

Purchaser/Measurer:

Location: NOBLE 13 20N 1W  
NW SE SE SW  
360 FSL 2250 FWL of 1/4 SEC  
Latitude: 36.203723134 Longitude: -97.256852834  
Derrick Elevation: 1142 Ground Elevation: 1133

First Sales Date:

Operator: MID-CON ENERGY OPERATING LLC 23271

2431 E 61ST ST STE 850  
TULSA, OK 74136-1236

Completion Type		Location Exception		Increased Density	
X	Single Zone	Order No		Order No	
	Multiple Zone	There are no Location Exception records to display.		There are no Increased Density records to display.	
	Commingled				

Casing and Cement							
Type	Size	Weight	Grade	Feet	PSI	SAX	Top of CMT
SURFACE	8 5/8	24	J-55	315		210	SURFACE
PRODUCTION	5 1/2	15.5	J-55	4553		595	SURFACE

Liner								
Type	Size	Weight	Grade	Length	PSI	SAX	Top Depth	Bottom Depth
There are no Liner records to display.								

**Total Depth: 4567**

Packer		Plug	
Depth	Brand & Type	Depth	Plug Type
4300	AS 1-X	There are no Plug records to display.	

Initial Test Data										
Test Date	Formation	Oil BBL/Day	Oil-Gravity (API)	Gas MCF/Day	Gas-Oil Ratio Cu FT/BBL	Water BBL/Day	Pumpin or Flowing	Initial Shut-In Pressure	Choke Size	Flow Tubing Pressure
There are no Initial Data records to display.										



**Completion and Test Data by Producing Formation**

Formation Name: CLEVELAND

Code: 405CLVD

Class: INJ

**Spacing Orders**

Order No	Unit Size
45977	UNIT

**Perforated Intervals**

From	To
4384	4400

**Acid Volumes**

750 GALLONS 15%

**Fracture Treatments**

There are no Fracture Treatments records to display.

Formation	Top
AVANT	3386
OSAGE LAYTON	3459
LAYTON	3795
CHECKERBOARD	4244
CLEVELAND	4291
BIG LIME	4431
OSWEGO	4551

Were open hole logs run? Yes

Date last log run: January 09, 2020

Were unusual drilling circumstances encountered? No

Explanation:

**Other Remarks**

REFERENCE INJECTION PERMIT NUMBER 2003700020 (DECEMBER 5, 2019)

**FOR COMMISSION USE ONLY**

1146590

Status: Accepted



API NO. 35-103-24763  
OTC PROD. UNIT NO. 10321092

Oil and Gas Conservation Division  
P.O. Box 52000  
Oklahoma City, OK 73152-2000  
405-522-0577  
OCCCentralProcessing@OCC.OK.GOV



OKLAHOMA  
Corporation  
Commission

Form 1002A  
Rev. 2020

submitted  
6-15-2021  
PKN

ORIGINAL  
AMENDED (Reason)

Rule 165:10-3-25

COMPLETION REPORT

TYPE OF DRILLING OPERATION

☒ STRAIGHT HOLE ☐ DIRECTIONAL HOLE ☐ HORIZONTAL HOLE  
☐ SERVICE WELL

If directional or horizontal, see reverse for bottom hole location.

COUNTY Noble SEC 13 TWP 20N RGE 1W  
LEASE NAME SLECSU WELL NO. 131  
NW 1/4 SE 1/4 SE 1/4 SW 1/4 FSL 360 FWL 2250  
ELEVATION Derrick FL 1142 Ground 1133 Latitude 36.203723134 Longitude -97.256852834  
OPERATOR NAME Mid-Con Energy Operating, LLC. OTC / OCC OPERATOR NO. 23271  
ADDRESS 2431 E 61st St, Suite 850  
CITY Tulsa STATE Oklahoma ZIP 74136

SPUD DATE 10/14/2019  
DRLG FINISHED DATE 10/23/2019  
DATE OF WELL COMPLETION 01/09/2020  
1st PROD DATE  
RECOMP DATE

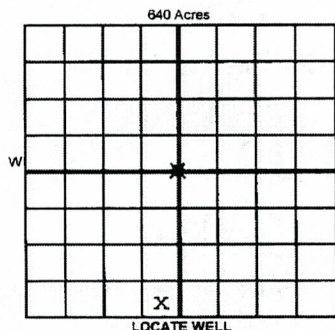

COMPLETION TYPE

☒ SINGLE ZONE  
☐ MULTIPLE ZONE  
☐ Application Date  
☐ COMMINGLED  
☐ Application Date  
LOCATION EXCEPTION ORDER NO.  
MULTIUNIT ORDER NO.  
INCREASED DENSITY ORDER NO.

CASING & CEMENT (Attach Form 1002C)

TYPE	SIZE	WEIGHT	GRADE	FEET	PSI	SAX	TOP OF CMT
CONDUCTOR							
SURFACE	8 5/8	24#	J-55	315		210	Surface
INTERMEDIATE							
PRODUCTION	5 1/2	15.5#	J-55	4553		595	Surface
LINER							

PACKER @ 4300' BRAND & TYPE AS 1-X PLUG @ TYPE PLUG @ TYPE TOTAL DEPTH 4567  
PACKER @ BRAND & TYPE PLUG @ TYPE PLUG @ TYPE

COMPLETION & TEST DATA BY PRODUCING FORMATION

FORMATION	Cleveland						No Frac
SPACING & SPACING ORDER NUMBER	45977 (unit)						
CLASS: Oil, Gas, Dry, Inj. Disp, Comm Disp, Svc	Inj						
PERFORATED INTERVALS	4384-4400 1 SPF						
ACID/VOLUME	750 Gals 15%						
FRACTURE TREATMENT (Fluids/Prop Amounts)							

☐ Min Gas Allowable (165:10-17-7)  
OR  
☐ Oil Allowable (165:10-13-3)

Purchaser/Measurer  
First Sales Date

INITIAL TEST DATA

INITIAL TEST DATE	Inj Well						
OIL-BBL/DAY							
OIL-GRAVITY (API)							
GAS-MCF/DAY							
GAS-OIL RATIO CU FT/BBL							
WATER-BBL/DAY							
PUMPING OR FLOWING							
INITIAL SHUT-IN PRESSURE							
CHOKE SIZE							
FLOW TUBING PRESSURE							

A record of the formations drilled through, and pertinent remarks are presented on the reverse. I declare that I have knowledge of the contents of this report and am authorized by my organization to make this report, which was prepared by me or under my supervision and direction, with the data and facts stated herein to be true, correct, and complete to the best of my knowledge and belief.

Mark Postulart, Engineering Analyst  
NAME (PRINT OR TYPE)

06/14/2021 (918) 392-3332  
DATE PHONE NUMBER

2431 E 61st ST, Suite 800

Tulsa

OK 74136

Mark.Postulart@contango.com

ADDRESS

CITY

STATE

ZIP

EMAIL ADDRESS



PLEASE TYPE OR USE BLACK INK ONLY

FORMATION RECORD

Give formation names and tops, if available, or descriptions and thickness of formations drilled through. Show intervals cored or drillstem tested.

NAMES OF FORMATIONS	TOP
Avant	3386
Osage Layton	3459
Layton	3795
Checkerboard	4244
Cleveland	4291
Big Lime	4431
Oswego	4551

LEASE NAME \_\_\_\_\_ SUECSU \_\_\_\_\_ WELL NO. \_\_\_\_\_ 131

FOR COMMISSION USE ONLY	
ITD on file <input type="checkbox"/> YES <input type="checkbox"/> NO	
APPROVED _____ DISAPPROVED _____	2) Reject Codes
<div></div> <div></div> <div></div> <div></div> <div></div>	

Were open hole logs run?	<input checked="" type="radio"/> yes <input type="radio"/> no
Date Last log was run	01/09/2020
Was CO <sub>2</sub> encountered?	<input type="radio"/> yes <input checked="" type="radio"/> no at what depths? _____
Was H <sub>2</sub> S encountered?	<input type="radio"/> yes <input checked="" type="radio"/> no at what depths? _____
Were unusual drilling circumstances encountered?	<input type="radio"/> yes <input checked="" type="radio"/> no
If yes, briefly explain below	

Other remarks: Reference injection permit 2003700020 (12/05/19)

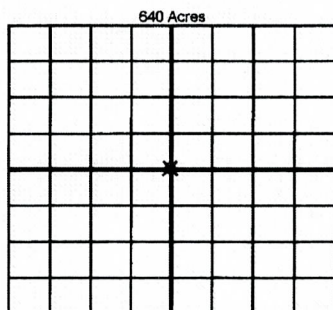

If more than three drainholes are proposed, attach a separate sheet indicating the necessary information.

Direction must be stated in degrees azimuth. Please note, the horizontal drainhole and its end point must be located within the boundaries of the lease or spacing unit.

Directional surveys are required for all drainholes and directional wells

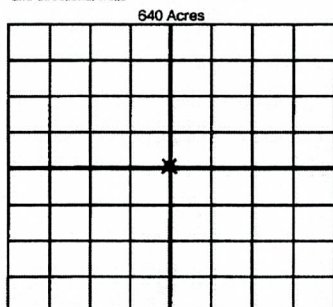

BOTTOM HOLE LOCATION FOR DIRECTIONAL HOLE

SEC	TWP	RGE	COUNTY
1/4	1/4	1/4	1/4
Measured Total Depth		True Vertical Depth	
Feet From 1/4 Sec Lines		BHL From Lease, Unit, or Property Line:	

BOTTOM HOLE LOCATION FOR HORIZONTAL HOLE: (LATERALS)

LATERAL #1			
SEC	TWP	RGE	COUNTY
1/4	1/4	1/4	1/4
Depth of Deviation		Radius of Turn	
Measured Total Depth		True Vertical Depth	
Feet From 1/4 Sec Lines		Total Length	
Direction		BHL From Lease, Unit, or Property Line:	

LATERAL #2			
SEC	TWP	RGE	COUNTY
1/4	1/4	1/4	1/4
Depth of Deviation		Radius of Turn	
Measured Total Depth		True Vertical Depth	
Feet From 1/4 Sec Lines		Total Length	
Direction		BHL From Lease, Unit, or Property Line:	

LATERAL #3			
SEC	TWP	RGE	COUNTY
1/4	1/4	1/4	1/4
Depth of Deviation		Radius of Turn	
Measured Total Depth		True Vertical Depth	
Feet From 1/4 Sec Lines		Total Length	
Direction		BHL From Lease, Unit, or Property Line:	