

Oklahoma Corporation Commission
Oil & Gas Conservation Division
Post Office Box 52000
Oklahoma City, Oklahoma 73152-2000
Rule 165: 10-3-25

Form 1002A

API No.: 35125225680002

Completion Report

Spud Date: April 19, 1985

OTC Prod. Unit No.:

Drilling Finished Date: April 29, 1985

Amended

1st Prod Date: May 04, 1985

Amend Reason: RECLASSIFY TO DRY

Completion Date: May 01, 1985

Recomplete Date: September 30, 2020

Drill Type: STRAIGHT HOLE

Well Name: SPENCER 24-4

Purchaser/Measurer:

Location: POTTAWATOMIE 24 6N 4E
C SW SE SE
330 FSL 1650 FWL of 1/4 SEC
Derrick Elevation: 0 Ground Elevation: 0

First Sales Date:

Operator: CANTRELL ROBERT R 17498
PO BOX 1433
11330 COUNTY ROAD 3560
ADA, OK 74821-1433

Completion Type		Location Exception		Increased Density	
	Single Zone	Order No		Order No	
	Multiple Zone	There are no Location Exception records to display.		There are no Increased Density records to display.	
	Commingled				

Casing and Cement							
Type	Size	Weight	Grade	Feet	PSI	SAX	Top of CMT
SURFACE	8 5/8	23	K-55	450		250	SURFACE
PRODUCTION	4 1/2	10.5	J-55	3815		450	1420

Liner								
Type	Size	Weight	Grade	Length	PSI	SAX	Top Depth	Bottom Depth
There are no Liner records to display.								

Total Depth: 3807

Packer	
Depth	Brand & Type
There are no Packer records to display.	

Plug	
Depth	Plug Type
2600	CIBP
2915	CIBP

Initial Test Data

Test Date	Formation	Oil BBL/Day	Oil-Gravity (API)	Gas MCF/Day	Gas-Oil Ratio Cu FT/BBL	Water BBL/Day	Pumpin or Flowing	Initial Shut- In Pressure	Choke Size	Flow Tubing Pressure
-----------	-----------	----------------	----------------------	----------------	----------------------------	------------------	----------------------	---------------------------------	---------------	-------------------------

There are no Initial Data records to display.

Completion and Test Data by Producing Formation

Formation Name: EARLSBORO

Code: 404ERLB

Class: DRY

Spacing Orders		Perforated Intervals	
Order No	Unit Size	From	To
348690		2792	2812
Acid Volumes		Fracture Treatments	
1,200 GALLONS		NONE	

Formation Name: HUNTON

Code: 269HNTN

Class: DRY

Spacing Orders		Perforated Intervals	
Order No	Unit Size	From	To
There are no Spacing Order records to display.		3146	3156
Acid Volumes		Fracture Treatments	
10,000 GALLONS		NONE	

Formation	Top
EARLSBORO	2790

Were open hole logs run? No

Date last log run:

Were unusual drilling circumstances encountered? No

Explanation:

Other Remarks

PUMPED 100 SACKS OF CEMENT. 52 OF THAT BEHIND THE CASING AND FILLED CASING TO 1,420'. TESTED TO 1,200 PSI. OCC - TERMINATED INJECTION 10/12/2020 BY FORM 1072. BOTH ZONES BELOW CIBP'S.

FOR COMMISSION USE ONLY

1146585

Status: Accepted

API NO. 35-12522568
OTC PROD. UNIT NO. 125-36460-3019

P.O. Box 52000
Oklahoma City, OK 73152-2000
405-522-0577
OCCCentralProcessing@OCC.OK.GOV



OKLAHOMA
Corporation
Commission

Received
10-16-2020
with 1003A
DATA

Form 1002A
Rev. 2020

ORIGINAL
AMENDED (Reason)

Reclassification to Dry
(Cover to Producer)

Rule 165:10-3-25

COMPLETION REPORT

TYPE OF DRILLING OPERATION

☒ STRAIGHT HOLE ☐ DIRECTIONAL HOLE ☐ HORIZONTAL HOLE
☐ SERVICE WELL

If directional or horizontal, see reverse for bottom hole location.

COUNTY	Potawatomie	SEC	24	TWP	6N	RGE	4E
LEASE NAME	Spencer (24)			WELL NO.	24-4		
1/4 SW 1/4 SE 1/4 SE 1/4	FSL	330	FWL	1650	DATE OF WELL COMPLETION	5-1-85	
ELEVATION	Ground	Latitude			1st PROD DATE	5-4-85	
Derrick FL			Longitude				
OPERATOR NAME	Robert R. Cantrell			OTC / OCC OPERATOR NO.	17498		
ADDRESS	PO Box 1433						
CITY	Ada	STATE	Ok	ZIP	74821		

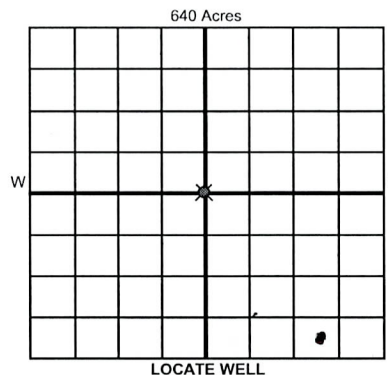

COMPLETION TYPE

<input type="radio"/> SINGLE ZONE	
<input type="radio"/> MULTIPLE ZONE	
<input type="radio"/> COMMINGLED	
LOCATION EXCEPTION ORDER NO.	
MULTIUNIT ORDER NO.	
INCREASED DENSITY ORDER NO.	

CASING & CEMENT (Attach Form 1002C)

TYPE	SIZE	WEIGHT	GRADE	FEET	PSI	SAX	TOP OF CMT
CONDUCTOR							
SURFACE	8 5/8	23	K-55	450		250	surface
INTERMEDIATE							
PRODUCTION	4 1/2	10.5	J-55	3815	450	350	2550'
Production - Fill inside casing						100	1420' Initial Now

PACKER @ BRAND & TYPE PLUG @ 2600 TYPE CIBP PLUG @ TYPE TOTAL DEPTH 3807
PACKER @ BRAND & TYPE PLUG @ 2915 TYPE CIBP PLUG @ TYPE

COMPLETION & TEST DATA BY PRODUCING FORMATION

FORMATION	Earlsboro	Hunton				
SPACING & SPACING ORDER NUMBER	348690					
CLASS: Oil, Gas, Dry, Inj, Disp, Comm Disp, Svc	Inj Dry	Dry	both zones below plugs			
PERFORATED INTERVALS	2792-2812	3146-3156				
ACID/VOLUME	1200 Gal	10,000 gal				
FRACTURE TREATMENT (Fluids/Prop Amounts)	NO	NO				

Min Gas Allowable (165:10-17-7)

Purchaser/Measurer

TrainsOil

INITIAL TEST DATA

Oil Allowable (165:10-13-3)

INITIAL TEST DATE	6-12-1985				
OIL-BBL/DAY	15				
OIL-GRAVITY (API)	36				
GAS-MCF/DAY	0				
GAS-OIL RATIO CU FT/BBL	0				
WATER-BBL/DAY	2				
PUMPING OR FLOWING	pumping				
INITIAL SHUT-IN PRESSURE					
CHOKE SIZE					
FLOW TUBING PRESSURE					

A record of the formations drilled through, and pertinent remarks are presented on the reverse. I declare that I have knowledge of the contents of this report and am authorized by my organization to make this report, which was prepared by me or under my supervision and direction, with the data and facts stated herein to be true, correct, and complete to the best of my knowledge and belief.

SIGNATURE: Robert R. Cantrell
ADDRESS: PO Box 1433
CITY: Ada
STATE: OK
ZIP: 74821
DATE: 10-12-20
PHONE NUMBER: 530.392.9495
EMAIL ADDRESS: lizwillburn@yahoo.com

PLEASE TYPE OR USE BLACK INK ONLY
FORMATION RECORD

Give formation names and tops, if available, or descriptions and thickness of formations drilled through. Show intervals cored or drillstem tested.

NAMES OF FORMATIONS	TOP
Earlsboro	2790

LEASE NAME _____ WELL NO. _____

FOR COMMISSION USE ONLY	
ITD on file <input type="checkbox"/> YES <input type="checkbox"/> NO	
APPROVED _____ DISAPPROVED _____	2) Reject Codes

Were open hole logs run?	<input type="radio"/> yes <input type="radio"/> no
Date Last log was run	_____
Was CO ₂ encountered?	<input type="radio"/> yes <input type="radio"/> no at what depths? _____
Was H ₂ S encountered?	<input type="radio"/> yes <input type="radio"/> no at what depths? _____
Were unusual drilling circumstances encountered?	<input type="radio"/> yes <input type="radio"/> no
If yes, briefly explain below	

Other remarks: Pumped 100 sacks of cement. 52 of that behind the casing and filled casing to 1420' Tested to 1200 PSI.

OCC-Terminated injection 10-12-2020 by 1072

640 Acres

BOTTOM HOLE LOCATION FOR DIRECTIONAL HOLE

SEC	TWP	RGE	COUNTY
1/4	1/4	1/4	1/4
Measured Total Depth	True Vertical Depth	Feet From 1/4 Sec Lines	
		BHL From Lease, Unit, or Property Line:	

BOTTOM HOLE LOCATION FOR HORIZONTAL HOLE: (LATERALS)

LATERAL #1

SEC	TWP	RGE	COUNTY
1/4	1/4	1/4	1/4
Depth of Deviation	Radius of Turn	Direction	Total Length
Measured Total Depth	True Vertical Depth	BHL From Lease, Unit, or Property Line:	

LATERAL #2

SEC	TWP	RGE	COUNTY
1/4	1/4	1/4	1/4
Depth of Deviation	Radius of Turn	Direction	Total Length
Measured Total Depth	True Vertical Depth	BHL From Lease, Unit, or Property Line:	

LATERAL #3

SEC	TWP	RGE	COUNTY
1/4	1/4	1/4	1/4
Depth of Deviation	Radius of Turn	Direction	Total Length
Measured Total Depth	True Vertical Depth	BHL From Lease, Unit, or Property Line:	

If more than three drainholes are proposed, attach a separate sheet indicating the necessary information.

Direction must be stated in degrees azimuth. Please note, the horizontal drainhole and its end point must be located within the boundaries of the lease or spacing unit.

Directional surveys are required for all drainholes and directional wells

640 Acres