

Oklahoma Corporation Commission  
Oil & Gas Conservation Division  
Post Office Box 52000  
Oklahoma City, Oklahoma 73152-2000  
Rule 165: 10-3-25

Form 1002A

API No.: 35071242450001

**Completion Report**

Spud Date: June 07, 2008

OTC Prod. Unit No.: 071-125497-0-0000

Drilling Finished Date: June 12, 2008

**Amended**

1st Prod Date: December 06, 2008

Amend Reason: ADD PERFORATIONS TO EXISTING ZONE

Completion Date: November 25, 2008

Recomplete Date: June 03, 2021

**Drill Type: STRAIGHT HOLE**

Well Name: BELL 1-10

Purchaser/Measurer:

Location: KAY 10 28N 1W  
SW SW SE NW  
100 FSL 1500 FWL of 1/4 SEC  
Derrick Elevation: 1099 Ground Elevation: 1086

First Sales Date:

Operator: BARBER OIL LLC 24363

8801 S YALE AVE STE 150  
TULSA, OK 74137-3575

Completion Type	
X	Single Zone
	Multiple Zone
	Commingled

Location Exception	
Order No	
There are no Location Exception records to display.	

Increased Density	
Order No	
There are no Increased Density records to display.	

Casing and Cement							
Type	Size	Weight	Grade	Feet	PSI	SAX	Top of CMT
SURFACE	8 5/8	24		202		170	SURFACE
PRODUCTION	4 1/2	10.5		3447		300	2245

Liner								
Type	Size	Weight	Grade	Length	PSI	SAX	Top Depth	Bottom Depth
There are no Liner records to display.								

**Total Depth: 3542**

Packer	
Depth	Brand & Type
There are no Packer records to display.	

Plug	
Depth	Plug Type
There are no Plug records to display.	

Initial Test Data
-------------------

Test Date	Formation	Oil BBL/Day	Oil-Gravity (API)	Gas MCF/Day	Gas-Oil Ratio Cu FT/BBL	Water BBL/Day	Pumpin or Flowing	Initial Shut-In Pressure	Choke Size	Flow Tubing Pressure
Dec 06, 2008	CLEVELAND	15.21	39	284	18665	10	FLOWING	260	21/64	80
Jun 05, 2021	CLEVELAND	3.33	39			64	PUMPING			

#### Completion and Test Data by Producing Formation

Formation Name: CLEVELAND

Code: 405CLVD

Class: OIL

#### Spacing Orders

Order No	Unit Size
103737	640

#### Perforated Intervals

From	To
3172	3183
3204	3219
3183	3204

#### Acid Volumes

NEW PERFORATONS 3172 - 3219 - 2,000 GALLONS;  
ORIGINAL PERFORATONS 3183 - 3204 - 1,000 GALLONS

#### Fracture Treatments

ORIGINAL PERFORATIONS 3183 - 3204 - 700 BARRELS

Formation	Top
CLEVELAND	3171

Were open hole logs run? Yes

Date last log run: June 12, 2008

Were unusual drilling circumstances encountered? No

Explanation:

#### Other Remarks

OCC - THE ORIGINAL PERFORATIONS WERE FROM 3183' TO 3204'.

#### FOR COMMISSION USE ONLY

1146583

Status: Accepted

API NO. 35-071-24245  
OTC PROD. UNIT NO. 071-125497

Oil and Gas Conservation Division  
P.O. Box 52000  
Oklahoma City, OK 73152-2000  
405-522-0577  
OCCCentralProcessing@OCC.OK.GOV



OKLAHOMA  
Corporation  
Commission

Form 1002A  
Rev. 2020

submitted  
6-15-21  
*[Signature]*



ORIGINAL  
AMENDED (Reason)

add perforations to existing zone

Rule 165:10-3-25

COMPLETION REPORT

TYPE OF DRILLING OPERATION

☒ STRAIGHT HOLE ☐ DIRECTIONAL HOLE ☐ HORIZONTAL HOLE  
☐ SERVICE WELL

If directional or horizontal, see reverse for bottom hole location.

COUNTY	Key	SEC	10	TWP	28N	RGE	1W	SPUD DATE	6/7/2008
LEASE NAME	Bell	WELL NO.	1-10	DRLG FINISHED DATE	6/12/2008	DATE OF WELL COMPLETION	11/25/2008	1st PROD DATE	12/6/2008
SW 1/4 SW 1/4 SE 1/4 NW 1/4	FBL	100'	FWL	1500'	RECOMP DATE	6/3/2021			
ELEVATION Derrick FL	1099	Ground	1086	Latitude		Longitude			
OPERATOR NAME	Barber Oil, LC	OTC / OCC OPERATOR NO.	24363						
ADDRESS	8801 South Yale Avenue, Suite 150								
CITY	Tulsa	STATE	OK	ZIP	74137				

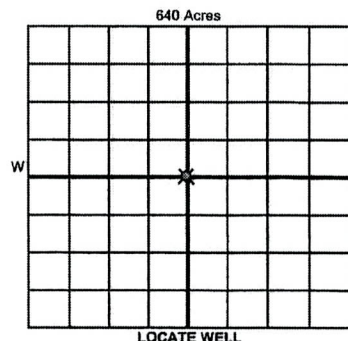

LOCATE WELL

COMPLETION TYPE

<input checked="" type="radio"/> SINGLE ZONE	
<input type="radio"/> MULTIPLE ZONE	
Application Date	
<input type="radio"/> COMMINGLED	
Application Date	
LOCATION EXCEPTION ORDER NO.	
MULTIUNIT ORDER NO.	
INCREASED DENSITY ORDER NO.	

CASING & CEMENT (Attach Form 1002C)

TYPE	SIZE	WEIGHT	GRADE	FEET	PSI	SAX	TOP OF CMT
CONDUCTOR							
SURFACE	8 5/8"	24#		202		170	Surface
INTERMEDIATE							
PRODUCTION	4 1/2"	10.5#		3447		300	2245
LINER							

PACKER @ \_\_\_\_\_ BRAND & TYPE \_\_\_\_\_ PLUG @ \_\_\_\_\_ TYPE \_\_\_\_\_ PLUG @ \_\_\_\_\_ TYPE \_\_\_\_\_ TOTAL DEPTH 3542'

COMPLETION & TEST DATA BY PRODUCING FORMATION

FORMATION	Cleveland	Cleveland				
SPACING & SPACING ORDER NUMBER	103737 - 640 ac					
CLASS: Oil, Gas, Dry, Inj, Disp, Comm Disp, Svc	Oil					
PERFORATED INTERVALS	3172'-3183'	original completion				
	3204'-3219	3183'-3204'				
ACID/VOLUME	2000 gals	1000 gals				
FRACTURE TREATMENT (Fluids/Prop Amounts)	(new treatment)	700 bbls (original treatment)				

☐ Min Gas Allowable (165:10-17-7)  
OR  
☐ Oil Allowable (165:10-13-3)

Purchaser/Measurer  
First Sales Date

INITIAL TEST DATA

INITIAL TEST DATE	6/5/2021	12/6/2008			
OIL-BBL/DAY	3.33	15.21			
OIL-GRAVITY ( API)	39	39			
GAS-MCF/DAY	0	283.9			
GAS-OIL RATIO CU FT/BBL	0	18665			
WATER-BBL/DAY	64	10.02			
PUMPING OR FLOWING	Pumping	Flowing			
INITIAL SHUT-IN PRESSURE	N/A	260			
CHOKE SIZE	N/A	21/64			
FLOW TUBING PRESSURE	N/A	80			

A record of the formations drilled through, and pertinent remarks are presented on the reverse. I declare that I have knowledge of the contents of this report and am authorized by my organization to make this report, which was prepared by me or under my supervision and direction, with the data and facts stated herein to be true, correct, and complete to the best of my knowledge and belief.

*Barbara Courtney*

Barbara Courtney

918-638-5951

SIGNATURE

NAME (PRINT OR TYPE)

DATE

PHONE NUMBER

8801 South Yale Ave, Suite 150

Tulsa

OK

74137

bcourtney@barberoilo.com

ADDRESS

CITY

STATE

ZIP

EMAIL ADDRESS

**PLEASE TYPE OR USE BLACK INK ONLY**  
**FORMATION RECORD**

Give formation names and tops, if available, or descriptions and thickness of formations drilled through. Show intervals cored or drillstem tested.

NAMES OF FORMATIONS	TOP
Cleveland	3171'

LEASE NAME \_\_\_\_\_ WELL NO. \_\_\_\_\_

FOR COMMISSION USE ONLY	
ITD on file <input type="checkbox"/> YES <input type="checkbox"/> NO	
APPROVED _____	DISAPPROVED _____
2) Reject Codes	

Were open hole logs run?	<input checked="" type="radio"/> yes <input type="radio"/> no
Date Last log was run	6/12/2008
Was CO <sub>2</sub> encountered?	<input type="radio"/> yes <input checked="" type="radio"/> no at what depths? _____
Was H <sub>2</sub> S encountered?	<input type="radio"/> yes <input checked="" type="radio"/> no at what depths? _____
Were unusual drilling circumstances encountered?	<input type="radio"/> yes <input checked="" type="radio"/> no
If yes, briefly explain below	

Other remarks:

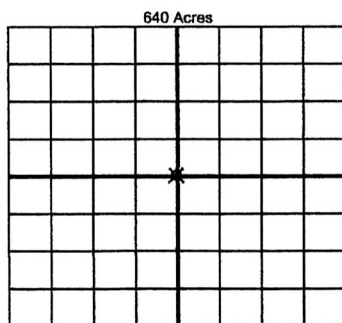
If more than three drainholes are proposed, attach a separate sheet indicating the necessary information.

Direction must be stated in degrees azimuth.  
Please note, the horizontal drainhole and its end point must be located within the boundaries of the lease or spacing unit.

Directional surveys are required for all drainholes and directional wells

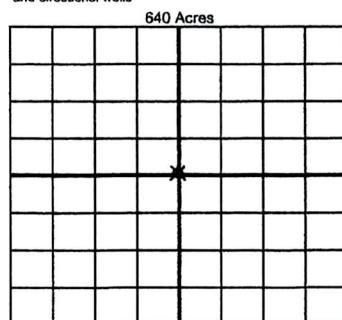

**BOTTOM HOLE LOCATION FOR DIRECTIONAL HOLE**

SEC	TWP	RGE	COUNTY
1/4	1/4	1/4	1/4
Measured Total Depth		True Vertical Depth	Feet From 1/4 Sec Lines BHL From Lease, Unit, or Property Line:

**BOTTOM HOLE LOCATION FOR HORIZONTAL HOLE: (LATERALS)**

LATERAL #1			
SEC	TWP	RGE	COUNTY
1/4	1/4	1/4	1/4
Depth of Deviation	Radius of Turn	Direction	Total Length
Measured Total Depth	True Vertical Depth	BHL From Lease, Unit, or Property Line:	

LATERAL #2			
SEC	TWP	RGE	COUNTY
1/4	1/4	1/4	1/4
Depth of Deviation	Radius of Turn	Direction	Total Length
Measured Total Depth	True Vertical Depth	BHL From Lease, Unit, or Property Line:	

LATERAL #3			
SEC	TWP	RGE	COUNTY
1/4	1/4	1/4	1/4
Depth of Deviation	Radius of Turn	Direction	Total Length
Measured Total Depth	True Vertical Depth	BHL From Lease, Unit, or Property Line:	