

Oklahoma Corporation Commission  
Oil & Gas Conservation Division  
Post Office Box 52000  
Oklahoma City, Oklahoma 73152-2000  
Rule 165: 10-3-25

Form 1002A

API No.: 35071244410001

**Completion Report**

Spud Date: October 05, 2011

OTC Prod. Unit No.: 071-206471-0-0000

Drilling Finished Date: October 13, 2011

**Amended**

1st Prod Date: June 11, 2012

Amend Reason: ADD PERFORATIONS AND ACIDIZE MISSISSIPPI

Completion Date: June 08, 2012

Recomplete Date: June 04, 2021

**Drill Type: STRAIGHT HOLE**

Well Name: DENNIS 1-27

Purchaser/Measurer:

Location: KAY 27 29N 1W  
C SW SE  
660 FSL 660 FWL of 1/4 SEC  
Derrick Elevation: 1115 Ground Elevation: 1105

First Sales Date:

Operator: BARBER OIL LLC 24363

8801 S YALE AVE STE 150  
TULSA, OK 74137-3575

Completion Type	
	Single Zone
	Multiple Zone
X	Commingled

Location Exception
Order No
There are no Location Exception records to display.

Increased Density
Order No
There are no Increased Density records to display.

Casing and Cement							
Type	Size	Weight	Grade	Feet	PSI	SAX	Top of CMT
SURFACE	8 5/8	24	J	308		250	SURFACE
PRODUCTION	5 1/2	15.5	J	3710		275	2100

Liner								
Type	Size	Weight	Grade	Length	PSI	SAX	Top Depth	Bottom Depth
There are no Liner records to display.								

**Total Depth: 3710**

Packer	
Depth	Brand & Type
There are no Packer records to display.	

Plug	
Depth	Plug Type
There are no Plug records to display.	

Initial Test Data
-------------------

Test Date	Formation	Oil BBL/Day	Oil-Gravity (API)	Gas MCF/Day	Gas-Oil Ratio Cu FT/BBL	Water BBL/Day	Pumpin or Flowing	Initial Shut-In Pressure	Choke Size	Flow Tubing Pressure
Apr 23, 2012	WILCOX	0.5	36	15	30000	3	FLOWING	120	1/4	25
Apr 27, 2012	MISSISSIPPI	8.5	40	220	25882	13	FLOWING	500	1/4	75
May 01, 2012	BIG LIME-OSWEGO	5	40	80	16000	5	FLOWING	500	1/4	40
Jun 08, 2012	CLEVELAND	18	41	300	16667	2	FLOWING	650	1/4	130
Jun 04, 2021	MISSISSIPPI	5.83	40			47	PUMPING			

#### Completion and Test Data by Producing Formation

Formation Name: MISSISSIPPI

Code: 351MISS

Class: OIL

##### Spacing Orders

Order No	Unit Size
NONE	

##### Perforated Intervals

From	To
3461	3466
3476	3480
3480	3486
3585	3600

##### Acid Volumes

NEW PERFORATIONS 3461 - 3480 - 1,500 GALLONS;  
ORIGINAL PERFORATIONS 3480 - 3600 - 2,500 GALLONS

##### Fracture Treatments

NONE

Formation Name: CLEVELAND

Code: 405CLVD

Class: GAS

##### Spacing Orders

Order No	Unit Size
NONE	

##### Perforated Intervals

From	To
3185	3190
3197	3207

##### Acid Volumes

2,000 GALLONS

##### Fracture Treatments

663 BARRELS, 41,125 POUNDS SAND

Formation Name: BIG LIME-OSWEGO

Code: 404BGLO

Class: GAS

##### Spacing Orders

Order No	Unit Size
NONE	

##### Perforated Intervals

From	To
3314	3324
3350	3354

##### Acid Volumes

2,500 GALLONS

##### Fracture Treatments

NONE

Formation Name: WILCOX		Code: 202WLCX	Class: GAS
<b>Spacing Orders</b>		<b>Perforated Intervals</b>	
<b>Order No</b>	<b>Unit Size</b>	<b>From</b>	<b>To</b>
NONE		3650	3652
<b>Acid Volumes</b>		<b>Fracture Treatments</b>	
250 GALLONS		NONE	

Formation	Top
CLEVELAND	3184
BIG LIME-OSWEGO	3262
MISSISSIPPI	3456
WILCOX	3650

Were open hole logs run? Yes  
Date last log run: October 11, 2011  
  
Were unusual drilling circumstances encountered? No  
Explanation:

<b>Other Remarks</b>
OCC - THE ORIGINAL PERFORATIONS IN THE MISSISSIPPI WERE FROM 3480' - 3486' AND 3585' TO 3600'.

<b>FOR COMMISSION USE ONLY</b>	
Status: Accepted	1146582

071-2444)-01

submitted

API NO. 35-071-24503  
 OTC PROD. UNIT NO. 071-206471

Oil and Gas Conservation Division  
 P.O. Box 52000  
 Oklahoma City, OK 73152-2000  
 405-522-0577  
 OCCCentralProcessing@OCC.OK.GOV



Form 1002A  
 Rev. 2020



ORIGINAL  
 AMENDED (Reason)

add perforations and acidize Mississippi

Rule 165:10-3-25

# COMPLETION REPORT

## TYPE OF DRILLING OPERATION

☒ STRAIGHT HOLE ☐ DIRECTIONAL HOLE ☐ HORIZONTAL HOLE  
☐ SERVICE WELL

If directional or horizontal, see reverse for bottom hole location.

COUNTY	Kay	SEC	27	TWP	29N	RGE	1W	SPUD DATE	10/5/2011		
LEASE NAME	Dennis			WELL NO.	1-27			DRLG FINISHED DATE	10/13/2011		
1/4 C 1/4 SW 1/4 SE 1/4	FRL	660'	FRL	660'	DATE OF WELL COMPLETION	6/8/2012			1st PROD DATE	6/11/2012	
ELEVATION Darrick FL	1115	Ground	1105	Latitude				RECOMP DATE	6/4/2021	Longitude	
OPERATOR NAME	Barber Oil, LC				OTC / OCC OPERATOR NO.	24363					
ADDRESS	8801 South Yale Avenue, Suite 150										
CITY	Tulsa			STATE	OK		ZIP	74137			

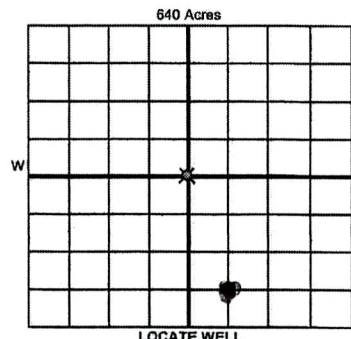

## COMPLETION TYPE

<input type="radio"/> SINGLE ZONE	
<input type="radio"/> MULTIPLE ZONE	
Application Date	
<input type="radio"/> COMMINGLED	
Application Date	
LOCATION EXCEPTION ORDER NO.	
MULTIUNIT ORDER NO.	
INCREASED DENSITY ORDER NO.	

## CASING & CEMENT (Attach Form 1002C)

TYPE	SIZE	WEIGHT	GRADE	FEET	PSI	SAX	TOP OF CMT
CONDUCTOR							
SURFACE	8 5/8"	24#	J	308		250	Surface
INTERMEDIATE							
PRODUCTION	5 1/2"	15.5#	J	3710		275	2100'
LINER							

PACKER @ \_\_\_\_\_ BRAND & TYPE \_\_\_\_\_ PLUG @ \_\_\_\_\_ TYPE \_\_\_\_\_ PLUG @ \_\_\_\_\_ TYPE \_\_\_\_\_ TOTAL DEPTH 3710

## COMPLETION & TEST DATA BY PRODUCING FORMATION

FORMATION	Mississippi	Cleveland	Big Lime-Oswego	Mississippi	Wilcox	No New Fracs
SPACING & SPACING ORDER NUMBER	none	none	none	none	none	
CLASS: Oil, Gas, Dry, Inj, Disp, Comm Disp, Svc	Oil	Gas	Gas	Gas	Gas	
PERFORATED INTERVALS	3461'-3466' 3476'-3480'	3185'-3190' 3197'-3207'	3314'-3324' 3350'-3354'	3480'-3486' 3585'-3600'	3650'-3652'	
ACID/VOLUME	1500 gals	2000 gals	2500 gals	2500 gals	250 gals	
FRACTURE TREATMENT (Fluids/Prop Amounts)	no (new treatment)	663 bbls, 41125 sand (original treatment)	no	no	no	

INITIAL TEST DATA ☐ Min Gas Allowable (165:10-17-7) OR ☐ Oil Allowable (165:10-13-3) ☐ Purchaser/Measurer First Sales Date ☐

INITIAL TEST DATE	6/4/2021	6/8/2012	5/1/2012	4/27/2012	4/23/2012
OIL-BBL/DAY	5.83	18	5	8.5	.5
OIL-GRAVITY (API)	40	41	40	40	36
GAS-MCF/DAY	0	300	80	220	15
GAS-OIL RATIO CU FT/BBL	0	16667	16000	25882	30000
WATER-BBL/DAY	47	2	5	13	3
PUMPING OR FLOWING	pumping	flow	flow	flow	flow
INITIAL SHUT-IN PRESSURE		650	500	500	120
CHOKE SIZE		1/4"	1/4"	1/4"	1/4"
FLOW TUBING PRESSURE		130	40	75	25

A record of the formations drilled through, and pertinent remarks are presented on the reverse. I declare that I have knowledge of the contents of this report and am authorized by my organization to make this report, which was prepared by me or under my supervision and direction, with the data and facts stated herein to be true, correct, and complete to the best of my knowledge and belief.

Barbara Courtney  
 SIGNATURE  
 8801 South Yale Ave, Suite 150  
 ADDRESS  
 Tulsa  
 CITY  
 OK  
 STATE  
 74137  
 ZIP  
 6/14/2021  
 DATE  
 918-638-5951  
 PHONE NUMBER  
 bcourtney@barberoilo.com  
 EMAIL ADDRESS

Give formation names and tops, if available, or descriptions and thickness of formations drilled through. Show intervals cored or drillstem tested.

NAMES OF FORMATIONS	TOP
Cleveland	3184'
Big Lime-Oswego	3262'
Mississippi	3456'
Wilcox	3650'

Other remarks:

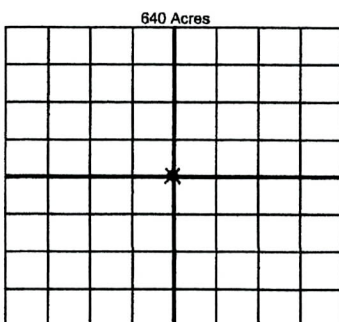

Direction must be stated in degrees azimuth.  
Please note, the horizontal drainhole and its end  
point must be located within the boundaries of the  
lease or spacing unit.

SEC	TWP	RGE	COUNTY				
1/4		1/4		1/4		1/4	
Measured Total Depth		True Vertical Depth		Feet From 1/4 Sec Lines			
				BHL From Lease, Unit, or Property Line:			

LATERAL #1										
SEC	TWP	RGE	COUNTY							
1/4		1/4		1/4		1/4		Feet From 1/4 Sec Lines		
Depth of Deviation		Radius of Turn		Direction				Total Length		
Measured Total Depth		True Vertical Depth		BHL From Lease, Unit, or Property Line:						

SEC	TWP	RGE	COUNTY						
1/4		1/4		1/4		Feet From 1/4 Sec Lines			
Depth of Deviation		Radius of Turn		Direction			Total Length		
Measured Total Depth		True Vertical Depth		BHL From Lease, Unit, or Property Line:					

SEC	TWP	RGE	COUNTY						
1/4		1/4		1/4		Feet From 1/4 Sec Lines			
Depth of Deviation		Radius of Turn		Direction		Total Length			
Measured Total Depth		True Vertical Depth		BHL From Lease, Unit, or Property Line:					