

Oklahoma Corporation Commission
Oil & Gas Conservation Division
Post Office Box 52000
Oklahoma City, Oklahoma 73152-2000
Rule 165: 10-3-25

Form 1002A

API No.: 35133002060002

Completion Report

Spud Date: January 20, 1946

OTC Prod. Unit No.:

Drilling Finished Date: February 01, 1946

Amended

1st Prod Date: February 22, 1946

Amend Reason: SHOW DEEPEN / SET 4 1/2 LINER

Completion Date: March 04, 1946

Recomplete Date: August 27, 2019

Drill Type: STRAIGHT HOLE

Well Name: BURCH 1

Purchaser/Measurer:

Location: SEMINOLE 5 8N 7E
C SE SE SE
330 FSL 2310 FWL of 1/4 SEC
Derrick Elevation: 0 Ground Elevation: 925

First Sales Date:

Operator: SHARBER BILLY JACK OPERATING LLC 21553
PO BOX 71
35585 EW 1270 (SEMINOLE)
KONAWA, OK 74849-0071

Completion Type	
X	Single Zone
	Multiple Zone
	Commingle

Location Exception	
Order No	
There are no Location Exception records to display.	

Increased Density	
Order No	
There are no Increased Density records to display.	

Casing and Cement							
Type	Size	Weight	Grade	Feet	PSI	SAX	Top of CMT
SURFACE	15 1/2	20		75		75	SURFACE
PRODUCTION	7			3275		100	SURFACE
PRODUCTION	4 1/2			4460		200	1557

Liner								
Type	Size	Weight	Grade	Length	PSI	SAX	Top Depth	Bottom Depth
There are no Liner records to display.								

Total Depth: 4460

Packer	
Depth	Brand & Type
There are no Packer records to display.	

Plug	
Depth	Plug Type
There are no Plug records to display.	

Initial Test Data

Test Date	Formation	Oil BBL/Day	Oil-Gravity (API)	Gas MCF/Day	Gas-Oil Ratio Cu FT/BBL	Water BBL/Day	Pumpin or Flowing	Initial Shut-In Pressure	Choke Size	Flow Tubing Pressure
Aug 28, 2019	VIOLA	2				10	PUMPING			

Completion and Test Data by Producing Formation

Formation Name: VIOLA

Code: 202VIOL

Class: OIL

Spacing Orders

Order No	Unit Size
NONE	

Perforated Intervals

From	To
4250	4272

Acid Volumes

There are no Acid Volume records to display.
--

Fracture Treatments

There are no Fracture Treatments records to display.
--

Formation	Top
EARLSBORO	2660
BOOCH	3310
UNION VALLEY	3408
CROMWELL	3510
MISENER	4150
HUNTON	4160
VIOLA	4250

Were open hole logs run? No

Date last log run:

Were unusual drilling circumstances encountered? No

Explanation:

Other Remarks

There are no Other Remarks.

FOR COMMISSION USE ONLY

1144453

Status: Accepted

API NO. 133-00206
OTC PROD.
UNIT NO.

(PLEASE TYPE OR USE BLACK INK ONLY)

OKLAHOMA CORPORATION COMMISSION
Oil & Gas Conservation Division
Post Office Box 52000
Oklahoma City, Oklahoma 73152-2000
Rule 165:10-3-25

RECEIVED

Form 1002A
Rev. 2009

DEC 19 2019

OKLAHOMA CORPORATION COMMISSION
640 Acres

ORIGINAL
☒ AMENDED (Reason)

show Deepen/set 4 1/2 lines

COMPLETION REPORT

TYPE OF DRILLING OPERATION

☒ STRAIGHT HOLE ☐ DIRECTIONAL HOLE ☐ HORIZONTAL HOLE
☐ SERVICE WELL

If directional or horizontal, see reverse for bottom hole location.

COUNTY	SEMINOLE	SEC	5	TWP	8N	RGE	7E
LEASE NAME	BURCH	WELL NO.	1	DATE OF WELL COMPLETION	3-4-46	1st PROD DATE	2-22-46
C	1/4 SE 1/4 SE 1/4 SE 1/4	FSL OF 1/4 SEC	330	FWL OF 1/4 SEC	2310	RECOMP DATE	8-27-19
ELEVATION	Ground 925	Latitude (if known)		Longitude (if known)			
OPERATOR NAME	BILLY JACK SHARBER OPERATING LLC			OTC / OCC OPERATOR NO.	21553		
ADDRESS	PO Box 71						
CITY	KONAWA		STATE	OK		ZIP	74849

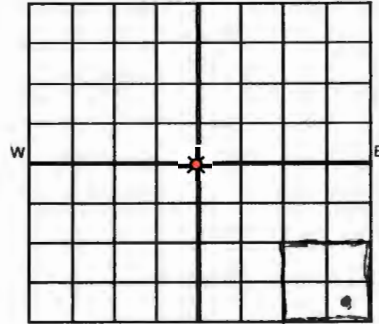

COMPLETION TYPE

<input checked="" type="checkbox"/> SINGLE ZONE	
<input type="checkbox"/> MULTIPLE ZONE	
Application Date	
COMMINGLED	
Application Date	
LOCATION EXCEPTION ORDER NO.	
INCREASED DENSITY ORDER NO.	

CASING & CEMENT (Attach Form 1002C)

TYPE	SIZE	WEIGHT	GRADE	FEET	PSI	SAX	TOP OF CMT
CONDUCTOR							
SURFACE	15 1/2	20#		75		75	surface
INTERMEDIATE							
PRODUCTION	4 1/2			3275		100	surface
LINER	4 1/2			51460		200	1557
							4460

PACKER @ BRAND & TYPE PLUG @ TYPE PLUG @ TYPE
PACKER @ BRAND & TYPE PLUG @ TYPE PLUG @ TYPE

COMPLETION & TEST DATA BY PRODUCING FORMATION

FORMATION	VIOLA					
SPACING & SPACING ORDER NUMBER	none					
CLASS: Oil, Gas, Dry, Inj, Disp, Comm Disp, Svc	OIL					
PERFORATED INTERVALS	4250-56 4260-72					
ACID/VOLUME						
FRACTURE TREATMENT (Fluids/Prop Amounts)						

Min Gas Allowable (165:10-17-7)

Gas Purchaser/Measurer



OR

First Sales Date

Oil Allowable (165:10-13-3)

INITIAL TEST DATA

INITIAL TEST DATE	8-28-19					
OIL-BBL/DAY	2					
OIL-GRAVITY (API)						
GAS-MCF/DAY	0					
GAS-OIL RATIO CU FT/BBL						
WATER-BBL/DAY	10					
PUMPING OR FLOWING	pumping					
INITIAL SHUT-IN PRESSURE						
CHOKE SIZE						
FLOW TUBING PRESSURE						

A record of the formations drilled through, and pertinent remarks are presented on the reverse. I declare that I have knowledge of the contents of this report and am authorized by my organization to make this report, which was prepared by me or under my supervision and direction, with the data and facts stated herein to be true, correct, and complete to the best of my knowledge and belief.

SIGNATURE: [Signature] NAME (PRINT OR TYPE): LES COBB
ADDRESS: PO Box 71 CITY: KONAWA STATE: OK ZIP: 74849
DATE: 10/10/19 PHONE NUMBER: 405-382-5340
EMAIL ADDRESS: bjsharber@hotmail.com

PLEASE TYPE OR USE BLACK INK ONLY
FORMATION RECORD

Give formation names and tops, if available, or descriptions and thickness of formations drilled through. Show intervals cored or drillstem tested.

LEASE NAME BURCH WELL NO. 1

NAMES OF FORMATIONS	TOP
EARLSBORO	2660
BOOCK	3310
UNION VALLEY	3408
CROMWELL	3510
MISENER	4150
HUNTON	4160
VIOLA	4250

FOR COMMISSION USE ONLY

ITD on file ☐ YES ☐ NO

APPROVED _____ DISAPPROVED _____

2) Reject Codes _____

Were open hole logs run? ☐ yes ☒ no

Date Last log was run _____

Was CO₂ encountered? ☐ yes ☒ no at what depths? _____

Was H₂S encountered? ☐ yes ☒ no at what depths? _____

Were unusual drilling circumstances encountered? ☐ yes ☒ no

If yes, briefly explain below _____

Other remarks: _____

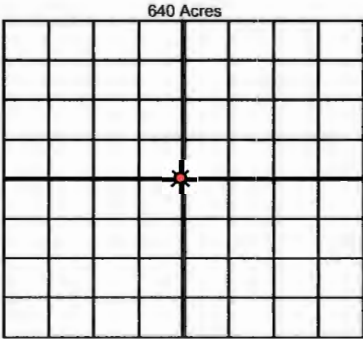

If more than three drainholes are proposed, attach a separate sheet indicating the necessary information.

Direction must be stated in degrees azimuth. Please note, the horizontal drainhole and its end point must be located within the boundaries of the lease or spacing unit.

Directional surveys are required for all drainholes and directional wells.

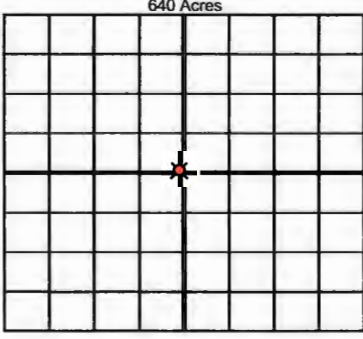

BOTTOM HOLE LOCATION FOR DIRECTIONAL HOLE

SEC	TWP	RGE	COUNTY
Spot Location		Feet From 1/4 Sec Lines	FSL
1/4	1/4	1/4	1/4
Measured Total Depth		True Vertical Depth	BHL From Lease, Unit, or Property Line:

BOTTOM HOLE LOCATION FOR HORIZONTAL HOLE: (LATERALS)

LATERAL #1

SEC	TWP	RGE	COUNTY
Spot Location		Feet From 1/4 Sec Lines	FSL
1/4	1/4	1/4	1/4
Depth of Deviation	Radius of Turn	Direction	Total Length
Measured Total Depth	True Vertical Depth	BHL From Lease, Unit, or Property Line:	

LATERAL #2

SEC	TWP	RGE	COUNTY
Spot Location		Feet From 1/4 Sec Lines	FSL
1/4	1/4	1/4	1/4
Depth of Deviation	Radius of Turn	Direction	Total Length
Measured Total Depth	True Vertical Depth	BHL From Lease, Unit, or Property Line:	

LATERAL #3

SEC	TWP	RGE	COUNTY
Spot Location		Feet From 1/4 Sec Lines	FSL
1/4	1/4	1/4	1/4
Depth of Deviation	Radius of Turn	Direction	Total Length
Measured Total Depth	True Vertical Depth	BHL From Lease, Unit, or Property Line:	