

Oklahoma Corporation Commission
Oil & Gas Conservation Division
Post Office Box 52000
Oklahoma City, Oklahoma 73152-2000
Rule 165: 10-3-25

Form 1002A

API No.: 35139238890002

Completion Report

Spud Date: August 06, 2004

OTC Prod. Unit No.:

Drilling Finished Date: August 11, 2004

Amended

1st Prod Date: November 24, 2004

Amend Reason: CONVERT TO INJECTION

Completion Date: November 23, 2004

Recomplete Date: November 22, 2019

Drill Type: STRAIGHT HOLE

SERVICE WELL

Well Name: LO BUCK FARMS 4-25

Purchaser/Measurer:

Location: TEXAS 25 6N 11E CM
C NE NE NE
330 FNL 330 FEL of 1/4 SEC
Derrick Elevation: 3560 Ground Elevation: 3550

First Sales Date:

Operator: RESOURCE OIL AND GAS LLC 24248

701 CEDAR LAKE BLVD #210
OKLAHOMA CITY, OK 73114-7806

Completion Type		Location Exception		Increased Density	
X	Single Zone	Order No		Order No	
	Multiple Zone	There are no Location Exception records to display.		There are no Increased Density records to display.	
	Commingled				

Casing and Cement							
Type	Size	Weight	Grade	Feet	PSI	SAX	Top of CMT
SURFACE	8.625	24	J-55	1510	700	877	SURFACE
PRODUCTION	5.50	17	J-55	3650	1150	355	2386

Liner								
Type	Size	Weight	Grade	Length	PSI	SAX	Top Depth	Bottom Depth
There are no Liner records to display.								

Total Depth: 3650

Packer		Plug	
Depth	Brand & Type	Depth	Plug Type
3215	AS1X	There are no Plug records to display.	

Initial Test Data

Test Date	Formation	Oil BBL/Day	Oil-Gravity (API)	Gas MCF/Day	Gas-Oil Ratio Cu FT/BBL	Water BBL/Day	Pumpin or Flowing	Initial Shut- In Pressure	Choke Size	Flow Tubing Pressure
-----------	-----------	----------------	----------------------	----------------	----------------------------	------------------	----------------------	---------------------------------	---------------	-------------------------

There are no Initial Data records to display.

Completion and Test Data by Producing Formation

Formation Name: WABAUNSEE-SHAWNEE Code: 406WBSSN Class: INJ

Spacing Orders		Perforated Intervals	
Order No	Unit Size	From	To
There are no Spacing Order records to display.		3237	3381
Acid Volumes		Fracture Treatments	
There are no Acid Volume records to display.		22,000 GALLONS 70 Q FOAMED 20% ACID	

Formation	Top
PREVIOUSLY REPORTED	0

Were open hole logs run? No
Date last log run:

Were unusual drilling circumstances encountered? No
Explanation:

Other Remarks
CONVERTED TO DISPOSAL WELL, ORDER NUMBER 2003700010

FOR COMMISSION USE ONLY

1144487

Status: Accepted

API NO. 139-23889
OTC PROD.
UNIT NO.

(PLEASE TYPE OR USE BLACK INK ONLY)

OKLAHOMA CORPORATION COMMISSION

Oil & Gas Conservation Division

Post Office Box 52000

Oklahoma City, Oklahoma 73152-2000

Rule 165:10-3-25

COMPLETION REPORT

RECEIVED

DEC 11 2019

OKLAHOMA CORPORATION COMMISSION

Form 1002A

Rev. 2009

ORIGINAL
☒ AMENDED (Reason) Convert to Injection

TYPE OF DRILLING OPERATION

☒ STRAIGHT HOLE ☐ DIRECTIONAL HOLE ☐ HORIZONTAL HOLE
☒ SERVICE WELL

If directional or horizontal, see reverse for bottom hole location.

COUNTY Texas SEC 25 TWP 6N RGE 11ECM
LEASE NAME Lo Buck Farms
C 1/4 NE 1/4 NE 1/4 NE 1/4 NE 1/4 SEC 1980' 1/4 SEC 1980'
ELEVATION Derrick FL 3560' Ground 3550' Latitude (if known) Longitude (if known)
OPERATOR NAME Resource Oil and Gas, LLC OTC / OCC OPERATOR NO. 24248
ADDRESS 701 Cedar Lake Blvd., Suite 210
CITY Oklahoma City STATE OK ZIP 73114

SPUD DATE 8/6/2004

DRLG FINISHED DATE 8/11/2004

DATE OF WELL COMPLETION 11/23/2004

1st PROD DATE 11/24/2004

RECOMP DATE 11/22/2019

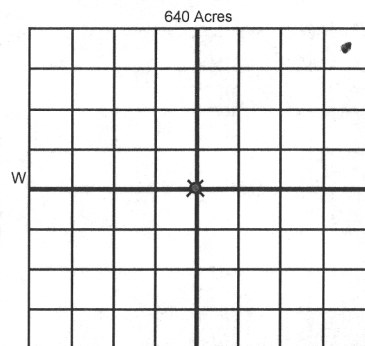

COMPLETION TYPE

☒ SINGLE ZONE
☐ MULTIPLE ZONE
Application Date
☐ COMMINGLED
Application Date
LOCATION EXCEPTION ORDER NO.
INCREASED DENSITY ORDER NO. 491954

CASING & CEMENT (Attach Form 1002C)

TYPE	SIZE	WEIGHT	GRADE	FEET	PSI	SAX	TOP OF CMT
CONDUCTOR							
SURFACE	8.625"	24#	J-55	1510'	700	877	surface
INTERMEDIATE							
PRODUCTION	5.50"	17#	J-55	3650'	1150	355	2386'
LINER							
						TOTAL DEPTH	3650'

PACKER @ 3215' BRAND & TYPE AS1X PLUG @ TYPE PLUG @ TYPE
PACKER @ BRAND & TYPE PLUG @ TYPE PLUG @ TYPE

COMPLETION & TEST DATA BY PRODUCING FORMATION

FORMATION Wabaunsee Shawnee
SPACING & SPACING ORDER NUMBER 044512
CLASS: Oil, Gas, Dry, Inj, Disp, Comm Disp, Svc Inj Order 2003700040 see remarks
PERFORATED INTERVALS 3237'-96'
3331'-81'
ACID/VOLUME
FRACTURE TREATMENT (Fluids/Prop Amounts) 22,000 gals 70Q
Foamed 20% acid

Min Gas Allowable (165:10-17-7)

Gas Purchaser/Measurer

OR
Oil Allowable (165:10-13-3)

First Sales Date

INITIAL TEST DATA

INITIAL TEST DATE NA
OIL-BBL/DAY
OIL-GRAVITY (API)
GAS-MCF/DAY
GAS-OIL RATIO CU FT/BBL
WATER-BBL/DAY
PUMPING OR FLOWING
INITIAL SHUT-IN PRESSURE
CHOKE SIZE
FLOW TUBING PRESSURE

AS SUBMITTED

A record of the formations drilled through, and pertinent remarks are presented on the reverse. I declare that I have knowledge of the contents of this report and am authorized by my organization to make this report, which was prepared by me or under my supervision and direction, with the data and facts stated herein to be true, correct, and complete to the best of my knowledge and belief.

Leigh Kuykendall

Leigh Kuykendall

12/5/2019 405-563-9756

SIGNATURE

NAME (PRINT OR TYPE)

DATE

PHONE NUMBER

701 Cedar Lake Blvd., Suite 210, Oklahoma City, OK 73114

leigh.kuykendall@resourceoilandgas.com

ADDRESS

CITY

STATE

ZIP

EMAIL ADDRESS

original stimulation 2004

PLEASE TYPE OR USE BLACK INK ONLY

FORMATION RECORD

Give formation names and tops, if available, or descriptions and thickness of formations drilled through. Show intervals cored or drillstem tested.

NAMES OF FORMATIONS	TOP
previously reported	

LEASE NAME Lo Buck Farms

WELL NO. 4-25

FOR COMMISSION USE ONLY	
ITD on file <input type="checkbox"/> YES <input type="checkbox"/> NO	
APPROVED _____	DISAPPROVED _____
2) Reject Codes	

Were open hole logs run?	____ yes ____ no
Date Last log was run	_____
Was CO ₂ encountered?	____ yes ____ no at what depths? _____
Was H ₂ S encountered?	____ yes ____ no at what depths? _____
Were unusual drilling circumstances encountered?	____ yes ____ no
If yes, briefly explain below	

Other remarks: Converted to disposal well, Order #2003700010

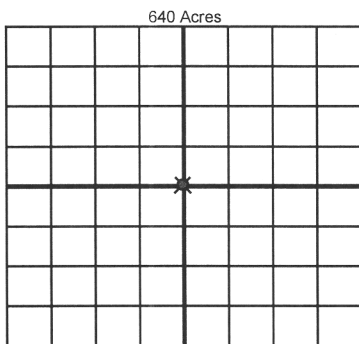

If more than three drainholes are proposed, attach a separate sheet indicating the necessary information.

Direction must be stated in degrees azimuth.
Please note, the horizontal drainhole and its end point must be located within the boundaries of the lease or spacing unit.

Directional surveys are required for all drainholes and directional wells.

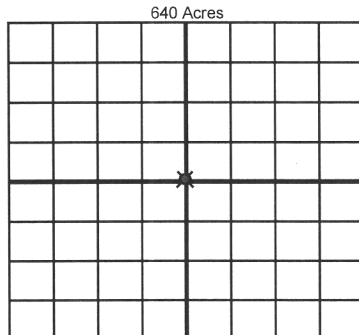

BOTTOM HOLE LOCATION FOR DIRECTIONAL HOLE

SEC	TWP	RGE	COUNTY
Spot Location			
1/4	1/4	1/4	1/4
Measured Total Depth		True Vertical Depth	BHL From Lease, Unit, or Property Line:

BOTTOM HOLE LOCATION FOR HORIZONTAL HOLE: (LATERALS)

LATERAL #1			
SEC	TWP	RGE	COUNTY
Spot Location			
1/4	1/4	1/4	1/4
Depth of Deviation		Radius of Turn	Direction
Measured Total Depth		True Vertical Depth	BHL From Lease, Unit, or Property Line:

LATERAL #2			
SEC	TWP	RGE	COUNTY
Spot Location			
1/4	1/4	1/4	1/4
Depth of Deviation		Radius of Turn	Direction
Measured Total Depth		True Vertical Depth	BHL From Lease, Unit, or Property Line:

LATERAL #3			
SEC	TWP	RGE	COUNTY
Spot Location			
1/4	1/4	1/4	1/4
Depth of Deviation		Radius of Turn	Direction
Measured Total Depth		True Vertical Depth	BHL From Lease, Unit, or Property Line: