

Oklahoma Corporation Commission
Oil & Gas Conservation Division
Post Office Box 52000
Oklahoma City, Oklahoma 73152-2000
Rule 165: 10-3-25

Form 1002A

API No.: 35139226740003

Completion Report

Spud Date: October 03, 1996

OTC Prod. Unit No.:

Drilling Finished Date: October 25, 1996

Amended

1st Prod Date: December 10, 1996

Amend Reason: CONVERT TO INJECTION

Completion Date: December 04, 1996

Recomplete Date: November 20, 2019

Drill Type: STRAIGHT HOLE

SERVICE WELL

Well Name: EPMG (EAST POSTLE MORROW G UNIT) 15-2

Purchaser/Measurer:

Location: TEXAS 34 6N 13E CM
SE SE SW SW
200 FSL 1250 FWL of 1/4 SEC
Derrick Elevation: 0 Ground Elevation: 3362

First Sales Date:

Operator: RESOURCE OIL AND GAS LLC 24248

701 CEDAR LAKE BLVD #210
OKLAHOMA CITY, OK 73114-7806

Completion Type		Location Exception		Increased Density	
X	Single Zone	Order No		Order No	
	Multiple Zone	There are no Location Exception records to display.		There are no Increased Density records to display.	
	Commingled				

Casing and Cement							
Type	Size	Weight	Grade	Feet	PSI	SAX	Top of CMT
SURFACE	13 3/8	48	H-40	627		400	SURFACE
INTERMEDIATE	8 5/8	23	M-50	1730		470	SURFACE
PRODUCTION	5 1/2	15.5	K-55	6525		450	2410

Liner								
Type	Size	Weight	Grade	Length	PSI	SAX	Top Depth	Bottom Depth
There are no Liner records to display.								

Total Depth: 6526

Packer		Plug	
Depth	Brand & Type	Depth	Plug Type
6397	AS1X	There are no Plug records to display.	

Initial Test Data

Test Date	Formation	Oil BBL/Day	Oil-Gravity (API)	Gas MCF/Day	Gas-Oil Ratio Cu FT/BBL	Water BBL/Day	Pumpin or Flowing	Initial Shut- In Pressure	Choke Size	Flow Tubing Pressure
-----------	-----------	----------------	----------------------	----------------	----------------------------	------------------	----------------------	---------------------------------	---------------	-------------------------

There are no Initial Data records to display.

Completion and Test Data by Producing Formation

Formation Name: MORROW G Code: 402MRRWG Class: INJ

Spacing Orders		Perforated Intervals	
Order No	Unit Size	From	To
There are no Spacing Order records to display.		6431	6470
Acid Volumes		Fracture Treatments	
2,000 GALLONS 7 1/2% HCL		12,700 GALLONS GEL, 48,000 POUNDS 16/30 SAND	

Formation	Top
PREVIOUSLY REPORTED	0

Were open hole logs run? No
Date last log run:

Were unusual drilling circumstances encountered? No
Explanation:

Other Remarks
CONVERT TO INJECTION WELL, PERMIT NUMBER 2003700009 DATED NOVEMBER 20, 2019. OCC - ON 5 1/2" CASING D-V TOOL SET AT 4,590'

FOR COMMISSION USE ONLY	
Status: Accepted	1144486

API NO. 139-22674
OTC PROD.
UNIT NO.

(PLEASE TYPE OR USE BLACK INK ONLY)

OKLAHOMA CORPORATION COMMISSION
Oil & Gas Conservation Division
Post Office Box 52000
Oklahoma City, Oklahoma 73152-2000
Rule 165:10-3-25

RECEIVED

DEC 11 2019

Form 1002A
Rev. 2009

OKLAHOMA CORPORATION
COMMISSION

☐ ORIGINAL
☒ AMENDED (Reason) Convert to Injection

COMPLETION REPORT

TYPE OF DRILLING OPERATION

☒ STRAIGHT HOLE ☐ DIRECTIONAL HOLE ☐ HORIZONTAL HOLE
☒ SERVICE WELL

If directional or horizontal, see reverse for bottom hole location.

COUNTY Texas SEC 34 TWP 6N RGE 13ECM
LEASE NAME EPMG (E. Postle Morrow G) WELL NO. 15-2 1st PROD DATE 12/10/1996
SE 1/4 SE 1/4 SW 1/4 SW 1/4 FSL OF 1/4 SEC 200' FWL OF 1/4 SEC 1250' RECOMP DATE 11/20/2019
ELEVATION Ground 3362' Latitude (if known) Longitude (if known)
OPERATOR NAME Resource Oil and Gas, LLC OTC / OCC OPERATOR NO. 24248
ADDRESS 701 Cedar Lake Blvd., Suite 210
CITY Oklahoma City STATE OK ZIP 73114

SPUD DATE 10/3/1996
DRLG FINISHED DATE 10/25/1996
DATE OF WELL COMPLETION 12/4/1996

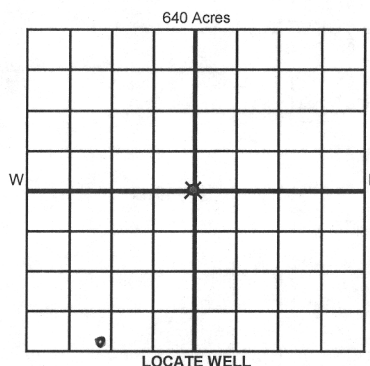

COMPLETION TYPE

☒ SINGLE ZONE Morrow "G"
☐ MULTIPLE ZONE
Application Date
☐ COMMINGLED
Application Date
LOCATION EXCEPTION ORDER NO.
INCREASED DENSITY ORDER NO.

CASING & CEMENT (Attach Form 1002C)

TYPE	SIZE	WEIGHT	GRADE	FEET	PSI	SAX	TOP OF CMT
CONDUCTOR							
SURFACE	13-3/8"	48#	H-40	627'		400	surface
INTERMEDIATE	8-5/8"	23#	M-50	1730'		470	surface (calc)
PRODUCTION	5-1/2"	15.5#	K-55	6525'		450	5160'/2410'
LINER							
(190+260 on DV tool @ 4590') see remarks							
TOTAL DEPTH							6526'

PACKER @ 6397' BRAND & TYPE AS1X PLUG @ TYPE PLUG @ TYPE
PACKER @ BRAND & TYPE PLUG @ TYPE PLUG @ TYPE

COMPLETION & TEST DATA BY PRODUCING FORMATION

402 MRRWG

FORMATION	<u>Morrow "G"</u>						<u>No New Frac</u>
SPACING & SPACING ORDER NUMBER	<u>110387</u>						
CLASS: Oil, Gas, Dry, Inj, Disp, Comm Disp, Svc	<u>Inj. 2003700009</u>	<u>see remarks</u>					
PERFORATED INTERVALS	<u>6431'-6446'</u>						
	<u>6453'-6470'</u>						
ACID/VOLUME	<u>7 1/2% HCl - 2000 gals</u>						
FRACTURE TREATMENT (Fluids/Prop Amounts)	<u>12,700 gals Gel</u>						
	<u>48,000 lbs 16/30 sand</u>						

☐ Min Gas Allowable (165:10-17-7)
OR
☐ Oil Allowable (165:10-13-3)

Gas Purchaser/Measurer
First Sales Date

INITIAL TEST DATA

INITIAL TEST DATE	<u>NA</u>					
OIL-BBL/DAY						
OIL-GRAVITY (API)						
GAS-MCF/DAY						
GAS-OIL RATIO CU FT/BBL						
WATER-BBL/DAY						
PUMPING OR FLOWING						
INITIAL SHUT-IN PRESSURE						
CHOKE SIZE						
FLOW TUBING PRESSURE						

AS SUBMITTED

A record of the formations drilled through, and pertinent remarks are presented on the reverse. I declare that I have knowledge of the contents of this report and am authorized by my organization to make this report, which was prepared by me or under my supervision and direction, with the data and facts stated herein to be true, correct, and complete to the best of my knowledge and belief.

Leigh Kuykendall SIGNATURE NAME (PRINT OR TYPE) 12/4/2019 DATE 405-563-9756 PHONE NUMBER
701 Cedar Lake Blvd., Suite 210, Oklahoma City, OK 73114 ADDRESS CITY STATE ZIP leigh.kuykendall@resourceoilandgas.com EMAIL ADDRESS

PLEASE TYPE OR USE BLACK INK ONLY

FORMATION RECORD

Give formation names and tops, if available, or descriptions and thickness of formations drilled through. Show intervals cored or drillstem tested.

NAMES OF FORMATIONS	TOP
previously reported	

LEASE NAME EPMG (E. Postle Morrow G)

WELL NO. 15-2

FOR COMMISSION USE ONLY	
ITD on file	<input type="checkbox"/> YES <input type="checkbox"/> NO
APPROVED	DISAPPROVED
2) Reject Codes	

Were open hole logs run?	<input type="checkbox"/> yes <input type="checkbox"/> no
Date Last log was run	
Was CO ₂ encountered?	<input type="checkbox"/> yes <input type="checkbox"/> no at what depths?
Was H ₂ S encountered?	<input type="checkbox"/> yes <input type="checkbox"/> no at what depths?
Were unusual drilling circumstances encountered?	<input type="checkbox"/> yes <input type="checkbox"/> no
If yes, briefly explain below	

Other remarks:

Convert to injection well, permit #2003700009 dated 11/20/2019

OCC - On 5 1/2" casing D-V tool set at 4590'

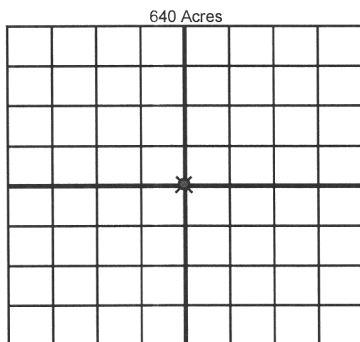

If more than three drainholes are proposed, attach a separate sheet indicating the necessary information.

Direction must be stated in degrees azimuth. Please note, the horizontal drainhole and its end point must be located within the boundaries of the lease or spacing unit.

Directional surveys are required for all drainholes and directional wells.

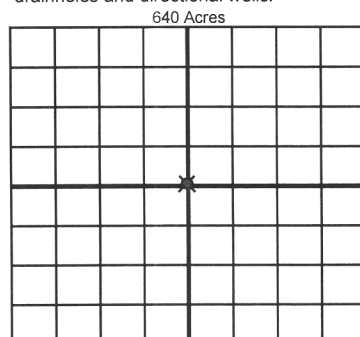

BOTTOM HOLE LOCATION FOR DIRECTIONAL HOLE

SEC	TWP	RGE	COUNTY
Spot Location			
1/4	1/4	1/4	1/4
Measured Total Depth		True Vertical Depth	BHL From Lease, Unit, or Property Line:

BOTTOM HOLE LOCATION FOR HORIZONTAL HOLE: (LATERALS)

LATERAL #1			
SEC	TWP	RGE	COUNTY
Spot Location			
1/4	1/4	1/4	1/4
Depth of Deviation		Radius of Turn	Direction
Measured Total Depth		True Vertical Depth	BHL From Lease, Unit, or Property Line:

LATERAL #2			
SEC	TWP	RGE	COUNTY
Spot Location			
1/4	1/4	1/4	1/4
Depth of Deviation		Radius of Turn	Direction
Measured Total Depth		True Vertical Depth	BHL From Lease, Unit, or Property Line:

LATERAL #3			
SEC	TWP	RGE	COUNTY
Spot Location			
1/4	1/4	1/4	1/4
Depth of Deviation		Radius of Turn	Direction
Measured Total Depth		True Vertical Depth	BHL From Lease, Unit, or Property Line: