

Oklahoma Corporation Commission
Oil & Gas Conservation Division
Post Office Box 52000
Oklahoma City, Oklahoma 73152-2000
Rule 165: 10-3-25

Form 1002A

API No.: 35063248410000

Completion Report

Spud Date: August 23, 2018

OTC Prod. Unit No.:

Drilling Finished Date: September 01, 2018

1st Prod Date: July 07, 2019

Completion Date: July 05, 2019

Drill Type: STRAIGHT HOLE

SERVICE WELL

Well Name: PRENTICE 2-19WV

Purchaser/Measurer:

Location: HUGHES 19 5N 9E
E2 SW SE SE
330 FSL 712 FEL of 1/4 SEC
Derrick Elevation: 882 Ground Elevation: 870

First Sales Date:

Operator: JONES DOUGLAS Q LLC 22648

3704 RIVER BEND RD
MUSKOGEE, OK 74403-2335

Completion Type	Location Exception	Increased Density
Single Zone	Order No	Order No
Multiple Zone	There are no Location Exception records to display.	There are no Increased Density records to display.
Commingled		

Casing and Cement							
Type	Size	Weight	Grade	Feet	PSI	SAX	Top of CMT
CONDUCTOR	17		H-40	70			SURFACE
SURFACE	9 5/8	36	J-55	672		265	SURFACE
PRODUCTION	7	29	N-80	3995		450	2140

Liner								
Type	Size	Weight	Grade	Length	PSI	SAX	Top Depth	Bottom Depth
There are no Liner records to display.								

Total Depth: 3995

Packer		Plug	
Depth	Brand & Type	Depth	Plug Type
3350	ARROW TENSION	There are no Plug records to display.	

Initial Test Data

Test Date	Formation	Oil BBL/Day	Oil-Gravity (API)	Gas MCF/Day	Gas-Oil Ratio Cu FT/BBL	Water BBL/Day	Pumpin or Flowing	Initial Shut- In Pressure	Choke Size	Flow Tubing Pressure
-----------	-----------	----------------	----------------------	----------------	----------------------------	------------------	----------------------	---------------------------------	---------------	-------------------------

There are no Initial Data records to display.

Completion and Test Data by Producing Formation

Formation Name: WAPANUCKA

Code: 402WPCK

Class: DISP

Spacing Orders

Order No

Unit Size

There are no Spacing Order records to display.

Perforated Intervals

From

To

3829

3886

Acid Volumes

2,000 GALLONS 15% HCL

Fracture Treatments

N/A

Formation	Top
GILCREASE	3350
WAPANUCKA	3825

Were open hole logs run? Yes

Date last log run: September 01, 2018

Were unusual drilling circumstances encountered? No

Explanation:

Other Remarks

PERMIT NUMBER 1907250042

FOR COMMISSION USE ONLY

1144506

Status: Accepted

API NO. 063-24841
OTC PROD.
UNIT NO.

(PLEASE TYPE OR USE BLACK INK ONLY)

OKLAHOMA CORPORATION COMMISSION
Oil & Gas Conservation Division
Post Office Box 52000
Oklahoma City, Oklahoma 73152-2000
Rule 165:10-3-25

RECEIVED

Form 1002A
Rev. 2009

DEC 18 2019

☒ ORIGINAL
☐ AMENDED (Reason)

COMPLETION REPORT

TYPE OF DRILLING OPERATION

☒ STRAIGHT HOLE ☐ DIRECTIONAL HOLE ☐ HORIZONTAL HOLE
☒ SERVICE WELL

If directional or horizontal, see reverse for bottom hole location.

COUNTY HUGHES SEC 19 TWP 5N RGE 9E
LEASE NAME PRENTICE WELL NO. 2-19WV 1st PROD DATE 07.07.19
FSL OF 1/4 SEC 330' FSL OFF 1/4 SEC 1928 RECOMP DATE
ELEVATION Derrick FL 882' Ground 870' Latitude (if known) Longitude (if known)
OPERATOR NAME DOUGLAS Q. JONES, LLC OTC / OCC OPERATOR NO. 22648
ADDRESS 3704 RIVER BEND ROAD
CITY MUSKOGEE STATE OK ZIP 74403

OKLAHOMA CORPORATION COMMISSION

640 Acres
LOCATE WELL

COMPLETION TYPE

☐ SINGLE ZONE
☐ MULTIPLE ZONE
☐ COMMINGLED
LOCATION EXCEPTION ORDER NO.
INCREASED DENSITY ORDER NO.

CASING & CEMENT (Attach Form 1002C)

TYPE	SIZE	WEIGHT	GRADE	FEET	PSI	SAX	TOP OF CMT
CONDUCTOR	17"		H-40	70'			SURFACE
SURFACE	9 5/8"	36#	J-55	672'		115	SURFACE
INTERMEDIATE						265	
PRODUCTION	7"	29#	N-80	3995'		450	2140'
LINER							

PACKER @ 3350' BRAND & TYPE ARROW TENSION PLUG @ TYPE PLUG @ TYPE
PACKER @ BRAND & TYPE PLUG @ TYPE PLUG @ TYPE

TOTAL DEPTH 3995'

COMPLETION & TEST DATA BY PRODUCING FORMATION

FORMATION WAPANUCKA No Frac
SPACING & SPACING ORDER NUMBER NA
CLASS: Oil, Gas, Dry, Inj, Disp, Comm Disp, Svc DISPOSAL
PERFORATED INTERVALS 3829-38', 3841-57', 3861-66', 3870-75', 3878-86'
ACID/VOLUME 2000 gal 15% HCl
FRACTURE TREATMENT (Fluids/Prop Amounts) NA

Min Gas Allowable (165:10-17-7)

Gas Purchaser/Measurer

☐

OR

First Sales Date

Oil Allowable (165:10-13-3)

INITIAL TEST DATA

INITIAL TEST DATE 07.05.19
OIL-BBL/DAY INJECTION TEST
OIL-GRAVITY (API)
GAS-MCF/DAY
GAS-OIL RATIO CU FT/BBL
WATER-BBL/DAY 216
PUMPING OR FLOWING PUMPING
INITIAL SHUT-IN PRESSURE
CHOKE SIZE OPEN
FLOW TUBING PRESSURE INT 226 PSI

AS SUBMITTED

A record of the formations drilled through, and pertinent remarks are presented on the reverse. I declare that I have knowledge of the contents of this report and am authorized by my organization to make this report, which was prepared by me or under my supervision and direction, with the data and facts stated herein to be true, correct, and complete to the best of my knowledge and belief.

SIGNATURE

NAME (PRINT OR TYPE)

DATE

PHONE NUMBER

PLEASE TYPE OR USE BLACK INK ONLY
FORMATION RECORD

Give formation names and tops, if available, or descriptions and thickness of formations drilled through. Show intervals cored or drillstem tested.

NAMES OF FORMATIONS	TOP
CALCREASE	3356'
WAPANUCKA	3825'

LEASE NAME PRENTICE #2-19 WV WELL NO. #2-19 WV

FOR COMMISSION USE ONLY		
ITD on file	<input type="checkbox"/> YES	<input type="checkbox"/> NO
APPROVED	DISAPPROVED	2) Reject Codes
<hr/> <hr/> <hr/> <hr/> <hr/>		

Were open hole logs run?	<input checked="" type="checkbox"/> yes	<input type="checkbox"/> no
Date Last log was run	<u>9.1.18</u>	
Was CO ₂ encountered?	<input type="checkbox"/> yes	<input checked="" type="checkbox"/> no at what depths? <u> </u>
Was H ₂ S encountered?	<input type="checkbox"/> yes	<input checked="" type="checkbox"/> no at what depths? <u> </u>
Were unusual drilling circumstances encountered?	<input type="checkbox"/> yes <input checked="" type="checkbox"/> no	
If yes, briefly explain below		

Other remarks: Permit 1907250042

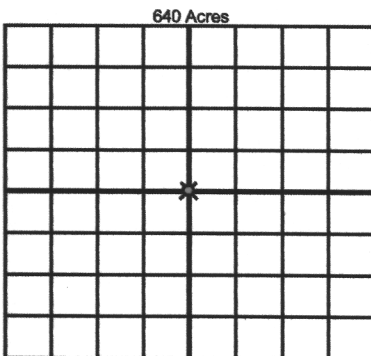

If more than three drainholes are proposed, attach a separate sheet indicating the necessary information.

Direction must be stated in degrees azimuth. Please note, the horizontal drainhole and its end point must be located within the boundaries of the lease or spacing unit.

Directional surveys are required for all drainholes and directional wells.

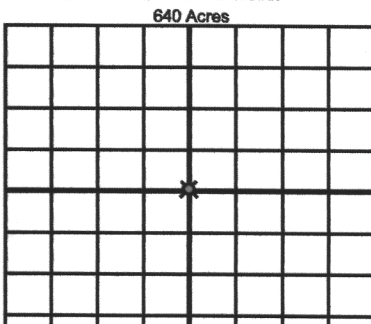

BOTTOM HOLE LOCATION FOR DIRECTIONAL HOLE

SEC	TWP	RGE	COUNTY
Spot Location			
1/4	1/4	1/4	1/4
Measured Total Depth		True Vertical Depth	BHL From Lease, Unit, or Property Line:

BOTTOM HOLE LOCATION FOR HORIZONTAL HOLE: (LATERALS)

LATERAL #1

SEC	TWP	RGE	COUNTY
Spot Location			
1/4	1/4	1/4	1/4
Depth of Deviation		Radius of Turn	Direction
			Total Length
Measured Total Depth		True Vertical Depth	BHL From Lease, Unit, or Property Line:

LATERAL #2

SEC	TWP	RGE	COUNTY
Spot Location			
1/4	1/4	1/4	1/4
Depth of Deviation		Radius of Turn	Direction
			Total Length
Measured Total Depth		True Vertical Depth	BHL From Lease, Unit, or Property Line:

LATERAL #3

SEC	TWP	RGE	COUNTY
Spot Location			
1/4	1/4	1/4	1/4
Depth of Deviation		Radius of Turn	Direction
			Total Length
Measured Total Depth		True Vertical Depth	BHL From Lease, Unit, or Property Line: