

Oklahoma Corporation Commission  
Oil & Gas Conservation Division  
Post Office Box 52000  
Oklahoma City, Oklahoma 73152-2000  
Rule 165: 10-3-25

Form 1002A

API No.: 35051246740000

**Completion Report**

Spud Date: August 19, 2019

OTC Prod. Unit No.:

Drilling Finished Date: September 02, 2019

1st Prod Date:

Completion Date: October 18, 2019

**Drill Type: STRAIGHT HOLE**

**SERVICE WELL**

Well Name: WILMER SWD 1-17

Purchaser/Measurer:

Location: GRADY 17 3N 7W  
SE NE SW NE  
1800 FNL 1530 FEL of 1/4 SEC  
Latitude: 34.7348166 Longitude: -97.95408  
Derrick Elevation: 1349 Ground Elevation: 1336

First Sales Date:

Operator: SUNDOWN ENERGY LP 21689

16400 DALLAS PKWY STE 100  
DALLAS, TX 75248-2609

Completion Type		Location Exception		Increased Density	
X	Single Zone	Order No		Order No	
	Multiple Zone	There are no Location Exception records to display.		There are no Increased Density records to display.	
	Commingled				

Casing and Cement							
Type	Size	Weight	Grade	Feet	PSI	SAX	Top of CMT
CONDUCTOR	16			40			SURFACE
SURFACE	9 5/8	36	J-55	1002	2000	450	SURFACE
PRODUCTION	7	23	J-55	6284	2500	425	3300

Liner								
Type	Size	Weight	Grade	Length	PSI	SAX	Top Depth	Bottom Depth
There are no Liner records to display.								

**Total Depth: 6300**

Packer	
Depth	Brand & Type
5783	AS1X

Plug	
Depth	Plug Type
There are no Plug records to display.	

Initial Test Data
-------------------

Test Date	Formation	Oil BBL/Day	Oil-Gravity (API)	Gas MCF/Day	Gas-Oil Ratio Cu FT/BBL	Water BBL/Day	Pumpin or Flowing	Initial Shut- In Pressure	Choke Size	Flow Tubing Pressure
-----------	-----------	----------------	----------------------	----------------	----------------------------	------------------	----------------------	---------------------------------	---------------	-------------------------

There are no Initial Data records to display.

### Completion and Test Data by Producing Formation

Formation Name: CISCO

Code: 406CSCO

Class: DISP

#### Spacing Orders

Order No

Unit Size

There are no Spacing Order records to display.

#### Perforated Intervals

From

To

5882

5948

#### Acid Volumes

NONE

#### Fracture Treatments

NONE

Formation	Top
FORTUNA	1738
NOBLE-OLSON	3240
CISCO	4080

Were open hole logs run? Yes

Date last log run: September 01, 2019

Were unusual drilling circumstances encountered? No

Explanation:

#### Other Remarks

COMPLETED AS SALTWATER DISPOSAL WELL; NON-COMMERCIAL SALTWATER DISPOSAL. PERMIT NUMBER 1911530012.  
OCC - OPERATOR SET DV-TOOL AT 3,491' (SEE 1002C)

### FOR COMMISSION USE ONLY

1144507

Status: Accepted

API NO. 051-24674  
OTC PROD.  
UNIT NO.

(PLEASE TYPE OR USE BLACK INK ONLY)

OKLAHOMA CORPORATION COMMISSION  
Oil & Gas Conservation Division  
Post Office Box 52000  
Oklahoma City, Oklahoma 73152-2000  
Rule 165:10-3-25

RECEIVED

Form 1002A  
Rev. 2009

DEC 09 2019

OKLAHOMA CORPORATION COMMISSION

XX ORIGINAL  
AMENDED (Reason)

TYPE OF DRILLING OPERATION

XX STRAIGHT HOLE ☐ DIRECTIONAL HOLE ☐ HORIZONTAL HOLE  
X SERVICE WELL

If directional or horizontal, see reverse for bottom hole location.

COUNTY GRADY SEC 17 TWP 3N RGE 7W  
LEASE NAME WILMER SWD  
SE 1/4 NE 1/4 SW 1/4 NE 1/4 PSL OF 1/4 SEC 1800 PWC OF 1/4 SEC 1530  
ELEVATION Derrick FL 1349 Ground 1336 Latitude (if known) 34.7348166X Longitude (if known) - 97.95408X  
OPERATOR NAME SUNDOWN ENERGY, LP OTC / OCC OPERATOR NO. 21689  
ADDRESS 16400 DALLAS PARKWAY #100  
CITY DALLAS STATE TEXAS ZIP 75248

SPUD DATE 8/19/19  
DRLG FINISHED DATE 9/2/2019  
DATE OF WELL COMPLETION 10/18/19  
1st PROD DATE NA  
RECOMP DATE  
WELL NO. 1-17

LOCATE WELL

COMPLETION TYPE

XX SINGLE ZONE  
MULTIPLE ZONE  
COMINGLED  
LOCATION EXCEPTION  
ORDER NO.  
INCREASED DENSITY  
ORDER NO.

CASING & CEMENT (Attach Form 1002C)

TYPE	SIZE	WEIGHT	GRADE	FEET	PSI	SAX	TOP OF CMT
CONDUCTOR	16"			40			surf
SURFACE	9 5/8"	36#	J55	1002	2000	450	surf
INTERMEDIATE							
PRODUCTION	7"	23#	J55	6,284	2500	425	3,300
LINER							
				TOTAL DEPTH		6,300	

PACKER @ 5,783 BRAND & TYPE AS1X PLUG @ TYPE PLUG @ TYPE  
PACKER @ BRAND & TYPE PLUG @ TYPE PLUG @ TYPE

COMPLETION & TEST DATA BY PRODUCING FORMATION

FORMATION	CISCO SANDS					No Frac
SPACING & SPACING						
ORDER NUMBER						
CLASS: Oil, Gas, Dry, Inj, Disp, Comm Disp, Svc	SWD					
PERFORATED INTERVALS	5882'-5902'					
	5928'-5948'					
ACID/VOLUME	NONE					
FRACTURE TREATMENT (Fluids/Prop Amounts)	NONE					

Min Gas Allowable (165:10-17-7) OR Oil Allowable (165:10-13-3) Gas Purchaser/Measurer First Sales Date

INITIAL TEST DATA

INITIAL TEST DATE	10/18/2019				
OIL-BBL/DAY					
OIL-GRAVITY ( API)					
GAS-MCF/DAY					
GAS-OIL RATIO CU FT/BBL					
WATER-BBL/DAY	1100 B/D				
PUMPING OR FLOWING	INJECTION				
INITIAL SHUT-IN PRESSURE	0#				
CHOKE SIZE	NA				
FLOW TUBING PRESSURE	NA				

AS SUBMITTED

A record of the formations drilled through and pertinent remarks are presented on the reverse. I declare that I have knowledge of the contents of this report and am authorized by my organization to make this report, which was prepared by me or under my supervision and direction, with the data and facts stated herein to be true, correct, and complete to the best of my knowledge and belief.

SIGNATURE 16400 DALLAS PARKWAY #100 ADDRESS  
NAME (PRINT OR TYPE) DALLAS TEXAS 75248 CITY STATE ZIP  
DATE 10/22/2019 PHONE NUMBER (214) 368-6100  
EMAIL ADDRESS rbutler@sundownenergy.com

PLEASE TYPE OR USE BLACK INK ONLY  
FORMATION RECORD

Give formation names and tops, if available, or descriptions and thickness of formations drilled through. Show intervals cored or drillstem tested.

NAMES OF FORMATIONS	TOP
FORTUNA	1,738
NOBLE-OLSEN	3,240
CISCO	4080

LEASE NAME WILMER SWD WELL NO. 1

FOR COMMISSION USE ONLY	
ITD on file <input type="checkbox"/> YES <input type="checkbox"/> NO	
APPROVED _____	DISAPPROVED _____
2) Reject Codes	

Were open hole logs run?	<input checked="" type="checkbox"/> yes	<input type="checkbox"/> no
Date Last log was run	<u>9/1/2019</u>	
Was CO <sub>2</sub> encountered?	<input type="checkbox"/> yes	<input checked="" type="checkbox"/> no at what depths? _____
Was H <sub>2</sub> S encountered?	<input type="checkbox"/> yes	<input checked="" type="checkbox"/> no at what depths? _____
Were unusual drilling circumstances encountered?	<input type="checkbox"/> yes <input checked="" type="checkbox"/> no	
If yes, briefly explain below		

Other remarks: COMPLETED AS SW DISPOSAL WELL; NON-COMMERCIAL SWD Permit 191530012  
OCC- Operator set DV-tool at 3491' (see 1002C)

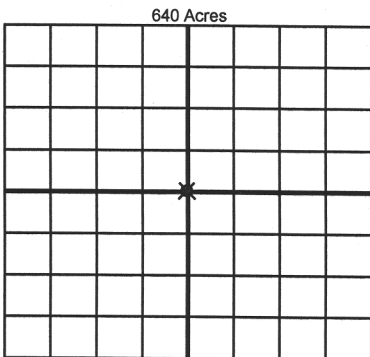

If more than three drainholes are proposed, attach a separate sheet indicating the necessary information.

Direction must be stated in degrees azimuth. Please note, the horizontal drainhole and its end point must be located within the boundaries of the lease or spacing unit.

Directional surveys are required for all drainholes and directional wells.

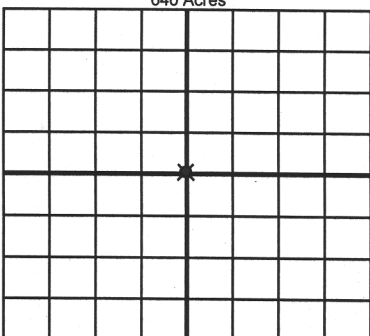

BOTTOM HOLE LOCATION FOR DIRECTIONAL HOLE

SEC	TWP	RGE	COUNTY
Spot Location			
1/4	1/4	1/4	1/4
Measured Total Depth		True Vertical Depth	BHL From Lease, Unit, or Property Line:
Feet From 1/4 Sec Lines		FSL	FWL

BOTTOM HOLE LOCATION FOR HORIZONTAL HOLE: (LATERALS)

LATERAL #1

SEC	TWP	RGE	COUNTY
Spot Location			
1/4	1/4	1/4	1/4
Depth of Deviation		Radius of Turn	Direction
Measured Total Depth		True Vertical Depth	BHL From Lease, Unit, or Property Line:
Feet From 1/4 Sec Lines		FSL	FWL
Total Length			

LATERAL #2

SEC	TWP	RGE	COUNTY
Spot Location			
1/4	1/4	1/4	1/4
Depth of Deviation		Radius of Turn	Direction
Measured Total Depth		True Vertical Depth	BHL From Lease, Unit, or Property Line:
Feet From 1/4 Sec Lines		FSL	FWL
Total Length			

LATERAL #3

SEC	TWP	RGE	COUNTY
Spot Location			
1/4	1/4	1/4	1/4
Depth of Deviation		Radius of Turn	Direction
Measured Total Depth		True Vertical Depth	BHL From Lease, Unit, or Property Line:
Feet From 1/4 Sec Lines		FSL	FWL
Total Length			