

Oklahoma Corporation Commission
Oil & Gas Conservation Division
Post Office Box 52000
Oklahoma City, Oklahoma 73152-2000
Rule 165: 10-3-25

Form 1002A

API No.: 35019261710001

Completion Report

Spud Date: April 02, 2015

OTC Prod. Unit No.:

Drilling Finished Date: April 03, 2015

Amended

1st Prod Date: June 28, 2015

Amend Reason: CONVERT TO INJECTION

Completion Date: June 27, 2015

Recomplete Date: October 18, 2019

Drill Type: STRAIGHT HOLE

SERVICE WELL

Well Name: BYRD 153

Purchaser/Measurer:

Location: CARTER 4 2S 2W
NE SW SW SW
495 FSL 495 FWL of 1/4 SEC
Derrick Elevation: 995 Ground Elevation: 990

First Sales Date:

Operator: KODIAK OIL & GAS INC 23226

204 N WALNUT ST
MUNSTER, TX 76252-2766

Completion Type		Location Exception		Increased Density	
X	Single Zone	Order No		Order No	
	Multiple Zone	There are no Location Exception records to display.		There are no Increased Density records to display.	
	Commingle				

Casing and Cement							
Type	Size	Weight	Grade	Feet	PSI	SAX	Top of CMT
PRODUCTION	5 1/2	15.5	J	1741		300	SURFACE

Liner								
Type	Size	Weight	Grade	Length	PSI	SAX	Top Depth	Bottom Depth
There are no Liner records to display.								

Total Depth: 1750

Packer	
Depth	Brand & Type
1475	ARROW TENSION

Plug	
Depth	Plug Type
1741	CASING SHOE + CEMENT
1741	PBTD

Initial Test Data

Test Date	Formation	Oil BBL/Day	Oil-Gravity (API)	Gas MCF/Day	Gas-Oil Ratio Cu FT/BBL	Water BBL/Day	Pumpin or Flowing	Initial Shut- In Pressure	Choke Size	Flow Tubing Pressure
-----------	-----------	----------------	----------------------	----------------	----------------------------	------------------	----------------------	---------------------------------	---------------	-------------------------

There are no Initial Data records to display.

Completion and Test Data by Producing Formation

Formation Name: DEESE

Code: 404DEESS

Class: INJ

Spacing Orders

Order No

Unit Size

There are no Spacing Order records to display.

Perforated Intervals

From

To

1496

1558

Acid Volumes

1,000 GALLONS 15%

Fracture Treatments

400 SACKS 16/30 SAND, 850 BARRELS LEASE WATER

Formation	Top
SEE ORIGINAL	0

Were open hole logs run? Yes

Date last log run: April 03, 2015

Were unusual drilling circumstances encountered? No

Explanation:

Other Remarks
CONVERT TO INJECTION WELL. PERMIT NUMBER 2003760016

FOR COMMISSION USE ONLY

1144477

Status: Accepted

API NO. 019-26171-01
OTC PROD. 019
UNIT NO. 213992

(PLEASE TYPE OR USE BLACK INK ONLY)

OKLAHOMA CORPORATION COMMISSION
Oil & Gas Conservation Division
Post Office Box 52000
Oklahoma City, Oklahoma 73152-2000
Rule 165-10-3-25

RECEIVED

Form 1002A
Rev. 2009

JAN 03 2020

☐ ORIGINAL
☒ AMENDED (Reason) CONVERT TO INJ.

COMPLETION REPORT

TYPE OF DRILLING OPERATION
☒ STRAIGHT HOLE ☐ DIRECTIONAL HOLE ☐ HORIZONTAL HOLE
☒ SERVICE WELL

If directional or horizontal, see reverse for bottom hole location.

COUNTY CARTER SEC 4 TWP 2S RGE 2W
LEASE NAME BYRD WELL NO. 153
NE 1/4 SW 1/4 SW 1/4 SW 1/4 FSL OF 1/4 SEC 495 FWL OF 1/4 SEC 495
ELEVATION 995 Ground 990 Latitude (if known) Longitude (if known)
OPERATOR NAME KODIAK OIL & GAS INC. OTC OCC OPERATOR NO. 23226-0
ADDRESS 204 N. WALNUT ST.
CITY MUENSTER STATE TX ZIP 76252

SPUD DATE 4/2/15
DRILL FINISHED DATE 4/3/15
DATE OF WELL COMPLETION 6/27/15
1st PROD DATE 6/28/15
RECOMP DATE 10/18/19

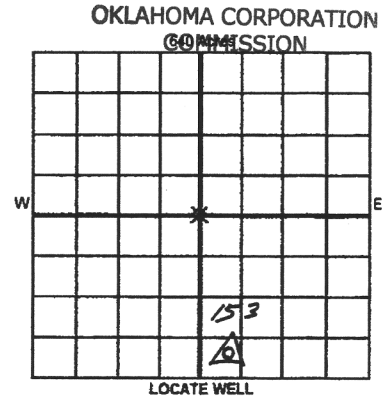

COMPLETION TYPE

☒ SINGLE ZONE
☐ MULTIPLE ZONE
Application Date
COMINGLED
Application Date
LOCATION EXCEPTION
ORDER NO.
INCREASED DENSITY
ORDER NO.

CASING & CEMENT (Attach Form 1002C)

TYPE	SIZE	WEIGHT	GRADE	FEET	PSI	SAX	TOP OF CMT
CONDUCTOR							
SURFACE							
INTERMEDIATE							
PRODUCTION	<u>5 1/2</u>	<u>15.5</u>	<u>5</u>	<u>1741</u>		<u>300</u>	<u>SURF</u>
LINER							

PACKER @ 1475 BRAND & TYPE ARROW TENSION PLUG @ 1741 TYPE Casing shoe + cement TOTAL DEPTH 1750
PACKER @ _____ BRAND & TYPE _____ PLUG @ _____ TYPE _____ PLUG @ _____ TYPE _____
COMPLETION & TEST DATA BY PRODUCING FORMATION 404 DEESE PBTD 1741

FORMATION	<u>DEESE</u>						<u>No New Frac</u>
SPACING & SPACING							
ORDER NUMBER							
CLASS: Oil, Gas, Dry, Inj, Disp, Comm Disp, Svc	<u>INJ.</u>						
PERFORATED INTERVALS	<u>1496-1558 (OA)</u>						
ACID/VOLUME	<u>1000 gals 15%</u>						
FRACTURE TREATMENT (Fluids/Prop Amounts)	<u>400 sacks 16/30 sand</u> <u>850 Bbls lease water</u>						

Min Gas Allowable (165-10-17-7)

Gas Purchaser/Measurer



OR

First Sales Date

Oil Allowable (165-10-13-3)

INITIAL TEST DATA

INITIAL TEST DATE						
OIL-BBL/DAY						
OIL-GRAVITY (API)						
GAS-MCF/DAY						
GAS-OIL RATIO CU FT/BBL						
WATER-BBL/DAY						
PUMPING OR FLOWING						
INITIAL SHUT-IN PRESSURE						
CHOKE SIZE						
FLOW TUBING PRESSURE						

AS SUBMITTED

A record of the formations drilled through, and pertinent remarks are presented on the reverse. I declare that I have knowledge of the contents of this report and am authorized by my organization to make this report, which was prepared by me or under my supervision and direction, with the data and facts stated herein to be true, correct, and complete to the best of my knowledge and belief.

SIGNATURE JOHN R. LAWS DATE 10/18/17 PHONE NUMBER 580-8455
ADDRESS 1515 WARD RD. ARDMORE, OK. 73401 EMAIL ADDRESS JRLAWS@HSTMAIL.COM

PLEASE TYPE OR USE BLACK INK ONLY

FORMATION RECORD

Give formation names and tops, if available, or descriptions and thickness of formations drilled through. Show intervals cored or drillstem tested.

LEASE NAME

BYRD

WELL NO.

153

NAMES OF FORMATIONS	TOP
SEE ORIG	

FOR COMMISSION USE ONLY

ITD on file ☐ YES ☐ NO

APPROVED DISAPPROVED

2) Reject Codes

Were open hole logs run?

☒ yes ☐ no

Date Last log was run

4/3/15

Was CO₂ encountered?☐ yes ☒ no at what depths?Was H₂S encountered?☐ yes ☒ no at what depths?

Were unusual drilling circumstances encountered?

☐ yes ☒ no

If yes, briefly explain below

Other remarks

Permit 2003 KODG CONVERT TO IND. WELL

640 Acres

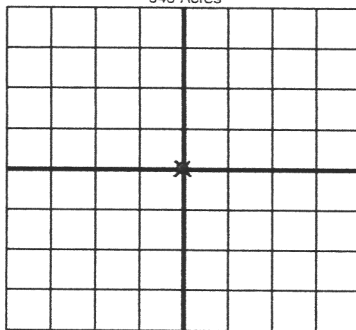

If more than three drainholes are proposed, attach a separate sheet indicating the necessary information.

Direction must be stated in degrees azimuth.
Please note, the horizontal drainhole and its end point must be located within the boundaries of the lease or spacing unit.

Directional surveys are required for all drainholes and directional wells.

640 Acres

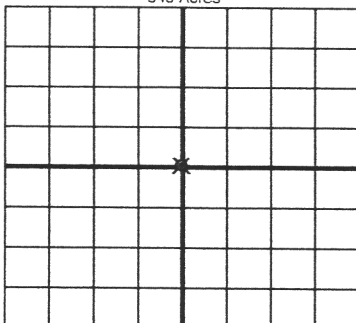

BOTTOM HOLE LOCATION FOR DIRECTIONAL HOLE

SEC	TWP	RGE	COUNTY
Spot Location			
1/4	1/4	1/4	1/4
Measured Total Depth		True Vertical Depth	BHL From Lease, Unit, or Property Line

BOTTOM HOLE LOCATION FOR HORIZONTAL HOLE: (LATERALS)

LATERAL #1

SEC	TWP	RGE	COUNTY
Spot Location			
1/4	1/4	1/4	1/4
Depth of Deviation		Radius of Turn	Direction
Measured Total Depth		True Vertical Depth	BHL From Lease, Unit, or Property Line

LATERAL #2

SEC	TWP	RGE	COUNTY
Spot Location			
1/4	1/4	1/4	1/4
Depth of Deviation		Radius of Turn	Direction
Measured Total Depth		True Vertical Depth	BHL From Lease, Unit, or Property Line

LATERAL #3

SEC	TWP	RGE	COUNTY
Spot Location			
1/4	1/4	1/4	1/4
Depth of Deviation		Radius of Turn	Direction
Measured Total Depth		True Vertical Depth	BHL From Lease, Unit, or Property Line