

Oklahoma Corporation Commission
Oil & Gas Conservation Division
Post Office Box 52000
Oklahoma City, Oklahoma 73152-2000
Rule 165: 10-3-25

Form 1002A

API No.: 35051244250000

Completion Report

Spud Date: August 12, 2018

OTC Prod. Unit No.: 051-225151-0-0000

Drilling Finished Date: August 30, 2018

1st Prod Date: February 28, 2019

Completion Date: February 26, 2019

Drill Type: STRAIGHT HOLE

Min Gas Allowable: Yes

Well Name: OTT 1-24

Purchaser/Measurer: DCP

Location: GRADY 24 7N 5W
W2 NE NE NE
330 FNL 630 FEL of 1/4 SEC
Latitude: 35.071596 Longitude: -97.672939
Derrick Elevation: 1309 Ground Elevation: 1292

First Sales Date: 03/06/2019

Operator: FAR WEST DEVELOPMENT LLC 22930

1410 NW 44TH ST
OKLAHOMA CITY, OK 73118-5002

| Completion Type | | Location Exception | | Increased Density | |
|-----------------|---------------|--------------------|--|--|--|
| X | Single Zone | Order No | | Order No | |
| | Multiple Zone | 686848 | | There are no Increased Density records to display. | |
| | Commingled | | | | |

| Casing and Cement | | | | | | | |
|-------------------|-------|--------|-------|-------|-----|-----|------------|
| Type | Size | Weight | Grade | Feet | PSI | SAX | Top of CMT |
| CONDUCTOR | 20 | | | 40 | | | |
| SURFACE | 9 5/8 | 40 | J-55 | 546 | | 426 | SURFACE |
| PRODUCTION | 5 1/2 | 17 | N-80 | 11365 | | 375 | 8254 |

| Liner | | | | | | | | |
|--|------|--------|-------|--------|-----|-----|-----------|--------------|
| Type | Size | Weight | Grade | Length | PSI | SAX | Top Depth | Bottom Depth |
| There are no Liner records to display. | | | | | | | | |

Total Depth: 11350

| Packer | |
|---|--------------|
| Depth | Brand & Type |
| There are no Packer records to display. | |

| Plug | |
|---------------------------------------|-----------|
| Depth | Plug Type |
| There are no Plug records to display. | |

| Initial Test Data |
|-------------------|
|-------------------|

| Test Date | Formation | Oil BBL/Day | Oil-Gravity (API) | Gas MCF/Day | Gas-Oil Ratio Cu FT/BBL | Water BBL/Day | Pumpin or Flowing | Initial Shut-In Pressure | Choke Size | Flow Tubing Pressure |
|--------------|-----------|-------------|-------------------|-------------|-------------------------|---------------|-------------------|--------------------------|------------|----------------------|
| Mar 08, 2019 | HUNTON | 39.9 | 40 | 282 | 7068 | 192 | PUMPING | 250 | 24/64 | 50 |

| Completion and Test Data by Producing Formation | | | | | |
|---|------------------|--|--|------------|--|
| Formation Name: HUNTON | | Code: 269HNTN | | Class: OIL | |
| Spacing Orders | | Perforated Intervals | | | |
| Order No | Unit Size | From | | To | |
| 188470 | 640 | 10911 | | 10991 | |
| Acid Volumes | | Fracture Treatments | | | |
| 3,000 GALLONS 15% | | 7,492 BARRELS WATER AND 96,190 POUNDS SAND | | | |

| Formation | Top |
|-----------|-------|
| OSBORN | 10100 |
| HUNTON | 10907 |

Were open hole logs run? Yes

Date last log run:

Were unusual drilling circumstances encountered? No

Explanation:

| Other Remarks |
|-----------------------------|
| There are no Other Remarks. |

| FOR COMMISSION USE ONLY | |
|-------------------------|---------|
| Status: Accepted | 1142564 |

OKLAHOMA CORPORATION
COMMISSION

OKLAHOMA CORPORATION COMMISSION
Oil & Gas Conservation Division
Post Office Box 52000
Oklahoma City, Oklahoma 73152-2000
Rule 165:10-3-25

PORT

If directional or horizontal, see reverse for bottom hole location.

| TYPE | SIZE | WEIGHT | GRADE | FEET | PSI | SAX | TOP OF CMT |
|--------------|--------|--------|-------|-------------------|-----|------------------|-----------------|
| CONDUCTOR | 20' | | | 40' | | 426 | |
| SURFACE | 9 5/8" | 40# | J55 | 546' | | 425.5 | Surface |
| INTERMEDIATE | | | | | | | |
| PRODUCTION | 5 1/2" | 17# | N80 | 11,251 | | 375 | 8254 |
| LINER | | | | 11365 | | | |
| PLUG @ | TYPE | PLUG @ | TYPE | TOTAL DEPTH | | 11,350' | |

| | | | | | | |
|--|---|--|--|--|--|------------------------|
| FORMATION | Hunton | | | | | Reported to Frac Fa |
| SPACING & SPACING ORDER NUMBER | 640 acres/188470 | | | | | |
| CLASS: Oil, Gas, Dry, Inj, Disp, Comm Disp, Svc | oil | | | | | |
| PERFORATED INTERVALS | 10,911-10,919' | | | | | |
| | 10,950-10,961' | | | | | |
| | 10,986-10,991 | | | | | |
| ACID/VOLUME | 15%/3,000 gallons | | | | | |
| FRACTURE TREATMENT (Fluids/Prop Amounts) | | | | | | |
| | 7,492 barrels water & 96,190 pounds sand | | | | | |
| | | | | | | |

| | | | | | | | |
|--------------------------|----------|--|--|--|--|--|--|
| INITIAL TEST DATE | 3/8/2019 | | | | | | |
| OIL-BBL/DAY | 39.9 | | | | | | |
| OIL-GRAVITY (API) | 40 | | | | | | |
| GAS-MCF/DAY | 282 | | | | | | |
| GAS-OIL RATIO CU FT/BBL | 7068 | | | | | | |
| WATER-BBL/DAY | 192 | | | | | | |
| PUMPING OR FLOWING | Pumping | | | | | | |
| INITIAL SHUT-IN PRESSURE | 250 | | | | | | |
| CHOKE SIZE | 24/64 | | | | | | |
| FLOW TUBING PRESSURE | 50 | | | | | | |

EMAIL ADDRESS

AS SUBMITTED

PLEASE TYPE OR USE BLACK INK ONLY
FORMATION RECORD

Give formation names and tops, if available, or descriptions and thickness of formations drilled through. Show intervals cored or drillstem tested.

| NAMES OF FORMATIONS | TOP |
|---------------------|---------|
| Osborn | 10,100' |
| Hunton | 10,907' |

LEASE NAME OTT WELL NO. 1-24

| FOR COMMISSION USE ONLY | |
|--|-------------------|
| ITD on file <input type="checkbox"/> YES <input type="checkbox"/> NO | |
| APPROVED _____ | DISAPPROVED _____ |
| 2) Reject Codes | |
| _____ | |
| _____ | |
| _____ | |
| _____ | |

Were open hole logs run? ☒ yes ☐ no

Date Last log was run _____

Was CO₂ encountered? ☐ yes ☒ no at what depths? _____

Was H₂S encountered? ☐ yes ☒ no at what depths? _____

Were unusual drilling circumstances encountered? ☐ yes ☒ no
If yes, briefly explain below _____

Other remarks:

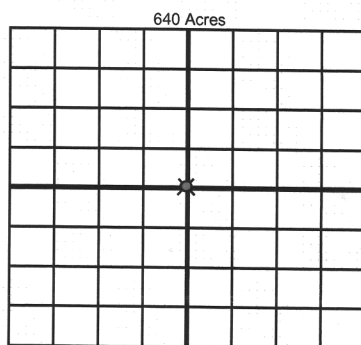

If more than three drainholes are proposed, attach a separate sheet indicating the necessary information.

Direction must be stated in degrees azimuth.
Please note, the horizontal drainhole and its end point must be located within the boundaries of the lease or spacing unit.

Directional surveys are required for all drainholes and directional wells.

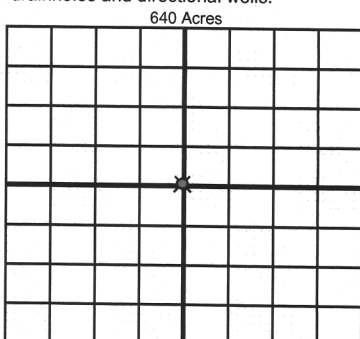

BOTTOM HOLE LOCATION FOR DIRECTIONAL HOLE

| SEC | TWP | RGE | COUNTY |
|---|-----|---------------------|---------------------------------|
| Spot Location | | | |
| 1/4 | 1/4 | 1/4 | 1/4 |
| Measured Total Depth | | True Vertical Depth | Feet From 1/4 Sec Lines FSL FWL |
| BHL From Lease, Unit, or Property Line: | | | |

BOTTOM HOLE LOCATION FOR HORIZONTAL HOLE: (LATERALS)

LATERAL #1

| SEC | TWP | RGE | COUNTY |
|---|-----|---------------------|--------------|
| Spot Location | | | |
| 1/4 | 1/4 | 1/4 | 1/4 |
| Depth of Deviation | | Radius of Turn | Direction |
| Measured Total Depth | | True Vertical Depth | Total Length |
| BHL From Lease, Unit, or Property Line: | | | |

LATERAL #2

| SEC | TWP | RGE | COUNTY |
|---|-----|---------------------|--------------|
| Spot Location | | | |
| 1/4 | 1/4 | 1/4 | 1/4 |
| Depth of Deviation | | Radius of Turn | Direction |
| Measured Total Depth | | True Vertical Depth | Total Length |
| BHL From Lease, Unit, or Property Line: | | | |

LATERAL #3

| SEC | TWP | RGE | COUNTY |
|---|-----|---------------------|--------------|
| Spot Location | | | |
| 1/4 | 1/4 | 1/4 | 1/4 |
| Depth of Deviation | | Radius of Turn | Direction |
| Measured Total Depth | | True Vertical Depth | Total Length |
| BHL From Lease, Unit, or Property Line: | | | |