

Oklahoma Corporation Commission
Oil & Gas Conservation Division
Post Office Box 52000
Oklahoma City, Oklahoma 73152-2000
Rule 165: 10-3-25

Form 1002A

API No.: 35019222920001

Completion Report

Spud Date: May 14, 1981

OTC Prod. Unit No.:

Drilling Finished Date: May 25, 1981

Amended

1st Prod Date: June 16, 1981

Amend Reason: OPEN AND FRAC PORTION OF INTERVAL / CHANGE WELL NUMBER

Completion Date: July 16, 1981

Recomplete Date: January 05, 2019

Drill Type: STRAIGHT HOLE

Well Name: HEWITT UNIT 15-5702

Purchaser/Measurer:

Location: CARTER 15 4S 2W
SE SW SW SW
150 FSL 580 FWL of 1/4 SEC
Derrick Elevation: 0 Ground Elevation: 855

First Sales Date:

Operator: XTO ENERGY INC 21003

22777 SPRINGWOODS VILLAGE PKWY
SPRING, TX 77389-1425

Completion Type	
X	Single Zone
	Multiple Zone
	Commingle

Location Exception	
Order No	
There are no Location Exception records to display.	

Increased Density	
Order No	
There are no Increased Density records to display.	

Casing and Cement							
Type	Size	Weight	Grade	Feet	PSI	SAX	Top of CMT
CONDUCTOR	20			45			
SURFACE	10 3/4	40.5	K-55	684		675	SURFACE
PRODUCTION	7	20, 23	K-55	2433		850	

Liner								
Type	Size	Weight	Grade	Length	PSI	SAX	Top Depth	Bottom Depth
There are no Liner records to display.								

Total Depth: 2435

Packer	
Depth	Brand & Type
1070	PACKER

Plug	
Depth	Plug Type
1880	CIBP

Initial Test Data

Test Date	Formation	Oil BBL/Day	Oil-Gravity (API)	Gas MCF/Day	Gas-Oil Ratio Cu FT/BBL	Water BBL/Day	Pumpin or Flowing	Initial Shut-In Pressure	Choke Size	Flow Tubing Pressure
Jan 05, 2019	HEWITT	2		1	500	44	PUMPING			

Completion and Test Data by Producing Formation					
Formation Name: HEWITT		Code: 405HWTT		Class: OIL	
Spacing Orders		Perforated Intervals			
Order No	Unit Size	From		To	
67990	UNIT	1100		1794	
Acid Volumes		Fracture Treatments			
1,000 15% HCL		38,000 GALLONS GEL, 49,000 POUNDS SAND			

Formation	Top
------------------	------------

Were open hole logs run? No

Date last log run:

Were unusual drilling circumstances encountered? No

Explanation:

Other Remarks
IRREGULAR SECTION. SET CIBP @ 1,880' WITH 2 SACKS CEMENT. SHOOT SQUEEZE HOLES @ 1,026' - 1,027' (4 SPF). SQUEEZE 250 SACKS CEMENT. RUN RCBL TO FIND TOC @ 850'. OPEN LOWER BAYOU (1,100' - 1,160' @ 2 SPF). FRAC LOWER BAYOU.

FOR COMMISSION USE ONLY	
<div style="border: 1px solid black; padding: 5px; margin-bottom: 10px;">Status: Accepted</div>	1141863

RECEIVED

JAN 14 2019

Form 1002A
Rev. 2009

Oklahoma Corporation
Commission

API NO. **019-22292**
OTC PROD.
UNIT NO.

PLEASE TYPE OR USE BLACK INK ONLY
NOTE:

Attach copy of original 1002A
if recompletion or reentry.

OKLAHOMA CORPORATION COMMISSION
Oil & Gas Conservation Division
Post Office Box 52000
Oklahoma City, Oklahoma 73152-2000
Rule 165:10-3-25

☐ ORIGINAL
☒ AMENDED (Reason)

Open & frac portion of interval

COMPLETION REPORT

TYPE OF DRILLING OPERATION
☒ STRAIGHT HOLE ☐ DIRECTIONAL HOLE ☐ HORIZONTAL HOLE
☐ SERVICE WELL

If directional or horizontal, see reverse for bottom hole location.

COUNTY **Carter** SEC **15** TWP **4S** RGE **2W**
LEASE NAME **Hewitt Unit** WELL NO. **15-5702**
SW 1/4 SW 1/4 SW 1/4 SW 1/4 FSL OF 1/4 SEC **150** FWL OF 1/4 SEC **580**
ELEVATION **Ground 855** Latitude (if known) **34.2020327N**
OPERATOR NAME **XTO Energy Inc.** OTC/OCC OPERATOR NO. **21003**
ADDRESS **210 Park Avenue, Suite 2350**
CITY **Oklahoma City** STATE **Oklahoma** ZIP **73102**

SPUD DATE **5/14/1981**
DRLG FINISHED DATE **5/25/1981**
DATE OF WELL COMPLETION **7/16/1981**
1st PROD DATE **6/16/1981**
RECOMP DATE **1/05/2019**
Longitude (if known) **-97.4025163W**

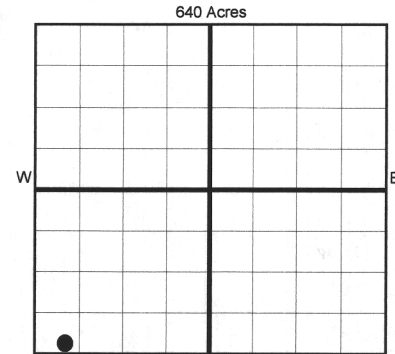

LOCATE WELL

COMPLETION TYPE

☒ SINGLE ZONE
☐ MULTIPLE ZONE
Application Date
☐ COMMINGLED
Application Date
LOCATION
EXCEPTION ORDER
INCREASED DENSITY
ORDER NO.

CASING & CEMENT (Form 1002C must be attached)

TYPE	SIZE	WEIGHT	GRADE	FEET	PSI	SAX	TOP OF CMT
CONDUCTOR	20:00			45			
SURFACE	10 3/4"	40.5#	K-55	684		675	Surface
INTERMEDIATE							
PRODUCTION	7"	20,23#	K-55	2,433		850	
LINER							

PACKER @ **1,070** BRAND & TYPE _____ PLUG @ **1880** TYPE **CIBP** PLUG @ _____ TYPE _____
PACKER @ _____ BRAND & TYPE _____ PLUG @ _____ TYPE _____ PLUG @ _____ TYPE _____

TOTAL DEPTH **2433'**

2435'

Per original 1002A

COMPLETION & TEST DATA BY PRODUCING FORMATION

405 HWTT

FORMATION	Hewitt Sands						Monitor
SPACING & SPACING ORDER NUMBER	67990 (unit)						Report to Focus
CLASS: Oil, Gas, Dry, Inj, Disp, Comm Disp, Svc	Oil						
PERFORATED INTERVALS	1100-2340 1794						
ACID/VOLUME	1000 15% HCL						
FRACTURE TREATMENT (Fluids/Prop Amounts)	38000 gals gel						
	49000# sand						

Min Gas Allowable (165:10-17-7)

Gas Purchaser/Measurer

OR

First Sales Date

INITIAL TEST DATA

Oil Allowable (165:10-13-3)

INITIAL TEST DATE	1/5/2019						
OIL-BBL/DAY	2 BOPD						
OIL-GRAVITY (API)							
GAS-MCF/DAY	1 MCFTD						
GAS-OIL RATIO CU FT/BBL	400 scf/bbl 500						
WATER-BBL/DAY	44 BWPD						
PUMPING OR FLOWING	Pumping						
INITIAL SHUT-IN PRESSURE							
CHOKE SIZE							
FLOW TUBING PRESSURE							

AS SUBMITTED

A record of the formations drilled through, and pertinent remarks are presented on the reverse. I declare that I have knowledge of the contents of this report and am authorized by my organization to make this report, which was prepared by me or under my supervision and direction, with the data and facts stated herein to be true, correct, and complete to the best of my knowledge and belief.

Debbie Waggoner SIGNATURE NAME (PRINT OR TYPE) **1/11/2019** DATE **405-319-3243** PHONE NUMBER
210 Park Avenue, Suite 2350 ADDRESS **Oklahoma City** CITY **Ok** STATE **73102** ZIP **debbie_waggoner@xtoenergy.com** EMAIL ADDRESS

Give formation names and tops, if available, or descriptions and thickness of formations drilled through. Show intervals cored or drillstem tested.

WELL NO. 15-5702

NAMES OF FORMATIONS	TOP

FOR COMMISSION USE ONLY	
ITD on file	<input type="checkbox"/> YES <input type="checkbox"/> NO
APPROVED	DISAPPROVED
2) Reject Codes	
<hr/>	
<hr/>	
<hr/>	
<hr/>	
<hr/>	

Were open hole logs run? ___ yes X no

Date Last log was run _____

Was CO₂ encountered? ___ yes X no at what depths? _____

Was H₂S encountered? ___ yes X no at what depths? _____

Were unusual drilling circumstances encountered? ___ yes X no

If yes, briefly explain below

Other remarks: Irregular Section

Set CIBP @ 1880' w/2 sx cmt. Shoot sqz holes @ 1026-27 (4 SPF). Sqz 250 sx cmt. Run RCBL to find TOC @ 850'. Open Lower Bayou (1100-1160 @ 2 SPF). Frac Lower Bayou.

640 Acres

A 10x10 grid representing 640 acres. The grid is divided into four 5x5 quadrants by a thick horizontal line and a thick vertical line. The text '640 Acres' is centered at the top of the grid.

If more than three drainholes are proposed, attach a separate sheet indicating the necessary information.

Direction must be stated in degrees azimuth.
Please note, the horizontal drainhole and its end
point must be located within the boundaries of the
lease or spacing unit.

Directional surveys are required for all drainholes and directional wells.

640 Acres

SEC	TWP	RGE	COUNTY
Spot Location			
1/4	1/4	1/4	1/4
Measured Total Depth		True Vertical Depth	BHL From Lease, Unit, or Property Line:

LATERAL #1							
SEC	TWP	RGE	COUNTY				
Spot Location		1/4	1/4	1/4	Feet From 1/4 Sec Lines	FNL	FEL
Depth of Deviation		Radius of Turn		Direction		Total Length	
Measured Total Depth		True Vertical Depth		BHL From Lease, Unit, or Property Line:			

LATERAL #2						
SEC	TWP	RGE	COUNTY			
Spot Location				Feet From 1/4 Sec Lines	FSL	FWL
1/4	1/4	1/4	1/4			
Depth of Deviation		Radius of Turn	Direction	Total Length		
Measured Total Depth		True Vertical Depth	BHL From Lease, Unit, or Property Line:			

LATERAL #3							
SEC	TWP	RGE	COUNTY				
Spot Location					Feet From 1/4 Sec Lines	FSL	FWL
1/4		1/4		1/4			
Depth of Deviation		Radius of Turn		Direction		Total Length	
Measured Total Depth		True Vertical Depth		BHL From Lease, Unit, or Property Line:			