

Oklahoma Corporation Commission
Oil & Gas Conservation Division
Post Office Box 52000
Oklahoma City, Oklahoma 73152-2000
Rule 165: 10-3-25

Form 1002A

API No.: 35037294720000

Completion Report

Spud Date: May 08, 2021

OTC Prod. Unit No.:

Drilling Finished Date: May 13, 2021

1st Prod Date: September 10, 2021

Completion Date: August 20, 2021

Drill Type: STRAIGHT HOLE

Well Name: NUGGET 2-24

Purchaser/Measurer:

Location: CREEK 24 14N 9E
C SW NE NE
990 FNL 990 FEL of 1/4 SEC
Derrick Elevation: 0 Ground Elevation: 800

First Sales Date:

Operator: WFD OIL CORPORATION 17501

16800 CONIFER LN
EDMOND, OK 73012-0619

Completion Type		Location Exception		Increased Density	
X	Single Zone	Order No		Order No	
	Multiple Zone	There are no Location Exception records to display.		There are no Increased Density records to display.	
	Commingled				

Casing and Cement								
Type		Size	Weight	Grade	Feet	PSI	SAX	Top of CMT
SURFACE		7	23	NEW	234		65	SURFACE
PRODUCTION		4 1/2	11.5	NEW	3575		160	1900

Liner								
Type	Size	Weight	Grade	Length	PSI	SAX	Top Depth	Bottom Depth
There are no Liner records to display.								

Total Depth: 3588

Packer		Plug	
Depth	Brand & Type	Depth	Plug Type
There are no Packer records to display.		There are no Plug records to display.	

Initial Test Data										
Test Date	Formation	Oil BBL/Day	Oil-Gravity (API)	Gas MCF/Day	Gas-Oil Ratio Cu FT/BBL	Water BBL/Day	Pumpin or Flowing	Initial Shut-In Pressure	Choke Size	Flow Tubing Pressure
Aug 20, 2021	DUTCHER	10	38				PUMPING			

Completion and Test Data by Producing Formation			
Formation Name: DUTCHER		Code: 403DTCR	Class: OIL
Spacing Orders		Perforated Intervals	
Order No	Unit Size	From	To
701434	40	2916	2942
Acid Volumes		Fracture Treatments	
500 GALLONS		There are no Fracture Treatments records to display.	

Formation	Top
SKINNER	1948
PINK LS	2137
RED FORK	2200
BARTLESVILLE	2450
BOOCH	2744
DUTCHER	2830
VIOLA	3495
WILCOX	3542

Were open hole logs run? Yes
Date last log run:

Were unusual drilling circumstances encountered? No
Explanation:

Other Remarks
There are no Other Remarks.

FOR COMMISSION USE ONLY	
Status: Accepted	1146933

OIL AND GAS CONSERVATION DIVISION
P.O. Box 52000
Oklahoma City, OK 73152-2000
405-522-0577
occentralprocessing@occ.ok.gov



Form 1002A
Rev. 2009

<input checked="" type="checkbox"/> ORIGINAL <input type="checkbox"/> AMENDED (Reason)		WELL COMPLETION REPORT	
TYPE OF DRILLING OPERATION <input checked="" type="checkbox"/> STRAIGHT HOLE <input type="checkbox"/> DIRECTIONAL HOLE <input type="checkbox"/> HORIZONTAL HOLE		OAC 165:10-3-25 (PLEASE TYPE OR USE BLACK INK ONLY)	
If directional or horizontal, see reverse for bottom hole location.		SPUD DATE 5/8/2021	
COUNTY CREEK SEC 24 TWP 14N RGE 9E		DRLG FINISHED DATE 5-13-2021	
LEASE NAME NUGGET		DATE OF WELL COMPLETION 8-20-2021	
C 1/4 SW 1/4 NE 1/4 NE 1/4		1st PROD DATE 9-10-2021	
ELEVATION Ground 800		RECOMP DATE	
Derrick FL		WELL NO. 2-24	
OPERATOR NAME WFO OIL CORP		1st PROD DATE 9-10-2021	
ADDRESS 16800 CONIFER LANE		RECOMP DATE	
CITY EDMOND, STATE OK ZIP 73012		RECOMP DATE	

API NO. 03709472
OTC PROP UNIT NO.

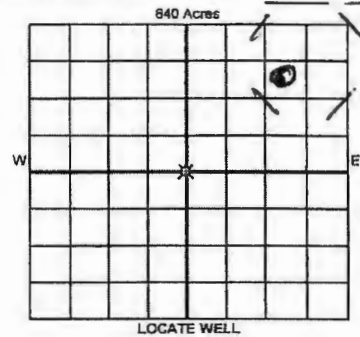

COMPLETION TYPE		CASING & CEMENT (Attach Form 1002C)							
<input checked="" type="checkbox"/> SINGLE ZONE		TYPE	SIZE	WEIGHT	GRADE	FEET	PSI	SAX	TOP OF CMT
<input type="checkbox"/> MULTIPLE ZONE		CONDUCTOR							
Application Date		SURFACE	7	23	NEW	234		65	Surface
<input type="checkbox"/> COMMINGLED		INTERMEDIATE							
Application Date		PRODUCTION	4 1/2	11.5	NEW	3575		160	1900'
LOCATION EXCEPTION ORDER NO.		LINER							
INCREASED DENSITY ORDER NO.									
		TOTAL DEPTH 3588							

PACKER @	BRAND & TYPE	PLUG @	TYPE	PLUG @	TYPE	PLUG @	TYPE
PACKER @	BRAND & TYPE	PLUG @	TYPE	PLUG @	TYPE	PLUG @	TYPE

COMPLETION & TEST DATA BY PRODUCING FORMATION		403 DTCR	
FORMATION	Dutcher	NO Fiac	
SPACING & SPACING ORDER NUMBER	701434 (40)		
CLASS: Oil, Gas, Dry, Inj, Disp, Comm Disp, Svc	OIL		
PERFORATED INTERVALS	2916-42	RECEIVED	
ACID/VOLUME	500 GAL	SEP 28 2021	
FRACTURE TREATMENT (Fluids/Prop Amounts)		OKLAHOMA CORPORATION COMMISSION	

Min Gas Allowable (165:10-17-7) OR Oil Allowable (165:10-13-3)		Gas Purchaser/Measurer First Sales Date	
INITIAL TEST DATA			
INITIAL TEST DATE	8/30/2021		
OIL-BBL/DAY	10		
OIL-GRAVITY (API)	38		
GAS-MCF/DAY	TSTM		
GAS-OIL RATIO CU FT/BBL			
WATER-BBL/DAY	0		
PUMPING OR FLOWING	pumping		
INITIAL SHUT-IN PRESSURE			
CHOKE SIZE			
FLOW TUBING PRESSURE			

A record of the formations drilled through, and pertinent remarks are presented on the reverse. I declare that I have knowledge of the contents of this report and am authorized by my organization to make this report, which was prepared by me or under my supervision and direction, with the data and facts stated herein to be true, correct, and complete to the best of my knowledge and belief.

SIGNATURE	NAME (PRINT OR TYPE)	DATE	PHONE NUMBER
W. D. DOST JR.	W. D. DOST JR.	9/23/2021	405-710-3160
16800 CONIFER LANE	EDMOND OK 73012	Bdost.wfo@coincet.net	
ADDRESS	CITY STATE ZIP	EMAIL ADDRESS	

PLEASE TYPE OR USE BLACK INK ONLY
FORMATION RECORD

Give formation names and tops, if available, or descriptions and thickness of formations drilled through. Show intervals cored or drillstem tested.

NAMES OF FORMATIONS	TOP
Skinner	1948
Dink LS	2137
Red Fork	2300
Antlersville	2450
Booch	2744
Dutcher	2830
VIO LA	3495
WILCOX	3542

LEASE NAME

Mugget 2024

WELL NO.

004

FOR COMMISSION USE ONLY

ITD on file ☐ YES ☐ NO

APPROVED ☐ DISAPPROVED ☐ 2) Reject Codes

Were open hole logs run? ☒ yes ☐ no

Date Last log was run _____

Was CO₂ encountered? ☐ yes ☒ no at what depths? _____

Was H₂S encountered? ☐ yes ☒ no at what depths? _____

Were unusual drilling circumstances encountered? ☐ yes ☒ no

If yes, briefly explain below _____

Other remarks:

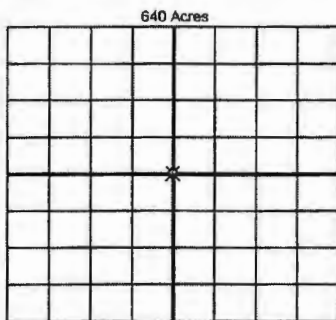

If more than three drainholes are proposed, attach a separate sheet indicating the necessary information.

Direction must be stated in degrees azimuth. Please note, the horizontal drainhole and its end point must be located within the boundaries of the lease or spacing unit.

Directional surveys are required for all drainholes and directional wells.

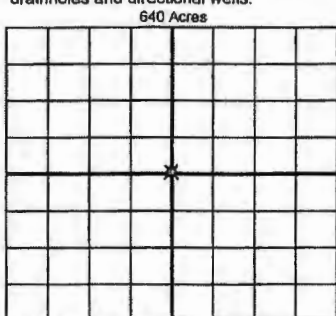

BOTTOM HOLE LOCATION FOR DIRECTIONAL HOLE

SEC	TWP	RGE	COUNTY
Spot Location			
1/4	1/4	1/4	1/4
Measured Total Depth		True Vertical Depth	BHL From Lease, Unit, or Property Line:

BOTTOM HOLE LOCATION FOR HORIZONTAL HOLE: (LATERALS)

LATERAL #1

SEC	TWP	RGE	COUNTY
Spot Location			
1/4	1/4	1/4	1/4
Depth of Deviation		Radius of Turn	Direction
Measured Total Depth		True Vertical Depth	BHL From Lease, Unit, or Property Line:

LATERAL #2

SEC	TWP	RGE	COUNTY
Spot Location			
1/4	1/4	1/4	1/4
Depth of Deviation		Radius of Turn	Direction
Measured Total Depth		True Vertical Depth	BHL From Lease, Unit, or Property Line:

LATERAL #3

SEC	TWP	RGE	COUNTY
Spot Location			
1/4	1/4	1/4	1/4
Depth of Deviation		Radius of Turn	Direction
Measured Total Depth		True Vertical Depth	BHL From Lease, Unit, or Property Line: