

Oklahoma Corporation Commission
Oil & Gas Conservation Division
Post Office Box 52000
Oklahoma City, Oklahoma 73152-2000
Rule 165: 10-3-25

Form 1002A

API No.: 35117234070001

Completion Report

Spud Date: August 06, 2010

OTC Prod. Unit No.: 117-0204520-0-0000

Drilling Finished Date: September 24, 2010

Amended

1st Prod Date: October 22, 2010

Amend Reason: RECOMPLETION

Completion Date: October 21, 2010

Recomplete Date: July 14, 2021

Drill Type: HORIZONTAL HOLE

Min Gas Allowable: Yes

Well Name: SPIDER 1-29H

Purchaser/Measurer:

Location: PAWNEE 29 23N 4E
NE NE NW NW
2495 FSL 1084 FWL of 1/4 SEC
Derrick Elevation: 913 Ground Elevation: 898

First Sales Date:

Operator: PETRO WARRIOR LLC 22165
PO BOX 3399
215 S ASH
WICHITA, KS 67201-3399

Completion Type	
X	Single Zone
	Multiple Zone
	Commingled

Location Exception
Order No
717667

Increased Density
Order No
There are no Increased Density records to display.

Casing and Cement							
Type	Size	Weight	Grade	Feet	PSI	SAX	Top of CMT
CONDUCTOR	20	94	H-40	38	1530	10	SURFACE
SURFACE	9.625	36	J-55	302	3520	165	SURFACE
PRODUCTION	7.00	26	J-55	4606	4980	400	2708

Liner								
Type	Size	Weight	Grade	Length	PSI	SAX	Top Depth	Bottom Depth
LINER	4.5	11.6	N-80	4572	7780	300	3124	7696

Total Depth: 8118

Packer	
Depth	Brand & Type
3650	CAST IRON

Plug	
Depth	Plug Type
There are no Plug records to display.	

Initial Test Data

Test Date	Formation	Oil BBL/Day	Oil-Gravity (API)	Gas MCF/Day	Gas-Oil Ratio Cu FT/BBL	Water BBL/Day	Pumpin or Flowing	Initial Shut-In Pressure	Choke Size	Flow Tubing Pressure
Jul 19, 2021	RED FORK	15	43.5	60	4000	155	PUMPING			

Completion and Test Data by Producing Formation

Formation Name: RED FORK		Code: 404RDFK	Class: OIL										
<div>Spacing Orders</div> <table> <tr> <th>Order No</th> <th>Unit Size</th> </tr> <tr> <td>717187</td> <td>640</td> </tr> </table>		Order No	Unit Size	717187	640	<div>Perforated Intervals</div> <table> <tr> <th>From</th> <th>To</th> </tr> <tr> <td>3472</td> <td>3500</td> </tr> <tr> <td>3510</td> <td>3528</td> </tr> </table>		From	To	3472	3500	3510	3528
Order No	Unit Size												
717187	640												
From	To												
3472	3500												
3510	3528												
<div>Acid Volumes</div> <table> <tr> <td>1,200 GALLONS 10% SME</td> </tr> </table>		1,200 GALLONS 10% SME	<div>Fracture Treatments</div> <table> <tr> <td>873 BARRELS XLINK GEL WITH 41,500 POUNDS 16/30 AND 23,790 POUNDS 12/20 SAND</td> </tr> </table>		873 BARRELS XLINK GEL WITH 41,500 POUNDS 16/30 AND 23,790 POUNDS 12/20 SAND								
1,200 GALLONS 10% SME													
873 BARRELS XLINK GEL WITH 41,500 POUNDS 16/30 AND 23,790 POUNDS 12/20 SAND													

Formation	Top
RED FORK SST	3472

Were open hole logs run? Yes
Date last log run: September 04, 2010

Were unusual drilling circumstances encountered? No
Explanation:

Other Remarks
There are no Other Remarks.

Lateral Holes
Sec: 29 TWP: 23N RGE: 4E County: PAWNEE NE SW SE SW 478 FSL 1960 FWL of 1/4 SEC Depth of Deviation: 2921 Radius of Turn: 885 Direction: 170 Total Length: 3637 Measured Total Depth: 8118 True Vertical Depth: 3730 End Pt. Location From Release, Unit or Property Line: 478

FOR COMMISSION USE ONLY
<div>Status: Accepted</div> <div>1146943</div>

API NO. 35-117-23407
OTC PROD. UNIT NO. 117-204520

Oil and Gas Conservation Division
P.O. Box 52000
Oklahoma City, OK 73152-2000
405-521-2331
OCCentralProcessing@OCC.OK.GOV



OKLAHOMA
Corporation
Commission

Form 1002A
Rev. 2020

☒ ORIGINAL
☐ AMENDED (Reason)

RE-COMPLETION

Rule 165:10-3-25

COMPLETION REPORT

TYPE OF DRILLING OPERATION

☐ STRAIGHT HOLE ☐ DIRECTIONAL HOLE ☒ HORIZONTAL HOLE
☐ SERVICE WELL

If directional or horizontal, see reverse for bottom hole location.

COUNTY	PAWNEE	SEC	29	TWP	23N	RGE	04E	SPUD DATE	08-06-2010
LEASE NAME	SPIDER				WELL NO.	1-29H	DRLG FINISHED DATE	09-24-2010	
NE 1/4 NE 1/4 NW 1/4 NW 1/4	FSL	2495	FWL	1084	DATE OF WELL COMPLETION	10-21-2010			
ELEVATION	913	Ground	898	Latitude	36 08' 31.8"N	1st PROD DATE	10-22-2010		
OPERATOR NAME	PETRO WARRIOR LLC				OTC / OCC OPERATOR NO.	22165			
ADDRESS	PO Box 3399								
CITY	WICHITA		STATE	KS	ZIP	67201-3399			

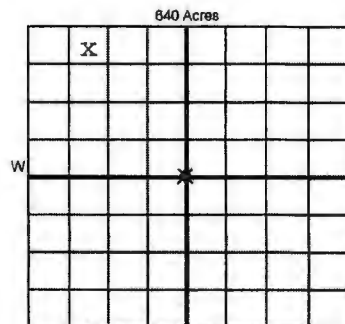

COMPLETION TYPE

<input checked="" type="radio"/> SINGLE ZONE	
<input type="radio"/> MULTIPLE ZONE	
<input type="radio"/> COMMINGLED	
LOCATION EXCEPTION ORDER NO.	717667
MULTIUNIT ORDER NO.	
INCREASED DENSITY ORDER NO.	

CASING & CEMENT (Attach Form 1002C)

TYPE	SIZE	WEIGHT	GRADE	FEET	PSI	SAX	TOP OF CMT
CONDUCTOR	20	94	H-40	38	1530	10	SURFACE
SURFACE	9.625	36	J-55	302	3520	165	SURFACE
INTERMEDIATE							
PRODUCTION	7.00	26	J-55	4606	4980	400	2708
LINER	4.5	11.6	N-80	3124 4672 7696	7780	300	

PACKER @ _____ BRAND & TYPE _____ PLUG @ _____ TYPE CAST IRON PLUG @ _____ TYPE _____ TOTAL DEPTH 8118
PACKER @ _____ BRAND & TYPE _____ PLUG @ _____ TYPE _____ PLUG @ _____ TYPE _____

COMPLETION & TEST DATA BY PRODUCING FORMATION

FORMATION	RED FORK S&T.							Monitors
SPACING & SPACING ORDER NUMBER	640 - #717187							Report to Field Focus
CLASS: Oil, Gas, Dry, Inj, Disp, Comm Disp, Svc	Oil							
PERFORATED INTERVALS	3472-3500 4spf							
	3510-3528 4spf							
ACID/VOLUME	1200gal 10% SME							
FRACTURE TREATMENT (Fluids/Prop Amounts)	873bbls Xlink Gel w/ 41,500# 16/30 & 23,790# 12/20 Sand							



Min Gas Allowable (165:10-17-7)

OR

Oil Allowable (165:10-13-3)

Purchaser/Measurer

First Sales Date

INITIAL TEST DATA

INITIAL TEST DATE	7-19-2021						
OIL-BBL/DAY	15						
OIL-GRAVITY (API)	43.5						
GAS-MCF/DAY	60						
GAS-OIL RATIO CU FT/BBL	4000						
WATER-BBL/DAY	155						
PUMPING OR FLOWING	Pumping						
INITIAL SHUT-IN PRESSURE							
CHOKE SIZE							
FLOW TUBING PRESSURE							

RECEIVED

SEP 27 2021

OKLAHOMA CORPORATION
COMMISSION

A record of the formations drilled through and pertinent remarks are presented on the reverse. I declare that I have knowledge of the contents of this report and am authorized by my organization to make this report, which was prepared by me or under my supervision and direction, with the data and facts stated herein to be true, correct, and complete to the best of my knowledge and belief.

SIGNATURE	ROBERT F. PFANNENSTIEL	DATE	9-22-21	PHONE NUMBER	405-612-1534
PO Box 3399	Wichita	KS	67201	PETROWARRIOR@YAHOO.COM	
ADDRESS	CITY	STATE	ZIP	EMAIL ADDRESS	

PLEASE TYPE OR USE BLACK INK ONLY
FORMATION RECORD

Give formation names and tops, if available, or descriptions and thickness of formations drilled through. Show intervals cored or drillstem tested.

NAMES OF FORMATIONS	TOP
RED FORK SST	3472MD

LEASE NAME SPIDER WELL NO. 1-29H

FOR COMMISSION USE ONLY	
ITD on file <input type="checkbox"/> YES <input type="checkbox"/> NO	
APPROVED <input type="checkbox"/> DISAPPROVED <input type="checkbox"/>	2) Reject Codes

Were open hole logs run?	<input checked="" type="radio"/> yes <input type="radio"/> no
Date Last log was run	9-04-2010
Was CO ₂ encountered?	<input type="radio"/> yes <input type="radio"/> no at what depths?
Was H ₂ S encountered?	<input type="radio"/> yes <input type="radio"/> no at what depths?
Were unusual drilling circumstances encountered?	<input type="radio"/> yes <input checked="" type="radio"/> no
If yes, briefly explain below	

Other remarks:

*DROP BOX for
FWL - FEL
does not
work.
↓*

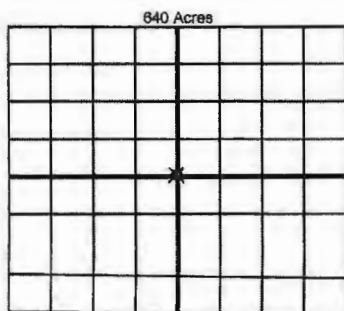

If more than three drainholes are proposed, attach a separate sheet indicating the necessary information.

Direction must be stated in degrees azimuth. Please note, the horizontal drainhole and its end point must be located within the boundaries of the lease or spacing unit.

Directional surveys are required for all drainholes and directional wells

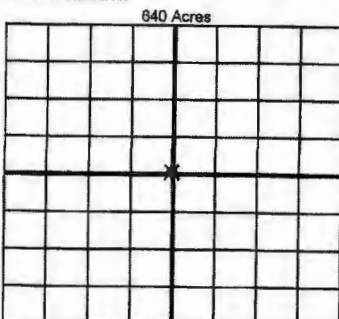

BOTTOM HOLE LOCATION FOR DIRECTIONAL HOLE

SEC	TWP	RGE	COUNTY
1/4	1/4	1/4	1/4
Measured Total Depth		True Vertical Depth	BHL From Lease, Unit, or Property Line:

BOTTOM HOLE LOCATION FOR HORIZONTAL HOLE: (LATERALS)

LATERAL #1				PAWNEE			
SEC	TWP	RGE	COUNTY				
29	23N	04E	COUNTY				
NE 1/4	SW 1/4	SE 1/4	SW 1/4	Feet From 1/4 Sec Lines	FSL	FWL	
Depth of Deviation	2921	Radius of Turn	885	Direction	170	Total Length	3637
Measured Total Depth	8118	True Vertical Depth	3730	BHL From Lease, Unit, or Property Line:		478	

LATERAL #2

SEC	TWP	RGE	COUNTY
1/4	1/4	1/4	1/4
Depth of Deviation	Radius of Turn	Direction	Total Length
Measured Total Depth	True Vertical Depth	BHL From Lease, Unit, or Property Line:	

LATERAL #3

SEC	TWP	RGE	COUNTY
1/4	1/4	1/4	1/4
Depth of Deviation	Radius of Turn	Direction	Total Length
Measured Total Depth	True Vertical Depth	BHL From Lease, Unit, or Property Line:	