

Oklahoma Corporation Commission
Oil & Gas Conservation Division
Post Office Box 52000
Oklahoma City, Oklahoma 73152-2000
Rule 165: 10-3-25

Form 1002A

API No.: 35037294760000

Completion Report

Spud Date: June 14, 2021

OTC Prod. Unit No.:

Drilling Finished Date: June 19, 2021

1st Prod Date: September 23, 2021

Completion Date: September 23, 2021

Drill Type: STRAIGHT HOLE

Well Name: VANORSOL 3

Purchaser/Measurer:

Location: CREEK 29 15N 9E
SW NE SE NE
1658 FNL 475 FEL of 1/4 SEC
Derrick Elevation: 0 Ground Elevation: 871

First Sales Date:

Operator: WFD OIL CORPORATION 17501

16800 CONIFER LN
EDMOND, OK 73012-0619

Completion Type		Location Exception		Increased Density	
X	Single Zone	Order No		Order No	
	Multiple Zone	There are no Location Exception records to display.		718099	
	Commingled				

Casing and Cement							
Type	Size	Weight	Grade	Feet	PSI	SAX	Top of CMT
SURFACE	9 5/8		NEW	407		200	SURFACE
PRODUCTION	7		NEW	2358		150	850

Liner								
Type	Size	Weight	Grade	Length	PSI	SAX	Top Depth	Bottom Depth
There are no Liner records to display.								

Total Depth: 2385

Packer		Plug	
Depth	Brand & Type	Depth	Plug Type
There are no Packer records to display.		There are no Plug records to display.	

Initial Test Data										
Test Date	Formation	Oil BBL/Day	Oil-Gravity (API)	Gas MCF/Day	Gas-Oil Ratio Cu FT/BBL	Water BBL/Day	Pumpin or Flowing	Initial Shut-In Pressure	Choke Size	Flow Tubing Pressure
Sep 23, 2021	SKINNER	10	43				PUMPING			

Completion and Test Data by Producing Formation			
Formation Name: SKINNER		Code: 404SKNR	Class: OIL
Spacing Orders		Perforated Intervals	
Order No	Unit Size	From	To
264812	40	2304	2340
Acid Volumes		Fracture Treatments	
250 GALLONS		There are no Fracture Treatments records to display.	

Formation	Top
LAYTON	1300
SKINNER	2306

Were open hole logs run? Yes
Date last log run: July 23, 2021

Were unusual drilling circumstances encountered? No
Explanation:

Other Remarks
There are no Other Remarks.

FOR COMMISSION USE ONLY	
Status: Accepted	1146938

OIL AND GAS CONSERVATION DIVISION
P.O. Box 52000
Oklahoma City, OK 73152-2000
405-522-0577
occentralprocessing@occ.ok.gov

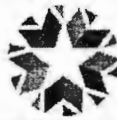

OKLAHOMA
Corporation
Commission

Form 1002A
Rev. 2009

API
NO. 037 39476
OTC PROD.
UNIT NO.

☒ ORIGINAL
☐ AMENDED (Reason) _____

WELL COMPLETION REPORT
OAC 165-10-3-25 (PLEASE TYPE OR USE BLACK INK ONLY)

TYPE OF DRILLING OPERATION
☒ STRAIGHT HOLE ☐ DIRECTIONAL HOLE ☐ HORIZONTAL HOLE
☐ SERVICE WELL

If directional or horizontal, see reverse for bottom hole location.

COUNTY CLICK SEC 29 TWP 15N RGE 9E
LEASE NAME VANORS002 WELL NO. 3
SW 1/4 NB 1/4 SB 1/4 UB 1/4 ENE 1/4 SEC 1658 ENE 1/4 SEC 475
ELEVATION Ground 871 Latitude (if known) Longitude (if known)
OPERATOR NAME WFOOLL CORP OTC / OCC OPERATOR NO. 17581
ADDRESS 16800 Conifer Ln
CITY Edmond STATE OK ZIP 73012

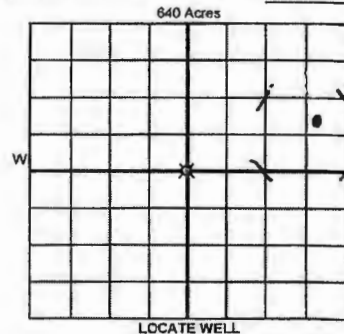

COMPLETION TYPE
☒ SINGLE ZONE
☐ MULTIPLE ZONE
Application Date
COMINGLED
Application Date
LOCATION EXCEPTION
ORDER NO.
INCREASED DENSITY
ORDER NO. 718099

CASING & CEMENT (Attach Form 1002C)

TYPE	SIZE	WEIGHT	GRADE	FEET	PSI	SAX	TOP OF CMT
CONDUCTOR							
SURFACE	<u>958</u>		<u>new</u>	<u>407</u>		<u>240</u>	<u>surface</u>
INTERMEDIATE							
PRODUCTION	<u>7</u>		<u>new</u>	<u>2358</u>		<u>150</u>	<u>550</u>
LINER							

PACKER @ _____ BRAND & TYPE _____ PLUG @ _____ TYPE _____ PLUG @ _____ TYPE _____ TOTAL DEPTH 2385
PACKER @ _____ BRAND & TYPE _____ PLUG @ _____ TYPE _____ PLUG @ _____ TYPE _____

COMPLETION & TEST DATA BY PRODUCING FORMATION 4045KNR

FORMATION	SPACING & SPACING ORDER NUMBER	CLASS: Oil, Gas, Dry, Inj, Disp, Comm Disp, Svc	PERFORATED INTERVALS	ACID/VOLUME	FRACTURE TREATMENT (Fluids/Prop Amounts)
<u>SKINNER</u>	<u>264812 (40)</u>	<u>oil</u>	<u>2304-40</u>	<u>250 gals</u>	

RECEIVED
SEP 28 2021
OKLAHOMA CORPORATION
COMMISSION

Min Gas Allowable (165-10-17-7) OR Oil Allowable (165-10-13-3) Gas Purchaser/Measurer First Sales Date

INITIAL TEST DATA

INITIAL TEST DATE	OIL-BBL/DAY	OIL-GRAVITY (API)	GAS-MCF/DAY	GAS-OIL RATIO CU FT/BBL	WATER-BBL/DAY	PUMPING OR FLOWING	INITIAL SHUT-IN PRESSURE	CHOKE SIZE	FLOW TUBING PRESSURE
<u>9/23/21</u>	<u>10</u>	<u>43</u>	<u>150m</u>		<u>150m</u>	<u>pumpin g</u>			

A record of the formations drilled through, and pertinent remarks are presented on the reverse. I declare that I have knowledge of the contents of this report and am authorized by my organization to make this report, which was prepared by me or under my supervision and direction, with the data and facts stated herein to be true, correct, and complete to the best of my knowledge and belief.

SIGNATURE WFOOLL NAME (PRINT OR TYPE) WFOOLL DATE 9/23/21 PHONE NUMBER 405-715-3170
ADDRESS 16800 Conifer Ln CITY Edmond STATE OK ZIP 73012 EMAIL ADDRESS WFOOLL@COXNET.NB

PLEASE TYPE OR USE BLACK INK ONLY
FORMATION RECORD

Give formation names and tops, if available, or descriptions and thickness of formations drilled through. Show intervals cored or drillstem tested.

NAMES OF FORMATIONS	TOP
Layer 1 5 Kinner	1300 2300

LEASE NAME VANORS DOOL

WELL NO. 3

FOR COMMISSION USE ONLY	
ITD on file <input type="checkbox"/> YES <input type="checkbox"/> NO	
APPROVED _____	DISAPPROVED _____
2) Reject Codes	

Were open hole logs run?	<input checked="" type="checkbox"/> yes <input type="checkbox"/> no
Date Last log was run	<u>7/23/2021</u>
Was CO ₂ encountered?	<input type="checkbox"/> yes <input checked="" type="checkbox"/> no at what depths? _____
Was H ₂ S encountered?	<input type="checkbox"/> yes <input checked="" type="checkbox"/> no at what depths? _____
Were unusual drilling circumstances encountered?	<input type="checkbox"/> yes <input checked="" type="checkbox"/> no
If yes, briefly explain below	

Other remarks:

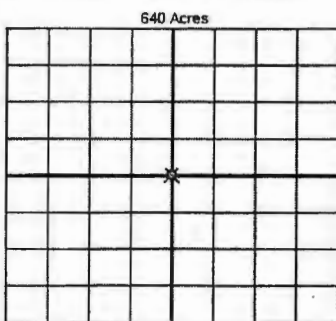

If more than three drainholes are proposed, attach a separate sheet indicating the necessary information.

Direction must be stated in degrees azimuth.
Please note, the horizontal drainhole and its end point must be located within the boundaries of the lease or spacing unit.

Directional surveys are required for all drainholes and directional wells.

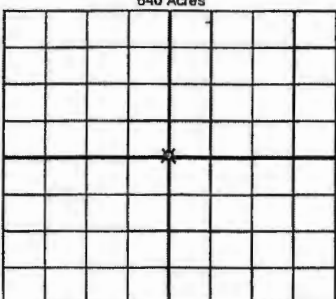

BOTTOM HOLE LOCATION FOR DIRECTIONAL HOLE

SEC	TWP	RGE	COUNTY
Spot Location			
1/4	1/4	1/4	1/4
Measured Total Depth		True Vertical Depth	BHL From Lease, Unit, or Property Line:

BOTTOM HOLE LOCATION FOR HORIZONTAL HOLE: (LATERALS)

LATERAL #1			
SEC	TWP	RGE	COUNTY
Spot Location			
1/4	1/4	1/4	1/4
Depth of Deviation		Radius of Turn	Direction
Measured Total Depth		True Vertical Depth	BHL From Lease, Unit, or Property Line:

LATERAL #2			
SEC	TWP	RGE	COUNTY
Spot Location			
1/4	1/4	1/4	1/4
Depth of Deviation		Radius of Turn	Direction
Measured Total Depth		True Vertical Depth	BHL From Lease, Unit, or Property Line:

LATERAL #3			
SEC	TWP	RGE	COUNTY
Spot Location			
1/4	1/4	1/4	1/4
Depth of Deviation		Radius of Turn	Direction
Measured Total Depth		True Vertical Depth	BHL From Lease, Unit, or Property Line: