

Oklahoma Corporation Commission  
Oil & Gas Conservation Division  
Post Office Box 52000  
Oklahoma City, Oklahoma 73152-2000  
Rule 165: 10-3-25

Form 1002A

API No.: 35037294690000

**Completion Report**

Spud Date: March 25, 2021

OTC Prod. Unit No.:

Drilling Finished Date: March 29, 2021

1st Prod Date: May 01, 2021

Completion Date: April 20, 2021

**Drill Type: STRAIGHT HOLE**

Well Name: GOOBERS GOLD 1-28

Purchaser/Measurer:

Location: CREEK 28 15N 9E  
W2 SW SW NW  
330 FSL 165 FWL of 1/4 SEC  
Derrick Elevation: 880 Ground Elevation: 0

First Sales Date:

Operator: WFD OIL CORPORATION 17501

16800 CONIFER LN  
EDMOND, OK 73012-0619

Completion Type		Location Exception		Increased Density	
X	Single Zone	Order No		Order No	
	Multiple Zone	There are no Location Exception records to display.		There are no Increased Density records to display.	
	Commingled				

Casing and Cement							
Type	Size	Weight	Grade	Feet	PSI	SAX	Top of CMT
SURFACE	7	23	NEW	404		110	SURFACE
PRODUCTION	4 1/2	11.5	NEW	2579		90	1360

Liner								
Type	Size	Weight	Grade	Length	PSI	SAX	Top Depth	Bottom Depth
There are no Liner records to display.								

**Total Depth: 2580**

Packer		Plug	
Depth	Brand & Type	Depth	Plug Type
There are no Packer records to display.		There are no Plug records to display.	

Initial Test Data										
Test Date	Formation	Oil BBL/Day	Oil-Gravity (API)	Gas MCF/Day	Gas-Oil Ratio Cu FT/BBL	Water BBL/Day	Pumpin or Flowing	Initial Shut-In Pressure	Choke Size	Flow Tubing Pressure
Apr 20, 2021	SKINNER	30	42				FLOWING			

**Completion and Test Data by Producing Formation**

Formation Name: SKINNER

Code: 404SKNR

Class: OIL

**Spacing Orders**

Order No	Unit Size
714570	40

**Perforated Intervals**

From	To
2323	2346

**Acid Volumes**

1,000 GALLONS
---------------

**Fracture Treatments**

There are no Fracture Treatments records to display.
--

Formation	Top
LAYTON	1250
SKINNER Z	2226
SKINNER SS	2324
PINK LS	2420
RED FORK SS	2504

Were open hole logs run? Yes

Date last log run: April 15, 2021

Were unusual drilling circumstances encountered? No

Explanation:

**Other Remarks**

There are no Other Remarks.

**FOR COMMISSION USE ONLY**

1146935

Status: Accepted



PLEASE TYPE OR USE BLACK INK ONLY  
FORMATION RECORD

Give formation names and tops, if available, or descriptions and thickness of formations drilled through. Show intervals cored or drillstem tested.

NAMES OF FORMATIONS	TOP
LAYTON	1250
SKINNER Z	2226
SKINNER SS	2324
PINK LS	2420
KEP FOCK SS	2504
T D	2580

LEASE NAME GOOBERS GOLD

WELL NO. 1-28

FOR COMMISSION USE ONLY		
ITD on file	<input type="checkbox"/> YES	<input type="checkbox"/> NO
APPROVED	DISAPPROVED	2) Reject Codes

Were open hole logs run?	<input checked="" type="checkbox"/> yes	<input type="checkbox"/> no
Date last log was run	<u>4-15-2021</u>	
Was CO <sub>2</sub> encountered?	<input type="checkbox"/> yes	<input checked="" type="checkbox"/> no at what depths? <u>          </u>
Was H <sub>2</sub> S encountered?	<input type="checkbox"/> yes	<input checked="" type="checkbox"/> no at what depths? <u>          </u>
Were unusual drilling circumstances encountered?	<input type="checkbox"/> yes <input checked="" type="checkbox"/> no	
If yes, briefly explain below		

Other remarks:

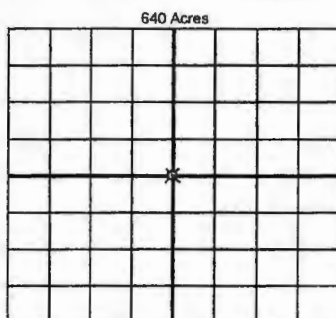

If more than three drainholes are proposed, attach a separate sheet indicating the necessary information.

Direction must be stated in degrees azimuth.  
Please note, the horizontal drainhole and its end point must be located within the boundaries of the lease or spacing unit.

Directional surveys are required for all drainholes and directional wells.

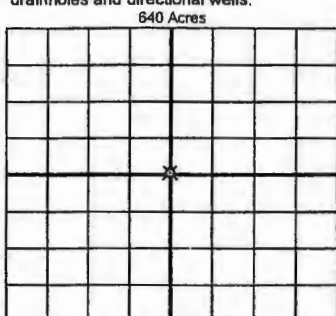

BOTTOM HOLE LOCATION FOR DIRECTIONAL HOLE

SEC	TWP	RGE	COUNTY
Spot Location			
1/4	1/4	1/4	1/4
Measured Total Depth		True Vertical Depth	BHL From Lease, Unit, or Property Line:

BOTTOM HOLE LOCATION FOR HORIZONTAL HOLE: (LATERALS)

LATERAL #1			
SEC	TWP	RGE	COUNTY
Spot Location			
1/4	1/4	1/4	1/4
Depth of Deviation		Radius of Turn	Direction
Measured Total Depth		True Vertical Depth	BHL From Lease, Unit, or Property Line:

LATERAL #2			
SEC	TWP	RGE	COUNTY
Spot Location			
1/4	1/4	1/4	1/4
Depth of Deviation		Radius of Turn	Direction
Measured Total Depth		True Vertical Depth	BHL From Lease, Unit, or Property Line:

LATERAL #3			
SEC	TWP	RGE	COUNTY
Spot Location			
1/4	1/4	1/4	1/4
Depth of Deviation		Radius of Turn	Direction
Measured Total Depth		True Vertical Depth	BHL From Lease, Unit, or Property Line: