

Oklahoma Corporation Commission
Oil & Gas Conservation Division
Post Office Box 52000
Oklahoma City, Oklahoma 73152-2000
Rule 165: 10-3-25

Form 1002A

API No.: 35133226730003

Completion Report

Spud Date: April 03, 1984

OTC Prod. Unit No.:

Drilling Finished Date: April 13, 1984

Amended

1st Prod Date:

Amend Reason: CHANGE WELL STATUS TO DRY

Completion Date: June 14, 1984

Recomplete Date: June 15, 2021

Drill Type: STRAIGHT HOLE

Well Name: MCDANIEL (HUSKER 1) 22-1

Purchaser/Measurer:

Location: SEMINOLE 22 10N 6E
C SE SW NW
330 FSL 990 FWL of 1/4 SEC
Derrick Elevation: 0 Ground Elevation: 930

First Sales Date:

Operator: MARSH OIL & GAS COMPANY 7818
PO BOX 726
111 E PAUL AVE
PAULS VALLEY, OK 73075-0726

Completion Type		Location Exception		Increased Density	
	Single Zone	Order No		Order No	
	Multiple Zone	There are no Location Exception records to display.		There are no Increased Density records to display.	
	Commingled				

Casing and Cement							
Type	Size	Weight	Grade	Feet	PSI	SAX	Top of CMT
SURFACE	8 5/8			182		25	SURFACE
PRODUCTION	4 1/2			4345		275	3410

Liner								
Type	Size	Weight	Grade	Length	PSI	SAX	Top Depth	Bottom Depth
There are no Liner records to display.								

Total Depth: 4345

Packer		Plug	
Depth	Brand & Type	Depth	Plug Type
There are no Packer records to display.		4000	COMPOSITE 4 1/2

Initial Test Data										
Test Date	Formation	Oil BBL/Day	Oil-Gravity (API)	Gas MCF/Day	Gas-Oil Ratio Cu FT/BBL	Water BBL/Day	Pumpin or Flowing	Initial Shut-In Pressure	Choke Size	Flow Tubing Pressure
There are no Initial Data records to display.										

Completion and Test Data by Producing Formation

Formation Name: HUNTON

Code: 269HNTN

Class: DRY

Spacing Orders**Order No****Unit Size**

There are no Spacing Order records to display.

Perforated Intervals**From****To**

4307

4313

Acid Volumes

There are no Acid Volume records to display.

Fracture Treatments

There are no Fracture Treatments records to display.

Formation	Top
GILCREASE	3818
HUNTON	4307

Were open hole logs run? No

Date last log run:

Were unusual drilling circumstances encountered? No

Explanation:

Other Remarks

SQUEEZED OLD GILCREASE PERFORATIONS (3,818' - 3,831') IN JUNE 1995 TO RECOMPLETE AS A NON-COMMERCIAL SALT WATER DISPOSAL UNDER ORDER NUMBER 398257. CASING WAS ALSO SQUEEZED AT 1,400' (UNKNOWN SACKS) BRINGING CEMENT UP TO 410'. THEN SQUEEZED WITH 185 SACKS AT 406' LIFTING CEMENT TO SURFACE, SUPPORTED BY CEMENT BOND LOG. MAY, 2021 - COMPOSITE BRIDGE PLUG SET ABOVE HUNTON ZONE AT 4,000'. OCC - TERMINATED AS DISPOSAL JUNE 15, 2021 BY FORM 1072.

FOR COMMISSION USE ONLY

1146854

Status: Accepted

API NO. 35-133-22873
OTC PROD.
UNIT NO.

Oil and Gas Conservation Division
P.O. Box 52000
Oklahoma City, OK 73152-2000
405-621-2331
OCCCentralProcessing@OCC.OK.GOV



OKLAHOMA
Corporation
Commission

RECEIVED

Rev. 2020

SEP 02 2021

☒ ORIGINAL
☐ AMENDED (Reason)

change well status to Temporary Abandoned

Rule 185-10-3-25

TYPE OF DRILLING OPERATION

☒ STRAIGHT HOLE ☐ DIRECTIONAL HOLE ☐ HORIZONTAL HOLE
SERVICE WELL

If directional or horizontal, see reverse for bottom hole location.

COUNTY SEMINOLE SEC 22 TWP 10N RGE 6E
LEASE NAME MCDANIEL (HUSKER) WELL NO. 22-1
C 1/4 SE 1/4 SW 1/4 NW 1/4 330FSL 980FWL
ELEVATION 930 Ground 930 Latitude Longitude
OPERATOR MARSH OIL AND GAS OTC/OCC OPERATOR NO. 7818
ADDRESS PO BOX 726
CITY PAULS VALLEY STATE OK ZIP 73075

COMPLETION REPORT

SPUD DATE 4-3-1984

DRILL FINISHED DATE 4-13-1984

DATE OF WELL COMPLETION 6-14-1984

1st PROD DATE

RECOMP DATE 5/2021

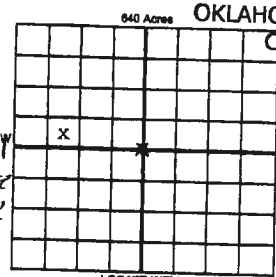

OKLAHOMA CORPORATION
COMMISSION

LOCATE WELL

COMPLETION TYPE

☒ SINGLE ZONE
☐ MULTIPLE ZONE
Application Data
☐ COMMINGLED
Application Data
LOCATION EXCEPTION
ORDER NO.
MULTIUNIT ORDER NO.
INCREASED DENSITY
ORDER NO.

CASING & CEMENT (Attach Form 1092C)

TYPE	SIZE	WEIGHT	GRADE	FEET	PSI	SAX	TOP OF CMT
CONDUCTOR							
SURFACE	8 5/8		182			25	SURFACE
INTERMEDIATE							
PRODUCTION	4 1/2		4345			275	3410
LINER							

PACKER @ BRAND & TYPE

PACKER @ BRAND & TYPE

PLUG @

4000

TYPE COMPRESS A 1/2

PLUG @

TYPE

TOTAL

DEPTH 4345

COMPLETION & TEST DATA BY PRODUCING FORMATION

FORMATION	HUNTON	GILCREASE					
SPACING & SPACING ORDER NUMBER	below plug						
CLASS: Oil, Gas, Dry, Inj, Disp, Comm Disp, Svo	Disp Dry	Dry					
PERFORATED INTERVALS	4307-4313	3818-3821					
ACID/VOLUME							
FRACTURE TREATMENT (Fluids/Prop Amounts)							

Min Gas Allowable (185-10-17-7)

OR

Oil Allowable (185-10-13-3)

Purchaser/Measure

First Sales Date

INITIAL TEST DATA

INITIAL TEST DATE							
OIL-BBL/DAY							
OIL-GRAVITY (API)							
GAS-MCF/DAY							
GAS-OIL RATIO CU FT/BBL							
WATER-BBL/DAY							
PUMPING OR FLOWING							
INITIAL SHUT-IN PRESSURE							
CHOKE SIZE							
FLOW TUBING PRESSURE							

A record of the formation drilled through, and pertinent remarks are presented on the reverse. I declare that I have knowledge of the contents of this report and am authorized by my organization to make this report, which was prepared by me or under my supervision and direction, with the data and facts stated herein to be true, correct, and complete to the best of my knowledge and belief.

Susan Marsh Agee
P O Box 726 Pauls Valley OK 73075
ADDRESS CITY STATE ZIP
DATE 8/20/2021 PHONE NUMBER 405-343-8610
EMAIL ADDRESS sageemarshoil@att.net

PLEASE TYPE OR USE BLACK INK ONLY

FORMATION RECORD

Give formation names and tops, if available, or descriptions and thickness of formations drilled through. Show intervals cored or driftestem tested.

LEASE NAME

MCDANIEL (HUSKER)

WELL NO.

22-1

NAMES OF FORMATIONS	TOP
Gilcrease	3818
Hunton	4307

FOR COMMISSION USE ONLY	
ITD on file <input type="checkbox"/> YES <input type="checkbox"/> NO	
APPROVED <input type="checkbox"/> DISAPPROVED <input type="checkbox"/>	2) Reject Codes

Were open hole logs run?	<input type="radio"/> yes <input checked="" type="radio"/> no
Date last log was run	
Was CO ₂ encountered?	<input type="radio"/> yes <input checked="" type="radio"/> no at what depths?
Was H ₂ S encountered?	<input type="radio"/> yes <input checked="" type="radio"/> no at what depths?
Were unusual drilling circumstances encountered?	<input type="radio"/> yes <input checked="" type="radio"/> no
If yes, briefly explain below.	

Other remarks: squeezed Old Gilcrease perfs (3818-3821) in 6/1995 to recompleat as a non-commercial SWD under order 398257

Casing was also squeezed at 1400 feet (unknown sacks) bringing cement up to 410 feet. Then squeezed with 185 sacks at 406 feet lifting cement to surface, supported by cement bond log.

5/21-Composite bridge plug set above Hunton zone at 4000'

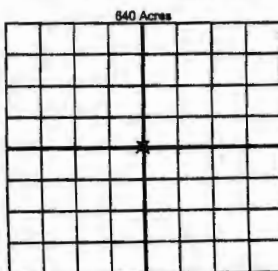
DCC - Terminated as Disposal 6-15-2021 by 1072

If more than three drainholes are proposed, attach a separate sheet indicating the necessary information.

Direction must be stated in degree azimuth. Please note, the horizontal drainhole and its end point must be located within the boundaries of the lease or spacing unit.

Directional surveys are required for all drainholes and directional wells.

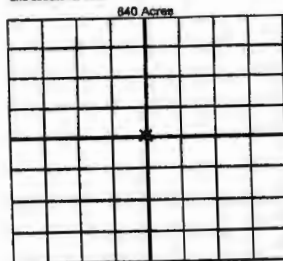

BOTTOM HOLE LOCATION FOR DIRECTIONAL HOLE

SEC	TWP	RGE	COUNTY
1/4	1/4	1/4	1/4
Measured Total Depth	True Vertical Depth	Feet From 1/4 Sec Lines	
BHL From Lease, Unit, or Property Line:			

BOTTOM HOLE LOCATION FOR HORIZONTAL HOLE: (LATERALS)

LATERAL #1			
SEC	TWP	RGE	COUNTY
1/4	1/4	1/4	1/4
Depth of Deviation	Radius of Turn	Direction	Total Length
Measured Total Depth	True Vertical Depth	BHL From Lease, Unit, or Property Line:	

LATERAL #2			
SEC	TWP	RGE	COUNTY
1/4	1/4	1/4	1/4
Depth of Deviation	Radius of Turn	Direction	Total Length
Measured Total Depth	True Vertical Depth	BHL From Lease, Unit, or Property Line:	

LATERAL #3			
SEC	TWP	RGE	COUNTY
1/4	1/4	1/4	1/4
Depth of Deviation	Radius of Turn	Direction	Total Length
Measured Total Depth	True Vertical Depth	BHL From Lease, Unit, or Property Line:	