

Oklahoma Corporation Commission
Oil & Gas Conservation Division
Post Office Box 52000
Oklahoma City, Oklahoma 73152-2000
Rule 165: 10-3-25

Form 1002A

API No.: 35121248030001

Completion Report

Spud Date: January 24, 2018

OTC Prod. Unit No.: 121-224009-0-0000

Drilling Finished Date: July 01, 2018

1st Prod Date: August 15, 2018

Completion Date: August 02, 2018

Amended

Amend Reason: TO CORRECT PERFORATIONS / SURFACE FOOTAGE FWL

Drill Type: HORIZONTAL HOLE

Min Gas Allowable: Yes

Well Name: FORD 0718 6H-15

Purchaser/Measurer: CLEARWATER ENT LLC

Location: PITTSBURG 14 7N 18E
SE NW NW NW
355 FNL 525 FWL of 1/4 SEC
Latitude: 35.086327 Longitude: -95.382699
Derrick Elevation: 714 Ground Elevation: 696

First Sales Date: 08/20/2018

Operator: RED MOUNTAIN OPERATING LLC 23694

5901 N WESTERN AVE
OKLAHOMA CITY, OK 73118-1253

Completion Type		Location Exception		Increased Density	
X	Single Zone	Order No		Order No	
	Multiple Zone	669798		There are no Increased Density records to display.	
	Commingled				

Casing and Cement							
Type	Size	Weight	Grade	Feet	PSI	SAX	Top of CMT
SURFACE	13 3/8	48	J-55	338	600	340	SURFACE
INTERMEDIATE	9 5/8	40	J-55	2739	1200	540	SURFACE
PRODUCTION	5 1/2	23	P-110	15447		2660	5736

Liner								
Type	Size	Weight	Grade	Length	PSI	SAX	Top Depth	Bottom Depth
There are no Liner records to display.								

Total Depth: 15540

Packer	
Depth	Brand & Type
There are no Packer records to display.	

Plug	
Depth	Plug Type
There are no Plug records to display.	

Initial Test Data

Test Date	Formation	Oil BBL/Day	Oil-Gravity (API)	Gas MCF/Day	Gas-Oil Ratio Cu FT/BBL	Water BBL/Day	Pumpin or Flowing	Initial Shut-In Pressure	Choke Size	Flow Tubing Pressure
Sep 13, 2018	WOODFORD			2450		1530	FLOWING	700	60/64	500

Completion and Test Data by Producing Formation

Formation Name: WOODFORD

Code: 319WDFD

Class: GAS

Spacing Orders

Order No	Unit Size
665592	640
670890	MULTIUNIT

Perforated Intervals

From	To
8500	15347

Acid Volumes

33,427 GALLONS 35.25%

Fracture Treatments

10,564,766 POUNDS SAND, 265,206 BARRELS FLUID

Formation	Top
BOOCH	1381
HARTSHORNE	1986
BASE HARTSHORNE	2380
ATOKA	2480
SPIRO	6640
WAPANUCKA	6662
CROMWELL	7152
CANEY	7379
LOWER CANEY MARKER	7684
MAYES	7794
WOODFORD	7894
HUNTON	7976

Were open hole logs run? No

Date last log run:

Were unusual drilling circumstances encountered? No

Explanation:

Other Remarks

OCC - THIS DOCUMENT IS ACCEPTED BASED ON THE DATA SUBMITTED NEITHER THE FINAL LOCATION EXCEPTION NOR THE FINAL MULTIUNIT ORDERS HAVE BEEN ISSUED.

Lateral Holes

Sec: 22 TWP: 7N RGE: 18E County: PITTSBURG

SE SW SE NE

2618 FNL 847 FEL of 1/4 SEC

Depth of Deviation: 7626 Radius of Turn: 329 Direction: 176 Total Length: 7394

Measured Total Depth: 15540 True Vertical Depth: 7955 End Pt. Location From Release, Unit or Property Line: 847

FOR COMMISSION USE ONLY

Status: Accepted

 SIGNATURE		Tim Cummings NAME (PRINT OR TYPE)		6/16/2020 DATE	405-842-4500 PHONE NUMBER
5901 N. Western ADDRESS		Oklahoma City CITY	OK 73118 STATE ZIP	tcummings@redmountainenergy.net EMAIL ADDRESS	

PLEASE TYPE OR USE BLACK INK ONLY

FORMATION RECORD

Give formation names and tops, if available, or descriptions and thickness of formations drilled through. Show intervals cored or drillstem tested.

LEASE NAME FORD 0718

WELL NO. 6H-15

NAMES OF FORMATIONS	TOP
BOOCH	1,381
HARTSHORNE	1,986
BASE HARTSHORNE	2,380
ATOKA	2,480
SPIRO	6,640
WAPANUCKA	6,662
CROMWELL	7,152
CANEY	7,379
L CANEY MARKER	7,684
MAYES	7,794
WOODFORD	7,894
HUNTON	7,976

FOR COMMISSION USE ONLY

ITD on file ☐ YES ☐ NO

APPROVED _____ DISAPPROVED _____

2) Reject Codes _____

Were open hole logs run? _____ yes ☒ no

Date Last log was run _____

Was CO₂ encountered? _____ yes ☒ no at what depths? _____

Was H₂S encountered? _____ yes ☒ no at what depths? _____

Were unusual drilling circumstances encountered? _____ yes ☒ no

If yes, briefly explain below _____

Other remarks: _____

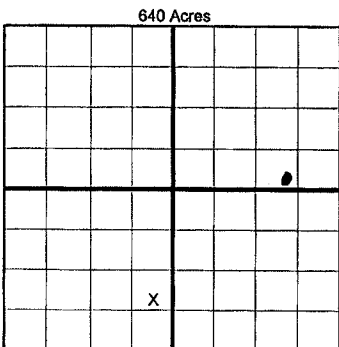

If more than three drainholes are proposed, attach a separate sheet indicating the necessary information.

Direction must be stated in degrees azimuth. Please note, the horizontal drainhole and its end point must be located within the boundaries of the lease or spacing unit.

Directional surveys are required for all drainholes and directional wells.

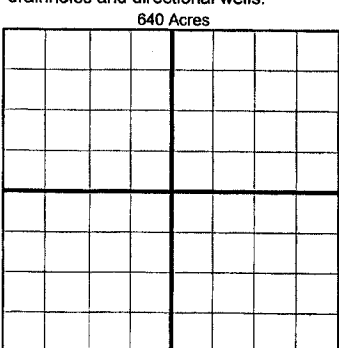

BOTTOM HOLE LOCATION FOR DIRECTIONAL HOLE

SEC	TWP	RGE	COUNTY
Spot Location	1/4	SE 1/4	1/4
Measured Total Depth	True Vertical Depth	BHL From Lease, Unit, or Property Line:	

BOTTOM HOLE LOCATION FOR HORIZONTAL HOLE: (LATERALS)

LATERAL #1

SEC	TWP	RGE	COUNTY
22	7N	18E	PITTSBURG
Spot Location	SE 1/4	SW 1/4	NE 1/4
Depth of Deviation	7,626	Radius of Turn	329
Measured Total Depth	15,540	True Vertical Depth	7,955
		Direction	176 SOUTH
		Total Length	7394
		BHL From Lease, Unit, or Property Line:	847

LATERAL #2

SEC	TWP	RGE	COUNTY
Spot Location	1/4	1/4	1/4
Depth of Deviation	Radius of Turn	Direction	Total Length
Measured Total Depth	True Vertical Depth	BHL From Lease, Unit, or Property Line:	

LATERAL #3

SEC	TWP	RGE	COUNTY
Spot Location	1/4	1/4	1/4
Depth of Deviation	Radius of Turn	Direction	Total Length
Measured Total Depth	True Vertical Depth	BHL From Lease, Unit, or Property Line:	

12/1/18

API NO. 121-24803
OTC PROD. 121-224009
UNIT NO.PLEASE TYPE OR USE BLACK INK ONLY
NOTE:Attach copy of original 1002A
if recompletion or reentry.

OKLAHOMA CORPORATION COMMISSION

Oil & Gas Conservation Division
Post Office Box 52000
Oklahoma City, Oklahoma 73152-2000
Rule 165:10-3-25

RECEIVED

Form 1002A
Rev. 2009

NOV 06 2018

OKLAHOMA CORPORATION
COMMISSION☒ ORIGINAL
☐ AMENDED (Reason)

TYPE OF DRILLING OPERATION

☐ STRAIGHT HOLE ☐ DIRECTIONAL HOLE ☒ HORIZONTAL HOLE
SERVICE WELL

If directional or horizontal, see reverse for bottom hole location.

COUNTY	Pittsburg	SEC	14	TWP	07N	RGE	18E
LEASE NAME	FORD 0718			WELL NO.	6H-15		
SE 1/4 NW 1/4 NW 1/4 NW 1/4	FNL OF 1/4 SEC	355	1/4 SEC	FWL-540	1st PROD DATE	8/15/18	
ELEVATION Demick FL	714	Ground	696	Latitude (if known)	35.086327	Longitude (if known)	-95.382699
OPERATOR NAME	Red Mountain Operating LLC			OTC/OCC OPERATOR NO.	23694		
ADDRESS	5901 N. Western, Suite 200						
CITY	Oklahoma City	STATE	OK	ZIP	73116		

COMPLETION REPORT

SPUD DATE	01/24/2018
DRLG FINISHED DATE	7/1/18
DATE OF WELL COMPLETION	8/2/18
RECOMP DATE	

X				

LOCATE WELL

COMPLETION TYPE

<input checked="" type="checkbox"/> SINGLE ZONE	
<input type="checkbox"/> MULTIPLE ZONE	
Application Date	
COMMINGLED	
Application Date	
LOCATION	669798 I.O.
EXCEPTION ORDER	
INCREASED DENSITY ORDER NO.	

CASING & CEMENT (Form 1002C must be attached)

TYPE	SIZE	WEIGHT	GRADE	FEET	PSI	SAX	TOP OF CMT
CONDUCTOR							
SURFACE	13 3/8	48#	J-55	338	600	340	SURF
INTERMEDIATE	9 5/8	40#	J-55	2,739	1200	540	SURF
PRODUCTION	5 1/2	23#	P-110	15,447	NA	2000	SURF 5736
LINER							
TOTAL DEPTH							15,540

 PACKER @ NA BRAND & TYPE PLUG @ TYPE PLUG @ TYPE
 PACKER @ NA BRAND & TYPE PLUG @ TYPE PLUG @ TYPE

COMPLETION & TEST DATA BY PRODUCING FORMATION

FORMATION	WOODFORD	319WDFD
SPACING & SPACING ORDER NUMBER	640 / 665592 (15x22)	670890 (multistage) MUX FO: 713299
CLASS: Oil, Gas, Dry, Inj, Disp, Comm Disp, Svc	DRY GAS (15x22)	Multistage:
PERFORATED INTERVALS	8535 - 15159	Sec. 14 (SL): -0-
ACID/VOLUME	33,427 gals 35.25%	Sec. 15: 64.4516 % 224009 I
FRACTURE TREATMENT (Fluids/Prop Amounts)	10,564,766# SD	Sec. 22: 35.5484 % 224009A I
	265,206 BBL FLUID	

Reported
to Frac Focus
 Min Gas Allowable (165:10-17-7) Gas Purchaser/Measurer CLEARWATER ENT. LLC
 OR Oil Allowable (165:10-13-3) First Sales Date 8/20/2018

INITIAL TEST DATA

INITIAL TEST DATE	9/13/2018
OIL-BBL/DAY	0
OIL-GRAVITY (API)	NA
GAS-MCF/DAY	2450
GAS-OIL RATIO CU FT/BBL	NA
WATER-BBL/DAY	1530
PUMPING OR FLOWING	FLOWING
INITIAL SHUT-IN PRESSURE	700#
CHOKE SIZE	60/64
FLOW TUBING PRESSURE	500

AS SUBMITTED

A record of the formations drilled through, and pertinent remarks are presented on the reverse. I declare that I have knowledge of the contents of this report and am authorized by my organization to make this report, which was prepared by me or under my supervision and direction, with the data and facts stated herein to be true, correct, and complete to the best of my knowledge and belief.

 Tim Cummings 10/2/2018 405-842-4500
 SIGNATURE NAME (PRINT OR TYPE) DATE PHONE NUMBER
 5901 N. Western Oklahoma City OK 73116 tcummings@redmountainenergy.net
 ADDRESS CITY STATE ZIP EMAIL ADDRESS

SCANNED

PLEASE TYPE OR USE BLACK INK ONLY

FORMATION RECORD

Give formation names and tops, if available, or descriptions and thickness of formations drilled through. Show intervals cored or drillstem tested.

LEASE NAME

FORD 0718

WELL NO. 6H-15

NAMES OF FORMATIONS	TOP
BOOCH	1,381
HARTSHORNE	1,986
BASE HARTSHORNE	2,380
ATOKA	2,480
SPIRO	6,640
WAPANUCKA	6,662
CROMWELL	7,152
CANEY	7,379
L CANEY MARKER	7,684
MAYES	7,794
WOODFORD	7,894
HUNTON	7,976

FOR COMMISSION USE ONLY

ITD on file

☐ YES☐ NO

APPROVED

DISAPPROVED

2) Reject Codes

Were open hole logs run?

☐ yes ☒ no

Date Last log was run

Was CO₂ encountered?☐ yes ☒ no at what depths?Was H₂S encountered?☐ yes ☒ no at what depths?

Were unusual drilling circumstances encountered?

☐ yes ☒ no

If yes, briefly explain below

Other remarks:

640 Acres

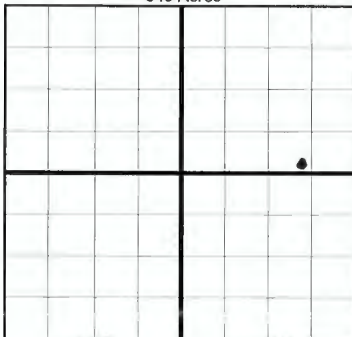

If more than three drainholes are proposed, attach a separate sheet indicating the necessary information.

Direction must be stated in degrees azimuth.
Please note, the horizontal drainhole and its end point must be located within the boundaries of the lease or spacing unit.

Directional surveys are required for all drainholes and directional wells.

640 Acres

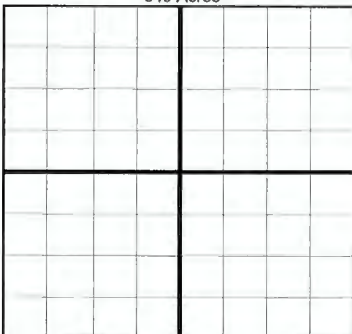

BOTTOM HOLE LOCATION FOR DIRECTIONAL HOLE

SEC	TWP	RGE	COUNTY
Spot Location	1/4	1/4	SE 1/4 1/4
Measured Total Depth	True Vertical Depth		Feet From 1/4 Sec Lines FSL FWL BHL From Lease, Unit, or Property Line:

BOTTOM HOLE LOCATION FOR HORIZONTAL HOLE: (LATERALS)

LATERAL #1

SEC	TWP	RGE	COUNTY
22	7N	18E	PITTSBURG
Spot Location	SE 1/4	SW 1/4	SE 1/4 NE 1/4
Depth of Deviation	7,626	Radius of Turn	Direction SOUTH
Measured Total Depth	15,540	True Vertical Depth	7,955
		BHL From Lease, Unit, or Property Line:	

FNL 2618

FEL 833

FSL 22

FWL 1807

22 833

LATERAL #2

SEC	TWP	RGE	COUNTY
Spot Location	1/4	1/4	1/4 1/4
Depth of Deviation	Radius of Turn		Direction
Measured Total Depth	True Vertical Depth		Total Length
		BHL From Lease, Unit, or Property Line:	

LATERAL #3

SEC	TWP	RGE	COUNTY
Spot Location	1/4	1/4	1/4
Depth of Deviation	Radius of Turn		Direction
Measured Total Depth	True Vertical Depth		Total Length
		BHL From Lease, Unit, or Property Line:	