

Oklahoma Corporation Commission
Oil & Gas Conservation Division
Post Office Box 52000
Oklahoma City, Oklahoma 73152-2000
Rule 165: 10-3-25

Form 1002A

API No.: 35121248360001

Completion Report

Spud Date: December 29, 2018

OTC Prod. Unit No.: 121-225291-0-0000

Drilling Finished Date: February 14, 2019

Amended

1st Prod Date: April 22, 2019

Amend Reason: TO CORRECT PERFORATIONS

Completion Date: March 28, 2019

Drill Type: HORIZONTAL HOLE

Min Gas Allowable: Yes

Well Name: SATTERFIELD 3H-28

Purchaser/Measurer: CLEARWATER ENT LLC

Location: PITTSBURG 28 8N 18E
SE NE SW NW
1929 FNL 1094 FWL of 1/4 SEC
Latitude: 35.1404162 Longitude: -95.4164435
Derrick Elevation: 0 Ground Elevation: 1020

First Sales Date: 04/22/2019

Operator: RED MOUNTAIN OPERATING LLC 23694

5901 N WESTERN AVE
OKLAHOMA CITY, OK 73118-1253

Completion Type	
X	Single Zone
	Multiple Zone
	Commingled

Location Exception
Order No
710136

Increased Density
Order No
686661

Casing and Cement							
Type	Size	Weight	Grade	Feet	PSI	SAX	Top of CMT
SURFACE	13 3/8	48	J-55	347	650	360	SURFACE
INTERMEDIATE	9 5/8	40	J-55	3125	800	520	63
PRODUCTION	5 1/2	20	P-110	14949	1800	2085	SURFACE

Liner								
Type	Size	Weight	Grade	Length	PSI	SAX	Top Depth	Bottom Depth
There are no Liner records to display.								

Total Depth: 15073

Packer	
Depth	Brand & Type
There are no Packer records to display.	

Plug	
Depth	Plug Type
There are no Plug records to display.	

Initial Test Data

Test Date	Formation	Oil BBL/Day	Oil-Gravity (API)	Gas MCF/Day	Gas-Oil Ratio Cu FT/BBL	Water BBL/Day	Pumpin or Flowing	Initial Shut-In Pressure	Choke Size	Flow Tubing Pressure
May 05, 2019	WOODFORD			1100		2100	FLOWING	600	64/64	300

Completion and Test Data by Producing Formation

Formation Name: WOODFORD

Code: 319WDFD

Class: GAS

Spacing Orders

Order No	Unit Size
679486	640
685312	640
689030	640 NPT
710135	MULTIUNIT

Perforated Intervals

From	To
8276	14873

Acid Volumes

105,843 GALLONS

Fracture Treatments

7,270,260 POUNDS SAND, 348,767 BARRELS FLUID
--

Formation	Top
MISSISSIPPIAN	7199
MAYES	7511
WOODFORD	7651
HUNTON	7713

Were open hole logs run? No

Date last log run:

Were unusual drilling circumstances encountered? No

Explanation:

Other Remarks

There are no Other Remarks.

Lateral Holes

Sec: 21 TWP: 8N RGE: 18E County: PITTSBURG

NE SE NE NW

984 FNL 2634 FWL of 1/4 SEC

Depth of Deviation: 7100 Radius of Turn: 303 Direction: 358 Total Length: 7497

Measured Total Depth: 15073 True Vertical Depth: 7403 End Pt. Location From Release, Unit or Property Line: 984

FOR COMMISSION USE ONLY

1145401

Status: Accepted

API NO. 121-24836
OTC PROD. UNIT NO. 121-225291

(PLEASE TYPE OR USE BLACK INK ONLY)

OKLAHOMA CORPORATION COMMISSION
Oil & Gas Conservation Division
Post Office Box 52000
Oklahoma City, Oklahoma 73152-2000
Rule 165:10-3-25

Form 1002A
Rev. 2009

☐ ORIGINAL
☒ AMENDED (Reason)

To Correct Perfs

COMPLETION REPORT

TYPE OF DRILLING OPERATION

☐ STRAIGHT HOLE ☐ DIRECTIONAL HOLE ☒ HORIZONTAL HOLE
☐ SERVICE WELL

If directional or horizontal, see reverse for bottom hole location.

COUNTY	Pittsburg	SEC	28	TWP	08N	RGE	18E	SPUD DATE	12/28/2019
LEASE NAME	Satterfield			FNL 1929	WELL NO.	3H-28		DRLG FINISHED DATE	2/14/2019
SE 1/4 NE 1/4 SW 1/4 NW 1/4	FBL OF 1/4 SEC 1934			FWL OF 1/4 SEC	1094		DATE OF WELL COMPLETION	03/28/2019	
ELEVATION Derrick FL	Ground	1020	Latitude (if known)	35.1404162		Longitude (if known)	-95.4164435		
OPERATOR NAME	Red Mountain Operating LLC				OTC / OCC OPERATOR NO.	23694			
ADDRESS	5901 N Western, Suite 200								
CITY	Oklahoma City	STATE	OK	ZIP	73118				

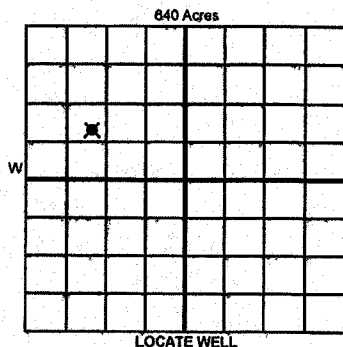

COMPLETION TYPE

<input checked="" type="checkbox"/> SINGLE ZONE	
<input type="checkbox"/> MULTIPLE ZONE	
Application Date	
<input type="checkbox"/> COMINGLED	
Application Date	
LOCATION EXCEPTION ORDER NO.	710136 F.O.
INCREASED DENSITY ORDER NO.	688517
	686661

CASING & CEMENT (Attach Form 1002C)

TYPE	SIZE	WEIGHT	GRADE	FEET	PSI	SAX	TOP OF CMT
CONDUCTOR							
SURFACE	13 3/8"	48#	J-55	347	650	360	Surface
INTERMEDIATE	9 5/8"	40#	J-55	3,125	800	520	3,062-63
PRODUCTION	5 1/2"	20#	P110	14,949	1800	2085	Surface
LINER							
						TOTAL DEPTH	15,073

PACKER @ _____ BRAND & TYPE _____ PLUG @ _____ TYPE _____ PLUG @ _____ TYPE _____
PACKER @ _____ BRAND & TYPE _____ PLUG @ _____ TYPE _____ PLUG @ _____ TYPE _____

COMPLETION & TEST DATA BY PRODUCING FORMATION

FORMATION	Woodford						
SPACING & SPACING ORDER NUMBER	640 / 685312	679486 (WFO)	689030 (WFO/NPT)	710135 F.O.	688316 (Multifrac)	Reported to Frac Focus	
CLASS: Oil, Gas, Dry, Inj, Disp, Comm Disp, Svc	GAS						
PERFORATED INTERVALS	8276 - 14873						
ACID/VOLUME	105,843 GAL						
FRACTURE TREATMENT (Fluids/Prop Amounts)	7,270,260# SD						
	348,767 BBL FLUID						

RECEIVED

JUN 29 2020

Oklahoma Corporation
Commission

☒

Min Gas Allowable (165:10-17-7)

Gas Purchaser/Measurer

Clearwater Ent LLC

OR
Oil Allowable (165:10-13-3)

First Sales Date

4/22/2019

INITIAL TEST DATA

INITIAL TEST DATE	5/5/2019						
OIL-BBL/DAY	0						
OIL-GRAVITY (API)							
GAS-MCF/DAY	1100						
GAS-OIL RATIO CU FT/BBL							
WATER-BBL/DAY	2100						
PUMPING OR FLOWING	Flowing						
INITIAL SHUT-IN PRESSURE	600						
CHOKE SIZE	64/64"						
FLOW TUBING PRESSURE	300						

A record of the formations drilled through, and pertinent remarks are presented on the reverse. I declare that I have knowledge of the contents of this report and am authorized by my organization to make this report, which was prepared by me or under my supervision and direction, with the data and facts stated herein to be true, correct, and complete to the best of my knowledge and belief.

Tim Cummings

6/15/2020 (405) 842-4500

SIGNATURE

NAME (PRINT OR TYPE)

DATE PHONE NUMBER

5901 N Western Ave Suite 200

Oklahoma City OK 73118

tcummings@redmountainenergy.net

ADDRESS

CITY STATE ZIP

EMAIL ADDRESS

PLEASE TYPE OR USE BLACK INK ONLY
FORMATION RECORD

Give formation names and tops, if available, or descriptions and thickness of formations drilled through. Show intervals cored or drillstem tested.

NAMES OF FORMATIONS	TOP
MISSISSIPPIAN	7,199
MAYES	7,511
WOODFORD	7,651
HUNTON	7,713

LEASE NAME Satterfield WELL NO. 3H-28

FOR COMMISSION USE ONLY	
ITD on file <input type="checkbox"/> YES <input type="checkbox"/> NO	
APPROVED _____	DISAPPROVED _____
2) Reject Codes	

Were open hole logs run?	yes	<input checked="" type="checkbox"/> no
Date Last log was run	_____	
Was CO ₂ encountered?	yes	<input checked="" type="checkbox"/> no at what depths? _____
Was H ₂ S encountered?	yes	<input checked="" type="checkbox"/> no at what depths? _____
Were unusual drilling circumstances encountered?	yes	<input checked="" type="checkbox"/> no
If yes, briefly explain below		

Other remarks:

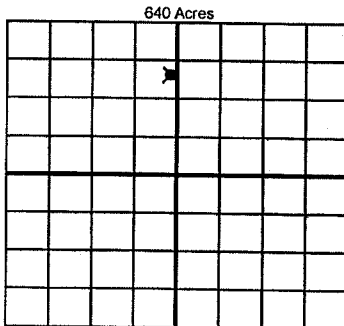

If more than three drainholes are proposed, attach a separate sheet indicating the necessary information.

Direction must be stated in degrees azimuth. Please note, the horizontal drainhole and its end point must be located within the boundaries of the lease or spacing unit.

Directional surveys are required for all drainholes and directional wells.

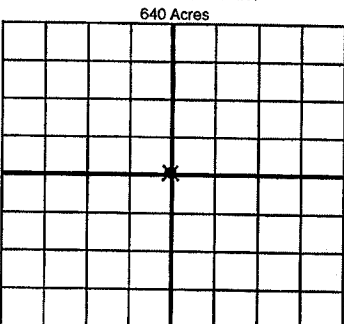

BOTTOM HOLE LOCATION FOR DIRECTIONAL HOLE

SEC	TWP	RGE	COUNTY
Spot Location	1/4	1/4	1/4
Measured Total Depth	True Vertical Depth	BHL From Lease, Unit, or Property Line:	FSL
			FWL

BOTTOM HOLE LOCATION FOR HORIZONTAL HOLE: (LATERALS)

LATERAL #1			
SEC	TWP	RGE	COUNTY
21	08N	18E	Pittsburg
Spot Location	NE 1/4	SE 1/4	NW 1/4
Depth of Deviation	71007.634	Radius of Turn	303
Measured Total Depth	15,073	True Vertical Depth	7,403
		BHL From Lease, Unit, or Property Line:	984
		FSL	984 fml
		Total Length	7497.700
		FWL	2634

LATERAL #2			
SEC	TWP	RGE	COUNTY
Spot Location	1/4	1/4	1/4
Depth of Deviation		Radius of Turn	
Measured Total Depth		True Vertical Depth	
		BHL From Lease, Unit, or Property Line:	
		FSL	
		Total Length	
		FWL	

LATERAL #3			
SEC	TWP	RGE	COUNTY
Spot Location	1/4	1/4	1/4
Depth of Deviation		Radius of Turn	
Measured Total Depth		True Vertical Depth	
		BHL From Lease, Unit, or Property Line:	
		FSL	
		Total Length	
		FWL	

API NO. 121-24836
OTC PROD. UNIT NO. 121-225291

(PLEASE TYPE OR USE BLACK INK ONLY)

OKLAHOMA CORPORATION COMMISSION
Oil & Gas Conservation Division
Post Office Box 52000
Oklahoma City, Oklahoma 73152-2000
Rule 165:10-3-25

Form 1002A
Rev. 2009

1002A
Addendum

ORIGINAL
AMENDED (Reason)

To Correct Perfs

COMPLETION REPORT

TYPE OF DRILLING OPERATION

☐ STRAIGHT HOLE ☐ DIRECTIONAL HOLE ☒ HORIZONTAL HOLE
☐ SERVICE WELL

If directional or horizontal, see reverse for bottom hole location.

COUNTY Pittsburg SEC 28 TWP 08N RGE 18E

LEASE NAME Satterfield FUL 1929 WELL NO. 3H-28

SE 1/4 NE 1/4 SW 1/4 NW 1/4 FUL OF 1/4 SEC 1934 FWL OF 1/4 SEC 1094

ELEVATION Derrick FL Ground 1020 Latitude (if known) 35.1404162 Longitude (if known) -95.4164435

OPERATOR NAME Red Mountain Operating LLC OTC / OCC OPERATOR NO. 23694

ADDRESS 5901 N Western, Suite 200

CITY Oklahoma City STATE OK ZIP 73118

SPUD DATE 12/29/2019

DRLG FINISHED DATE 2/14/2019

DATE OF WELL COMPLETION 03/28/2019

1st PROD DATE 4/22/2019

RECOMP DATE

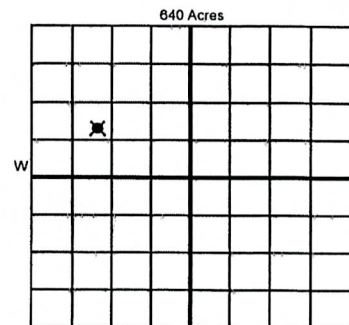

COMPLETION TYPE

☒ SINGLE ZONE
☐ MULTIPLE ZONE
☐ COMMINGLED
LOCATION EXCEPTION ORDER NO. 688317
INCREASED DENSITY ORDER NO. 686661

CASING & CEMENT (Attach Form 1002C)

TYPE	SIZE	WEIGHT	GRADE	FEET	PSI	SAX	TOP OF CMT
CONDUCTOR							
SURFACE	13 3/8"	48#	J-55	347	650	360	Surface
INTERMEDIATE	9 5/8"	40#	J-55	3,125	800	520	3,062-63
PRODUCTION	5 1/2"	20#	P110	14,949	1800	2085	Surface
LINER							
TOTAL DEPTH						15,073	

PACKER @ BRAND & TYPE

PLUG @

TYPE

PLUG @

TYPE

TOTAL DEPTH

PACKER @ BRAND & TYPE

PLUG @

TYPE

PLUG @

TYPE

COMPLETION & TEST DATA BY PRODUCING FORMATION

FORMATION	Woodford						
SPACING & SPACING ORDER NUMBER	640 / 685312	679486 (LWD)	689030 (LWD/NPT)	710135 F.O.	688316 (MULTIUNIT)	Reported to Frac Focus	
CLASS: Oil, Gas, Dry, Inj, Disp, Comm Disp, Svc	GAS						
PERFORATED INTERVALS	8276 - 14873						
ACID/VOLUME	105,843 GAL						
FRACTURE TREATMENT (Fluids/Prop Amounts)	7,270,260# SD						
	348,767 BBL FLUID						

RECEIVED

JUN 29 2020

Oklahoma Corporation
Commission

Min Gas Allowable (165:10-17-7)

Gas Purchaser/Measurer
First Sales Date

Clearwater Ent LLC
4/22/2019

INITIAL TEST DATA

INITIAL TEST DATE	5/5/2019						
OIL-BBL/DAY	0						
OIL-GRAVITY (API)							
GAS-MCF/DAY	1100						
GAS-OIL RATIO CU FT/BBL							
WATER-BBL/DAY	2100						
PUMPING OR FLOWING	Flowing						
INITIAL SHUT-IN PRESSURE	600						
CHOKE SIZE	64/64"						
FLOW TUBING PRESSURE	300						

A record of the formation drilled through, and pertinent remarks are presented on the reverse. I declare that I have knowledge of the contents of this report and am authorized by my organization to make this report, which was prepared by me or under my supervision and direction, with the data and facts stated herein to be true, correct, and complete to the best of my knowledge and belief.

SIGNATURE Tim Cummings DATE 6/15/2020 PHONE NUMBER (405) 842-4500
5901 N Western Ave Suite 200 Oklahoma City OK 73118 tcummings@redmountainenergy.net
ADDRESS CITY STATE ZIP EMAIL ADDRESS

Eff 10/1/19

Oklahoma Corporation Commission
Oil & Gas Conservation Division
Post Office Box 52000
Oklahoma City, Oklahoma 73152-2000
Rule 165: 10-3-25

Form 1002A
1002A Addendum

API No.: 35121248360001

Completion Report

Spud Date: December 29, 2018

OTC Prod. Unit No.: 121-225291-0-0000 -

Drilling Finished Date: February 14, 2019

Amended

1st Prod Date: April 22, 2019

Amend Reason: TO CORRECT PERFORATIONS

Completion Date: March 28, 2019

Drill Type: HORIZONTAL HOLE

Min Gas Allowable: Yes

Well Name: SATTERFIELD 3H-28

Purchaser/Measurer: CLEARWATER ENT LLC

Location: PITTSBURG 28 8N 18E
SE NE SW NW
1929 FNL 1094 FWL of 1/4 SEC
Latitude: 35.1404162 Longitude: -95.4164435
Derrick Elevation: 0 Ground Elevation: 1020

First Sales Date: 04/22/2019

Multunit:

Sec 28: 37.80506% 225291 I

Sec 21: 62.19494% 225291A I

Operator: RED MOUNTAIN OPERATING LLC 23694

5901 N WESTERN AVE
OKLAHOMA CITY, OK 73118-1253

Completion Type	
X	Single Zone
	Multiple Zone
	Commingled

Location Exception	
Order No	
710136	

Increased Density	
Order No	
686661	

MUFO: 710135

Casing and Cement							
Type	Size	Weight	Grade	Feet	PSI	SAX	Top of CMT
SURFACE	13 3/8	48	J-55	347	650	360	SURFACE
INTERMEDIATE	9 5/8	40	J-55	3125	800	520	63
PRODUCTION	5 1/2	20	P-110	14949	1800	2085	SURFACE

Liner								
Type	Size	Weight	Grade	Length	PSI	SAX	Top Depth	Bottom Depth
There are no Liner records to display.								

Total Depth: 15073

Packer	
Depth	Brand & Type
There are no Packer records to display.	

Plug	
Depth	Plug Type
There are no Plug records to display.	

Initial Test Data

5/5/19 319WDFD 600

July 16, 2020

Recvd 9/25/19 (orig)

1 of 2