

Oklahoma Corporation Commission
Oil & Gas Conservation Division
Post Office Box 52000
Oklahoma City, Oklahoma 73152-2000
Rule 165: 10-3-25

Form 1002A

API No.: 35109224660001

Completion Report

Spud Date: May 16, 2019

OTC Prod. Unit No.: 109-226173-0-0000

Drilling Finished Date: May 30, 2019

1st Prod Date: July 24, 2019

Amended

Completion Date: July 24, 2019

Amend Reason: CORRECT SURFACE LOCATION FOOTAGE

Drill Type: DIRECTIONAL HOLE

Min Gas Allowable: Yes

Well Name: DEER CREEK 2

Purchaser/Measurer: OGG, LLC

Location: OKLAHOMA 1 14N 4W
NW SW SE SW
573 FSL 1540 FWL of 1/4 SEC
Derrick Elevation: 1039 Ground Elevation: 1026

First Sales Date: 07/24/2019

Operator: INTERGY PRODUCTION LLC 21212
PO BOX 342
14101 SMITHURST RD
EDMOND, OK 73083-0342

Completion Type		Location Exception		Increased Density	
X	Single Zone	Order No		Order No	
	Multiple Zone	709618		693755	
	Commingled				

Casing and Cement							
Type	Size	Weight	Grade	Feet	PSI	SAX	Top of CMT
SURFACE	8 5/8	24	J-55	832	500	400	SURFACE
PRODUCTION	5 1/2	15 1/2 & 17	J-55	6657	1500	245	5462

Liner								
Type	Size	Weight	Grade	Length	PSI	SAX	Top Depth	Bottom Depth
There are no Liner records to display.								

Total Depth: 6661

Packer	
Depth	Brand & Type
6440	AS1X

Plug	
Depth	Plug Type
6620	CIBP
6640	CIBP

Initial Test Data

Test Date	Formation	Oil BBL/Day	Oil-Gravity (API)	Gas MCF/Day	Gas-Oil Ratio Cu FT/BBL	Water BBL/Day	Pumpin or Flowing	Initial Shut-In Pressure	Choke Size	Flow Tubing Pressure
Jul 23, 2019	VIOLA	1.6		135	84375		FLOWING	1100	8/64	550

Completion and Test Data by Producing Formation

Formation Name: 2ND WILCOX

Code: 202WLCX2

Class: DRY

Spacing Orders

Order No	Unit Size
620396	80

Perforated Intervals

From	To
6646	6650

Acid Volumes

NONE

Fracture Treatments

There are no Fracture Treatments records to display.
--

Formation Name: 2ND WILCOX

Code: 202WLCX2

Class: DRY

Spacing Orders

Order No	Unit Size
620396	80

Perforated Intervals

From	To
6629	6633

Acid Volumes

500 GALLONS HCL

Fracture Treatments

There are no Fracture Treatments records to display.
--

Formation Name: VIOLA

Code: 202VIOL

Class: GAS

Spacing Orders

Order No	Unit Size
620396	80

Perforated Intervals

From	To
6526	6534

Acid Volumes

NONE

Fracture Treatments

There are no Fracture Treatments records to display.
--

Formation	Top
HOGSHOOTER (BASE)	5355
CHECKERBOARD (BASE)	5491
OSWEGO (BASE)	6023
HUNTON	6166
VIOLA	6304
MARSHALL	6540
2ND WILCOX	6604

Were open hole logs run? Yes

Date last log run: June 17, 2019

Were unusual drilling circumstances encountered? No

Explanation:

Other Remarks

OCC - THIS WELL IS LOCATED ON AN IRREGULAR UNIT COMPRISING OF SE SW SECTION 1 AND NE NW SECTION 12-14N-4W

Bottom Holes
Sec: 1 TWP: 14N RGE: 4W County: OKLAHOMA
SW SW SE SW
70 FSL 1566 FWL of 1/4 SEC
Depth of Deviation: 0 Radius of Turn: 0 Direction: 0 Total Length: 0
Measured Total Depth: 6661 True Vertical Depth: 6636 End Pt. Location From Release, Unit or Property Line: 70

FOR COMMISSION USE ONLY
Status: Accepted
1144912

API NO. 109-22466
OTC PROD.
UNIT NO. 21212-0

(PLEASE TYPE OR USE BLACK INK ONLY)

OKLAHOMA CORPORATION COMMISSION

Oil & Gas Conservation Division

Post Office Box 52000

Oklahoma City, Oklahoma 73152-2000

Rule 165:10-3-25

COMPLETION REPORT

RECEIVED

Form 1002A

Rev. 2009

MAR 18 2020

OKLAHOMA CORPORATION COMMISSION

640 Acres SEC 1

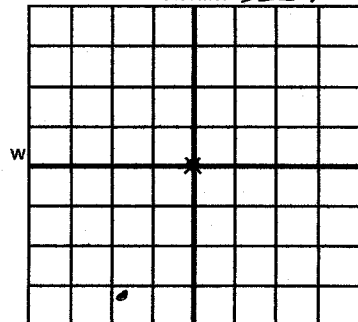

LOCATE WELL

ORIGINAL
AMENDED (Reason)

TYPE OF DRILLING OPERATION

STRAIGHT HOLE ☒ DIRECTIONAL HOLE ☐ HORIZONTAL HOLE ☐
SERVICE WELL

If directional or horizontal, see reverse for bottom hole location.

COUNTY OKLAHOMA SEC 1 TWP 14N RGE 4W

LEASE NAME Deer Creek WELL NO. 2

NW 1/4 SW 1/4 SE 1/4 SW 1/4 FSL OF 1/4 SEC 573 FWL OF 1/4 SEC 540

ELEVATION 1039 KB Ground 1026 Latitude (if known) 35° 42' Longitude (if known) 97° 34'

OPERATOR NAME INTERGY PRODUCTION LLC. OTC/OCC OPERATOR NO. 21212-0

ADDRESS P.O. Box 342

CITY EDMOND STATE OK ZIP 73083-0342

COMPLETION TYPE

☒ SINGLE ZONE
☐ MULTIPLE ZONE
Application Date
☐ COMINGLED
Application Date
LOCATION EXCEPTION ORDER NO. 109618 F.O.
INCREASED DENSITY ORDER NO. 693 155

CASING & CEMENT (Attach Form 1002C)

TYPE	SIZE	WEIGHT	GRADE	FEET	PSI	SAX	TOP OF CMT
CONDUCTOR							
SURFACE	8 5/8	24	J-55	832	500	400	Surface
INTERMEDIATE							
PRODUCTION	5 1/2	15 1/2	J-55	6657	1500	245	54 62
LINER							

PACKER @ 6440 BRAND & TYPE ASIX PLUG @ 6640 TYPE C18P PLUG @ 6620 TYPE C18P TOTAL DEPTH 6658 6661
PACKER @ BRAND & TYPE PLUG @ TYPE PLUG @ TYPE

COMPLETION & TEST DATA BY PRODUCING FORMATION

FORMATION	2nd Wilcox	2nd Wilcox	Viola			
SPACING & SPACING ORDER NUMBER	80-620396	620 396-80	620 396-80			
CLASS: Oil, Gas, Dry, Inj, Disp, Comm Disp, Svc	Dry	Dry	Gas			
PERFORATED INTERVALS	6646-50	6629-33	6526-34			
ACID/VOLUME	None	500gal HCl	None			
FRACTURE TREATMENT (Fluids/Prop Amounts)						

Min Gas Allowable (165:10-17-7)

Gas Purchaser/Measurer

First Sales Date

INITIAL TEST DATA

Oil Allowable (165:10-13-3)

INITIAL TEST DATE	7/12/19	7/18/19	7/23/19		
OIL-BBL/DAY	PEA	PEA	1.6		
OIL-GRAVITY (API)					
GAS-MCF/DAY			135		
GAS-OIL RATIO CU FT/BBL			84375		
WATER-BBL/DAY			zero water		
PUMPING OR FLOWING			Flowing		
INITIAL SHUT-IN PRESSURE			1100		
CHOKE SIZE			8/64		
FLOW TUBING PRESSURE			550		

A record of the formations drilled through, and pertinent remarks are presented on the reverse. I declare that I have knowledge of the contents of this report and am authorized by my organization to make this report, which was prepared by me or under my supervision and direction, with the data and facts stated herein to be true, correct, and complete to the best of my knowledge and belief.

SIGNATURE JAMES M. FRANKLIN, AGENT 3/11/20 (405) 802-3325
ADDRESS P.O. Box 342 CITY EDMOND STATE OK ZIP 73083-0342 EMAIL ADDRESS gsisman@intergyprod.com

PLEASE TYPE OR USE BLACK INK ONLY

FORMATION RECORD

Give formation names and tops, if available, or descriptions and thickness of formations drilled through. Show intervals cored or drillstem tested.

LEASE NAME

DEER CREEK

WELL NO.

2

NAMES OF FORMATIONS	TOP
	TVD
Hogshooter (Base)	5355
Checker Board (Base)	5491
Oswego (Base)	6023
Hunton	6166
Viola	6304
Marshall	6540
2nd Wilcox	6604

FOR COMMISSION USE ONLY

ITD on file ☐ YES ☐ NO

APPROVED DISAPPROVED

2) Reject Codes

Were open hole logs run?

☒ yes ☐ no

Date Last log was run

6/17/19

Was CO₂ encountered?☐ yes ☒ no at what depths?Was H₂S encountered?☐ yes ☒ no at what depths?

Were unusual drilling circumstances encountered?

☐ yes ☒ no

If yes, briefly explain below

Other remarks:

DCC - This well is located on an irregular unit comprising of SE 1/4 Section 1 and NE 1/4 Section 2 - 14N-4W

640 Acres

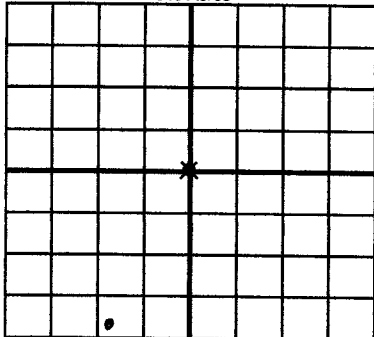

If more than three drainholes are proposed, attach a separate sheet indicating the necessary information.

Direction must be stated in degrees azimuth. Please note, the horizontal drainhole and its end point must be located within the boundaries of the lease or spacing unit.

Directional surveys are required for all drainholes and directional wells.

640 Acres

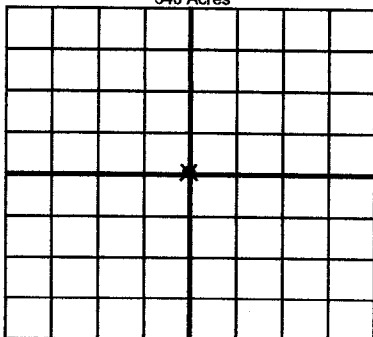

BOTTOM HOLE LOCATION FOR DIRECTIONAL HOLE

SEC	TWP	RGE	COUNTY
1	14N	4W	OKLAHOMA
Spot Location			
SW 1/4	SW 1/4	SE 1/4	SW 1/4
Measured Total Depth		True Vertical Depth	BHL From Lease, Unit, or Property Line:
6658-6661		6590-6636	70

BOTTOM HOLE LOCATION FOR HORIZONTAL HOLE: (LATERALS)

LATERAL #1

SEC	TWP	RGE	COUNTY
1	14N	4W	OKLAHOMA
Spot Location			
1/4	1/4	1/4	1/4
Feet From 1/4 Sec Lines		FSL	FWL
70			1566
Depth of Deviation		Radius of Turn	Direction
Measured Total Depth		True Vertical Depth	BHL From Lease, Unit, or Property Line:

LATERAL #2

SEC	TWP	RGE	COUNTY
1	14N	4W	OKLAHOMA
Spot Location			
1/4	1/4	1/4	1/4
Feet From 1/4 Sec Lines		FSL	FWL
70			1566
Depth of Deviation		Radius of Turn	Direction
Measured Total Depth		True Vertical Depth	BHL From Lease, Unit, or Property Line:

LATERAL #3

SEC	TWP	RGE	COUNTY
1	14N	4W	OKLAHOMA
Spot Location			
1/4	1/4	1/4	1/4
Feet From 1/4 Sec Lines		FSL	FWL
70			1566
Depth of Deviation		Radius of Turn	Direction
Measured Total Depth		True Vertical Depth	BHL From Lease, Unit, or Property Line:

API
NO. 109-22466
OTC PROD.
UNIT NO. 21212

(PLEASE TYPE OR USE BLACK INK ONLY)

OKLAHOMA CORPORATION COMMISSION

Oil & Gas Conservation Division

Post Office Box 52000

Oklahoma City, Oklahoma 73152-2000

Rule 165:10-3-25

COMPLETION REPORT

RECEIVED

Form 1002A

Rev. 2009

MAR 18 2020

OKLAHOMA CORPORATION
COMMISSION

640 Acres Sec 1

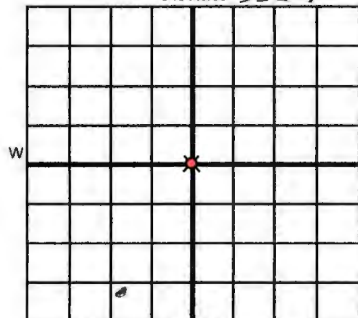

TYPE OF DRILLING OPERATION

☐ STRAIGHT HOLE ☒ DIRECTIONAL HOLE ☐ HORIZONTAL HOLE
☐ SERVICE WELL

If directional or horizontal, see reverse for bottom hole location.

COUNTY OKLAHOMA SEC 1 TWP 14N RGE 4W

LEASE NAME Daer Creek WELL NO. 2

NW 1/4 SW 1/4 SE 1/4 SW 1/4 FSL OF 1/4 SEC 573 FWL OF 1/4 SEC 540

ELEVATION 1039 KB Ground 1026 Latitude (if known) 35° 42' Longitude (if known) 97° 34'

OPERATOR NAME INTERGY PRODUCTION LLC. OTC/OCC OPERATOR NO. 21212-0

ADDRESS P.O. Box 342

CITY EDMOND STATE OK ZIP 73083-0342

COMPLETION TYPE

☒ SINGLE ZONE
☐ MULTIPLE ZONE
Application Date
☐ COMMINGLED
Application Date
LOCATION EXCEPTION ORDER NO. 709618 F.O.
INCREASED DENSITY ORDER NO. 693 755

CASING & CEMENT (Attach Form 1002C)

TYPE	SIZE	WEIGHT	GRADE	FEET	PSI	SAX	TOP OF CMT
CONDUCTOR							
SURFACE	8 5/8	24#	J-55	832	500	400	Surface
INTERMEDIATE							
PRODUCTION	5 1/2	15 1/2 #17	J55	6657	1500	245	5462
LINER							

PACKER @ 6440 BRAND & TYPE ASIX PLUG @ 6640 TYPE C18P PLUG @ 6620 TYPE C18P
PACKER @ 6440 BRAND & TYPE ASIX PLUG @ 6640 TYPE C18P PLUG @ 6620 TYPE C18P

TOTAL DEPTH 6659 6661

COMPLETION & TEST DATA BY PRODUCING FORMATION

FORMATION	2nd Wilcox	2nd Wilcox	Viola			
SPACING & SPACING						
ORDER NUMBER	<u>80-620396</u>	<u>620346-80</u>	<u>620396-80</u>			
CLASS: Oil, Gas, Dry, Inj, Disp, Comm Disp, Svc	<u>Dry</u>	<u>Dry</u>	<u>Gas</u>			
PERFORATED INTERVALS	<u>6646-50</u>	<u>6629-33</u>	<u>6526-34</u>			
ACID/VOLUME	<u>None</u>	<u>500gal HCl</u>	<u>None</u>			
FRACTURE TREATMENT (Fluids/Prop Amounts)						

Min Gas Allowable (165:10-17-7)



OR

Oil Allowable (165:10-13-3)

Gas Purchaser/Measurer

First Sales Date

OGG, LLC

7/24/19

INITIAL TEST DATA

INITIAL TEST DATE	<u>7/12/19</u>	<u>7/18/19</u>	<u>7/23/19</u>			
OIL-BBL/DAY	<u>PEA</u>	<u>PEA</u>	<u>1.6</u>			
OIL-GRAVITY (API)						
GAS-MCF/DAY			<u>135</u>			
GAS-OIL RATIO CU FT/BBL			<u>84375</u>			
WATER-BBL/DAY			<u>1100</u>			
PUMPING OR FLOWING			<u>Flowing</u>			
INITIAL SHUT-IN PRESSURE			<u>864</u>			
CHOKE SIZE			<u>55/64</u>			
FLOW TUBING PRESSURE			<u>55/64</u>			

A record of the formations drilled through, and pertinent remarks are presented on the reverse. I declare that I have knowledge of the contents of this report and am authorized by my organization to make this report, which was prepared by me or under my supervision and direction, with the data and facts stated herein to be true, correct, and complete to the best of my knowledge and belief.

James M. Frankum

SIGNATURE

JAMES M. FRANKUM, AGENT

NAME (PRINT OR TYPE)

3/11/20 (405) 802-3325

DATE PHONE NUMBER

P.O. Box 342

ADDRESS

EDMOND

CITY

OK

STATE

73083-0342

ZIP

gs.sman@intergyprod.com

EMAIL ADDRESS

PLEASE TYPE OR USE BLACK INK ONLY

FORMATION RECORD

Give formation names and tops, if available, or descriptions and thickness of formations drilled through. Show intervals cored or drillstem tested.

NAMES OF FORMATIONS	TOP
	1VD
Hogshooter (Base)	5355
Checker Board (Base)	5491
Oswego (Base)	6023
Huntton	6166
Viola	6304
Marshall	6540
2nd Wilcox	6604

LEASE NAME

DEER CREEK

WELL NO.

2

FOR COMMISSION USE ONLY

ITD on file

☐ YES☐ NO

APPROVED

DISAPPROVED

2) Reject Codes

Were open hole logs run?

☒ yes ☐ no

Date Last log was run

6/17/19

Was CO₂ encountered?☐ yes ☒ no at what depths?Was H₂S encountered?☐ yes ☒ no at what depths?

Were unusual drilling circumstances encountered?

☐ yes ☒ no

If yes, briefly explain below

Other remarks:

DCC - This well is located on an irregular unit comprising of SE SW Section 1 and NENW Section 12 - 14N - 4W

640 Acres

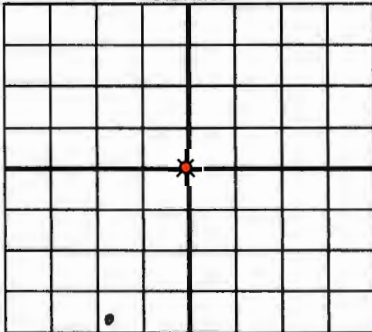

If more than three drainholes are proposed, attach a separate sheet indicating the necessary information.

Direction must be stated in degrees azimuth. Please note, the horizontal drainhole and its end point must be located within the boundaries of the lease or spacing unit.

Directional surveys are required for all drainholes and directional wells.

640 Acres

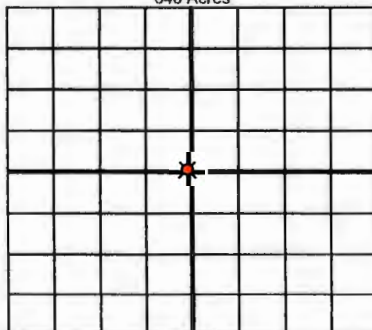

BOTTOM HOLE LOCATION FOR DIRECTIONAL HOLE

SEC	TWP	RGE	COUNTY
1	14N	4W	OKLAHOMA
Spot Location			
SW 1/4	SW 1/4	SE 1/4	SW 1/4
Measured Total Depth		True Vertical Depth	BHL From Lease, Unit, or Property Line:
6658 6661		6590 6636	70

BOTTOM HOLE LOCATION FOR HORIZONTAL HOLE: (LATERALS)

LATERAL #1

SEC	TWP	RGE	COUNTY
Spot Location			
1/4	1/4	1/4	1/4
Depth of Deviation		Radius of Turn	Direction
Measured Total Depth		True Vertical Depth	Total Length
BHL From Lease, Unit, or Property Line:			

LATERAL #2

SEC	TWP	RGE	COUNTY
Spot Location			
1/4	1/4	1/4	1/4
Depth of Deviation		Radius of Turn	Direction
Measured Total Depth		True Vertical Depth	Total Length
BHL From Lease, Unit, or Property Line:			

LATERAL #3

SEC	TWP	RGE	COUNTY
Spot Location			
1/4	1/4	1/4	1/4
Depth of Deviation		Radius of Turn	Direction
Measured Total Depth		True Vertical Depth	Total Length
BHL From Lease, Unit, or Property Line:			