

Oklahoma Corporation Commission
Oil & Gas Conservation Division
Post Office Box 52000
Oklahoma City, Oklahoma 73152-2000
Rule 165: 10-3-25

Form 1002A

API No.: 35019070640003

Completion Report

Spud Date: September 30, 1949

OTC Prod. Unit No.:

Drilling Finished Date: September 22, 1949

Amended

1st Prod Date: October 18, 1949

Amend Reason: SET PLUGS & RECOMPLETE NEW ZONE INJECTION

Completion Date: October 27, 1949

Recomplete Date: March 12, 2021

Drill Type: STRAIGHT HOLE

SERVICE WELL

Well Name: BAYOU UNIT (J C SULLIVAN A 7) 100

Purchaser/Measurer:

Location: CARTER 36 4S 2W
SW NW SE SW
955 FSL 1615 FWL of 1/4 SEC
Latitude: 34.160728 Longitude: -97.364096
Derrick Elevation: 857 Ground Elevation: 850

First Sales Date:

Operator: CITATION OIL & GAS CORPORATION 14156

14077 CUTTEN RD
HOUSTON, TX 77069-2212

Completion Type	
X	Single Zone
	Multiple Zone
	Commingled

Location Exception
Order No
There are no Location Exception records to display.

Increased Density
Order No
There are no Increased Density records to display.

Casing and Cement							
Type	Size	Weight	Grade	Feet	PSI	SAX	Top of CMT
SURFACE	10.75	40		222		200	SURFACE
PRODUCTION	7	23		3441		400	910

Liner								
Type	Size	Weight	Grade	Length	PSI	SAX	Top Depth	Bottom Depth
There are no Liner records to display.								

Total Depth: 3495

Packer	
Depth	Brand & Type
2021	AD-1

Plug	
Depth	Plug Type
3000	CIBP
3430	CIBP

Initial Test Data

Test Date	Formation	Oil BBL/Day	Oil-Gravity (API)	Gas MCF/Day	Gas-Oil Ratio Cu FT/BBL	Water BBL/Day	Pumpin or Flowing	Initial Shut- In Pressure	Choke Size	Flow Tubing Pressure
-----------	-----------	----------------	----------------------	----------------	----------------------------	------------------	----------------------	---------------------------------	---------------	-------------------------

There are no Initial Data records to display.

Completion and Test Data by Producing Formation

Formation Name: PENNSYLVANIAN

Code: 409PSLV

Class: INJ

Spacing Orders		Perforated Intervals	
Order No	Unit Size	From	To
57171	UNIT	2230	2496
Acid Volumes		Fracture Treatments	
N/A		N/A	

Formation	Top
PENNSYLVANIAN	2230

Were open hole logs run? No

Date last log run:

Were unusual drilling circumstances encountered? No

Explanation:

Other Remarks
FILING THIS 1002A TO UPDATE WELLBORE CONFIGURATION. THERE IS A CIBP AT 3,430' AND ONE AT 3,000'. EACH HAVE 1 SACK CEMENT ON TOP OF BRIDGE PLUG. PRODUCTION CASING TOP OF CEMENT AT 910' BY TEMPREATURE SURVEY. OCC- UIC ORDER 57171 WITH EXCEPTION ORDER 717250 EXCEPTION TO THE RULE 165:10-5-6 MIT REQUIREMENT.

FOR COMMISSION USE ONLY

1145485

Status: Accepted

OIL AND GAS CONSERVATION DIVISION

P.O. Box 52000

Oklahoma City, OK 73152-2000

405-522-0577

occcentralprocessing@occ.ok.gov



Form 1002A

Rev. 2009

03

ORIGINAL

AMENDED (Reason)

Update well configuration

OAC 165:10-3-25

(PLEASE TYPE OR USE BLACK INK ONLY)

TYPE OF DRILLING OPERATION

☒ STRAIGHT HOLE ☐ DIRECTIONAL HOLE ☐ HORIZONTAL HOLE
☒ SERVICE WELL

If directional or horizontal, see reverse for bottom hole location.

COUNTY	Carter	SEC	36	TWP	4S	RGE	2W	SPUD DATE	9/30/1949
LEASE NAME	Bayou Unit (J C Sullivan "A" 7)			WELL NO.	100	DATE OF WELL COMPLETION	10/27/1949	DRLG FINISHED DATE	9/22/1949
SW 1/4 NW 1/4 SE 1/4 SW 1/4	FSL OF 1/4 SEC	955	FWL OF 1/4 SEC	1615	RECOMP DATE	4/18/1969	1st PROD DATE	10/18/1949	
ELEVATION Derrick FL	857	Ground	850	Latitude (if known)	34.160728	Longitude (if known)	-97.364096		
OPERATOR NAME	Citation Oil & Gas Corp.			OTC / OCC OPERATOR NO.	14156				
ADDRESS	14077 Cutten Rd.								
CITY	Houston			STATE	Texas	ZIP	77069		

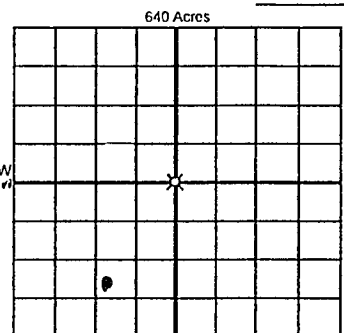

COMPLETION TYPE

<input checked="" type="checkbox"/> SINGLE ZONE	Hoxbar
<input type="checkbox"/> MULTIPLE ZONE	
<input type="checkbox"/> COMMINGLED	
LOCATION EXCEPTION ORDER NO.	
INCREASED DENSITY ORDER NO.	

CASING & CEMENT (Attach Form 1002C)

TYPE	SIZE	WEIGHT	GRADE	FEET	PSI	SAX	TOP OF CMT
CONDUCTOR							
SURFACE	10.75	40		222		200	surface
INTERMEDIATE							
PRODUCTION	7	23		3441		400	910
LINER							

PACKER @ AD-1 BRAND & TYPE 2021 PLUG @ CIBP TYPE 3000 PLUG @ TYPE
 PACKER @ BRAND & TYPE PLUG @ CIBP TYPE 3430 PLUG @ TYPE

TOTAL DEPTH 3495

COMPLETION & TEST DATA BY PRODUCING FORMATION

FORMATION	Pennsylvanian								
SPACING & SPACING ORDER NUMBER	57171 (unit)								
CLASS: Oil, Gas, Dry, Inj, Disp, Comm Disp, Svc	Inj								
PERFORATED INTERVALS	2230-2496								
ACID/VOLUME	N/A								
FRACTURE TREATMENT (Fluids/Prop Amounts)	N/A								

RECEIVED

AUG 06 2020

Oklahoma Corporation Commission

Min Gas Allowable (165:10-17-7)

Gas Purchaser/Measurer

N/A

OR

First Sales Date

N/A

INITIAL TEST DATA

INITIAL TEST DATE	N/A						
OIL-BBL/DAY							
OIL-GRAVITY (API)							
GAS-MCF/DAY							
GAS-OIL RATIO CU FT/BBL							
WATER-BBL/DAY							
PUMPING OR FLOWING							
INITIAL SHUT-IN PRESSURE							
CHOKE SIZE							
FLOW TUBING PRESSURE							

A record of the formations drilled through, and pertinent remarks are presented on the reverse. I declare that I have knowledge of the contents of this report and am authorized by my organization to make this report, which was prepared by me or under my supervision and direction, with the data and facts stated herein to be true, correct, and complete to the best of my knowledge and belief.

SIGNATURE	Sharon Ward	NAME (PRINT OR TYPE)	Sharon Ward	DATE	7/31/2020	PHONE NUMBER	281-891-1556
ADDRESS	14077 Cutten Rd.	CITY	Houston	STATE	Texas	ZIP	77069
						EMAIL ADDRESS	sward@cogc.com

PLEASE TYPE OR USE BLACK INK ONLY
FORMATION RECORD

Give formation names and tops, if available, or descriptions and thickness of formations drilled through. Show intervals cored or driftestem tested.

LEASE NAME Bayou

WELL NO. 100

NAMES OF FORMATIONS	TOP
Pennsylvanian	2230

FOR COMMISSION USE ONLY

ITD on file ☐ YES ☐ NO

APPROVED _____ DISAPPROVED _____

2) Reject Codes _____

Were open hole logs run? ☐ yes ☐ no NA

Date Last log was run _____ NA

Was CO₂ encountered? NA ☐ yes ☐ no at what depths? _____

Was H₂S encountered? NA ☐ yes ☐ no at what depths? _____

Were unusual drilling circumstances encountered? NA ☐ yes ☐ no

If yes, briefly explain below _____

Other remarks: Filing this 1002A to update wellbore configuration. There is a CIBP # 3430 and one at 3000. Each have 1 sack cement on top of bridge plug. Production casing is at 910' by temp survey.

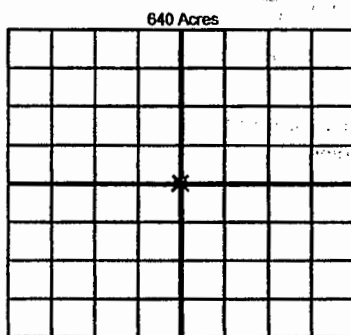

If more than three drainholes are proposed, attach a separate sheet indicating the necessary information.

Direction must be stated in degrees azimuth. Please note, the horizontal drainhole and its end point must be located within the boundaries of the lease or spacing unit.

Directional surveys are required for all drainholes and directional wells.

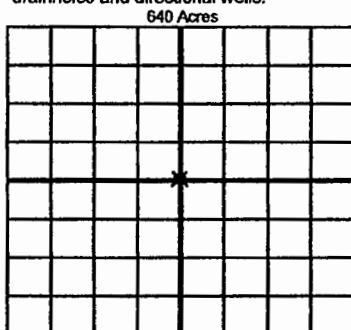

BOTTOM HOLE LOCATION FOR DIRECTIONAL HOLE

SEC	TWP	RGE	COUNTY
Spot Location			
1/4	1/4	1/4	1/4
Measured Total Depth		True Vertical Depth	Feet From 1/4 Sec Lines FSL FWL
BHL From Lease, Unit, or Property Line:			

BOTTOM HOLE LOCATION FOR HORIZONTAL HOLE: (LATERALS)

LATERAL #1

SEC	TWP	RGE	COUNTY
Spot Location			
1/4	1/4	1/4	1/4
Depth of Deviation		Radius of Turn	Direction
Measured Total Depth		True Vertical Depth	Total Length
BHL From Lease, Unit, or Property Line:			

LATERAL #2

SEC	TWP	RGE	COUNTY
Spot Location			
1/4	1/4	1/4	1/4
Depth of Deviation		Radius of Turn	Direction
Measured Total Depth		True Vertical Depth	Total Length
BHL From Lease, Unit, or Property Line:			

LATERAL #3

SEC	TWP	RGE	COUNTY
Spot Location			
1/4	1/4	1/4	1/4
Depth of Deviation		Radius of Turn	Direction
Measured Total Depth		True Vertical Depth	Total Length
BHL From Lease, Unit, or Property Line:			