

Oklahoma Corporation Commission  
Oil & Gas Conservation Division  
Post Office Box 52000  
Oklahoma City, Oklahoma 73152-2000  
Rule 165: 10-3-25

Form 1002A

API No.: 35051244170000

**Completion Report**

Spud Date: July 25, 2018

OTC Prod. Unit No.: 051-225401-0-0000

Drilling Finished Date: September 28, 2018

1st Prod Date: April 15, 2019

Completion Date: April 15, 2019

**Drill Type:** HORIZONTAL HOLE

Well Name: JEANNIE 5-27X34H

Purchaser/Measurer:

Location: GRADY 27 5N 6W  
NW SW NW SE  
1870 FSL 2380 FEL of 1/4 SEC  
Latitude: 34.874683 Longitude: -97.81923  
Derrick Elevation: 0 Ground Elevation: 1148

First Sales Date:

Operator: GULFPORT MIDCON LLC 24020

3001 QUAIL SPRINGS PKWY  
OKLAHOMA CITY, OK 73134-2640

Completion Type	
X	Single Zone
	Multiple Zone
	Commingled

Location Exception	
Order No	
700539	

Increased Density	
Order No	
680412	
684013	

Casing and Cement							
Type	Size	Weight	Grade	Feet	PSI	SAX	Top of CMT
CONDUCTOR	30			128			
SURFACE	13 5/8		J-55	1513		865	SURFACE
INTERMEDIATE	9 5/8		P-110HC	9655		965	4302
INTERMEDIATE	7 5/8		P-110HC	9395		774	2449
PRODUCTION	5 1/2		P-110	21703		860	8626

Liner								
Type	Size	Weight	Grade	Length	PSI	SAX	Top Depth	Bottom Depth
There are no Liner records to display.								

**Total Depth: 21715**

Packer	
Depth	Brand & Type
There are no Packer records to display.	

Plug	
Depth	Plug Type
There are no Plug records to display.	

Initial Test Data
-------------------

Test Date	Formation	Oil BBL/Day	Oil-Gravity (API)	Gas MCF/Day	Gas-Oil Ratio Cu FT/BBL	Water BBL/Day	Pumpin or Flowing	Initial Shut-In Pressure	Choke Size	Flow Tubing Pressure
May 07, 2019	WOODFORD	730	59	16340	22383	5146	FLOWING	4481	32/64	

<b>Completion and Test Data by Producing Formation</b>	
Formation Name: WOODFORD	Code: 319WDFD
Class: GAS	

Spacing Orders	
Order No	Unit Size
446322	640
456941	640
700658	MULTIUNIT

Perforated Intervals	
From	To
15287	21590

Acid Volumes	
991 BARRELS ACID	

Fracture Treatments	
348,008 BARRELS WATER, 13,577,763 POUNDS SAND	

Formation	Top
WOODFORD	14950

Were open hole logs run? No

Date last log run:

Were unusual drilling circumstances encountered? No

Explanation:

<b>Other Remarks</b>
There are no Other Remarks.

<b>Lateral Holes</b>
Sec: 34 TWP: 5N RGE: 6W County: GRADY  SW SW SW SE  113 FSL 2337 FEL of 1/4 SEC  Depth of Deviation: 14659 Radius of Turn: 769 Direction: 182 Total Length: 6456  Measured Total Depth: 21715 True Vertical Depth: 15259 End Pt. Location From Release, Unit or Property Line: 113

<b>FOR COMMISSION USE ONLY</b>	
Status: Accepted	1143157

# RECEIVED

JUN 19 2019

Oklahoma Corporation  
Commission

Form 1002A  
Rev. 2009

API NO. 051-24417  
OTC PROD. UNIT NO. 051225401-0-0000

(PLEASE TYPE OR USE BLACK INK ONLY)

OKLAHOMA CORPORATION COMMISSION  
Oil & Gas Conservation Division  
Post Office Box 52000  
Oklahoma City, Oklahoma 73152-2000  
Rule 165-10-3-25

☒ ORIGINAL  
☐ AMENDED (Reason)

## COMPLETION REPORT

### TYPE OF DRILLING OPERATION

☐ STRAIGHT HOLE ☐ DIRECTIONAL HOLE ☒ HORIZONTAL HOLE  
☐ SERVICE WELL

If directional or horizontal, see reverse for bottom hole location.

COUNTY	Grady	SEC	27	TWP	5N	RGE	6W
LEASE NAME	Jeannie			WELL NO.	5-27X34H		
NW 1/4 SW 1/4 NW 1/4 SE 1/4	FSL OF 1/4 SEC 1870			FEL 1/4 SEC	2380		
ELEVATION Derrick FL	Ground	1148	Latitude (if known)	34.874683		Longitude (if known)	-97.81923
OPERATOR NAME	Gulfport MidCon			OTC / OCC OPERATOR NO.	24020		
ADDRESS	3001 Quail Springs Parkway						
CITY	Oklahoma City	STATE	OK	ZIP	73134		

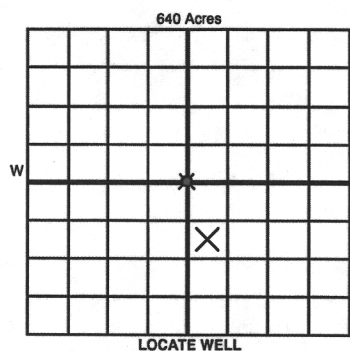

### COMPLETION TYPE

<input checked="" type="checkbox"/> SINGLE ZONE	
<input type="checkbox"/> MULTIPLE ZONE	
Application Date	F.O.
COMINGLED	
Application Date	700539
LOCATION EXCEPTION ORDER NO.	681305
INCREASED DENSITY ORDER NO.	680412/684013

### CASING & CEMENT (Attach Form 1002C)

TYPE	SIZE	WEIGHT	GRADE	FEET	PSI	SAX	TOP OF CMT
CONDUCTOR	30			128			
SURFACE	13 5/8		J55	1,513		865	Surface
INTERMEDIATE	9 5/8		P110HC	9,655		965	5,353
PRODUCTION	7 5/8		P110HC	9,395		774	6,946
INNER PRODUCTION	5 1/2		P110	21,703		860	13,077
							21,715

PACKER @ \_\_\_\_\_ BRAND & TYPE \_\_\_\_\_

PLUG @ \_\_\_\_\_ TYPE \_\_\_\_\_

PLUG @ \_\_\_\_\_ TYPE \_\_\_\_\_

TOTAL DEPTH

PACKER @ \_\_\_\_\_ BRAND & TYPE \_\_\_\_\_

PLUG @ \_\_\_\_\_ TYPE \_\_\_\_\_

PLUG @ \_\_\_\_\_ TYPE \_\_\_\_\_

### COMPLETION & TEST DATA BY PRODUCING FORMATION

FORMATION	Woodford	Woodford					
SPACING & SPACING	640/#456941	MU#681305					
ORDER NUMBER	446322	700658					
CLASS: Oil, Gas, Dry, Inj, Disp, Comm Disp, Svc	GAS						
PERFORATED INTERVALS	15,287-21,590						
ACID/VOLUME	991 bbls Acid						
FRACTURE TREATMENT (Fluids/Prop Amounts)	348,008 bbls Water 13,577,763 bbls Sand						

Min Gas Allowable (165:10-17-7)

Gas Purchaser/Measurer

☐

OR

First Sales Date

### INITIAL TEST DATA

INITIAL TEST DATE	5/7/2019				
OIL-BBL/DAY	730				
OIL-GRAVITY (API)	59				
GAS-MCF/DAY	16,340				
GAS-OIL RATIO CU FT/BBL	22,383				
WATER-BBL/DAY	5,146				
PUMPING OR FLOWING	Flowing				
INITIAL SHUT-IN PRESSURE	4,481				
CHOKE SIZE	32/64				
FLOW TUBING PRESSURE	N/A				

AS SUBMITTED

A record of the formations drilled through, and pertinent remarks are presented on the reverse. I declare that I have knowledge of the contents of this report and am authorized by my organization to make this report, which was prepared by me or under my supervision and direction, with the data and facts stated herein to be true, correct, and complete to the best of my knowledge and belief.

SIGNATURE	NAME (PRINT OR TYPE)	DATE	PHONE NUMBER
3001 Quail Springs Parkway	Monica Pickens	6/14/2019	252-4703
ADDRESS	CITY	STATE	ZIP
	OKC	OK	73134
			mpickens@gulfportenergy.com
			EMAIL ADDRESS

PLEASE TYPE OR USE BLACK INK ONLY

FORMATION RECORD

Give formation names and tops, if available, or descriptions and thickness of formations drilled through. Show intervals cored or drillstem tested.

NAMES OF FORMATIONS	TOP
Woodford	14,950

LEASE NAME Jeannie WELL NO. 5-27X34H

FOR COMMISSION USE ONLY	
ITD on file <input type="checkbox"/> YES <input type="checkbox"/> NO	
APPROVED _____	DISAPPROVED _____
2) Reject Codes	
_____	
_____	
_____	
_____	

Were open hole logs run?	yes	<input checked="" type="checkbox"/> no
Date Last log was run	_____	
Was CO <sub>2</sub> encountered?	yes	<input checked="" type="checkbox"/> no at what depths? _____
Was H <sub>2</sub> S encountered?	yes	<input checked="" type="checkbox"/> no at what depths? _____
Were unusual drilling circumstances encountered?	yes	<input checked="" type="checkbox"/> no
If yes, briefly explain below		

Other remarks:

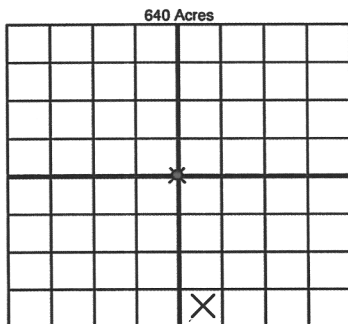
If more than three drainholes are proposed, attach a separate sheet indicating the necessary information.

Direction must be stated in degrees azimuth. Please note, the horizontal drainhole and its end point must be located within the boundaries of the lease or spacing unit.

Directional surveys are required for all drainholes and directional wells.

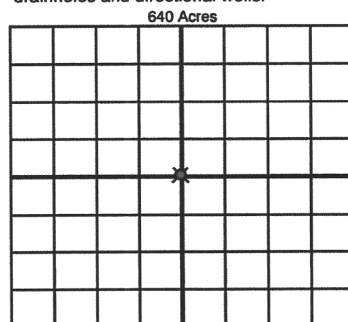

BOTTOM HOLE LOCATION FOR DIRECTIONAL HOLE

SEC	TWP	RGE	COUNTY
Spot Location	1/4	1/4	1/4
Measured Total Depth	True Vertical Depth	BHL From Lease, Unit, or Property Line:	

BOTTOM HOLE LOCATION FOR HORIZONTAL HOLE: (LATERALS)

SEC	TWP	RGE	COUNTY
34	5N	6W	Grady
Spot Location	SW 1/4	SW 1/4	SE 1/4
Depth of Deviation	14,659	Radius of Turn	769
Measured Total Depth	21,715	True Vertical Depth	15,259
Direction		182-175	Total Length 6,456
BHL From Lease, Unit, or Property Line: 151 113			

Per Exhibit LEBM11

As Drilled Plot

LATERAL #2

SEC	TWP	RGE	COUNTY
Spot Location	1/4	1/4	1/4
Depth of Deviation	Radius of Turn	Direction	Total Length
Measured Total Depth	True Vertical Depth	BHL From Lease, Unit, or Property Line:	

LATERAL #3

SEC	TWP	RGE	COUNTY
Spot Location	1/4	1/4	1/4
Depth of Deviation	Radius of Turn	Direction	Total Length
Measured Total Depth	True Vertical Depth	BHL From Lease, Unit, or Property Line:	