

Oklahoma Corporation Commission
Oil & Gas Conservation Division
Post Office Box 52000
Oklahoma City, Oklahoma 73152-2000
Rule 165: 10-3-25

Form 1002A

API No.: 35019262890000

Completion Report

Spud Date: April 20, 2018

OTC Prod. Unit No.: 019-225335-0-0000

Drilling Finished Date: October 03, 2018

1st Prod Date: April 18, 2019

Completion Date: April 18, 2019

Drill Type: HORIZONTAL HOLE

Well Name: LAWSON 5-13H14X

Purchaser/Measurer:

Location: CARTER 13 3S 2E
NE SE NE NE
880 FNL 280 FEL of 1/4 SEC
Latitude: 34.300776 Longitude: -97.03878
Derrick Elevation: 0 Ground Elevation: 775

First Sales Date:

Operator: XTO ENERGY INC 21003

22777 SPRINGWOODS VILLAGE PKWY
SPRING, TX 77389-1425

Completion Type	
X	Single Zone
	Multiple Zone
	Commingled

Location Exception	
Order No	
674577	

Increased Density	
Order No	
674281	
674954	

Casing and Cement							
Type	Size	Weight	Grade	Feet	PSI	SAX	Top of CMT
CONDUCTOR	20	94	J-55	110			SURFACE
SURFACE	13 3/8	54.5	J-55	2056		845	SURFACE
INTERMEDIATE	9 5/8	39.9	P-110	11555		815	8401
PRODUCTION	5 1/2	23	P-110	22703		2840	7650

Liner								
Type	Size	Weight	Grade	Length	PSI	SAX	Top Depth	Bottom Depth
There are no Liner records to display.								

Total Depth: 22710

Packer	
Depth	Brand & Type
There are no Packer records to display.	

Plug	
Depth	Plug Type
There are no Plug records to display.	

Initial Test Data

Test Date	Formation	Oil BBL/Day	Oil-Gravity (API)	Gas MCF/Day	Gas-Oil Ratio Cu FT/BBL	Water BBL/Day	Pumpin or Flowing	Initial Shut-In Pressure	Choke Size	Flow Tubing Pressure
Apr 23, 2019	WOODFORD	111	50	490	4414	822	FLOWING	279	48/64	

Completion and Test Data by Producing Formation

Formation Name: WOODFORD

Code: 319WDFD

Class: OIL

Spacing Orders

Order No	Unit Size
197431	640
674572	MULTIUNIT

Perforated Intervals

From	To
12394	22545

Acid Volumes

9,000 GALLONS

Fracture Treatments

36 STAGES - 531,618 BARRELS TREATED WATER, 1,617,680 POUNDS 100 MESH SAND, 13,970,142 POUNDS 40/70 SAND

Formation	Top
WOODFORD	12030

Were open hole logs run? No

Date last log run:

Were unusual drilling circumstances encountered? No

Explanation:

Other Remarks

IRREGULAR SECTION. THIS IS AN OIL WELL RIGHT NOW BUT WHEN I RE-SUBMIT WITH A BETTER TEST, IT WILL BE A GAS WELL. OCC - THIS DOCUMENT IS ACCEPTED BASED ON THE DATA SUBMITTED NEITHER THE FINAL LOCATION EXCEPTION NOR THE FINAL MULTIUNIT ORDERS HAVE BEEN ISSUED.

Lateral Holes

Sec: 14 TWP: 3S RGE: 2E County: CARTER

SW SW NW NW

1316 FNL 38 FWL of 1/4 SEC

Depth of Deviation: 11437 Radius of Turn: 860 Direction: 271 Total Length: 9921

Measured Total Depth: 22710 True Vertical Depth: 12112 End Pt. Location From Release, Unit or Property Line: 38

FOR COMMISSION USE ONLY

1143237

Status: Accepted

(PLEASE TYPE OR USE BLACK INK ONLY)

OKLAHOMA CORPORATION COMMISSION
Oil & Gas Conservation Division
Post Office Box 52000
Oklahoma City, Oklahoma 73152-2000
Rule 165:10-3-25

RECEIVED
JUN 21 2019
Oklahoma Corporation
Commission

Form 1002A
Rev. 2009

X	ORIGINAL
	AMENDED (Reason)

COMPLETION REPORT

TYPE OF DRILLING OPERATION

TYPE OF DRILLING OPERATION

☒ STRAIGHT HOLE ☐ DIRECTIONAL HOLE ☒ HORIZONTAL HOLE

☐ SERVICE WELL

If directional or horizontal, see reverse for bottom hole location.

COUNTY	Carter	SEC	13	TWP	3S	RGE	2E	DATE OF WELL COMPLETION	4/18/2019
LEASE NAME	Lawson 5-13H14X				WELL NO.			1st PROD DATE	4/18/2019
NE 1/4 SE 1/4 NE 1/4 NE 1/4	FNL OF 1/4 SEC		880	FEL OF 1/4 SEC		280	RECOMP DATE		
ELEVATION Derrick FL	Ground	775'	Latitude (if known)		34.300776	Longitude (if known)		-97.03878	
OPERATOR NAME	XTO Energy Inc.					OTC / OCC OPERATOR NO.		21003	
ADDRESS	210 Park Avenue, Suite 2350								
CITY	Oklahoma City				STATE	Oklahoma	ZIP	73102	

COMPLETION TYPE

<input checked="" type="checkbox"/>	SINGLE ZONE	
<input type="checkbox"/>	MULTIPLE ZONE Application Date	
<input type="checkbox"/>	COMMINGLED Application Date	10
LOCATION EXCEPTION ORDER NO.		674577, 674572
INCREASED DENSITY ORDER NO.		674954, 674281

CASING & CEMENT (Attach Form 1002C)

TYPE	SIZE	WEIGHT	GRADE	FEET	PSI	SAX	TOP OF CMT
CONDUCTOR	20"	94	J-55	110			Surface
SURFACE	13 3/8"	54.5	J-55	2056		845	Surface
INTERMEDIATE	9 5/8"	39.9	P-110	11,555		815	8,401
PRODUCTION	5 1/2"	23	P-110	22703		2840	7650
LINER							
PLUG @	TYPE	PLUG @	TYPE	TOTAL DEPTH			22710'

PACKER @ _____ BRAND & TYPE _____ PLUG @ _____ TYPE _____ PLUG @ _____ TYPE _____
 PACKER @ _____ BRAND & TYPE _____ PLUG @ _____ TYPE _____ PLUG @ _____ TYPE _____

COMPLETION & TEST DATA BY PRODUCING FORMATION

FORMATION	Woodford	IO			Reported to Frac
SPACING & SPACING	640: 197431	674572 (Multistage)			
ORDER NUMBER					
CLASS: Oil, Gas, Dry, Inj, Disp, Comm Disp, Svc	Oil				
PERFORATED INTERVALS	36 Stages				
	12394-22545				
ACID/VOLUME	9000 gals				
FRACTURE TREATMENT (Fluids/Prop Amounts)	531,618 BTW Barrels Treated Water				
	1,617,680# 100 mesh Sand				
	13,970,142# 40/70 Sand				

Reported	
to Frac Focus	

☒ **Min Gas Allowable** (165:10-17-7)
OR
☐ **Oil Allowable** (165:10-13-3)

Gas Purchaser/Measurer
First Sales Date

INITIAL TEST DATA

INITIAL TEST DATE	4/23/2019					
OIL-BBL/DAY	111					
OIL-GRAVITY (API)	50					
GAS-MCF/DAY	490					
GAS-OIL RATIO CU FT/BBL	4414					
WATER-BBL/DAY	822					
PUMPING OR FLOWING	Flowing					
INITIAL SHUT-IN PRESSURE	279					
CHOKE SIZE	48/64"					
FLOW TUBING PRESSURE	N/A					

AS SUBMITTED

A record of the formations drilled through, and pertinent remarks are presented on the reverse. I declare that I have knowledge of the contents of this report and am authorized by my organization to make this report, which was prepared by me or under my supervision and direction, with the data and facts stated herein to be true, correct, and complete to the best of my knowledge and belief.

Nebbie Maggoner
SIGNATURE

Debbie Waggoner

6/20/2018 405-319-3243

210 Park Avenue, Suite 2350

Oklahoma City Ok 73102

debbie waggoner@xtoenergy.com

ADDRESS

CITY	STATE	ZIP
------	-------	-----

EMAIL ADDRESS

PLEASE TYPE OR USE BLACK INK ONLY
FORMATION RECORD

Give formation names and tops, if available, or descriptions and thickness of formations drilled through. Show intervals cored or drillstem tested.

LEASE NAME Lawson WELL NO. 5-13H14X

NAMES OF FORMATIONS	TOP
Woodford	12030'

FOR COMMISSION USE ONLY

ITD on file ☐ YES ☐ NO

APPROVED _____ DISAPPROVED _____

2) Reject Codes _____

Were open hole logs run? _____ yes ☒ no

Date Last log was run _____

Was CO₂ encountered? _____ yes ☒ no at what depths? _____

Was H₂S encountered? _____ yes ☒ no at what depths? _____

Were unusual drilling circumstances encountered? _____ yes ☒ no

If yes, briefly explain below _____

Other remarks: Irregular Section

This is an oil well right now but when I resubmit with a better test, it'll be a gas well.

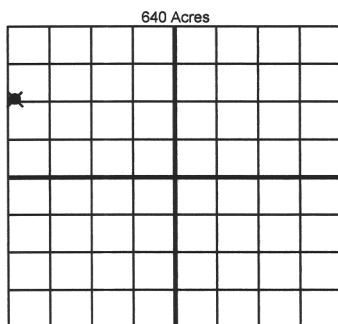

If more than three drainholes are proposed, attach a separate sheet indicating the necessary information.

Direction must be stated in degrees azimuth.
Please note, the horizontal drainhole and its end point must be located within the boundaries of the lease or spacing unit.

Directional surveys are required for all drainholes and directional wells.

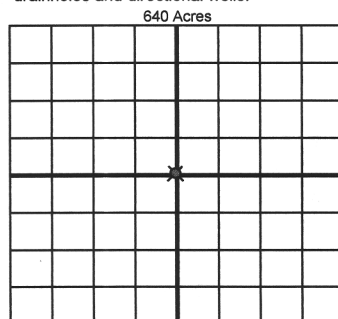

BOTTOM HOLE LOCATION FOR DIRECTIONAL HOLE

SEC	TWP	RGE	COUNTY
Spot Location		Feet From 1/4 Sec Lines	FSL
1/4	1/4	1/4	1/4
Measured Total Depth	True Vertical Depth	BHL From Lease, Unit, or Property Line:	

BOTTOM HOLE LOCATION FOR HORIZONTAL HOLE: (LATERALS)

LATERAL #1

SEC	TWP	RGE	COUNTY
14	3S	2E	Carter
Spot Location		Feet From 1/4 Sec Lines	FNL
SW 1/4	NW 1/4	NW 1/4	1316
Depth of Deviation	Radius of Turn	Direction	Total Length
11,437	860.7	271 258.3	9,921
Measured Total Depth	True Vertical Depth	BHL From Lease, Unit, or Property Line:	
22,710	12,112	4316 FNL & 38 FWL	

LATERAL #2

SEC	TWP	RGE	COUNTY
Spot Location	Feet From 1/4 Sec Lines	FSL	FWL
1/4	1/4	1/4	1/4
Depth of Deviation	Radius of Turn	Direction	Total Length
Measured Total Depth	True Vertical Depth	BHL From Lease, Unit, or Property Line:	

LATERAL #3

SEC	TWP	RGE	COUNTY
Spot Location	Feet From 1/4 Sec Lines	FSL	FWL
1/4	1/4	1/4	1/4
Depth of Deviation	Radius of Turn	Direction	Total Length
Measured Total Depth	True Vertical Depth	BHL From Lease, Unit, or Property Line:	