

Oklahoma Corporation Commission
Oil & Gas Conservation Division
Post Office Box 52000
Oklahoma City, Oklahoma 73152-2000
Rule 165: 10-3-25

Form 1002A

API No.: 35085213370000

Completion Report

Spud Date: January 17, 2022

OTC Prod. Unit No.: 085-227712-0-0000

Drilling Finished Date: January 26, 2022

1st Prod Date: March 11, 2022

Completion Date: February 02, 2022

Drill Type: DIRECTIONAL HOLE

Min Gas Allowable: Yes

Well Name: CORSAIR 1-11

Purchaser/Measurer: CP ENERGY

Location: LOVE 11 8S 1W
SW NE NW SW
2270 FSL 730 FWL of 1/4 SEC
Latitude: 33.87400112 Longitude: -97.28018547
Derrick Elevation: 15 Ground Elevation: 692

First Sales Date: 03/22/2022

Operator: COMMAND ENERGY OPERATING LLC 24630

15 W 6TH ST STE 1300
TULSA, OK 74119

| Completion Type | | Location Exception | | Increased Density | |
|-----------------|---------------|---|--|--|--|
| X | Single Zone | Order No | | Order No | |
| | Multiple Zone | There are no Location Exception records to display. | | There are no Increased Density records to display. | |
| | Commingled | | | | |

| Casing and Cement | | | | | | | |
|-------------------|-------|--------|-------|------|------|-----|------------|
| Type | Size | Weight | Grade | Feet | PSI | SAX | Top of CMT |
| CONDUCTOR | 20 | | | 65 | | | SURFACE |
| SURFACE | 9 5/8 | 36 | J-55 | 750 | 250 | 285 | SURFACE |
| PRODUCTION | 5 1/2 | 17 | L-80 | 6740 | 1450 | 240 | 5400 |

| Liner | | | | | | | | |
|--|------|--------|-------|--------|-----|-----|-----------|--------------|
| Type | Size | Weight | Grade | Length | PSI | SAX | Top Depth | Bottom Depth |
| There are no Liner records to display. | | | | | | | | |

Total Depth: 6750

| Packer | |
|---|--------------|
| Depth | Brand & Type |
| There are no Packer records to display. | |

| Plug | |
|---------------------------------------|-----------|
| Depth | Plug Type |
| There are no Plug records to display. | |

| Initial Test Data |
|-------------------|
|-------------------|

| Test Date | Formation | Oil BBL/Day | Oil-Gravity (API) | Gas MCF/Day | Gas-Oil Ratio Cu FT/BBL | Water BBL/Day | Pumpin or Flowing | Initial Shut-In Pressure | Choke Size | Flow Tubing Pressure |
|--------------|-----------|-------------|-------------------|-------------|-------------------------|---------------|-------------------|--------------------------|------------|----------------------|
| Mar 16, 2022 | DEESE | 32 | 40 | 22 | 688 | 40 | PUMPING | | | |

| | |
|--|----------------|
| Completion and Test Data by Producing Formation | |
| Formation Name: DEESE | Code: 404DEESS |
| Class: OIL | |

| Spacing Orders | |
|----------------|-----------|
| Order No | Unit Size |
| 722267 | 40 |

| Perforated Intervals | |
|----------------------|------|
| From | To |
| 6512 | 6518 |
| 6536 | 6538 |
| 6540 | 6546 |

| Acid Volumes |
|--------------|
| NONE |

| Fracture Treatments |
|--|
| 45,066 GALLONS HVFR AND 51,763 POUNDS 16/30 SAND |

| Formation | Top |
|-----------|------|
| TAYLOR | 6263 |
| BEASLEY A | 6506 |
| WICHITA | 6546 |

Were open hole logs run? Yes
Date last log run: January 24, 2022

Were unusual drilling circumstances encountered? No
Explanation:

| |
|-----------------------------|
| Other Remarks |
| There are no Other Remarks. |

| |
|--|
| Bottom Holes |
| Sec: 11 TWP: 8S RGE: 1W County: LOVE SE NW NW SW 2052 FSL 594 FWL of 1/4 SEC Depth of Deviation: 0 Radius of Turn: 0 Direction: 0 Total Length: 0 Measured Total Depth: 6750 True Vertical Depth: 6740 End Pt. Location From Release, Unit or Property Line: 561 |

| | |
|--------------------------------|---------|
| FOR COMMISSION USE ONLY | |
| Status: Accepted | 1147761 |

API NO. 35-085 21337
OTC PROD. UNIT NO. 227712

Oil and Gas Conservation Division
P.O. Box 52000
Oklahoma City, OK 73152-2000
405-521-2331
OCCCentralProcessing@OCC.OK.GOV



OKLAHOMA
Corporation
Commission

Form 1002A
Rev. 2021

☒ ORIGINAL
☐ AMENDED (Reason)

Rule 185:10-3-25

COMPLETION REPORT

TYPE OF DRILLING OPERATION
☐ STRAIGHT HOLE ☒ DIRECTIONAL HOLE ☐ HORIZONTAL HOLE
☐ SERVICE WELL
If directional or horizontal, see reverse for bottom hole location.

SPUD DATE 1/17/2022
DRLG FINISHED DATE 1/26/2022
DATE OF WELL COMPLETION 2/2/2022
1st PROD DATE 3/11/2022

COUNTY Love SEC 11 TWP 8S RGE 1W
LEASE NAME Corsair WELL NO. 1-11

SW 1/4 NE 1/4 NW 1/4 SW 1/4 FSL 2,270' FWL 730'

ELEVATION Derrick Ft. 15' Ground 692' Latitude 33 52' 26.40"N Longitude -97 16' 48.67"W

OPERATOR NAME Command Energy Operating, LLC OTC / OCC OPERATOR NO. 24630

ADDRESS 15 W 6th street Suite 1300

CITY Tulsa STATE Ok ZIP 74119

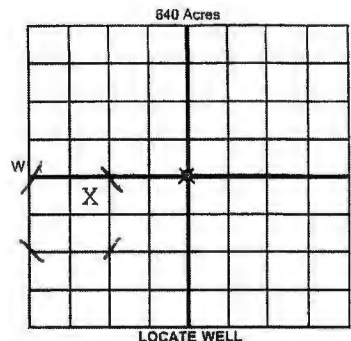

COMPLETION TYPE

☒ SINGLE ZONE
☐ MULTIPLE ZONE
☐ COMMINGLED
LOCATION EXCEPTION ORDER NO.
MULTIUNIT ORDER NO.
INCREASED DENSITY ORDER NO.

CASING & CEMENT (Attach Form 1002C)

| TYPE | SIZE | WEIGHT | GRADE | FEET | PSI | SAX | TOP OF CMT |
|--------------|--------|--------|-------|--------|-------|-----|------------|
| CONDUCTOR | 20" | | | 65' | | | Surface |
| SURFACE | 9 5/8" | 36# | J-55 | 750' | 250 | 285 | Surface |
| INTERMEDIATE | | | | | | | |
| PRODUCTION | 5 1/2" | 17# | L-80 | 6,740' | 1,450 | 240 | 5,400' |
| LINER | | | | | | | |

PACKER @ BRAND & TYPE PLUG @ TYPE PLUG @ TYPE
PACKER @ BRAND & TYPE PLUG @ TYPE PLUG @ TYPE

TOTAL DEPTH 6750 Per Survey to BHL

COMPLETION & TEST DATA BY PRODUCING FORMATION

| | | | | | | |
|---|---|--|--|--|--|------------------------|
| FORMATION | Deese | | | | | Reported to Trac Fours |
| SPACING & SPACING ORDER NUMBER | 40ac 722267 | | | | | |
| CLASS: Oil, Gas, Dry, Inj, Disp, Comm Disp, Svo | Oil | | | | | |
| PERFORATED INTERVALS | 6,512' - 6,518' 6,536' - 6,538' 6,540' - 6,546' | | | | | |
| ACID/VOLUME | X | | | | | |
| FRACTURE TREATMENT (Fluids/Prop Amounts) | 45,066 gals HVFR & 51,763# 16/30 sd | | | | | |



Min Gas Allowable (165:10-17-7)
OR
Oil Allowable (165:10-13-3)

Purchaser/Mesurer
First Sales Date

CP Energy
03/22/2022

INITIAL TEST DATA

| | | | | | | |
|--------------------------|------------|--|--|--|--|--|
| INITIAL TEST DATE | 03/16/2022 | | | | | |
| OIL-BBL/DAY | 32 | | | | | |
| OIL-GRAVITY (API) | 40 | | | | | |
| GAS-MCF/DAY | 22 | | | | | |
| GAS-OIL RATIO CU FT/BBL | 688 | | | | | |
| WATER-BBL/DAY | 40 | | | | | |
| PUMPING OR FLOWING | Pumping | | | | | |
| INITIAL SHUT-IN PRESSURE | XX | | | | | |
| CHOKE SIZE | XX | | | | | |
| FLOW TUBING PRESSURE | XX | | | | | |

A record of the formations drilled through, and pertinent remarks are presented on the reverse. I declare that I have knowledge of the contents of this report and am authorized by my organization to make this report, which was prepared by me or under my supervision and direction, with the data and facts stated herein to be true, correct, and complete to the best of my knowledge and belief.

James Lollar
SIGNATURE
15 west 6th street Suite 1300
ADDRESS
Tulsa
CITY
Ok
STATE
74119
ZIP
James Lollar
NAME (PRINT OR TYPE)
539-867-1887
DATE
PHONE NUMBER
j.lollar@cetulsa.com
EMAIL ADDRESS

PLEASE TYPE OR USE BLACK INK ONLY
FORMATION RECORD

Give formation names and tops, if available, or descriptions and thickness of formations drilled through. Show intervals cored or drillstem tested.

LEASE NAME Corsair WELL NO. 1-11

not recognized
by OGE →

| NAMES OF FORMATIONS | TOP |
|---------------------|--------|
| Kunkel sand (MD) | 6,119' |
| Taylor sand (MD) | 6,263' |
| Beasley A (MD) | 6,506' |
| Upper Wichita (MD) | 6,546' |
| Kunkel sand (TVD) | 6,110' |
| Taylor sand (TVD) | 6,253' |
| Beasley A (TVD) | 6,496' |
| Upper Wichita (TVD) | 6,536' |

FOR COMMISSION USE ONLY

ITD on file ☐ YES ☐ NO

APPROVED _____ DISAPPROVED _____

2) Reject Codes _____

Were open hole logs run? ☒ yes ☐ no

Date Last log was run 1/24/2022

Was CO₂ encountered? ☐ yes ☒ no at what depths? _____

Was H₂S encountered? ☐ yes ☒ no at what depths? _____

Were unusual drilling circumstances encountered? ☐ yes ☒ no

If yes, briefly explain below _____

Other remarks: _____

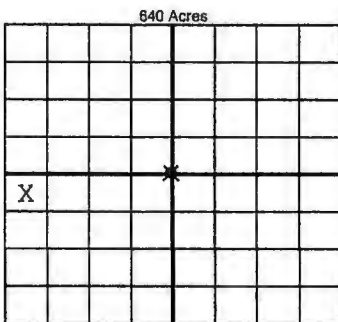

If more than three drainholes are proposed, attach a separate sheet indicating the necessary information.

Direction must be stated in degrees azimuth. Please note, the horizontal drainhole and its end point must be located within the boundaries of the lease or spacing unit.

Directional surveys are required for all drainholes and directional wells

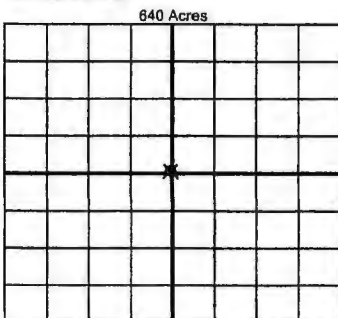

BOTTOM HOLE LOCATION FOR DIRECTIONAL HOLE

| | | | |
|---|--------|----------------------------|-------------|
| SEC 11 | TWP 8S | RGE 1W | COUNTY Love |
| SE 1/4 | NW 1/4 | NW 1/4 | SW 1/4 |
| Measured Total Depth 6,750' | | True Vertical Depth 6,740' | |
| Feet From 1/4 Sec Lines | | FSL 2052' | FNL 594' |
| BHL From Lease, Unit, or Property Line: 594' FWL & 561' FNL | | | |

BOTTOM HOLE LOCATION FOR HORIZONTAL HOLE: (LATERALS)

LATERAL #1

| | | | |
|-------------------------|---------------------|---|--------------|
| SEC | TWP | RGE | COUNTY |
| 1/4 | 1/4 | 1/4 | 1/4 |
| Feet From 1/4 Sec Lines | | | |
| Depth of Deviation | Radius of Turn | Direction | Total Length |
| Measured Total Depth | True Vertical Depth | BHL From Lease, Unit, or Property Line: | |

LATERAL #2

| | | | |
|-------------------------|---------------------|---|--------------|
| SEC | TWP | RGE | COUNTY |
| 1/4 | 1/4 | 1/4 | 1/4 |
| Feet From 1/4 Sec Lines | | | |
| Depth of Deviation | Radius of Turn | Direction | Total Length |
| Measured Total Depth | True Vertical Depth | BHL From Lease, Unit, or Property Line: | |

LATERAL #3

| | | | |
|-------------------------|---------------------|---|--------------|
| SEC | TWP | RGE | COUNTY |
| 1/4 | 1/4 | 1/4 | 1/4 |
| Feet From 1/4 Sec Lines | | | |
| Depth of Deviation | Radius of Turn | Direction | Total Length |
| Measured Total Depth | True Vertical Depth | BHL From Lease, Unit, or Property Line: | |