

Oklahoma Corporation Commission  
Oil & Gas Conservation Division  
Post Office Box 52000  
Oklahoma City, Oklahoma 73152-2000  
Rule 165: 10-3-25

Form 1002A

API No.: 35083244180001

**Completion Report**

Spud Date: November 15, 2017

OTC Prod. Unit No.: 083-227620-0-0000

Drilling Finished Date: November 24, 2017

**Amended**

1st Prod Date: January 20, 2022

Amend Reason: RECOMPLETION

Completion Date: January 08, 2018

Recomplete Date: January 19, 2022

**Drill Type: STRAIGHT HOLE**

Min Gas Allowable: Yes

Well Name: LEONA 1

Purchaser/Measurer:

Location: LOGAN 14 16N 2W  
C SW NE  
660 FSL 660 FWL of 1/4 SEC  
Latitude: 35.5155 Longitude: -97.376389  
Derrick Elevation: 0 Ground Elevation: 0

First Sales Date:

Operator: OEX-1 LLC 21164

4870 S LEWIS AVE STE 240  
TULSA, OK 74105-5153

Completion Type		Location Exception		Increased Density	
X	Single Zone	Order No		Order No	
	Multiple Zone	There are no Location Exception records to display.		There are no Increased Density records to display.	
	Commingled				

Casing and Cement							
Type	Size	Weight	Grade	Feet	PSI	SAX	Top of CMT
SURFACE	8 5/8			548			SURFACE
PRODUCTION	5 1/2			5653			4370

Liner								
Type	Size	Weight	Grade	Length	PSI	SAX	Top Depth	Bottom Depth
There are no Liner records to display.								

**Total Depth: 5665**

Packer		Plug	
Depth	Brand & Type	Depth	Plug Type
There are no Packer records to display.		4900	CBP

Initial Test Data
-------------------

Test Date	Formation	Oil BBL/Day	Oil-Gravity (API)	Gas MCF/Day	Gas-Oil Ratio Cu FT/BBL	Water BBL/Day	Pumpin or Flowing	Initial Shut-In Pressure	Choke Size	Flow Tubing Pressure
Jan 20, 2022	CLEVELAND	5				5	PUMPING			

Completion and Test Data by Producing Formation										
Formation Name: CLEVELAND				Code: 405CLVD				Class: OIL		
Spacing Orders				Perforated Intervals						
Order No		Unit Size		From			To			
674630		160		4764			4772			
Acid Volumes				Fracture Treatments						
1,200 GALLONS ACID				375 BARRELS FLUID, 23,760 POUNDS SAND						

Formation	Top
CLEVELAND	4698
SKINNER	5346
MISENER	5518
HUNTON	5530

Were open hole logs run? Yes  
Date last log run: December 06, 2021  
  
Were unusual drilling circumstances encountered? No  
Explanation:

Other Remarks
There are no Other Remarks.

FOR COMMISSION USE ONLY
<div>Status: Accepted</div> <div>1147715</div>

API NO. 35-083-24418  
OTC PROD. UNIT NO. 083-221620

Oil and Gas Conservation Division  
P.O. Box 52000  
Oklahoma City, OK 73152-2000  
405-521-2331  
OCCentralProcessing@OCC.OK.GOV



OKLAHOMA  
Corporation  
Commission

Form 1002A  
Rev. 2020

8 ORIGINAL  
8 AMENDED (Reason) Recompletion

Rule 165:10-3-25

COMPLETION REPORT

TYPE OF DRILLING OPERATION

☒ STRAIGHT HOLE ☐ DIRECTIONAL HOLE ☐ HORIZONTAL HOLE  
☐ SERVICE WELL

If directional or horizontal, see reverse for bottom hole location.

COUNTY Logan SEC 14 TWP 16N RGE 02W  
LEASE NAME LEONA WELL NO. 1  
1/4 C 1/4 SW 1/4 NE 1/4 FSL 660 FWL 660  
ELEVATION Ground Latitude 97.376389 Longitude -35.515500  
OPERATOR NAME OEX-1, LLC OCC / OCC OPERATOR NO. 21164  
ADDRESS 4870 S Lewis Ave, Suite 240  
CITY Tulsa STATE OK ZIP 74105

SPUD DATE 11/15/2017  
DRLG FINISHED DATE 11/24/2017  
DATE OF WELL COMPLETION 1/8/2018  
1st PROD DATE 1/20/2022  
RECOMP DATE 1/19/2022

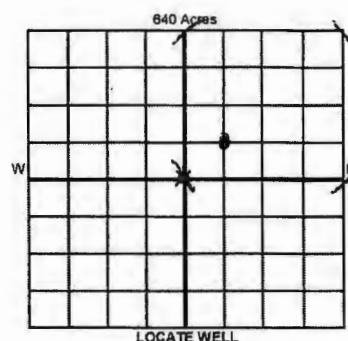

COMPLETION TYPE

☒ SINGLE ZONE  
☐ MULTIPLE ZONE  
☐ COMMINGLED  
LOCATION EXCEPTION ORDER NO.  
MULTIUNIT ORDER NO.  
INCREASED DENSITY ORDER NO.

CASING & CEMENT (Attach Form 1002C)

TYPE	SIZE	WEIGHT	GRADE	FEET	PSI	SAX	TOP OF CMT
CONDUCTOR							
SURFACE	8 5/8			548			Surface
INTERMEDIATE							
PRODUCTION	5 1/2			5653			4370
LINER							

PACKER @            BRAND & TYPE            PLUG @ 4900' TYPE CBP PLUG @            TYPE            TOTAL DEPTH 5665  
PACKER @            BRAND & TYPE            PLUG @            TYPE            PLUG @            TYPE           

COMPLETION & TEST DATA BY PRODUCING FORMATION

FORMATION	<u>Cleveland</u>					
SPACING & SPACING ORDER NUMBER	<u>160 ares- 674630</u>					
CLASS: Oil, Gas, Dry, Inj, Disp, Comm Disp, Svc	<u>Oil</u>					
PERFORATED INTERVALS	<u>4764-4772</u>					
ACID/VOLUME	<u>1200 gal acid</u>					
FRACTURE TREATMENT (Fluids/Prop Amounts)	<u>375 bbls fluid, 23,760# sand</u>					

*Report to FracFocus*

RECEIVED  
MAR 14 2022

OKLAHOMA CORPORATION  
COMMISSION



Min Gas Allowable (165:10-17-7)  
OR  
Oil Allowable (165:10-13-3)

Purchaser/Measureur  
First Sales Date

INITIAL TEST DATA

INITIAL TEST DATE	<u>1/20/2022</u>					
OIL-BBL/DAY	<u>5</u>					
OIL-GRAVITY (API)						
GAS-MCF/DAY	<u>0</u>					
GAS-OIL RATIO CU FT/BBL	<u>0</u>					
WATER-BBL/DAY	<u>5</u>					
PUMPING OR FLOWING	<u>Pumping</u>					
INITIAL SHUT-IN PRESSURE						
CHOKE SIZE						
FLOW TUBING PRESSURE						

A record of the formations drilled through, and pertinent remarks are presented on the reverse. I declare that I have knowledge of the contents of this report and am authorized by my organization to make this report, which was prepared by me or under my supervision and direction, with the data and facts stated herein to be true, correct, and complete to the best of my knowledge and belief.

SIGNATURE John Brown NAME (PRINT OR TYPE) John Brown DATE 3/9/2022 PHONE NUMBER 918-492-0254  
ADDRESS 4870 S Lewis Ave, Suite 240 CITY Tulsa STATE OK ZIP 74105 EMAIL ADDRESS john@orionexploration.com

PLEASE TYPE OR USE BLACK INK ONLY  
FORMATION RECORD

Give formation names and tops, if available, or descriptions and thickness of formations drilled through. Show intervals cored or drillstem tested.

NAMES OF FORMATIONS	TOP
Cleveland	4698
Skinner	5346
Misener	5518
Hunton	5530

LEASE NAME LEONA WELL NO. 1

FOR COMMISSION USE ONLY	
ITD on file <input type="checkbox"/> YES <input type="checkbox"/> NO	
APPROVED _____	DISAPPROVED _____
2) Reject Codes	
_____	
_____	
_____	
_____	

Were open hole logs run?	<input checked="" type="radio"/> yes <input type="radio"/> no
Date Last log was run	12-6-2021
Was CO <sub>2</sub> encountered?	<input type="radio"/> yes <input type="radio"/> no at what depths? _____
Was H <sub>2</sub> S encountered?	<input type="radio"/> yes <input type="radio"/> no at what depths? _____
Were unusual drilling circumstances encountered?	<input type="radio"/> yes <input type="radio"/> no
If yes, briefly explain below	

Other remarks: \_\_\_\_\_

\_\_\_\_\_

\_\_\_\_\_

\_\_\_\_\_

\_\_\_\_\_

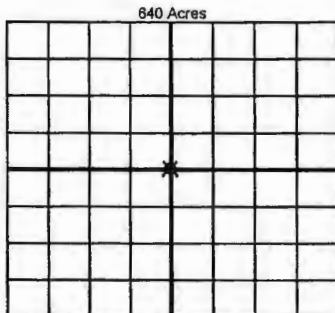

If more than three drainholes are proposed, attach a separate sheet indicating the necessary information.

Direction must be stated in degrees azimuth. Please note, the horizontal drainhole and its end point must be located within the boundaries of the lease or spacing unit.

Directional surveys are required for all drainholes and directional wells

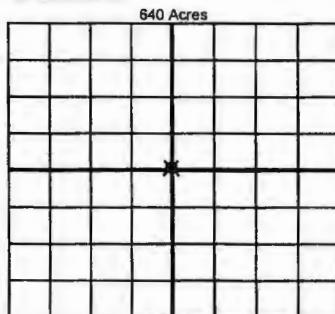

BOTTOM HOLE LOCATION FOR DIRECTIONAL HOLE

SEC	TWP	RGE	COUNTY
1/4	1/4	1/4	1/4
Measured Total Depth		True Vertical Depth	Feet From 1/4 Sec Lines BHL From Lease, Unit, or Property Line:

BOTTOM HOLE LOCATION FOR HORIZONTAL HOLE: (LATERALS)

LATERAL #1			
SEC	TWP	RGE	COUNTY
1/4	1/4	1/4	1/4
Depth of Deviation		Radius of Turn	Direction
Measured Total Depth		True Vertical Depth	Total Length
		BHL From Lease, Unit, or Property Line:	

LATERAL #2			
SEC	TWP	RGE	COUNTY
1/4	1/4	1/4	1/4
Depth of Deviation		Radius of Turn	Direction
Measured Total Depth		True Vertical Depth	Total Length
		BHL From Lease, Unit, or Property Line:	

LATERAL #3			
SEC	TWP	RGE	COUNTY
1/4	1/4	1/4	1/4
Depth of Deviation		Radius of Turn	Direction
Measured Total Depth		True Vertical Depth	Total Length
		BHL From Lease, Unit, or Property Line:	