

Oklahoma Corporation Commission
Oil & Gas Conservation Division
Post Office Box 52000
Oklahoma City, Oklahoma 73152-2000
Rule 165: 10-3-25

Form 1002A

API No.: 35151245520000

Completion Report

Spud Date: December 12, 2018

OTC Prod. Unit No.: 151-225148-0-0000

Drilling Finished Date: December 24, 2018

1st Prod Date: February 16, 2019

Completion Date: January 29, 2019

Drill Type: STRAIGHT HOLE

Well Name: KAMAS 12-32

Purchaser/Measurer:

Location: WOODS 32 29N 17W
W2 W2 E2 W2
2640 FSL 1335 FWL of 1/4 SEC
Derrick Elevation: 1934 Ground Elevation: 1924

First Sales Date:

Operator: POLLOK ENERGY LLC 23163
PO BOX 106
501 N 4TH ST
PURCELL, OK 73080-0106

Completion Type		Location Exception		Increased Density	
X	Single Zone	Order No		Order No	
	Multiple Zone	There are no Location Exception records to display.		There are no Increased Density records to display.	
	Commingled				

Casing and Cement							
Type	Size	Weight	Grade	Feet	PSI	SAX	Top of CMT
CONDUCTOR	20			62			SURFACE
SURFACE	8 5/8	24	J-55	808		400	SURFACE
PRODUCTION	4 1/2	10.5	J-55	5622		300	3607

Liner								
Type	Size	Weight	Grade	Length	PSI	SAX	Top Depth	Bottom Depth
There are no Liner records to display.								

Total Depth: 5643

Packer		Plug	
Depth	Brand & Type	Depth	Plug Type
5351	MODEL R	There are no Plug records to display.	

Initial Test Data

Test Date	Formation	Oil BBL/Day	Oil-Gravity (API)	Gas MCF/Day	Gas-Oil Ratio Cu FT/BBL	Water BBL/Day	Pumpin or Flowing	Initial Shut-In Pressure	Choke Size	Flow Tubing Pressure
Jun 28, 2019	MISSISSIPPIAN	6	37.3	50	8333	50	PUMPING			

Completion and Test Data by Producing Formation

Formation Name: MISSISSIPPIAN

Code: 359MSSP

Class: OIL

Spacing Orders

Order No

Unit Size

265303

640

Perforated Intervals

From

To

5430

5520

Acid Volumes

4,000 GALLONS, 10,318 BARRELS SLICKWATER

Fracture Treatments

There are no Fracture Treatments records to display.

Formation	Top
BASE HEEBNER	4472
LANSING	4661
CHEROKEE	5360
MISSISSIPPIAN	5438

Were open hole logs run? Yes

Date last log run:

Were unusual drilling circumstances encountered? No

Explanation:

Other Remarks

There are no Other Remarks.

FOR COMMISSION USE ONLY

Status: Accepted

1143558

API NO. 3515124552
OTC PROD. UNIT NO. 151225148

(PLEASE TYPE OR USE BLACK INK ONLY)

OKLAHOMA CORPORATION COMMISSION

Oil & Gas Conservation Division

Post Office Box 52000

Oklahoma City, Oklahoma 73152-2000

Rule 165:10-3-25

COMPLETION REPORT

RECEIVED

JUL 19 2019

OKLAHOMA CORPORATION COMMISSION

Form 1002A

Rev. 2009

☒ ORIGINAL
☐ AMENDED (Reason)

TYPE OF DRILLING OPERATION

☒ STRAIGHT HOLE ☐ DIRECTIONAL HOLE ☐ HORIZONTAL HOLE
☐ SERVICE WELL

If directional or horizontal, see reverse for bottom hole location.

COUNTY Woods SEC 32 TWP 29N RGE 17W
LEASE NAME Kamas WELL NO. 12-32
W2 1/4 W2 1/4 E2 1/4 W2 1/4 FSL OF 1/4 SEC 2,640' FWL OF 1/4 SEC 1,335'
ELEVATION Derrick FL 1,934' Ground 1,924' Latitude (if known) Longitude (if known)
OPERATOR NAME Pollok Energy, LLC. OTC/OCC OPERATOR NO. 23163
ADDRESS P.O. Box 106
CITY Purcell STATE OK ZIP 73080

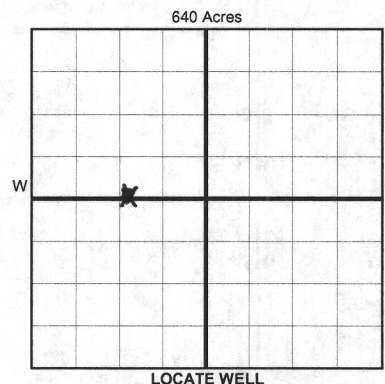

COMPLETION TYPE

☒ SINGLE ZONE
☐ MULTIPLE ZONE
Application Date
COMMINGLED
Application Date
LOCATION EXCEPTION
ORDER NO.
INCREASED DENSITY
ORDER NO.

CASING & CEMENT (Form 1002C must be attached)

TYPE	SIZE	WEIGHT	GRADE	FEET	PSI	SAX	TOP OF CMT
CONDUCTOR	20"			62'			Surface
SURFACE	8 5/8"	24#	J-55	808'		400	Surface
INTERMEDIATE							
PRODUCTION	4 1/2"	10.5#	J-55	5,622		250 300	3607
LINER							
TOTAL DEPTH							5,643

PACKER @ 5,351 BRAND & TYPE Model R PLUG @ TYPE PLUG @ TYPE
PACKER @ BRAND & TYPE PLUG @ TYPE PLUG @ TYPE

COMPLETION & TEST DATA BY PRODUCING FORMATION

FORMATION Mississippian
SPACING & SPACING ORDER NUMBER 265303 (640 acres)
CLASS: Oil, Gas, Dry, Inj, Disp, Comm Disp, Svc Gas oil per GOR
PERFORATED INTERVALS 5,488'-5,520'
5,430'-5,474'
ACID/VOLUME 4,000 gals
10318 bbl slickwater
FRACTURE TREATMENT (Fluids/Prop Amounts)

Min Gas Allowable (165:10-17-7)

Gas Purchaser/Measurer

OR

First Sales Date

INITIAL TEST DATA

Oil Allowable (165:10-13-3)

INITIAL TEST DATE 6/28/2019
OIL-BBL/DAY 6
OIL-GRAVITY (API) 37.3
GAS-MCF/DAY 50
GAS-OIL RATIO CU FT/BBL 8.3:1 8333
WATER-BBL/DAY 50
PUMPING OR FLOWING Pumping
INITIAL SHUT-IN PRESSURE
CHOKE SIZE
FLOW TUBING PRESSURE

AS SUBMITTED

A record of the formations drilled through, and pertinent remarks are presented on the reverse. I declare that I have knowledge of the contents of this report and am authorized by my organization to make this report, which was prepared by me or under my supervision and direction, with the data and facts stated herein to be true, correct, and complete to the best of my knowledge and belief.

SIGNATURE Mike Pollok
ADDRESS PO Box 106
CITY Purcell
STATE OK
ZIP 73080
DATE 7/1/2019
PHONE NUMBER 918-620-6719
EMAIL ADDRESS pollokenergy@gmail.com

PLEASE TYPE OR USE BLACK INK ONLY
FORMATION RECORD

Give formation names and tops, if available, or descriptions and thickness of formations drilled through. Show intervals cored or drillstem tested.

LEASE NAME

Kansas

WELL NO.

12-32

NAMES OF FORMATIONS	TOP
Base Heebner	4,472'
Lansing	4,661'
Cherokee	5,360'
Mississippian	5,438'

FOR COMMISSION USE ONLY		
ITD on file	<input type="checkbox"/> YES	<input type="checkbox"/> NO
APPROVED	DISAPPROVED	2) Reject Codes

Were open hole logs run?	<u>X</u> yes	no
Date Last log was run		
Was CO ₂ encountered?	yes	<u>X</u> no at what depths? <u> </u>
Was H ₂ S encountered?	yes	<u>X</u> no at what depths? <u> </u>
Were unusual drilling circumstances encountered?	yes	<u>X</u> no
If yes, briefly explain below		

Other remarks:

640 Acres

If more than three drainholes are proposed, attach a separate sheet indicating the necessary information.

Direction must be stated in degrees azimuth. Please note, the horizontal drainhole and its end point must be located within the boundaries of the lease or spacing unit.

Directional surveys are required for all drainholes and directional wells.

640 Acres

BOTTOM HOLE LOCATION FOR DIRECTIONAL HOLE

SEC	TWP	RGE	COUNTY
Spot Location	1/4	1/4	1/4
Measured Total Depth	True Vertical Depth		BHL From Lease, Unit, or Property Line:
Feet From 1/4 Sec Lines	FSL	FWL	

BOTTOM HOLE LOCATION FOR HORIZONTAL HOLE: (LATERALS)

LATERAL #1

SEC	TWP	RGE	COUNTY
Spot Location	1/4	1/4	1/4
Depth of Deviation	Radius of Turn	Direction	Total Length
Measured Total Depth	True Vertical Depth		BHL From Lease, Unit, or Property Line:
Feet From 1/4 Sec Lines	FSL	FWL	

LATERAL #2

SEC	TWP	RGE	COUNTY
Spot Location	1/4	1/4	1/4
Depth of Deviation	Radius of Turn	Direction	Total Length
Measured Total Depth	True Vertical Depth		BHL From Lease, Unit, or Property Line:
Feet From 1/4 Sec Lines	FSL	FWL	

LATERAL #3

SEC	TWP	RGE	COUNTY
Spot Location	1/4	1/4	1/4
Depth of Deviation	Radius of Turn	Direction	Total Length
Measured Total Depth	True Vertical Depth		BHL From Lease, Unit, or Property Line:
Feet From 1/4 Sec Lines	FSL	FWL	