

Oklahoma Corporation Commission
Oil & Gas Conservation Division
Post Office Box 52000
Oklahoma City, Oklahoma 73152-2000
Rule 165: 10-3-25

Form 1002A

API No.: 35117237060000

Completion Report

Spud Date: November 14, 2019

OTC Prod. Unit No.: 117-226588-0-0000

Drilling Finished Date: November 20, 2019

1st Prod Date: January 04, 2020

Completion Date: January 02, 2020

Drill Type: STRAIGHT HOLE

Well Name: GLENCOE 9-31

Purchaser/Measurer:

Location: PAWNEE 31 21N 4E
NW SW SE NE
2229 FNL 1150 FEL of 1/4 SEC
Derrick Elevation: 1030 Ground Elevation: 1024

First Sales Date:

Operator: ARUBA PETROLEUM INC 24083

555 REPUBLIC DR STE 505
PLANO, TX 75074-8865

Completion Type		Location Exception		Increased Density	
X	Single Zone	Order No		Order No	
	Multiple Zone	There are no Location Exception records to display.		There are no Increased Density records to display.	
	Commingled				

Casing and Cement							
Type	Size	Weight	Grade	Feet	PSI	SAX	Top of CMT
SURFACE	8 5/8	32	J-55	535		305	SURFACE
PRODUCTION	5 1/2	17	N-80	3414		100	2814

Liner								
Type	Size	Weight	Grade	Length	PSI	SAX	Top Depth	Bottom Depth
There are no Liner records to display.								

Total Depth: 3430

Packer		Plug	
Depth	Brand & Type	Depth	Plug Type
There are no Packer records to display.		There are no Plug records to display.	

Initial Test Data										
Test Date	Formation	Oil BBL/Day	Oil-Gravity (API)	Gas MCF/Day	Gas-Oil Ratio Cu FT/BBL	Water BBL/Day	Pumpin or Flowing	Initial Shut-In Pressure	Choke Size	Flow Tubing Pressure
Jan 02, 2020	CLEVELAND	46	44	16	348	386	PUMPING	440		

Completion and Test Data by Producing Formation

Formation Name: CLEVELAND

Code: 405CLVD

Class: OIL

Spacing Orders

Order No	Unit Size
UNSPACED	

Perforated Intervals

From	To
3242	3324

Acid Volumes

3,000 GALLONS NE / HCL

Fracture Treatments

30,500 POUNDS 20/40 SAND, 49,500 POUNDS 16/30 SAND
--

Formation	Top
UPPER TONKAWA	1698
LOWER TONKAWA	2005
DEWEY LS	2455
CHECKERBOARD LIME	3128
CLEVELAND SST	3240
BIG LIME	3356

Were open hole logs run? Yes

Date last log run: December 12, 2019

Were unusual drilling circumstances encountered? No

Explanation:

Other Remarks

There are no Other Remarks.

FOR COMMISSION USE ONLY

1144708

Status: Accepted

API NO. 35-117-23706
OTC PROD.
UNIT NO. 117-226588

(PLEASE TYPE OR USE BLACK INK ONLY)

OKLAHOMA CORPORATION COMMISSION
Oil & Gas Conservation Division
Post Office Box 52000
Oklahoma City, Oklahoma 73152-2000
Rule 165:10-3-25

RECEIVED

Form 1002A
Rev. 2009

JAN 23 2020

☒ ORIGINAL
☐ AMENDED (Reason) _____

COMPLETION REPORT

TYPE OF DRILLING OPERATION

☒ STRAIGHT HOLE ☐ DIRECTIONAL HOLE ☐ HORIZONTAL HOLE
☐ SERVICE WELL

If directional or horizontal, see reverse for bottom hole location.

COUNTY	PAWNEE	SEC	31	TWP	21N	RGE	04E	SPUD DATE	11/14/2019
LEASE NAME	GLENCOE			WELL NO.	9-31			DRLG FINISHED DATE	11/20/2019
NW 1/4 SW 1/4 SE 1/4 NE 1/4	FNL OF 1/4 SEC 2229			FEL OF 1/4 SEC	1150			DATE OF WELL COMPLETION	01/02/2020
ELEVATION Derrick FL	1030	Ground	1024	Latitude (if known)	36.25479N			1st PROD DATE	01/04/2020
OPERATOR NAME	ARUBA PETROLEUM, INC.			OTC / OCC OPERATOR NO.	24083				
ADDRESS	555 REPUBLIC DRIVE SUITE 505								
CITY	PLANO			STATE	TX	ZIP	75074		

OKLAHOMA CORPORATION COMMISSION

LOCATE WELL

COMPLETION TYPE

<input checked="" type="checkbox"/> SINGLE ZONE	
<input type="checkbox"/> MULTIPLE ZONE	
Application Date	
<input type="checkbox"/> COMMINGLED	
Application Date	
LOCATION EXCEPTION ORDER NO.	
INCREASED DENSITY ORDER NO.	

CASING & CEMENT (Attach Form 1002C)

TYPE	SIZE	WEIGHT	GRADE	FEET	PSI	SAX	TOP OF CMT
CONDUCTOR							
SURFACE	8 5/8	32#	J55	535		305	SURFACE
INTERMEDIATE							
PRODUCTION	5 1/2	17#	N80	3414		100	2814
LINER							
						TOTAL DEPTH	3,430

PACKER @ _____ BRAND & TYPE _____ PLUG @ _____ TYPE _____ PLUG @ _____ TYPE _____
PACKER @ _____ BRAND & TYPE _____ PLUG @ _____ TYPE _____ PLUG @ _____ TYPE _____

COMPLETION & TEST DATA BY PRODUCING FORMATION

FORMATION	CLEVELAND EST						
SPACING & SPACING ORDER NUMBER	UNSPACED						
CLASS: Oil, Gas, Dry, Inj, Disp, Comm Disp, Svc	OIL						
PERFORATED INTERVALS	3242-3270						
	3274-3292						
	3294-3324						
ACID/VOLUME	3000GAL NE/HCL						
FRACTURE TREATMENT (Fluids/Prop Amounts)	30,500# 20/40 SAND						
	49,500# 16/30 SAND						

Min Gas Allowable (165:10-17-7)

Gas Purchaser/Measurer

INITIAL TEST DATA

OR
Oil Allowable (165:10-13-3)

First Sales Date

INITIAL TEST DATE	1/2/2020						
OIL-BBL/DAY	46						
OIL-GRAVITY (API)	44						
GAS-MCF/DAY	16						
GAS-OIL RATIO CU FT/BBL	1600.01:00 348						
WATER-BBL/DAY	386						
PUMPING OR FLOWING	PUMPING						
INITIAL SHUT-IN PRESSURE	440						
CHOKE SIZE							
FLOW TUBING PRESSURE							

A record of the formations drilled through, and pertinent remarks are presented on the reverse. I declare that I have knowledge of the contents of this report and am authorized by my organization to make this report, which was prepared by me or under my supervision and direction, with the data and facts stated herein to be true, correct, and complete to the best of my knowledge and belief.

KATHERINE DRISKELL

1/16/2020 972-312-9366

SIGNATURE

NAME (PRINT OR TYPE)

DATE

PHONE NUMBER

555 REPUBLIC DRIVE SUITE 505

PLANO

TX

75074

kkd@arubapetroleum.com

ADDRESS

CITY

STATE

ZIP

EMAIL ADDRESS

PLEASE TYPE OR USE BLACK INK ONLY

FORMATION RECORD

Give formation names and tops, if available, or descriptions and thickness of formations drilled through. Show intervals cored or drillstem tested.

NAMES OF FORMATIONS	TOP
UPPER TONKAWA	1,698
LOWER TONKAWA	2,005
DEWEY LS	2455
CHECKERBOARD LM	3,128
CLEVELAND SST	3,240
BIG LM	3,356

LEASE NAME GLENCOE WELL NO. 9-31

FOR COMMISSION USE ONLY	
ITD on file <input type="checkbox"/> YES <input type="checkbox"/> NO	
APPROVED <input type="checkbox"/> DISAPPROVED <input type="checkbox"/>	2) Reject Codes

Were open hole logs run?	<input checked="" type="checkbox"/> yes <input type="checkbox"/> no
Date Last log was run	<u>CBL - 12/12/2019</u>
Was CO ₂ encountered?	<input type="checkbox"/> yes <input checked="" type="checkbox"/> no at what depths? <u></u>
Was H ₂ S encountered?	<input type="checkbox"/> yes <input checked="" type="checkbox"/> no at what depths? <u></u>
Were unusual drilling circumstances encountered?	<input type="checkbox"/> yes <input checked="" type="checkbox"/> no
If yes, briefly explain below	

Other remarks:

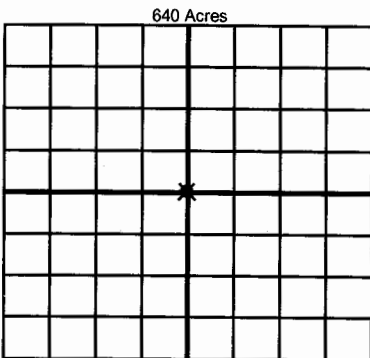

If more than three drainholes are proposed, attach a separate sheet indicating the necessary information.

Direction must be stated in degrees azimuth. Please note, the horizontal drainhole and its end point must be located within the boundaries of the lease or spacing unit.

Directional surveys are required for all drainholes and directional wells.

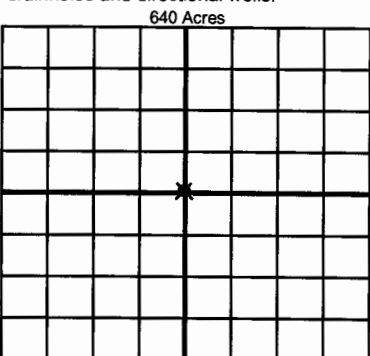

BOTTOM HOLE LOCATION FOR DIRECTIONAL HOLE

SEC	TWP	RGE	COUNTY
Spot Location			
1/4	1/4	1/4	1/4
Measured Total Depth		True Vertical Depth	BHL From Lease, Unit, or Property Line:

BOTTOM HOLE LOCATION FOR HORIZONTAL HOLE: (LATERALS)

LATERAL #1			
SEC	TWP	RGE	COUNTY
Spot Location			
1/4	1/4	1/4	1/4
Depth of Deviation		Radius of Turn	Direction
Measured Total Depth		True Vertical Depth	BHL From Lease, Unit, or Property Line:

LATERAL #2			
SEC	TWP	RGE	COUNTY
Spot Location			
1/4	1/4	1/4	1/4
Depth of Deviation		Radius of Turn	Direction
Measured Total Depth		True Vertical Depth	BHL From Lease, Unit, or Property Line:

LATERAL #3			
SEC	TWP	RGE	COUNTY
Spot Location			
1/4	1/4	1/4	1/4
Depth of Deviation		Radius of Turn	Direction
Measured Total Depth		True Vertical Depth	BHL From Lease, Unit, or Property Line: