

Oklahoma Corporation Commission
Oil & Gas Conservation Division
Post Office Box 52000
Oklahoma City, Oklahoma 73152-2000
Rule 165: 10-3-25

Form 1002A

API No.: 35151245800000

Completion Report

Spud Date: October 29, 2019

OTC Prod. Unit No.: 151-226430-0-0000

Drilling Finished Date: November 15, 2019

1st Prod Date: January 04, 2020

Completion Date: December 06, 2019

Drill Type: HORIZONTAL HOLE

Well Name: NORTHERN LIGHTS 1-35-26 XH

Purchaser/Measurer:

Location: WOODS 35 23N 13W
NW NE NW SW
2607 FSL 700 FWL of 1/4 SEC
Latitude: 36.427101 Longitude: -98.566699
Derrick Elevation: 1356 Ground Elevation: 1340

First Sales Date:

Operator: BLAKE PRODUCTION COMPANY INC 18119

1601 NW EXPRESSWAY STE 777
OKLAHOMA CITY, OK 73118-1446

Completion Type	
X	Single Zone
	Multiple Zone
	Commingled

Location Exception	
Order No	
705464	

Increased Density	
Order No	
NONE	

Casing and Cement							
Type	Size	Weight	Grade	Feet	PSI	SAX	Top of CMT
CONDUCTOR	20			80			
SURFACE	13 3/8	48.5	J-55	472	180	335	SURFACE
INTERMEDIATE	7	26	P-110	6619	700	175	4300
PRODUCTION	4 1/2	13.5	P-110	11104		490	3600

Liner								
Type	Size	Weight	Grade	Length	PSI	SAX	Top Depth	Bottom Depth
There are no Liner records to display.								

Total Depth: 11111

Packer	
Depth	Brand & Type
There are no Packer records to display.	

Plug	
Depth	Plug Type
There are no Plug records to display.	

Initial Test Data

Test Date	Formation	Oil BBL/Day	Oil-Gravity (API)	Gas MCF/Day	Gas-Oil Ratio Cu FT/BBL	Water BBL/Day	Pumpin or Flowing	Initial Shut-In Pressure	Choke Size	Flow Tubing Pressure
Feb 05, 2020	OSWEGO	28	42	53	1893	535	PUMPING			

Completion and Test Data by Producing Formation

Formation Name: OSWEGO

Code: 404OSWG

Class: OIL

Spacing Orders

Order No	Unit Size
700145	320

Perforated Intervals

From	To
6550	11059

Acid Volumes

3,972 BARRELS

Fracture Treatments

48,500 BARRELS WATER, 800,000 POUNDS PROPPANT

Formation	Top
TONKAWA	5300
COTTAGE GROVE	5712
HOGSHOOTER	5871
CHECKERBOARD	6033
BIG LIME	6155
OSWEGO	6198

Were open hole logs run? No

Date last log run:

Were unusual drilling circumstances encountered? No

Explanation:

Other Remarks

OCC - THE SPACING ORDER IS FOR AN IRREGULAR 320 ACRE SPACED UNIT COMPRISING SW/4 SEC 26 AND NW/4 SEC 35 OF 23N-13W. OCC - THIS DOCUMENT IS ACCEPTED BASED ON THE DATA SUBMITTED THE FINAL LOCATION EXCEPTION HAS NOT BEEN SUBMITTED.

Lateral Holes

Sec: 26 TWP: 23N RGE: 13W County: WOODS

SE NW NW SW

334 FNL 337 FWL of 1/4 SEC

Depth of Deviation: 5743 Radius of Turn: 807 Direction: 356 Total Length: 4561

Measured Total Depth: 11111 True Vertical Depth: 6200 End Pt. Location From Release, Unit or Property Line: 334

FOR COMMISSION USE ONLY

Status: Accepted

1144808

API NO. 35-151-24580
OTC PROD. UNIT NO. 151-226430

(PLEASE TYPE OR USE BLACK INK ONLY)

OKLAHOMA CORPORATION COMMISSION

Oil & Gas Conservation Division
Post Office Box 52000

Oklahoma City, Oklahoma 73152-2000
Rule 165:10-3-25

RECEIVED

Form 1002A
Rev. 2009

MAR 04 2020

☒ ORIGINAL
☐ AMENDED (Reason)

COMPLETION REPORT

TYPE OF DRILLING OPERATION

☐ STRAIGHT HOLE ☐ DIRECTIONAL HOLE ☒ HORIZONTAL HOLE
☐ SERVICE WELL

If directional or horizontal, see reverse for bottom hole location.

COUNTY Woods SEC 35 TWP 23N RGE 13W
LEASE NAME Northern Lights
NW 1/4 NE 1/4 NW 1/4 SW 1/4
ELEVATION 1356' Ground 1340' Latitude (if known) 36.427101 Longitude (if known) -98.566699
OPERATOR NAME Blake Production Company, Inc. OTC / OCC OPERATOR NO. 18119
ADDRESS 1601 NW Expressway, Ste 777
CITY Oklahoma City STATE OK ZIP 73118

SPUD DATE 10/29/2019
DRLG FINISHED DATE 11/15/2019
DATE OF WELL COMPLETION 12/6/2019
1st PROD DATE 1/4/2020
RECOMP DATE
WELL NO. 1-35-26XH
FWL OF 1/4 SEC 700'

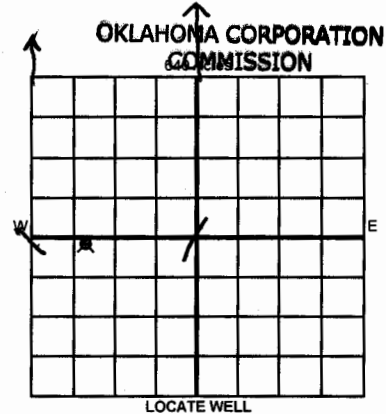

COMPLETION TYPE

☒ SINGLE ZONE
☐ MULTIPLE ZONE
☐ COMMINGLED
LOCATION EXCEPTION ORDER NO. 705464 Ind.
INCREASED DENSITY ORDER NO. None

CASING & CEMENT (Attach Form 1002C)

TYPE	SIZE	WEIGHT	GRADE	FEET	PSI	SAX	TOP OF CMT
CONDUCTOR	20"			80			
SURFACE	13-3/8"	48.5	J-55	472	180	335	Surface
INTERMEDIATE	7"	26	P-110	6,619	700	175	4,300
PRODUCTION	4-1/2"	13.5	P-110	11,104		490	3,600
LINER							
TOTAL DEPTH							11,111

PACKER @ _____ BRAND & TYPE _____ PLUG @ _____ TYPE _____ PLUG @ _____ TYPE _____
PACKER @ _____ BRAND & TYPE _____ PLUG @ _____ TYPE _____ PLUG @ _____ TYPE _____

COMPLETION & TEST DATA BY PRODUCING FORMATION

FORMATION	Oswego						
SPACING & SPACING ORDER NUMBER	840 - 700145 (320)						Reported to Frac Focus
CLASS: Oil, Gas, Dry, Inj, Disp, Comm Disp, Svc	Oil						
PERFORATED INTERVALS	6,550-11,059						
ACID/VOLUME	3972 bbls						
FRACTURE TREATMENT (Fluids/Prop Amounts)	48,500 bbls water 800,000 # proppant						

☐ Min Gas Allowable (165:10-17-7)
OR
☐ Oil Allowable (165:10-13-3)

Gas Purchaser/Measurer
First Sales Date

INITIAL TEST DATA

INITIAL TEST DATE	2/5/2020					
OIL-BBL/DAY	28					
OIL-GRAVITY (API)	42					
GAS-MCF/DAY	53					
GAS-OIL RATIO CU FT/BBL	1893					
WATER-BBL/DAY	535					
PUMPING OR FLOWING	pumping					
INITIAL SHUT-IN PRESSURE						
CHOKE SIZE						
FLOW TUBING PRESSURE						

A record of the formations drilled through, and pertinent remarks are presented on the reverse. I declare that I have knowledge of the contents of this report and am authorized by my organization to make this report, which was prepared by me or under my supervision and direction, with the data and facts stated herein to be true, correct, and complete to the best of my knowledge and belief.

SIGNATURE: [Signature] NAME (PRINT OR TYPE): Jared Glenn DATE: 3/3/2020 PHONE NUMBER: 405-286-9800
ADDRESS: 1601 NW Expressway, Ste 777 CITY: Oklahoma City STATE: OK ZIP: 73118 EMAIL ADDRESS: Jared.glenn@blakeproduction.com

PLEASE TYPE OR USE BLACK INK ONLY
FORMATION RECORD

Give formation names and tops, if available, or descriptions and thickness of formations drilled through. Show intervals cored or drillstem tested.

NAMES OF FORMATIONS	TOP
TOKAWA	5,300
COTTAGE GROVE	5,712
HOGSHOOTER	5,871
CHECKERBOARD	6,033
BIG LIME	6,155
OSWEGO	6,198

LEASE NAME

Northern Lights

WELL NO. 1-35-26XH

FOR COMMISSION USE ONLY	
ITD on file <input type="checkbox"/> YES <input type="checkbox"/> NO	
APPROVED _____	DISAPPROVED _____
2) Reject Codes	

Were open hole logs run?	yes <input type="checkbox"/> no <input checked="" type="checkbox"/>	per Jared Glenn
Date Last log was run	_____	
Was CO ₂ encountered?	yes <input type="checkbox"/> no <input checked="" type="checkbox"/> at what depths? _____	
Was H ₂ S encountered?	yes <input type="checkbox"/> no <input checked="" type="checkbox"/> at what depths? _____	
Were unusual drilling circumstances encountered?	yes <input type="checkbox"/> no <input checked="" type="checkbox"/>	
If yes, briefly explain below		

Other remarks:

OCB - The spacing order is for an irregular 320 acre spaced unit comprising SW 1/4 Sec 26 and NW 1/4 Sec 35 of 23N-13W

640 Acres

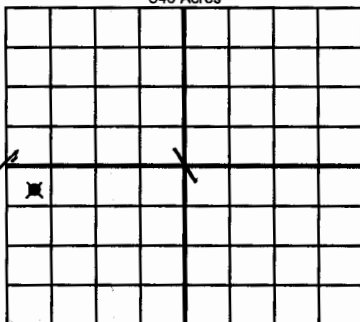

If more than three drainholes are proposed, attach a separate sheet indicating the necessary information.

Direction must be stated in degrees azimuth. Please note, the horizontal drainhole and its end point must be located within the boundaries of the lease or spacing unit.

Directional surveys are required for all drainholes and directional wells.

640 Acres

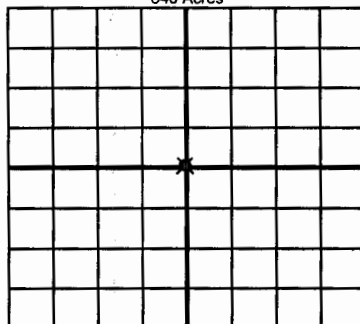

BOTTOM HOLE LOCATION FOR DIRECTIONAL HOLE

SEC	TWP	RGE	COUNTY
SEC	26	23N	13W
Spot Location		1/4	1/4
Measured Total Depth		True Vertical Depth	BHL From Lease, Unit, or Property Line:

BOTTOM HOLE LOCATION FOR HORIZONTAL HOLE: (LATERALS)

LATERAL #1			
SEC	TWP	RGE	COUNTY
SEC	26	23N	13W
Spot Location		1/4	1/4
Measured Total Depth		True Vertical Depth	BHL From Lease, Unit, or Property Line:

LATERAL #2			
SEC	TWP	RGE	COUNTY
SEC	26	23N	13W
Spot Location		1/4	1/4
Measured Total Depth		True Vertical Depth	BHL From Lease, Unit, or Property Line:

LATERAL #3			
SEC	TWP	RGE	COUNTY
SEC	26	23N	13W
Spot Location		1/4	1/4
Measured Total Depth		True Vertical Depth	BHL From Lease, Unit, or Property Line: