

Oklahoma Corporation Commission  
Oil & Gas Conservation Division  
Post Office Box 52000  
Oklahoma City, Oklahoma 73152-2000  
Rule 165: 10-3-25

Form 1002A

API No.: 35081243170000

**Completion Report**

Spud Date: March 03, 2020

OTC Prod. Unit No.: 081-226809

Drilling Finished Date: March 14, 2020

1st Prod Date: July 16, 2020

Completion Date: July 07, 2020

**Drill Type: HORIZONTAL HOLE**

Min Gas Allowable: Yes

Well Name: SADLER 1-27MH

Purchaser/Measurer: SUPERIOR PIPELINE

Location: LINCOLN 34 17N 3E  
NE NE NE NW  
300 FNL 200 FEL of 1/4 SEC  
Latitude: 35.544375 Longitude: -96.581926  
Derrick Elevation: 0 Ground Elevation: 962

First Sales Date: 07/14/2020

Operator: ROBERSON OIL COMPANY INC 19500  
PO BOX 8  
201 E COTTAGE ST  
ADA, OK 74821-0008

Completion Type		Location Exception		Increased Density	
X	Single Zone	Order No		Order No	
	Multiple Zone	714738		NONE	
	Commingled				

Casing and Cement							
Type	Size	Weight	Grade	Feet	PSI	SAX	Top of CMT
CONDUCTOR	16	36	J-55	60		225	SURFACE
SURFACE	9 5/8	36	J-55	533	4000	280	SURFACE
PRODUCTION	5 1/2	20	P-110	8818	7000	1120	1885

Liner								
Type	Size	Weight	Grade	Length	PSI	SAX	Top Depth	Bottom Depth
There are no Liner records to display.								

**Total Depth: 8822**

Packer	
Depth	Brand & Type
There are no Packer records to display.	

Plug	
Depth	Plug Type
There are no Plug records to display.	

Initial Test Data
-------------------

Test Date	Formation	Oil BBL/Day	Oil-Gravity (API)	Gas MCF/Day	Gas-Oil Ratio Cu FT/BBL	Water BBL/Day	Pumpin or Flowing	Initial Shut-In Pressure	Choke Size	Flow Tubing Pressure
Aug 01, 2020	MISSISSIPPIAN	173	45	518	2994	1300	PUMPING	510	N/A	

Completion and Test Data by Producing Formation									
Formation Name: MISSISSIPPIAN				Code: 359MSSP			Class: OIL		
Spacing Orders				Perforated Intervals					
Order No		Unit Size		From			To		
708756		640		4700			8700		
Acid Volumes				Fracture Treatments					
215,250 GALLONS 15%				3,587,500 POUNDS 20/40 SAND, 164,238 BARRELS WATER					

Formation	Top
-----------	-----

Were open hole logs run? No

Date last log run:

Were unusual drilling circumstances encountered? No

Explanation:

Other Remarks
There are no Other Remarks.

Lateral Holes
Sec: 27 TWP: 17N RGE: 3E County: LINCOLN  NE SE NE NW  1906 FSL 2514 FWL of 1/4 SEC  Depth of Deviation: 3560 Radius of Turn: 1410 Direction: 360 Total Length: 3915  Measured Total Depth: 8822 True Vertical Depth: 4383 End Pt. Location From Release, Unit or Property Line: 1906

FOR COMMISSION USE ONLY
<div>Status: Accepted</div> <div>1145487</div>

OIL AND GAS CONSERVATION DIVISION  
P.O. Box 52000  
Oklahoma City, OK 73152-2000  
405-522-0577  
occcentralprocessing@occ.ok.gov



Form 1002A  
Rev. 2009

API NO. 081-24317  
OTC PROD. UNIT NO. 081-226809

☒ ORIGINAL  
☐ AMENDED (Reason) \_\_\_\_\_  
WELL COMPLETION REPORT  
OAC 165-10-3-25 (PLEASE TYPE OR USE BLACK INK ONLY)  
TYPE OF DRILLING OPERATION  
☐ STRAIGHT HOLE ☐ DIRECTIONAL HOLE ☒ HORIZONTAL HOLE  
If directional or horizontal, see reverse for bottom hole location.  
COUNTY Lincoln SEC 34 TWP 17N RGE 03E  
LEASE NAME SADLER WELL NO. 1-27M 1st PROD DATE 7/16/2020  
NE 1/4 NE 1/4 NE 1/4 NW 1/4 (F3) OF 300' (F2) OF 200'  
ELEVATION Derrick FL Ground 962' Latitude (if known) 85.544375 Longitude (if known) -96.581926  
OPERATOR NAME ROBERSON OIL CO., INC. OTC/OCC OPERATOR NO. 19500  
ADDRESS PO Box 8  
CITY Ada STATE OK ZIP 74821

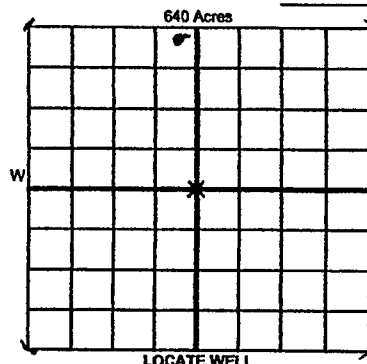

COMPLETION TYPE  
☒ SINGLE ZONE  
☐ MULTIPLE ZONE  
☐ COMMINGLED  
LOCATION EXCEPTION ORDER NO. None 7/4738  
INCREASED DENSITY ORDER NO. None

CASING & CEMENT (Attach Form 1002C)

TYPE	SIZE	WEIGHT	GRADE	FEET	PSI	SAX	TOP OF CMT
CONDUCTOR	16"	36#	J55	60'		225	Surface
SURFACE	9 5/8	36#	J55	533'	4000	280	Surface
INTERMEDIATE							
PRODUCTION	5 1/2	20#	P-110	8818'	7000	1120	1885'
LINER							
TOTAL DEPTH							8822'

PACKER @ \_\_\_\_\_ BRAND & TYPE \_\_\_\_\_ PLUG @ \_\_\_\_\_ TYPE \_\_\_\_\_ PLUG @ \_\_\_\_\_ TYPE \_\_\_\_\_  
PACKER @ \_\_\_\_\_ BRAND & TYPE \_\_\_\_\_ PLUG @ \_\_\_\_\_ TYPE \_\_\_\_\_ PLUG @ \_\_\_\_\_ TYPE \_\_\_\_\_

COMPLETION & TEST DATA BY PRODUCING FORMATION

FORMATION	Mississippi an						Reported to Frac Focus
SPACING & SPACING ORDER NUMBER	#708756 640 Ac						
CLASS: Oil, Gas, Dry, Inj, Disp, Comm Disp, Svc	Oil						
PERFORATED INTERVALS	4700-4850	5350-5450	5950-6050	6550-6650	7150-7250	7750-7850 7950-8050	
	4950-5050	5550-5650	6150-6250	6750-6850	7350-7450	8150-8250 8350-8450	
	5150-5250	5750-5850	6350-6450	6950-7050	7550-7650	8600-8700	
ACID VOLUME	215,250 gals. 15%						
FRACTURE TREATMENT (Fluids/Prop Amounts)	3,587,500 20/40 Sand						
	164,238 Bbls Water						

☒ Min Gas Allowable (165-10-17-7) OR ☐ Oil Allowable (165-10-13-3)  
Gas Purchaser/Measurer Superior Pipeline  
First Sales Date 7/14/2020

INITIAL TEST DATA

INITIAL TEST DATE	8/01/2020					
OIL-BBL/DAY	173					
OIL-GRAVITY (API)	45					
GAS-MCF/DAY	518					
GAS-OIL RATIO CU FT/BBL	2994:1					
WATER-BBL/DAY	1300					
PUMPING OR FLOWING	Pumping					
INITIAL SHUT-IN PRESSURE	510					
CHOKE SIZE	n/a					
FLOW TUBING PRESSURE	n/a					

RECEIVED

AUG 10 2020

Oklahoma Corporation  
Commission

A record of the formations drilled through, and pertinent remarks are presented on the reverse. I declare that I have knowledge of the contents of this report and am authorized by my organization to make this report, which was prepared by me or under my supervision and direction, with the data and facts stated herein to be true, correct, and complete to the best of my knowledge and belief.

SIGNATURE David Roberson, II, President 8-06-2020 580-332-6170  
P.O. Box 8 Ada, OK 74821 ROIL11@yahoo.com  
ADDRESS CITY STATE ZIP EMAIL ADDRESS

PLEASE TYPE OR USE BLACK INK ONLY  
FORMATION RECORD

Give formation names and tops, if available, or descriptions and thickness of formations drilled through. Show intervals cored or drillstem tested.

NAMES OF FORMATIONS	TOP
Checkerboard	3298
Peru	3749
Big Lime	3798
Oswego	3837
Lower Skinner	4133
Pink Lime	4170
Redfork	4195
Mississippian	4738

LEASE NAME SADLER

WELL NO. 1-27MH

FOR COMMISSION USE ONLY	
ITD on file <input type="checkbox"/> YES <input type="checkbox"/> NO	
APPROVED <input type="checkbox"/> DISAPPROVED <input type="checkbox"/>	2) Reject Codes
<div></div> <div></div> <div></div> <div></div> <div></div>	

Were open hole logs run? ☐ yes ☒ no

Date Last log was run \_\_\_\_\_

Was CO<sub>2</sub> encountered? ☐ yes ☒ no at what depths? \_\_\_\_\_

Was H<sub>2</sub>S encountered? ☐ yes ☒ no at what depths? \_\_\_\_\_

Were unusual drilling circumstances encountered? ☐ yes ☒ no  
If yes, briefly explain below \_\_\_\_\_

Other remarks:

BOTTOM HOLE LOCATION FOR DIRECTIONAL HOLE

SEC	TWP	RGE	COUNTY
27	17N	3E	Lincoln
Spot Location		1/4	1/4
Measured Total Depth		True Vertical Depth	BHL From Lease, Unit, or Property Line:
3560'		4382.77	734'

BOTTOM HOLE LOCATION FOR HORIZONTAL HOLE: (LATERALS)

SEC	TWP	RGE	COUNTY
27	17N	3E	Lincoln
Spot Location		1/4	1/4
Measured Total Depth		True Vertical Depth	BHL From Lease, Unit, or Property Line:
8822'		4382.77	734'

LATERAL #2

SEC	TWP	RGE	COUNTY
27	17N	3E	Lincoln
Spot Location		1/4	1/4
Measured Total Depth		True Vertical Depth	BHL From Lease, Unit, or Property Line:
3560'		4382.77	734'

LATERAL #3

SEC	TWP	RGE	COUNTY
27	17N	3E	Lincoln
Spot Location		1/4	1/4
Measured Total Depth		True Vertical Depth	BHL From Lease, Unit, or Property Line:
3560'		4382.77	734'

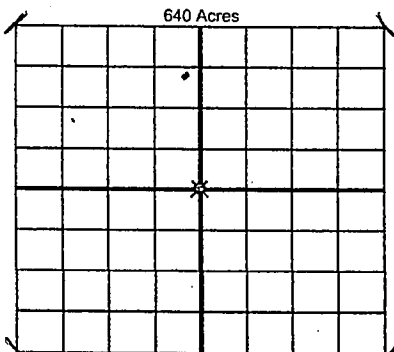

If more than three drainholes are proposed, attach a separate sheet indicating the necessary information.

Direction must be stated in degrees azimuth. Please note, the horizontal drainhole and its end point must be located within the boundaries of the lease or spacing unit.

Directional surveys are required for all drainholes and directional wells.

