

Oklahoma Corporation Commission
Oil & Gas Conservation Division
Post Office Box 52000
Oklahoma City, Oklahoma 73152-2000
Rule 165: 10-3-25

Form 1002A

API No.: 35071245030001

Completion Report

Spud Date: May 12, 2012

OTC Prod. Unit No.: 071-206471-0-0000

Drilling Finished Date: May 18, 2012

Amended

Amend Reason: ADD PERFORATIONS TO EXISTING ZONE

1st Prod Date: January 13, 2011

Completion Date: February 02, 2013

Recomplete Date: February 23, 2021

Drill Type: STRAIGHT HOLE

Well Name: DICKERSON 2-34

Purchaser/Measurer:

Location: KAY 34 29N 1W
C W2 NW NE
1980 FSL 330 FWL of 1/4 SEC
Derrick Elevation: 1114 Ground Elevation: 1103

First Sales Date:

Operator: BARBER OIL LLC 24363

8801 S YALE AVE STE 150
TULSA, OK 74137-3575

Completion Type		Location Exception		Increased Density	
X	Single Zone	Order No		Order No	
	Multiple Zone	592326		There are no Increased Density records to display.	
	Commingle				

Casing and Cement							
Type	Size	Weight	Grade	Feet	PSI	SAX	Top of CMT
SURFACE	8 5/8	24	J-55	311	220	130	SURFACE
PRODUCTION	5 1/2	15.5	J-55	3670	720	210	2300

Liner								
Type	Size	Weight	Grade	Length	PSI	SAX	Top Depth	Bottom Depth
There are no Liner records to display.								

Total Depth: 3682

Packer	
Depth	Brand & Type
There are no Packer records to display.	

Plug	
Depth	Plug Type
There are no Plug records to display.	

Initial Test Data										
Test Date	Formation	Oil BBL/Day	Oil-Gravity (API)	Gas MCF/Day	Gas-Oil Ratio Cu FT/BBL	Water BBL/Day	Pumpin or Flowing	Initial Shut-In Pressure	Choke Size	Flow Tubing Pressure
Feb 23, 2021	CLEVELAND	17.5	38			83	PUMPING			

Completion and Test Data by Producing Formation

Formation Name: CLEVELAND

Code: 405CLVD

Class: OIL

Spacing Orders

Order No	Unit Size
587735	320

Perforated Intervals

From	To
3217	3234

Acid Volumes

1,000 GALLONS NEW

Fracture Treatments

191,676 POUNDS WATER, 15,300 POUNDS SAND NEW
--

Formation Name: CLEVELAND

Code: 405CLVD

Class: OIL

Spacing Orders

Order No	Unit Size
587735	320

Perforated Intervals

From	To
3205	3328

Acid Volumes

1,500 GALLONS ORIGINAL

Fracture Treatments

815 BARRELS FRAC FLUID, 54,875 POUNDS SAND ORIGINAL

Formation	Top
CLEVELAND	3204

Were open hole logs run? Yes

Date last log run: May 17, 2012

Were unusual drilling circumstances encountered? No

Explanation:

Other Remarks

There are no Other Remarks.

FOR COMMISSION USE ONLY

1146185

Status: Accepted

API NO. 35-071-24503
OTC PROD. UNIT NO. 071-206471

Oil and Gas Conservation Division
P.O. Box 52000
Oklahoma City, OK 73152-2000
405-522-0577
OCCCentralProcessing@OCC.OK.GOV



OKLAHOMA
Corporation
Commission

Form 1002A
Rev. 2020

ORIGINAL
AMENDED (Reason) add perforations to existing zone

Rule 165:10-3-25

COMPLETION REPORT

TYPE OF DRILLING OPERATION

☒ STRAIGHT HOLE ☐ DIRECTIONAL HOLE ☐ HORIZONTAL HOLE
☐ SERVICE WELL

If directional or horizontal, see reverse for bottom hole location.

COUNTY	Kay	SEC	34	TWP	27N	RGE	1W
LEASE NAME	Dickerson			WELL NO.	2-34		
C	1/4 NW 1/4	1/4 NE 1/4	FSL 1980	FWL	330		
ELEVATION	1114	Ground	1103	Latitude	Longitude		
OPERATOR NAME	Barber Oil, LC			OTC / OCC OPERATOR NO.	24363		
ADDRESS	8801 South Yale Avenue, Suite 150						
CITY	Tulsa		STATE	OK	ZIP	74137	

SPUD DATE 5/12/2012
DRLG FINISHED DATE 5/18/2012
DATE OF WELL COMPLETION 2/23/2013
1st PROD DATE 1/13/2011
RECOMP DATE 2-23-2021

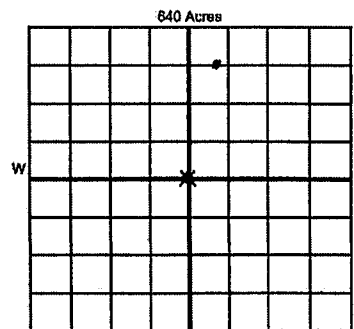

LOCATE WELL

COMPLETION TYPE

<input checked="" type="radio"/> SINGLE ZONE	
<input type="radio"/> MULTIPLE ZONE	
<input type="radio"/> COMMINGLED	
LOCATION EXCEPTION ORDER NO.	592326
MULTIUNIT ORDER NO.	
INCREASED DENSITY ORDER NO.	

CASING & CEMENT (Attach Form 1002C)

TYPE	SIZE	WEIGHT	GRADE	FEET	PSI	SAX	TOP OF CMT
CONDUCTOR							
SURFACE	8 5/8"	24#	J-55	311	220	130	Surface
INTERMEDIATE							
PRODUCTION	5 1/2"	15.5#	J-55	3670	720	210	2300'
LINER							

PACKER @ _____ BRAND & TYPE _____ PLUG @ _____ TYPE _____ PLUG @ _____ TYPE _____ TOTAL DEPTH 3682

COMPLETION & TEST DATA BY PRODUCING FORMATION

FORMATION	Cleveland						Reported to Frac Focals
SPACING & SPACING ORDER NUMBER	587735 (320)						
CLASS: Oil, Gas, Dry, Inf, Disp, Comm Disp, Svc	Oil						
PERFORATED INTERVALS	3217'-3234'	3205-3328 (original perforations + Frac)					
ACID/VOLUME	1000 gal	1500 gals					
FRACTURE TREATMENT (Fluids/Prop Amounts)	191,676# water 15,300# sand	815 Bbls Frac Fluid 54,875 lbs sand					

☐ Min Gas Allowable (165:10-17-7)
OR
☐ Oil Allowable (165:10-13-3)

Purchaser/Measurer _____
First Sales Date _____

INITIAL TEST DATA

INITIAL TEST DATE	2/23/2021					
OIL-BBL/DAY	17.5					
OIL-GRAVITY (API)	38					
GAS-MCF/DAY	0					
GAS-OIL RATIO CU FT/BBL	0					
WATER-BBL/DAY	83					
PUMPING OR FLOWING	pump					
INITIAL SHUT-IN PRESSURE						
CHOKE SIZE						
FLOW TUBING PRESSURE						

RECEIVED
MAR 15 2021
Oklahoma Corporation
Commission

A record of the formations drilled through, and pertinent remarks are presented on the reverse. I declare that I have knowledge of the contents of this report and am authorized by my organization to make this report, which was prepared by me or under my supervision and direction, with the data and facts stated herein to be true, correct, and complete to the best of my knowledge and belief.

Barbara Courtney

Barbara Courtney

918-638-5951

SIGNATURE

NAME (PRINT OR TYPE)

DATE

PHONE NUMBER

8801 South Yale Ave, Suite 150

Tulsa

OK

74137

bcourtney@barberoilco.com

ADDRESS

CITY

STATE

ZIP

EMAIL ADDRESS

PLEASE TYPE OR USE BLACK INK ONLY

FORMATION RECORD

Give formation names and tops, if available, or descriptions and thickness of formations drilled through. Show intervals cored or drillstem tested.

NAMES OF FORMATIONS	TOP
Cleveland	3204'

LEASE NAME _____ WELL NO. _____

FOR COMMISSION USE ONLY	
ITD on file <input type="checkbox"/> YES <input type="checkbox"/> NO	
APPROVED _____	DISAPPROVED _____
2) Reject Codes	

Were open hole logs run?	<input checked="" type="radio"/> yes <input type="radio"/> no
Date Last log was run	5-17-2012
Was CO ₂ encountered?	<input type="radio"/> yes <input type="radio"/> no at what depths? _____
Was H ₂ S encountered?	<input type="radio"/> yes <input type="radio"/> no at what depths? _____
Were unusual drilling circumstances encountered?	<input type="radio"/> yes <input type="radio"/> no
If yes, briefly explain below	

Other remarks: _____

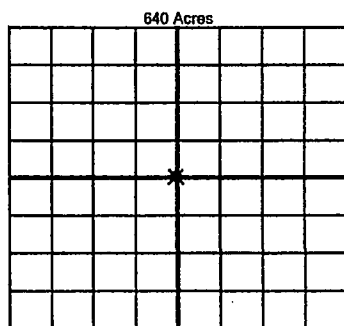

If more than three drainholes are proposed, attach a separate sheet indicating the necessary information.

Direction must be stated in degrees azimuth. Please note, the horizontal drainhole and its end point must be located within the boundaries of the lease or spacing unit.

Directional surveys are required for all drainholes and directional wells

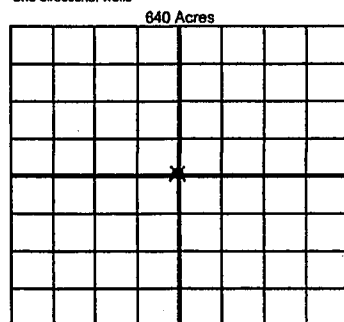

BOTTOM HOLE LOCATION FOR DIRECTIONAL HOLE

SEC	TWP	RGE	COUNTY
1/4	1/4	1/4	1/4
Measured Total Depth		True Vertical Depth	
		Feet From 1/4 Sec Lines	
		BHL From Lease, Unit, or Property Line:	

BOTTOM HOLE LOCATION FOR HORIZONTAL HOLE: (LATERALS)

LATERAL #1			
SEC	TWP	RGE	COUNTY
1/4	1/4	1/4	1/4
Depth of Deviation		Radius of Turn	
Measured Total Depth		True Vertical Depth	
		Feet From 1/4 Sec Lines	
		Total Length	
		BHL From Lease, Unit, or Property Line:	

LATERAL #2			
SEC	TWP	RGE	COUNTY
1/4	1/4	1/4	1/4
Depth of Deviation		Radius of Turn	
Measured Total Depth		True Vertical Depth	
		Feet From 1/4 Sec Lines	
		Total Length	
		BHL From Lease, Unit, or Property Line:	

LATERAL #3			
SEC	TWP	RGE	COUNTY
1/4	1/4	1/4	1/4
Depth of Deviation		Radius of Turn	
Measured Total Depth		True Vertical Depth	
		Feet From 1/4 Sec Lines	
		Total Length	
		BHL From Lease, Unit, or Property Line:	