

Oklahoma Corporation Commission
Oil & Gas Conservation Division
Post Office Box 52000
Oklahoma City, Oklahoma 73152-2000
Rule 165: 10-3-25

Form 1002A

API No.: 35093252550001

Completion Report

Spud Date: June 23, 2021

OTC Prod. Unit No.: 093-227266-0-0000

Drilling Finished Date: July 02, 2021

1st Prod Date: July 29, 2021

Completion Date: July 22, 2021

Drill Type: DIRECTIONAL HOLE

Min Gas Allowable: Yes

Well Name: CHEVAL 12-3

Purchaser/Measurer: ENERGY TRANSFER
(SUNOCO)

First Sales Date: 08/03/2021

Location: MAJOR 5 21N 14W
C SE SE
660 FSL 660 FEL of 1/4 SEC
Latitude: 36.32008 Longitude: -98.71317
Derrick Elevation: 0 Ground Elevation: 1502

Operator: KIRKPATRICK OIL COMPANY INC 19792

1001 W WILSHIRE BLVD STE 202
OKLAHOMA CITY, OK 73116-7017

Completion Type		Location Exception		Increased Density	
X	Single Zone	Order No		Order No	
	Multiple Zone	There are no Location Exception records to display.		There are no Increased Density records to display.	
	Commingled				

Casing and Cement							
Type	Size	Weight	Grade	Feet	PSI	SAX	Top of CMT
SURFACE	9 5/8	36	J-55	616		275	SURFACE
PRODUCTION	5 1/2	17	N-80	7356		240	5870

Liner								
Type	Size	Weight	Grade	Length	PSI	SAX	Top Depth	Bottom Depth
There are no Liner records to display.								

Total Depth: 7360

Packer		Plug	
Depth	Brand & Type	Depth	Plug Type
There are no Packer records to display.		There are no Plug records to display.	

Initial Test Data

Test Date	Formation	Oil BBL/Day	Oil-Gravity (API)	Gas MCF/Day	Gas-Oil Ratio Cu FT/BBL	Water BBL/Day	Pumpin or Flowing	Initial Shut-In Pressure	Choke Size	Flow Tubing Pressure
Aug 10, 2021	CHEROKEE	57.09	41.9			74	PUMPING			

Completion and Test Data by Producing Formation

Formation Name: CHEROKEE

Code: 404CHRK

Class: OIL

Spacing Orders

Order No	Unit Size
64660	UNIT

Perforated Intervals

From	To
7077	7079
7081	7084
7091	7100
7102	71017

Acid Volumes

500 GALLONS 15% RETARDED ACID

Fracture Treatments

3,795 BARRELS 15 AND 20 POUNDS LINEAR AND BORATE X-LINKED GEL, 38,360 POUNDS 30/70 SAND AND 102,020 POUNDS 20/40 SAND
--

Formation	Top
CHEROKEE	7000

Were open hole logs run? Yes

Date last log run: June 30, 2021

Were unusual drilling circumstances encountered? No

Explanation:

Other Remarks

LATITUDE AND LONGITUDE COORDINATES HAVE BEEN UPDATED PER THE LATEST CORRECTED SURVEY PLAT. THE CORRECTED PLAT WAS SUBMITTED TO THE OCC VIA EMAIL TO STEVEN CARLSON ON AUGUST 16, 2021.

Bottom Holes

Sec: 5 TWP: 21N RGE: 14W County: MAJOR

SE NE SW SE

906 FSL 1620 FEL of 1/4 SEC

Depth of Deviation: 0 Radius of Turn: 0 Direction: 0 Total Length: 0

Measured Total Depth: 7360 True Vertical Depth: 7216 End Pt. Location From Release, Unit or Property Line: 1620

FOR COMMISSION USE ONLY

1146944

Status: Accepted

API NO. 35-093-25255 X
OTC PROD. UNIT NO. 093-227266

Oil and Gas Conservation Division
P.O. Box 52000
Oklahoma City, OK 73152-2000
405-521-2331
OCCCentralProcessing@OCC.OK.GOV



OKLAHOMA
Corporation
Commission

Form 1002A
Rev. 2020



ORIGINAL
AMENDED (Reason)

Rule 165:10-3-25

COMPLETION REPORT

TYPE OF DRILLING OPERATION

☐ STRAIGHT HOLE ☒ DIRECTIONAL HOLE ☐ HORIZONTAL HOLE
☐ SERVICE WELL

If directional or horizontal, see reverse for bottom hole location.

COUNTY	Major	SEC	05	TWP	21N	RGE	14W	
LEASE NAME	Cheval			WELL NO.	12-3			
1/4	C	1/4	SE	1/4	SE	1/4	FSL 660	
ELEVATION	Ground		1502	Latitude	36.32008		Longitude	-98.71317
OPERATOR NAME	Kirkpatrick Oil Company, Inc.				OTC / OCC OPERATOR NO.	19792		
ADDRESS	1001 W Wilshire Blvd, Ste 202							
CITY	Oklahoma City		STATE	OK	ZIP	73116		

SPUD DATE 06/23/2021

DRLG FINISHED DATE 07/02/2021

DATE OF WELL COMPLETION 07/22/2021

1st PROD DATE 07/29/2021

RECOMP DATE

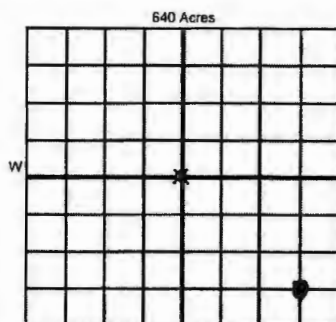

LOCATE WELL

COMPLETION TYPE

<input checked="" type="radio"/> SINGLE ZONE	
<input type="radio"/> MULTIPLE ZONE	
<input type="radio"/> COMMINGLED	
LOCATION EXCEPTION ORDER NO.	
MULTIUNIT ORDER NO.	
INCREASED DENSITY ORDER NO.	

CASING & CEMENT (Attach Form 1002C)

TYPE	SIZE	WEIGHT	GRADE	FEET	PSI	SAX	TOP OF CMT
CONDUCTOR							
SURFACE	9 5/8	36	J55	616		275	Surface
INTERMEDIATE							
PRODUCTION	5 1/2	17	N80	7356		240	5870
LINER							

PACKER @ BRAND & TYPE PLUG @ TYPE PLUG @ TYPE TOTAL DEPTH 7360'

COMPLETION & TEST DATA BY PRODUCING FORMATION

FORMATION	Cherokee						
SPACING & SPACING ORDER NUMBER	64660 (unit)						
CLASS: Oil, Gas, Dry, Inj, Disp, Comm Disp, Svc	Oil						
PERFORATED INTERVALS	7077-79', 7081-84'						
	7091-7100'						
	7102-17'						
ACID/VOLUME	500 gal 15% HCL retarded acid						
FRACTURE TREATMENT (Fluids/Prop Amounts)	3795 bbls 15 & 20# linear and Borate X-linked gel 38,360 lbs 30/70 & 102,020 lbs 20/40						

Reported to
Free Focis

RECEIVED
SEP 27 2021

OKLAHOMA CORPORATION
COMMISSION



Min Gas Allowable (165:10-17-7)

OR

Oil Allowable (165:10-13-3)

Purchaser/Messenger

First Sales Date

Energy Transfer (Sunoco)

08/03/2021

INITIAL TEST DATA

INITIAL TEST DATE	08/10/2021					
OIL-BBL/DAY	57.09					
OIL-GRAVITY (API)	41.9					
GAS-MCF/DAY	0					
GAS-OIL RATIO CU FT/BBL	0					
WATER-BBL/DAY	74					
PUMPING OR FLOWING	Pumping					
INITIAL SHUT-IN PRESSURE						
CHOKE SIZE						
FLOW TUBING PRESSURE						

A record of the formations drilled through, and pertinent remarks are presented on the reverse. I declare that I have knowledge of the contents of this report and am authorized by my organization to make this report, which was prepared by me or under my supervision and direction, with the data and facts stated herein to be true, correct, and complete to the best of my knowledge and belief.

Cindy Kyle
SIGNATURE

Cindy Kyle, President & CFO

NAME (PRINT OR TYPE)

09/17/2021

DATE

405-840-2882

PHONE NUMBER

1001 W Wilshire Blvd, Ste 202

Oklahoma City

OK

73116

ADDRESS

CITY

STATE

ZIP

kyle@kirkpatrickoil.com

EMAIL ADDRESS

PLEASE TYPE OR USE BLACK INK ONLY
FORMATION RECORD

Give formation names and tops, if available, or descriptions and thickness of formations drilled through. Show intervals cored or drillstem tested.

NAMES OF FORMATIONS	TOP
Cherokee	7000

LEASE NAME Cheval WELL NO. 12-3

FOR COMMISSION USE ONLY	
ITD on file <input type="checkbox"/> YES <input type="checkbox"/> NO	
APPROVED _____	DISAPPROVED _____
2) Reject Codes	

Were open hole logs run?	<input checked="" type="radio"/> yes <input type="radio"/> no
Date Last log was run	06/30/2021
Was CO ₂ encountered?	<input type="radio"/> yes <input checked="" type="radio"/> no at what depths? _____
Was H ₂ S encountered?	<input type="radio"/> yes <input checked="" type="radio"/> no at what depths? _____
Were unusual drilling circumstances encountered?	<input type="radio"/> yes <input checked="" type="radio"/> no
If yes, briefly explain below	

Other remarks: Latitude and longitude coordinates have been updated per the latest/corrected survey plat.
The corrected plat was submitted to the OCC via email to Steven Carlson on 08/16/2021.

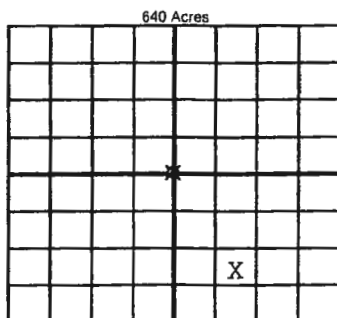

If more than three drainholes are proposed, attach a separate sheet indicating the necessary information.

Direction must be stated in degrees azimuth. Please note, the horizontal drainhole and its end point must be located within the boundaries of the lease or spacing unit.

Directional surveys are required for all drainholes and directional wells

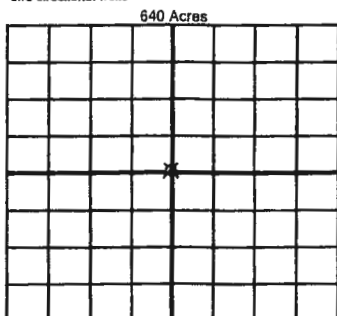

BOTTOM HOLE LOCATION FOR DIRECTIONAL HOLE

SEC 05	TWP 21N	RGE 14W	COUNTY	Major
SW 1/4 NE 1/4 SW 1/4 SE 1/4		Feet From 1/4 Sec Lines FSL 906 FEL 1620		
Measured Total Depth 7360		True Vertical Depth 7216 BHL From Lease, Unit, or Property Line: 1620		

BOTTOM HOLE LOCATION FOR HORIZONTAL HOLE: (LATERALS)

LATERAL #1				
SEC	TWP	RGE	COUNTY	
1/4	1/4	1/4	1/4	Feet From 1/4 Sec Lines
Depth of Deviation	Radius of Turn	Direction	Total Length	
Measured Total Depth	True Vertical Depth	BHL From Lease, Unit, or Property Line:		

LATERAL #2				
SEC	TWP	RGE	COUNTY	
1/4	1/4	1/4	1/4	Feet From 1/4 Sec Lines
Depth of Deviation	Radius of Turn	Direction	Total Length	
Measured Total Depth	True Vertical Depth	BHL From Lease, Unit, or Property Line:		

LATERAL #3				
SEC	TWP	RGE	COUNTY	
1/4	1/4	1/4	1/4	Feet From 1/4 Sec Lines
Depth of Deviation	Radius of Turn	Direction	Total Length	
Measured Total Depth	True Vertical Depth	BHL From Lease, Unit, or Property Line:		