

Oklahoma Corporation Commission  
Oil & Gas Conservation Division  
Post Office Box 52000  
Oklahoma City, Oklahoma 73152-2000  
Rule 165: 10-3-25

Form 1002A

API No.: 35035215710000

**Completion Report**

Spud Date: December 02, 2019

OTC Prod. Unit No.: 035-2265712-0-0000

Drilling Finished Date: December 03, 2019

1st Prod Date: December 23, 2019

Completion Date: December 19, 2019

**Drill Type: STRAIGHT HOLE**

Min Gas Allowable: Yes

Well Name: SNEDDEN 11-29C

Purchaser/Measurer: CVR

Location: CRAIG 29 27N 19E  
NW SE NW NW  
745 FNL 825 FWL of 1/4 SEC  
Derrick Elevation: 0 Ground Elevation: 905

First Sales Date: 01/06/2020

Operator: NEOK PRODUCTION COMPANY LLC 21838  
PO BOX 428  
109 NORTH OAK  
NOWATA, OK 74048-0428

Completion Type		Location Exception		Increased Density	
X	Single Zone	Order No		Order No	
	Multiple Zone	There are no Location Exception records to display.		There are no Increased Density records to display.	
	Commingled				

Casing and Cement							
Type	Size	Weight	Grade	Feet	PSI	SAX	Top of CMT
CONDUCTOR	8 5/8	20	J-55	21		12	SURFACE
PRODUCTION	4 1/2	10.5	J-55	987		105	SURFACE

Liner								
Type	Size	Weight	Grade	Length	PSI	SAX	Top Depth	Bottom Depth
There are no Liner records to display.								

**Total Depth: 998**

Packer	
Depth	Brand & Type
There are no Packer records to display.	

Plug	
Depth	Plug Type
There are no Plug records to display.	

Initial Test Data										
Test Date	Formation	Oil BBL/Day	Oil-Gravity (API)	Gas MCF/Day	Gas-Oil Ratio Cu FT/BBL	Water BBL/Day	Pumpin or Flowing	Initial Shut-In Pressure	Choke Size	Flow Tubing Pressure
Dec 23, 2019	ARBUCKLE	5	22			25	PUMPING			25

Completion and Test Data by Producing Formation			
Formation Name: ARBUCKLE		Code: 169ABCK	Class: OIL
<b>Spacing Orders</b>		<b>Perforated Intervals</b>	
<b>Order No</b>	<b>Unit Size</b>	<b>From</b>	<b>To</b>
N/A		There are no Perf. Intervals records to display.	
<b>Acid Volumes</b>		<b>Fracture Treatments</b>	
N/A		N/A	

Formation	Top
VERDIGRIS LIME	44
CROWEBERG COAL	87
TEBO COAL	231
BARTLESVILLE SAND	352
WARNER SAND	534
MISSISSIPPI CHAT	585
WOODFORD SHALE	935
ARBUCKLE	987

Were open hole logs run? Yes  
Date last log run: December 13, 2019

Were unusual drilling circumstances encountered? No  
Explanation:

Other Remarks
OCC - THIS WELL IS AN OPEN HOLE COMPLETION FROM BOTTOM OF THE 4 1/2" AT 987' TO TOTAL DEPTH AT 998'.

FOR COMMISSION USE ONLY	
Status: Accepted	1144748

API NO. 03521571  
OTC PROD. UNIT NO. 0352265712

(PLEASE TYPE OR USE BLACK INK ONLY)

OKLAHOMA CORPORATION COMMISSION

Oil & Gas Conservation Division  
Post Office Box 52000  
Oklahoma City, Oklahoma 73152-2000  
Rule 165:10-3-25

RECEIVED

Form 1002A  
Rev. 2009

FEB 06 2020

☒ ORIGINAL  
☐ AMENDED (Reason)

COMPLETION REPORT

TYPE OF DRILLING OPERATION

☒ STRAIGHT HOLE ☐ DIRECTIONAL HOLE ☐ HORIZONTAL HOLE  
☐ SERVICE WELL

If directional or horizontal, see reverse for bottom hole location.

COUNTY Craig SEC 29 TWP 27N RGE 19E  
LEASE NAME Snedden FNA 745  
NW 1/4 SE 1/4 NW 1/4 NW 1/4 SEC OF 1805 FWL OF 825  
ELEVATION Ground 905  
OPERATOR NAME Neok Production Company LLC OTC / OCC OPERATOR NO. 21838  
ADDRESS P.O. Box 428  
CITY Nowata STATE Ok ZIP 74048

SPUD DATE 12/02/2019  
DRLG FINISHED DATE 12/03/2019  
DATE OF WELL COMPLETION 12/19/2019  
1st PROD DATE 12/23/2019  
RECOMP DATE  
Longitude (if known)

640 Acres  
LOCATE WELL

COMPLETION TYPE

☒ SINGLE ZONE  
☐ MULTIPLE ZONE  
Application Date  
COMINGLED  
Application Date  
LOCATION EXCEPTION ORDER NO.  
INCREASED DENSITY ORDER NO.

CASING & CEMENT (Attach Form 1002C)

TYPE	SIZE	WEIGHT	GRADE	FEET	PSI	SAX	TOP OF CMT
CONDUCTOR	8-5/8"	20	J55	21		12	Surface
SURFACE							
INTERMEDIATE							
PRODUCTION	4-1/2"	10.5	J55	987		105	Surface
LINER							
						TOTAL DEPTH	998

PACKER @ BRAND & TYPE PLUG @ TYPE PLUG @ TYPE  
PACKER @ BRAND & TYPE PLUG @ TYPE PLUG @ TYPE

COMPLETION & TEST DATA BY PRODUCING FORMATION

FORMATION	Arbuckle					No Frac
SPACING & SPACING ORDER NUMBER	N/A					
CLASS: Oil, Gas, Dry, Inj, Disp, Comm Disp, Svc	Oil					
PERFORATED INTERVALS	987'-998' OH					
ACID/VOLUME	N/A					
FRACTURE TREATMENT (Fluids/Prop Amounts)	N/A					
	N/A					
	N/A					

Min Gas Allowable (165:10-17-7)

Gas Purchaser/Measurer

CVR



OR

First Sales Date

1/6/2020

INITIAL TEST DATA

INITIAL TEST DATE	12/23/2019					
OIL-BBL/DAY	5					
OIL-GRAVITY ( API)	22					
GAS-MCF/DAY	0					
GAS-OIL RATIO CU FT/BBL	0					
WATER-BBL/DAY	25					
PUMPING OR FLOWING	Pumping					
INITIAL SHUT-IN PRESSURE	0					
CHOKE SIZE						
FLOW TUBING PRESSURE	25					

A record of the formations drilled through, and pertinent remarks are presented on the reverse. I declare that I have knowledge of the contents of this report and am authorized by my organization to make this report, which was prepared by me or under my supervision and direction, with the data and facts stated herein to be true, correct, and complete to the best of my knowledge and belief.

SIGNATURE Michael Frauenberger 1/28/2020 918.695.2230  
NAME (PRINT OR TYPE) DATE PHONE NUMBER  
P.O. Box 428 Nowata Ok 74048 mfrauenberger@neokprod.com  
ADDRESS CITY STATE ZIP EMAIL ADDRESS

PLEASE TYPE OR USE BLACK INK ONLY  
FORMATION RECORD

Give formation names and tops, if available, or descriptions and thickness of formations drilled through. Show intervals cored or drillstem tested.

NAMES OF FORMATIONS	TOP
Verdigris Lime	44
Croweburg Coal	87
Tebo Coal	231
Bartlesville Sand	352
Warner Sand	534
Mississippi Chat	585
Woddford Shale	935
Arbuckle	987

LEASE NAME Snedden WELL NO. 11-29C

FOR COMMISSION USE ONLY	
ITD on file <input type="checkbox"/> YES <input type="checkbox"/> NO	
APPROVED _____	DISAPPROVED _____
2) Reject Codes	
_____	
_____	
_____	
_____	

Were open hole logs run?	<input checked="" type="checkbox"/> yes	<input type="checkbox"/> no
Date Last log was run	<u>12/13/2019</u>	
Was CO <sub>2</sub> encountered?	<input type="checkbox"/> yes	<input checked="" type="checkbox"/> no at what depths? _____
Was H <sub>2</sub> S encountered?	<input type="checkbox"/> yes	<input checked="" type="checkbox"/> no at what depths? _____
Were unusual drilling circumstances encountered?	<input type="checkbox"/> yes	<input checked="" type="checkbox"/> no
If yes, briefly explain below		

Other remarks: \_\_\_\_\_

\_\_\_\_\_

\_\_\_\_\_

\_\_\_\_\_

\_\_\_\_\_

\_\_\_\_\_

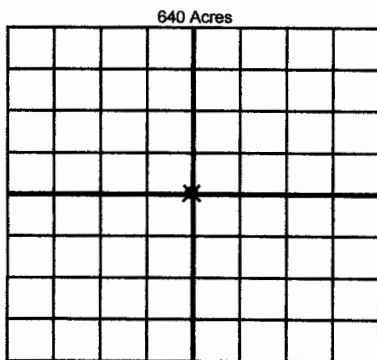

If more than three drainholes are proposed, attach a separate sheet indicating the necessary information.

Direction must be stated in degrees azimuth.  
Please note, the horizontal drainhole and its end point must be located within the boundaries of the lease or spacing unit.

Directional surveys are required for all drainholes and directional wells.

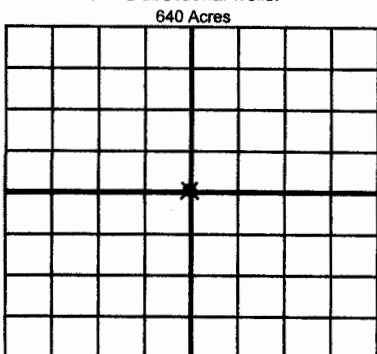

BOTTOM HOLE LOCATION FOR DIRECTIONAL HOLE

SEC	TWP	RGE	COUNTY
Spot Location			
1/4	1/4	1/4	1/4
Measured Total Depth		True Vertical Depth	BHL From Lease, Unit, or Property Line:

BOTTOM HOLE LOCATION FOR HORIZONTAL HOLE: (LATERALS)

LATERAL #1

SEC	TWP	RGE	COUNTY
Spot Location			
1/4	1/4	1/4	1/4
Depth of Deviation		Radius of Turn	Direction
Measured Total Depth		True Vertical Depth	BHL From Lease, Unit, or Property Line:

LATERAL #2

SEC	TWP	RGE	COUNTY
Spot Location			
1/4	1/4	1/4	1/4
Depth of Deviation		Radius of Turn	Direction
Measured Total Depth		True Vertical Depth	BHL From Lease, Unit, or Property Line:

LATERAL #3

SEC	TWP	RGE	COUNTY
Spot Location			
1/4	1/4	1/4	1/4
Depth of Deviation		Radius of Turn	Direction
Measured Total Depth		True Vertical Depth	BHL From Lease, Unit, or Property Line: