

Oklahoma Corporation Commission
Oil & Gas Conservation Division
Post Office Box 52000
Oklahoma City, Oklahoma 73152-2000
Rule 165: 10-3-25

Form 1002A

API No.: 35087221810000

Completion Report

Spud Date: October 17, 2018

OTC Prod. Unit No.: 087-226544-0-0000

Drilling Finished Date: November 29, 2018

1st Prod Date: January 01, 2020

Completion Date: December 21, 2019

Drill Type: HORIZONTAL HOLE

Min Gas Allowable: Yes

Well Name: PARKER 7N 2W 33 4HX

Purchaser/Measurer: ENERFIN RESOURCES CO

Location: MCCLAIN 28 7N 2W
SE NE SW SW
753 FSL 1233 FWL of 1/4 SEC
Derrick Elevation: 0 Ground Elevation: 1099

First Sales Date: 01/09/2020

Operator: LIME ROCK RESOURCES IV-A LP 24419

1111 BAGBY ST STE 4600
HOUSTON, TX 77002-2559

Completion Type		Location Exception		Increased Density	
X	Single Zone	Order No		Order No	
	Multiple Zone	695049		687725	
	Commingled			687589	

Casing and Cement							
Type	Size	Weight	Grade	Feet	PSI	SAX	Top of CMT
CONDUCTOR	20	133	X-56	103		10	
SURFACE	13 3/8	54.5	J-55	440		460	SURFACE
INTERMEDIATE	9 5/8	40.0	P-110	6845		780	5556
PRODUCTION	5 1/2	20.0	P-110	18283		2745	13874

Liner								
Type	Size	Weight	Grade	Length	PSI	SAX	Top Depth	Bottom Depth
There are no Liner records to display.								

Total Depth: 18298

Packer		Plug	
Depth	Brand & Type	Depth	Plug Type
7100	AS-1X	There are no Plug records to display.	

Initial Test Data

Test Date	Formation	Oil BBL/Day	Oil-Gravity (API)	Gas MCF/Day	Gas-Oil Ratio Cu FT/BBL	Water BBL/Day	Pumpin or Flowing	Initial Shut-In Pressure	Choke Size	Flow Tubing Pressure
Jan 09, 2020	WOODFORD	268	46.8	184	687	1911	PUMPING		16/64	376

Completion and Test Data by Producing Formation

Formation Name: WOODFORD

Code: 319WDFD

Class: OIL

Spacing Orders

Order No	Unit Size
652167	640
695050	MULTIUNIT

Perforated Intervals

From	To
7974	18144

Acid Volumes

27,523 GALLONS 15% HCL

Fracture Treatments

21,650,339 BBLS WATER, 11,492,952 POUNDS 100 MESH SAND, 11,494,226 POUNDS 40/70 OTTAWA SAND.

Formation	Top
GIBSON	7128
HART	7227
WOODFORD	7542

Were open hole logs run? No

Date last log run:

Were unusual drilling circumstances encountered? No

Explanation:

Other Remarks

KOP @ 6,955'. WELL PERMITTED / DRILLED BY BP, BUT WAS COMPLETED BY LIME ROCK. OCC - THIS DOCUMENT IS ACCEPTED BASED ON THE DATA SUBMITTED NEITHER THE FINAL LOCATION EXCEPTION NOR THE FINAL MULTIUNIT ORDERS HAVE BEEN ISSUED.

Lateral Holes

Sec: 4 TWP: 6N RGE: 2W County: MCCLAIN

SW SW SE SW

67 FSL 1581 FWL of 1/4 SEC

Depth of Deviation: 7024 Radius of Turn: 8137 Direction: 180 Total Length: 10140

Measured Total Depth: 18298 True Vertical Depth: 7674 End Pt. Location From Release, Unit or Property Line: 67

FOR COMMISSION USE ONLY

1144731

Status: Accepted

RECEIVED

Form 1002A
Rev. 2009

JAN 31 2020

OKLAHOMA CORPORATION COMMISSION
Oil & Gas Conservation Division
Post Office Box 52000
Oklahoma City, Oklahoma 73152-2000
Rule 165:10-3-25OKLAHOMA CORPORATION
COMMISSIONAPI NO. 35-087-
22181
OTC PROD. UNIT NO. 087-226544-0-0000

(PLEASE TYPE OR USE BLACK INK ONLY)

☒ ORIGINAL
☐ AMENDED (Reason)

COMPLETION REPORT

TYPE OF DRILLING OPERATION

☐ STRAIGHT HOLE ☐ DIRECTIONAL HOLE ☒ HORIZONTAL HOLE
☐ SERVICE WELL

If directional or horizontal, see reverse for bottom hole location.

COUNTY	McClain	SEC	28	TWP	7N	RGE	2W
LEASE NAME	Parker 7N 2W 33			WELL NO.	4HX		
SE 1/4	NE 1/4	SW 1/4	SW 1/4	FSL OF 1/4 SEC	753	FWL OF 1/4 SEC	1233
ELEVATION	Ground 1099			Latitude (if known)			
OPERATOR NAME	Lime Rock Resources IV-A, LP			OTC / OCC OPERATOR NO.	24419		
ADDRESS 1111 Bagby St., Ste. 4600							
CITY	Houston			STATE	TX		ZIP 77002

SPUD DATE 10/17/18

DRLG FINISHED DATE 11/29/18

DATE OF WELL COMPLETION 12/21/19

1st PROD DATE 01/09/20

RECOMP DATE

Longitude (if known)

Longtitude (if known)

Longtitude (if known)

Longtitude (if known)

640 Acres

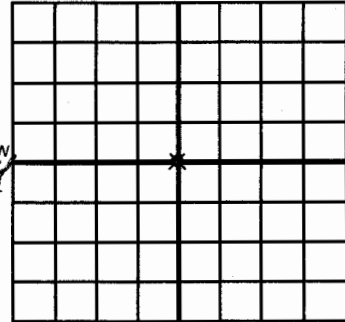

LOCATE WELL

COMPLETION TYPE

<input checked="" type="checkbox"/>	SINGLE ZONE	
<input type="checkbox"/>	MULTIPLE ZONE	
<input type="checkbox"/>	Application Date	
<input type="checkbox"/>	COMMINGLED	
<input type="checkbox"/>	Application Date	
<input type="checkbox"/>	LOCATION EXCEPTION	
<input type="checkbox"/>	ORDER NO.	695049
<input type="checkbox"/>	INCREASED DENSITY	
<input type="checkbox"/>	ORDER NO.	687725/687589

CASING & CEMENT (Attach Form 1002C)

TYPE	SIZE	WEIGHT	GRADE	FEET	PSI	SAX	TOP OF CMT
CONDUCTOR	20	133#	X56	103		10	
SURFACE	13-3/8	54.5	J55	440		460	Surface
INTERMEDIATE	9-5/8	40.0	P110	6845	780525		5556
PRODUCTION	5-1/2	20.0	P110	18283		2745	13874
LINER							

PACKER @ 7100 BRAND & TYPE AS-1X PLUG @ TYPE PLUG @ TYPE TOTAL DEPTH 18298 MD
 PACKER @ BRAND & TYPE PLUG @ TYPE PLUG @ TYPE 7674 TVD

COMPLETION & TEST DATA BY PRODUCING FORMATION

FORMATION	Woodford						
SPACING & SPACING	640/652167						
ORDER NUMBER							
CLASS: Oil, Gas, Dry, Inj, Disp, Comm Disp, Svc	Oil						
PERFORATED INTERVALS	7974-18144						
ACID/VOLUME	27523 gal 15% HCl						
FRACTURE TREATMENT (Fluids/Prop Amounts)	21650339 BW						
	11492952# 100 mesh						
	11494226# 40/70 Ottawa						

Min Gas Allowable (165:10-17-7)

Gas Purchaser/Measurer

Enerfin Resources Co



OR

First Sales Date

1/9/20

INITIAL TEST DATA

Oil Allowable (165:10-13-3)

INITIAL TEST DATE	1/9/20						
OIL-BBL/DAY	268						
OIL-GRAVITY (API)	46.8						
GAS-MCF/DAY	184						
GAS-OIL RATIO CU FT/BBL	687/1						
WATER-BBL/DAY	1911						
PUMPING OR FLOWING	P						
INITIAL SHUT-IN PRESSURE							
CHOKE SIZE	16/64						
FLOW TUBING PRESSURE	376						

A record of the formations drilled through, and pertinent remarks are presented on the reverse. I declare that I have knowledge of the contents of this report and am authorized by my organization to make this report, which was prepared by me or under my supervision and direction, with the data and facts stated herein to be true, correct, and complete to the best of my knowledge and belief.

Carla Martin

SIGNATURE

Carla Martin/Regulatory Tech

NAME (PRINT OR TYPE)

1/29/20 713/292-9510

DATE

PHONE NUMBER

1111 Bagby St., Ste. 4600

ADDRESS

Houston

CITY

TX 7702

STATE

ZIP

cmartin@limerockresources.com

EMAIL ADDRESS

PLEASE TYPE OR USE BLACK INK ONLY

FORMATION RECORD

Give formation names and tops, if available, or descriptions and thickness of formations drilled through. Show intervals cored or drillstem tested.

NAMES OF FORMATIONS	TOP
Gibson	7128
Hart	7227
Woodford	7542

LEASE NAME Parker 7N 2W 33

WELL NO. 4HX

FOR COMMISSION USE ONLY	
ITD on file <input type="checkbox"/> YES <input type="checkbox"/> NO	
APPROVED <input type="checkbox"/> DISAPPROVED <input type="checkbox"/>	2) Reject Codes
<div></div> <div></div> <div></div> <div></div>	

Were open hole logs run?	<input type="checkbox"/> yes <input checked="" type="checkbox"/> no
Date Last log was run	
Was CO ₂ encountered?	<input type="checkbox"/> yes <input checked="" type="checkbox"/> no at what depths? <div></div>
Was H ₂ S encountered?	<input type="checkbox"/> yes <input checked="" type="checkbox"/> no at what depths? <div></div>
Were unusual drilling circumstances encountered?	<input type="checkbox"/> yes <input checked="" type="checkbox"/> no
If yes, briefly explain below	

Other remarks:

KOP @ 6955'. Well permitted/drilled by BP, but was completed by Lime Rock.

640 Acres

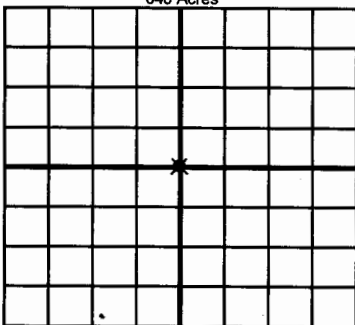

If more than three drainholes are proposed, attach a separate sheet indicating the necessary information.

Direction must be stated in degrees azimuth.
Please note, the horizontal drainhole and its end point must be located within the boundaries of the lease or spacing unit.

Directional surveys are required for all drainholes and directional wells.

640 Acres

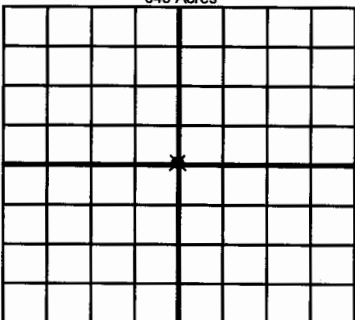

BOTTOM HOLE LOCATION FOR DIRECTIONAL HOLE

SEC	TWP	RGE	COUNTY
Spot Location			
1/4	1/4	1/4	1/4
Measured Total Depth		True Vertical Depth	BHL From Lease, Unit, or Property Line:

BOTTOM HOLE LOCATION FOR HORIZONTAL HOLE: (LATERALS)

LATERAL #1			
SEC	TWP	RGE	COUNTY
4	6N	2W	McClain
Spot Location			
SE 1/4	SE 1/4	SE 1/4	SW 1/4
Depth of Deviation 7024'		Radius of Turn 8137'	Direction 180° S
Measured Total Depth 18298		True Vertical Depth 7674	Total Length 10140'
			BHL From Lease, Unit, or Property Line: 68

LATERAL #2			
SEC	TWP	RGE	COUNTY
Spot Location			
1/4	1/4	1/4	1/4
Depth of Deviation		Radius of Turn	Direction
Measured Total Depth		True Vertical Depth	Total Length
			BHL From Lease, Unit, or Property Line:

LATERAL #3			
SEC	TWP	RGE	COUNTY
Spot Location			
1/4	1/4	1/4	1/4
Depth of Deviation		Radius of Turn	Direction
Measured Total Depth		True Vertical Depth	Total Length
			BHL From Lease, Unit, or Property Line:

RECEIVED

Form 1002A

Rev. 2009

API NO.	087-22181
OTC PROD.	
UNIT NO.	

(PLEASE TYPE OR USE BLACK INK ONLY)

OKLAHOMA CORPORATION COMMISSION

Oil & Gas Conservation Division

Post Office Box 52000

Oklahoma City, Oklahoma 73152-2000

Rule 165:10-3-25

FEB 13 2020

OKLAHOMA CORPORATION COMMISSION

<input type="checkbox"/>	ORIGINAL
<input checked="" type="checkbox"/>	AMENDED (Reason)

1st prod date, perforated intervals

COMPLETION REPORT

TYPE OF DRILLING OPERATION

<input type="checkbox"/>	STRAIGHT HOLE	<input type="checkbox"/>	DIRECTIONAL HOLE	<input checked="" type="checkbox"/>	HORIZONTAL HOLE
<input type="checkbox"/>	SERVICE WELL				

If directional or horizontal, see reverse for bottom hole location.

COUNTY	McCain	SEC	28	TWP	7N	RGE	2W
LEASE NAME	PARKER 7N 2W 33			WELL NO.	4HX		
SE 1/4 NE 1/4 SW 1/4 SW 1/4	FSL OF 1/4 SEC	753	FWL 1/4 SEC	1233			
ELEVATION Derrick FL	Ground	1100	Latitude (if known)	35.0463626		Longitude (if known)	-97.4199414
OPERATOR NAME	LIME ROCK RESOURCES IV-A, LP			OTC / OCC OPERATOR NO.	24419		
ADDRESS	1111 BAGBY ST., STE. 4600 ATTN: Regulatory						
CITY	HOUSTON	STATE	TX	ZIP	77002		

SPUD DATE 10/17/18

DRLG FINISHED DATE 11/30/18

DATE OF WELL COMPLETION 12/21/19

1st PROD DATE 01/01/20

RECOMP DATE

640 Acres									
LOCATE WELL									

COMPLETION TYPE

<input checked="" type="checkbox"/>	SINGLE ZONE
<input type="checkbox"/>	MULTIPLE ZONE
	Application Date
<input type="checkbox"/>	COMINGLED
	Application Date
<input type="checkbox"/>	LOCATION EXCEPTION ORDER NO.
<input type="checkbox"/>	INCREASED DENSITY ORDER NO.

CASING & CEMENT (Attach Form 1002C)

TYPE	SIZE	WEIGHT	GRADE	FEET	PSI	SAX	TOP OF CMT
CONDUCTOR	20	133	X56	103		10	
SURFACE	13-3/8	54.5	J55	440		460	SURF
INTERMEDIATE	9 5/8	40	P110	6,845		525	5,556
PRODUCTION	5 1/2	20	P110	18283		2745	13874
LINER							

PACKER @ 7,100	BRAND & TYPE AX-1X	PLUG @	TYPE	PLUG @	TYPE	TOTAL DEPTH	18298 MD
PACKER @	BRAND & TYPE	PLUG @	TYPE	PLUG @	TYPE		

COMPLETION & TEST DATA BY PRODUCING FORMATION

FORMATION	WOODFORD						
SPACING & SPACING ORDER NUMBER	640/652167						
CLASS: Oil, Gas, Dry, Inj, Disp, Comm Disp, Svc	OIL						
PERFORATED INTERVALS	7974-18144						
ACID/VOLUME	27523 gal 15% HC1						
FRACTURE TREATMENT (Fluids/Prop Amounts)	21650339 BW						
	11492952# 100 mesh						
	11494226# 40/70 Ottawa						

Min Gas Allowable (165:10-17-7)

☐

OR

Oil Allowable (165:10-13-3)

Gas Purchaser/Measurer

First Sales Date

ENERFIN RESOURCES

1/9/2020

INITIAL TEST DATA

INITIAL TEST DATE	1/9/2020						
OIL-BBL/DAY	268						
OIL-GRAVITY (API)	46.8						
GAS-MCF/DAY	184						
GAS-OIL RATIO CU FT/BBL	687/1						
WATER-BBL/DAY	1911						
PUMPING OR FLOWING	P						
INITIAL SHUT-IN PRESSURE							
CHOKE SIZE	16/64						
FLOW TUBING PRESSURE	376						

A record of the formations drilled through, and pertinent remarks are presented on the reverse. I declare that I have knowledge of the contents of this report and am authorized by my organization to make this report, which was prepared by me or under my supervision and direction, with the data and facts stated herein to be true, correct, and complete to the best of my knowledge and belief.

		Carla Martin/Regulatory Tech		2/11/2020		713-360-5834	
SIGNATURE		NAME (PRINT OR TYPE)		DATE		PHONE NUMBER	
1111 Bagby St. Ste 4600, Attn: Regulatory		HOUSTON TX 77002		hr.dmarberry@limerockresources.com			
ADDRESS		CITY STATE ZIP		EMAIL ADDRESS			

PLEASE TYPE OR USE BLACK INK ONLY
FORMATION RECORD

Give formation names and tops, if available, or descriptions and thickness of formations drilled through. Show intervals cored or drillstem tested.

NAMES OF FORMATIONS	TOP
GIBSON	7,128
HART	7,227
WOODFORD	7542

LEASE NAME PARKER 7N 2W 33

WELL NO. 4HX

FOR COMMISSION USE ONLY	
ITD on file <input type="checkbox"/> YES <input type="checkbox"/> NO	
APPROVED _____	DISAPPROVED _____
2) Reject Codes	

Were open hole logs run?	yes	<input checked="" type="checkbox"/> no
Date Last log was run	_____	
Was CO ₂ encountered?	yes	<input checked="" type="checkbox"/> no at what depths? _____
Was H ₂ S encountered?	yes	<input checked="" type="checkbox"/> no at what depths? _____
Were unusual drilling circumstances encountered?	yes	<input checked="" type="checkbox"/> no
If yes, briefly explain below		

Other remarks: KOP @ 6955' THIS WELL WAS PERMITTED AND DRILLED BY BP. THE OPERATOR CHANGED TO LIME ROCK RESOURCE AND WAS COMPLETED BY LIME ROCK.

640 Acres

If more than three drainholes are proposed, attach a separate sheet indicating the necessary information.

Direction must be stated in degrees azimuth.
Please note, the horizontal drainhole and its end point must be located within the boundaries of the lease or spacing unit.

Directional surveys are required for all drainholes and directional wells.

640 Acres

BOTTOM HOLE LOCATION FOR DIRECTIONAL HOLE

SEC	TWP	RGE	COUNTY
Spot Location	1/4	1/4	1/4
Measured Total Depth	True Vertical Depth		BHL From Lease, Unit, or Property Line:

BOTTOM HOLE LOCATION FOR HORIZONTAL HOLE: (LATERALS)

LATERAL #1			
SEC	TWP	RGE	COUNTY
4	6N	2W	McCLAIN
Spot Location	SE 1/4	SE 1/4	SW 1/4
Depth of Deviation	7,024	Radius of Turn	8137
Measured Total Depth	18,298	True Vertical Depth	7,674
Direction 180 S			
Total Length 10,140			
BHL From Lease, Unit, or Property Line: 68' FSL & 1581' FWL			

LATERAL #2			
SEC	TWP	RGE	COUNTY
Spot Location	1/4	1/4	1/4
Depth of Deviation	Radius of Turn		Direction
Measured Total Depth	True Vertical Depth		BHL From Lease, Unit, or Property Line:

LATERAL #3			
SEC	TWP	RGE	COUNTY
Spot Location	1/4	1/4	1/4
Depth of Deviation	Radius of Turn		Direction
Measured Total Depth	True Vertical Depth		BHL From Lease, Unit, or Property Line:

A circular professional seal for a land surveyor. The outer ring contains the text "LICENSED PROFESSIONAL LAND SURVEYOR" at the top and "OKLAHOMA" at the bottom. Inside this ring is a smaller circle with a beaded border. In the center of the seal, the text reads "LANCE G. MATHIS" and "1664" below it.